

NOTE:
THE EXISTING TRAFFIC SIGNAL CONTROL EQUIPMENT FOR THIS INTERSECTION IS "ECONOLITE".



SIGN ASSEMBLY "A"

SIGN ASSEMBLY "B"

SIGN ASSEMBLY "C"

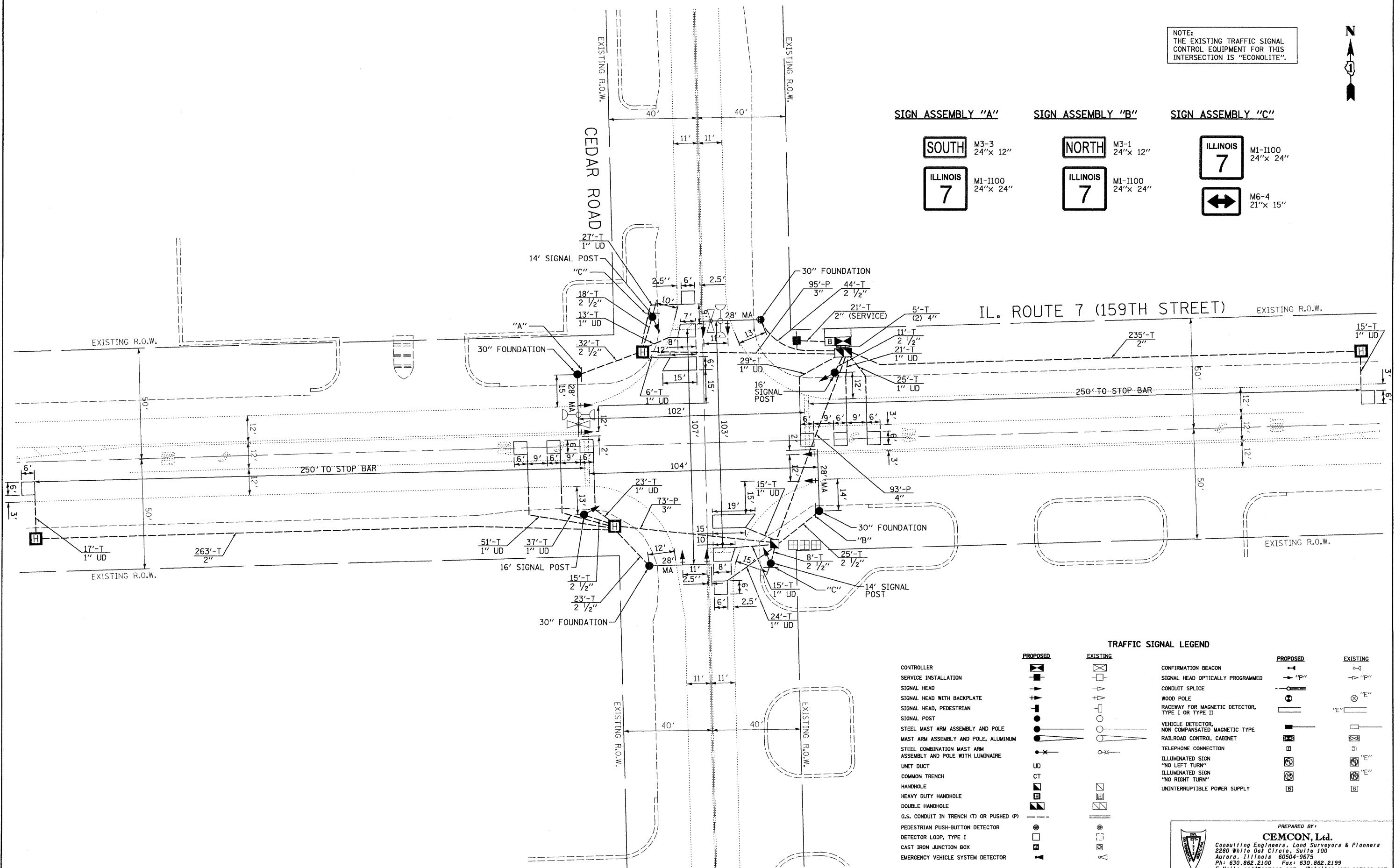
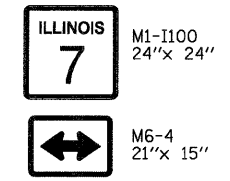
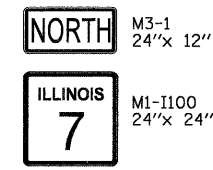
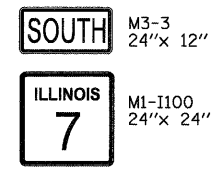

TRAFFIC SIGNAL LEGEND			
PROPOSED	EXISTING	PROPOSED	EXISTING
CONTROLLER	[Symbol]	CONFIRMATION BEACON	[Symbol]
SERVICE INSTALLATION	[Symbol]	SIGNAL HEAD OPTICALLY PROGRAMMED	[Symbol]
SIGNAL HEAD	[Symbol]	CONDUIT SPLICE	[Symbol]
SIGNAL HEAD WITH BACKPLATE	[Symbol]	WOOD POLE	[Symbol]
SIGNAL HEAD, PEDESTRIAN	[Symbol]	RACEWAY FOR MAGNETIC DETECTOR, TYPE I OR TYPE II	[Symbol]
SIGNAL POST	[Symbol]	VEHICLE DETECTOR, NON COMPENSATED MAGNETIC TYPE	[Symbol]
STEEL MAST ARM ASSEMBLY AND POLE	[Symbol]	RAILROAD CONTROL CABINET	[Symbol]
MAST ARM ASSEMBLY AND POLE, ALUMINUM	[Symbol]	TELEPHONE CONNECTION	[Symbol]
STEEL COMBINATION MAST ARM ASSEMBLY AND POLE WITH LUMINAIRE	[Symbol]	ILLUMINATED SIGN "NO LEFT TURN"	[Symbol]
UNIT DUCT	[Symbol]	ILLUMINATED SIGN "NO RIGHT TURN"	[Symbol]
COMMON TRENCH	[Symbol]	UNINTERRUPTIBLE POWER SUPPLY	[Symbol]
HANDHOLE	[Symbol]		
HEAVY DUTY HANDHOLE	[Symbol]		
DOUBLE HANDHOLE	[Symbol]		
G.S. CONDUIT IN TRENCH (T) OR PUSHED (P)	[Symbol]		
PEDESTRIAN PUSH-BUTTON DETECTOR	[Symbol]		
DETECTOR LOOP, TYPE I	[Symbol]		
CAST IRON JUNCTION BOX	[Symbol]		
EMERGENCY VEHICLE SYSTEM DETECTOR	[Symbol]		

FILE NAME = \MICROST\352072\ IL 7 @ CEDAR SIG.DGN	USER NAME = RDS	DESIGNED - KK	REVISED -
		DRAWN - RDS	REVISED -
		CHECKED - BPT	REVISED -
		DATE - 03-18-09	REVISED -

**STATE OF ILLINOIS
DEPARTMENT OF TRANSPORTATION**

**TRAFFIC SIGNAL MODIFICATION PLAN
IL. ROUTE 7 (159TH STREET) AT CEDAR ROAD**

SCALE: N.T.S. SHEET NO. OF SHEETS STA. TO STA.

PREPARED BY:
CEMCON, Ltd.
Consulting Engineers, Land Surveyors & Planners
2280 White Oak Circle, Suite 100
Aurora, Illinois 60504-9675
Ph: 630.862.2100 Fax: 630.862.2199
E-Mail: cadd@cemcon.com Website: www.cemcon.com

F.A.P. RTE.	SECTION	COUNTY	TOTAL SHEETS	SHEET NO.
	2009-038 TS	WILL	19	11

CONTRACT NO. 60643
FED. ROAD DIST. NO. ILLINOIS FED. AID PROJECT