

CONTRACT NO. 62700

F.A. ROUTE NO.	SECTION	COUNTY	TOTAL SHEETS	SHEET NO.
866	*	LAKE	554	65
FED. ROAD DIST. NO.		ILLINOIS FED. AID PROJECT		
		* (L-2(W,R);6,6A & 6 EXT) WRS-1		

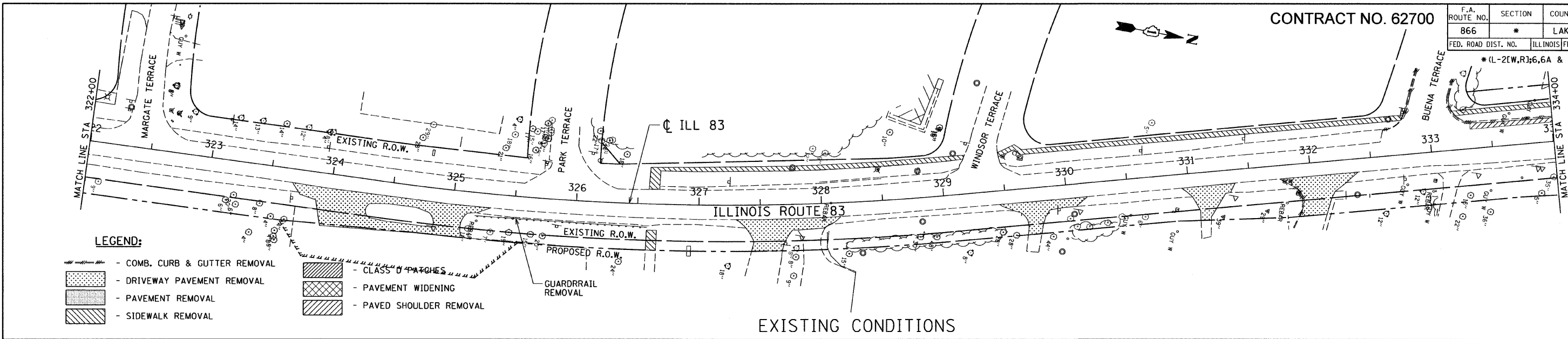

LEGEND:

- COMB. CURB & GUTTER REMOVAL
- DRIVEWAY PAVEMENT REMOVAL
- PAVEMENT REMOVAL
- SIDEWALK REMOVAL
- CLASS P PATCHES
- PAVEMENT WIDENING
- PAVED SHOULDER REMOVAL

EXISTING CONDITIONS

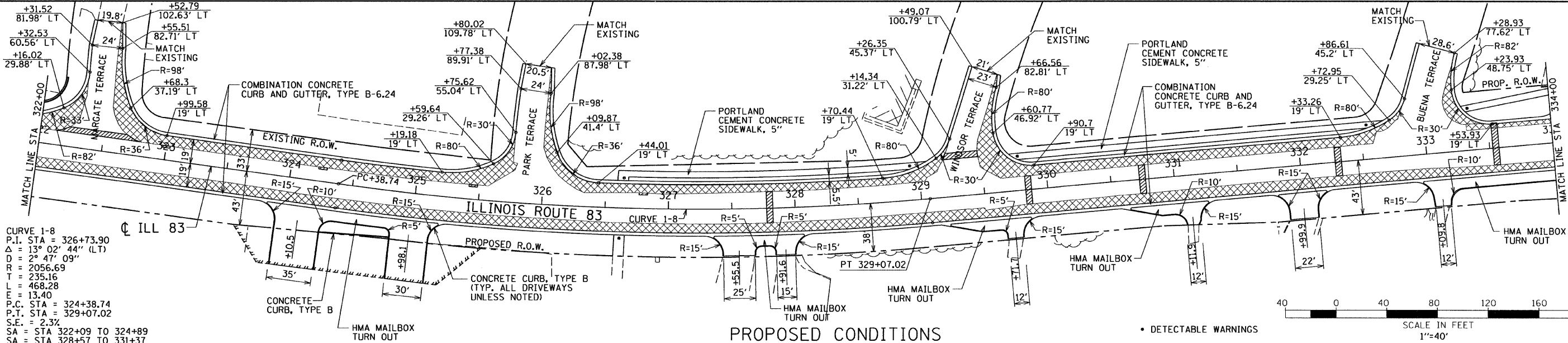

PROPOSED CONDITIONS

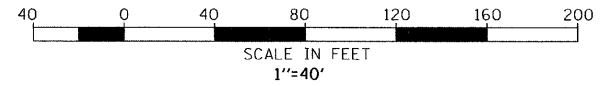

CURVE 1-8
 P.I. STA = 326+73.90
 P.C. STA = 324+38.74
 P.T. STA = 329+07.02
 S.E. = 2.3%
 SA = STA 322+09 TO 324+89
 SA = STA 328+57 TO 331+37

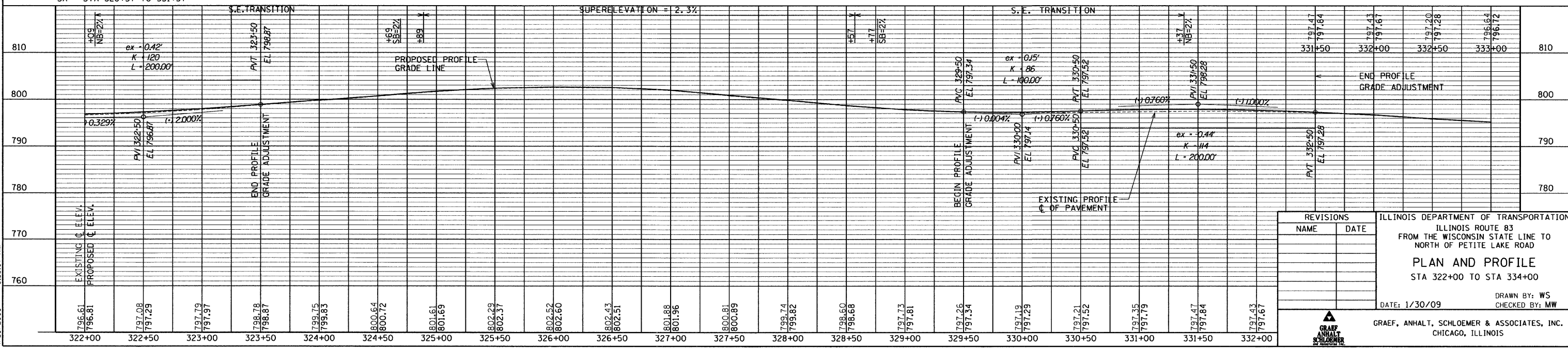

REVISIONS	
NAME	DATE

ILLINOIS DEPARTMENT OF TRANSPORTATION
 FROM THE WISCONSIN STATE LINE TO
 NORTH OF PETITE LAKE ROAD
PLAN AND PROFILE
 STA 322+00 TO STA 334+00

DATE: 1/30/09
 DRAWN BY: WS
 CHECKED BY: MW

GRAEF, ANHALT, SCHLOEMER & ASSOCIATES, INC.
 CHICAGO, ILLINOIS

G:\20004024_M\ms\plan\set\plan15.dgn 4/23/2009 9:15:30T AM