

CONTRACT NO. 62700

F.A. ROUTE NO.	SECTION	COUNTY	TOTAL SHEETS	SHEET NO.
866	*	LAKE	554	72
FED. ROAD DIST. NO.		ILLINOIS	FED. AID PROJECT	

\*(L-2(W,R);6,6A & 6 EXT) WRS-1

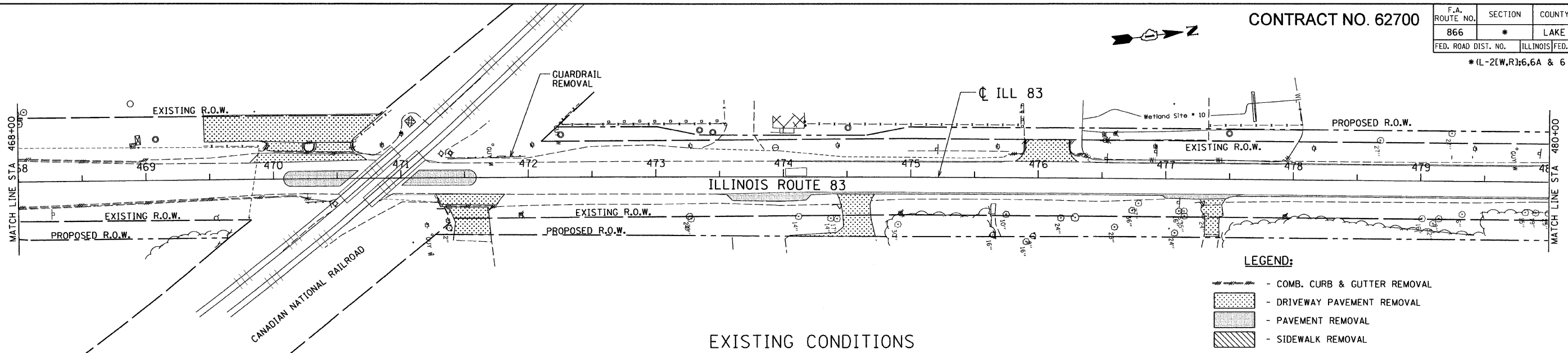

LEGEND:

- COMB. CURB & GUTTER REMOVAL
- DRIVEWAY PAVEMENT REMOVAL
- PAVEMENT REMOVAL
- SIDEWALK REMOVAL
- CLASS D PATCHES
- PAVEMENT WIDENING

EXISTING CONDITIONS

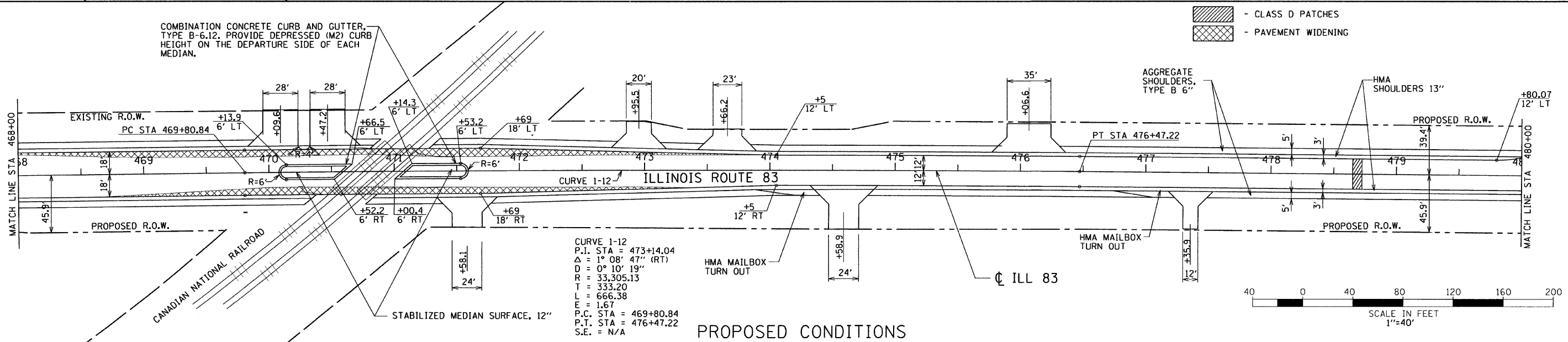

PROPOSED CONDITIONS

CURVE 1-12  
 P.I. STA = 473+14.04  
 $\Delta = 1^\circ 08' 47''$  (RT)  
 $D = 0^\circ 10' 19''$   
 $R = 33,305.13$   
 $T = 333.20$   
 $L = 666.38$   
 $E = 1.67$   
 P.C. STA = 469+80.84  
 P.T. STA = 476+47.22  
 S.E. = N/A

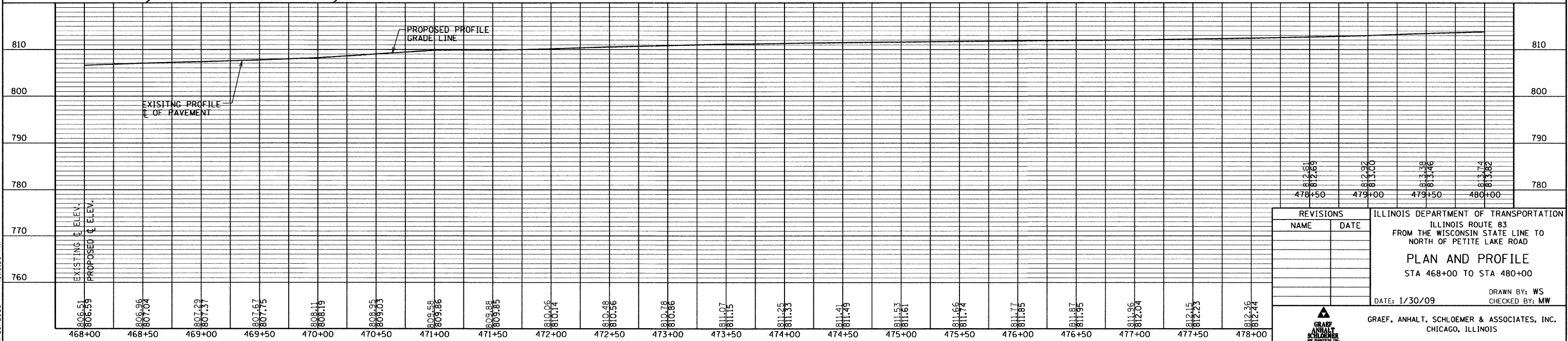

REVISIONS	
NAME	DATE

ILLINOIS DEPARTMENT OF TRANSPORTATION  
 FROM THE WISCONSIN STATE LINE TO  
 NORTH OF PETITE LAKE ROAD  
**PLAN AND PROFILE**  
 STA 468+00 TO STA 480+00

DATE: 1/30/09  
 DRAWN BY: WS  
 CHECKED BY: MW

GRAEF, ANHALT, SCHLOEMER & ASSOCIATES, INC.  
 CHICAGO, ILLINOIS

G:\2004\0424\_MVns\plan\set\p\0122.dgn  
 4/29/2009 10:03:30 AM