

CONTRACT NO. 62700

F.A. ROUTE NO.	SECTION	COUNTY	TOTAL SHEETS	SHEET NO.
866	*	LAKE	554	75
FED. ROAD DIST. NO.		ILLINOIS	FED. AID PROJECT	
* (L-2(W,R);6.6A & 6 EXT) WRS-1				

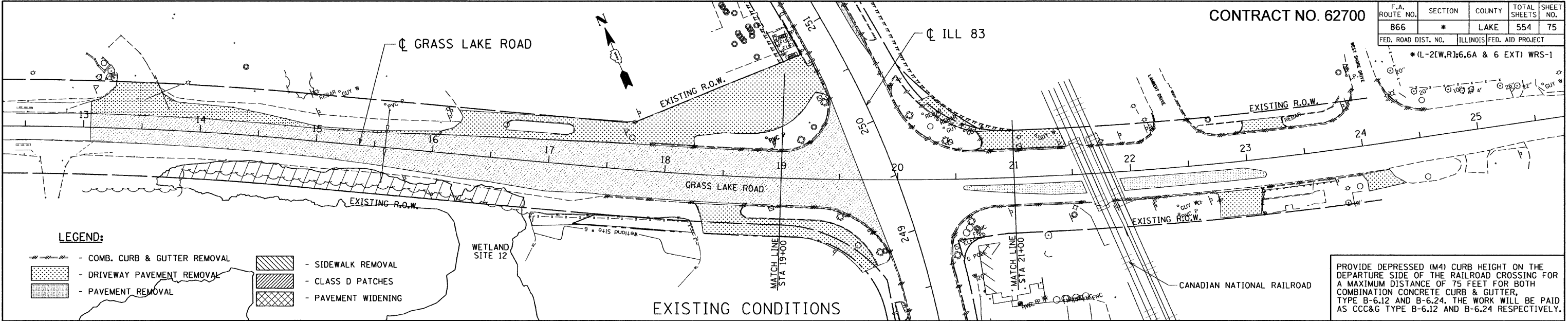

LEGEND:

- COMB. CURB & GUTTER REMOVAL
- DRIVEWAY PAVEMENT REMOVAL
- PAVEMENT REMOVAL
- SIDEWALK REMOVAL
- CLASS D PATCHES
- PAVEMENT WIDENING

PROVIDE DEPRESSED (M4) CURB HEIGHT ON THE DEPARTURE SIDE OF THE RAILROAD CROSSING FOR A MAXIMUM DISTANCE OF 75 FEET FOR BOTH COMBINATION CONCRETE CURB & GUTTER, TYPE B-6.12 AND B-6.24. THE WORK WILL BE PAID AS CCC&G TYPE B-6.12 AND B-6.24 RESPECTIVELY.

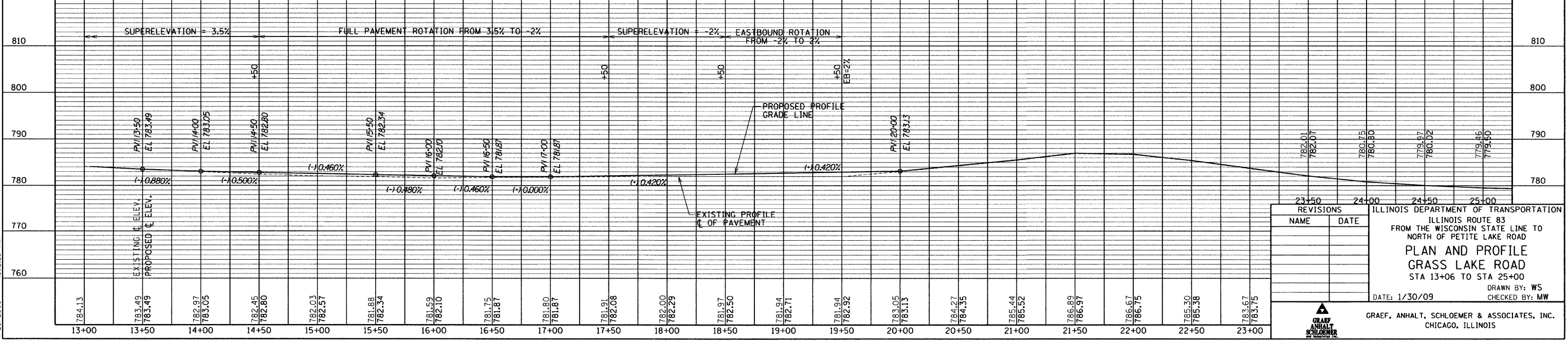
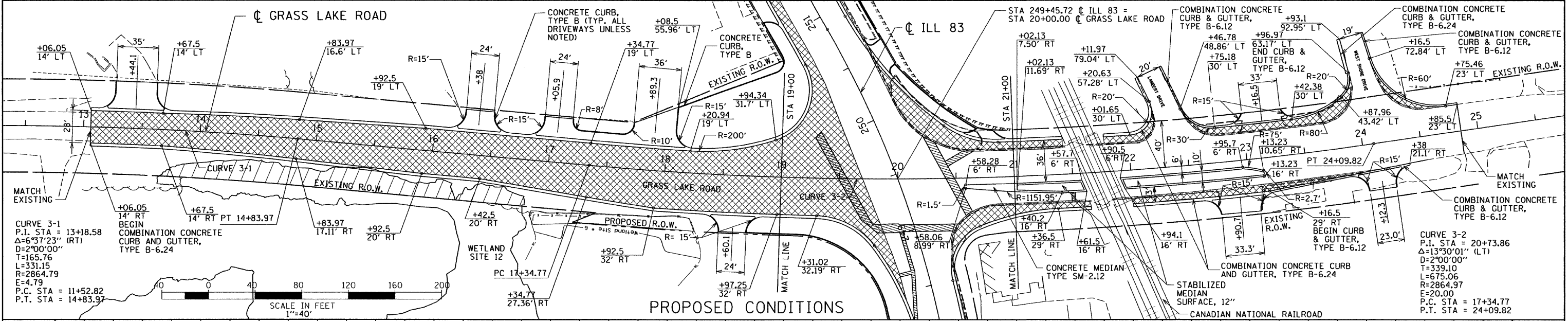

REVISIONS	
NAME	DATE

ILLINOIS DEPARTMENT OF TRANSPORTATION
 FROM THE WISCONSIN STATE LINE TO
 NORTH OF PETITE LAKE ROAD
PLAN AND PROFILE
GRASS LAKE ROAD
 STA 13+06 TO STA 25+00
 DATE: 1/30/09
 DRAWN BY: WS
 CHECKED BY: MW

GRAEF, ANHALT, SCHLOEMER & ASSOCIATES, INC.
 CHICAGO, ILLINOIS

G:\20004024.M\ms\plan\set\plan26.dgn
 4/29/2009 10:22:23 AM