

CONTRACT NO. 62700

|                                 |          |                  |              |           |
|---------------------------------|----------|------------------|--------------|-----------|
| F.A. ROUTE NO.                  | SECTION  | COUNTY           | TOTAL SHEETS | SHEET NO. |
| 866                             | *        | LAKE             | 554          | 78        |
| FED. ROAD DIST. NO.             | ILLINOIS | FED. AID PROJECT |              |           |
| * (L-2(W,R);6,6A & 6 EXT) WRS-1 |          |                  |              |           |

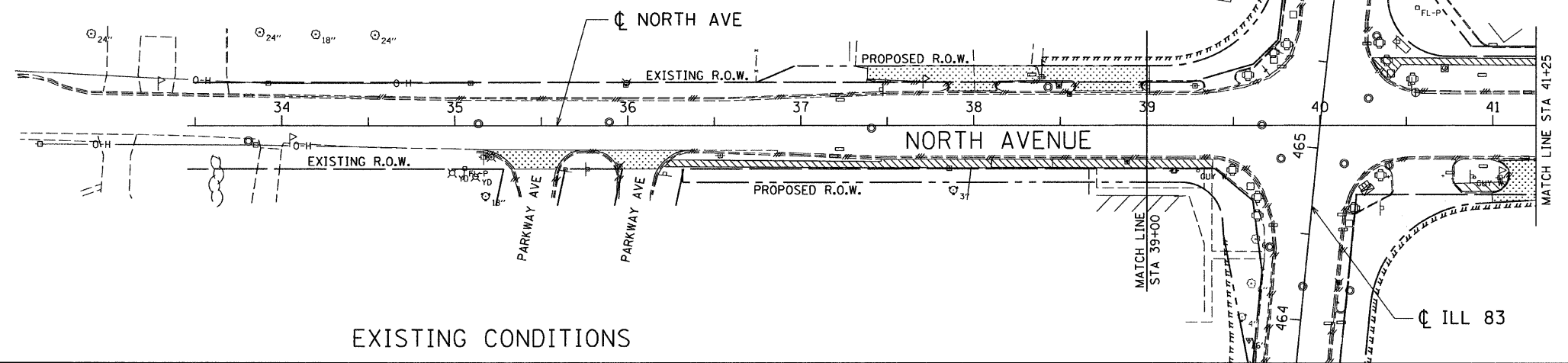

EXISTING CONDITIONS

**LEGEND:**

- COMB. CURB & GUTTER REMOVAL
- DRIVEWAY PAVEMENT REMOVAL
- PAVEMENT REMOVAL
- SIDEWALK REMOVAL
- CLASS D PATCHES
- PAVEMENT WIDENING

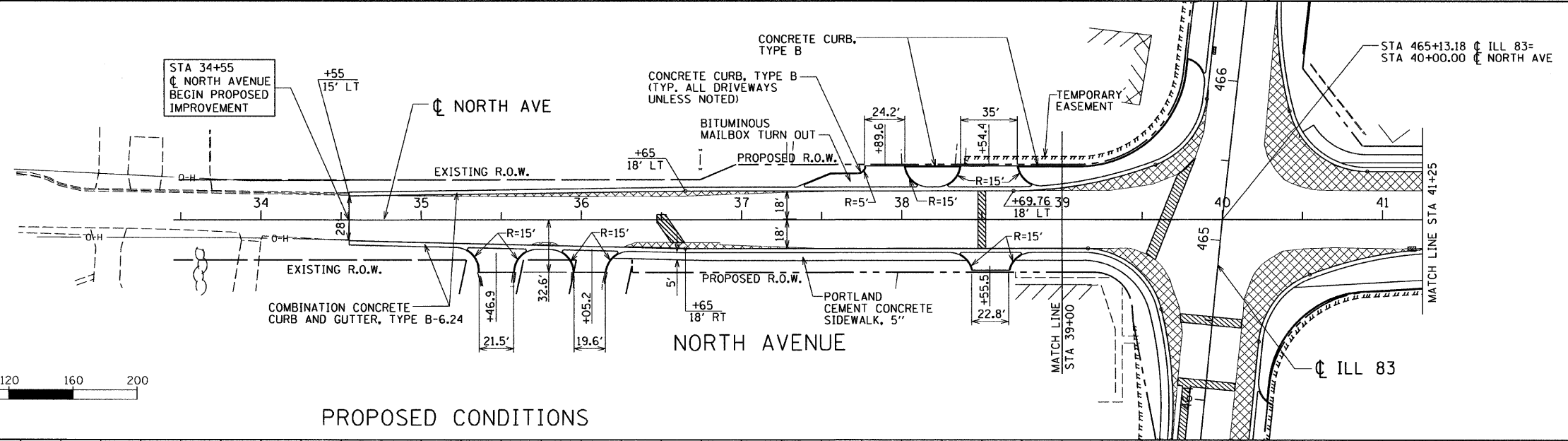

PROPOSED CONDITIONS

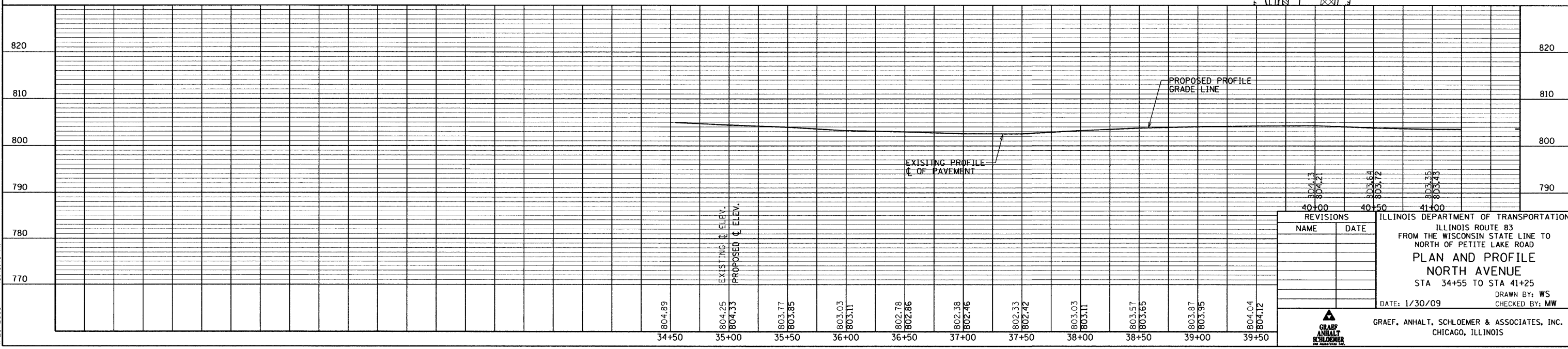
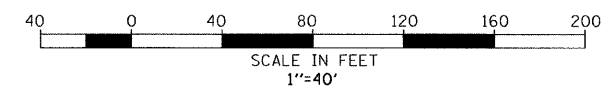

| REVISIONS |      |
|-----------|------|
| NAME      | DATE |
|           |      |
|           |      |
|           |      |

ILLINOIS DEPARTMENT OF TRANSPORTATION  
 ILLINOIS ROUTE 83  
 FROM THE WISCONSIN STATE LINE TO  
 NORTH OF PETITE LAKE ROAD  
**PLAN AND PROFILE**  
**NORTH AVENUE**  
 STA 34+50 TO STA 41+25  
 DATE: 1/30/09  
 DRAWN BY: WS  
 CHECKED BY: MW

GRAEF, ANHALT, SCHLOEMER & ASSOCIATES, INC.  
 CHICAGO, ILLINOIS

G:\20040424\_M\ms\plan\set\picr23.dgn 4/29/2005 10:48:40 AM