

F.A. ROUTE NO.	SECTION	COUNTY	TOTAL SHEETS	SHEET NO.
866	*	LAKE	554	87
FED. ROAD DIST. NO.		ILLINOIS	FED. AID PROJECT	

\*(L-2EW,R)6,6A & 6 EXT) WRS-1

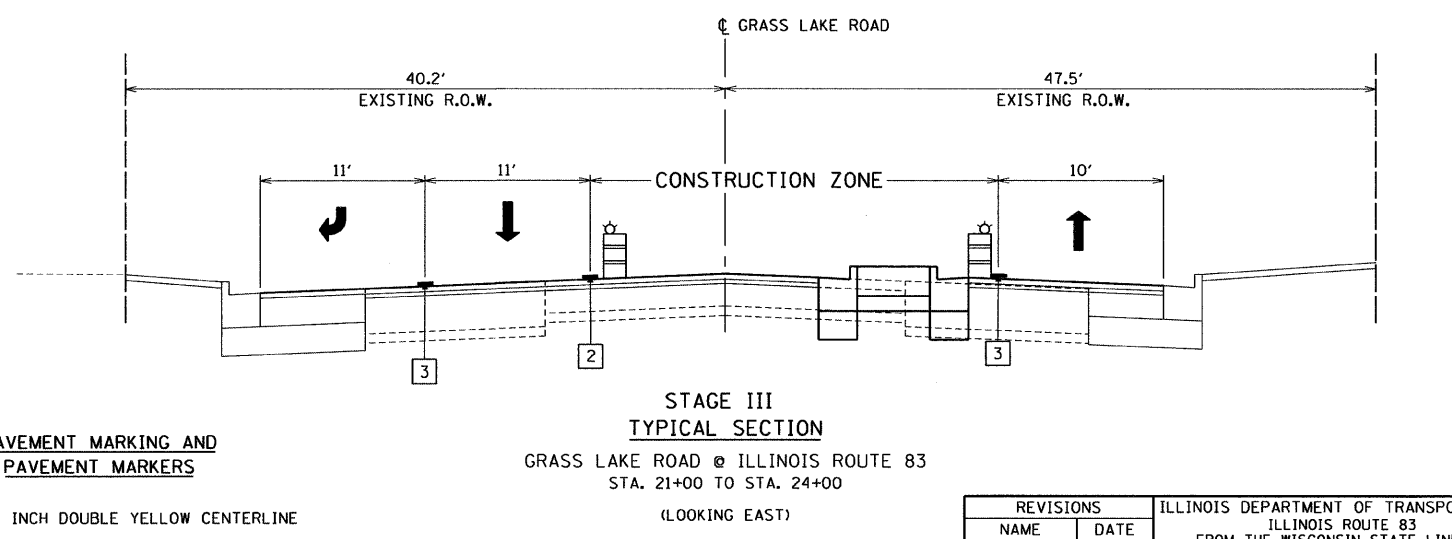
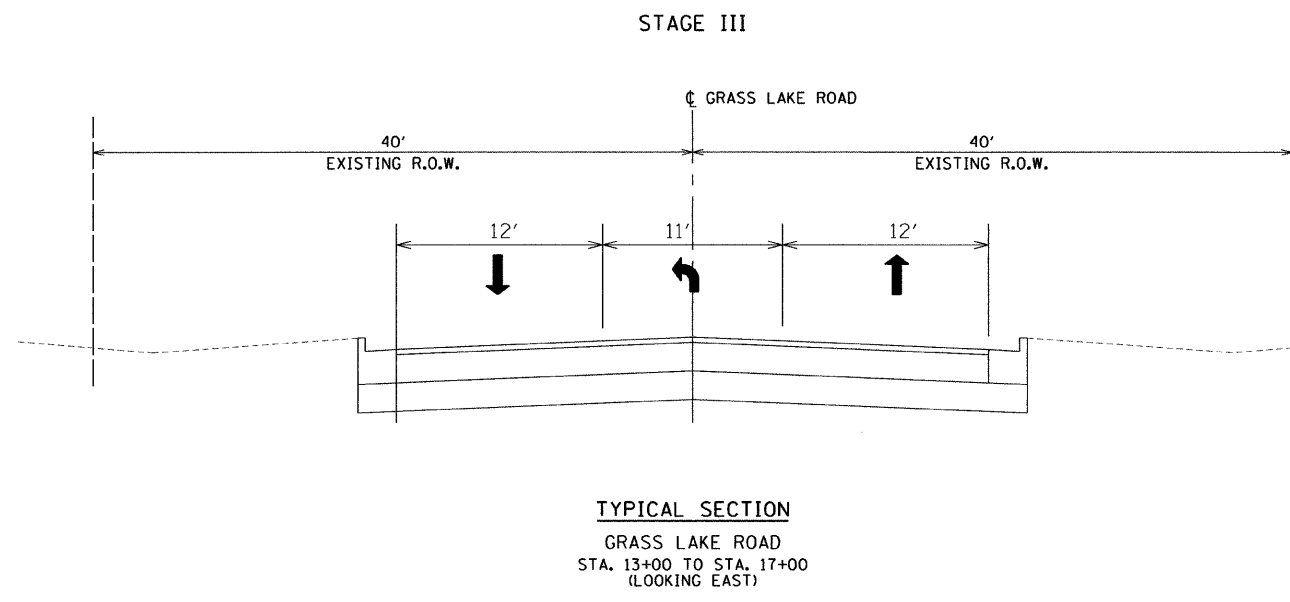
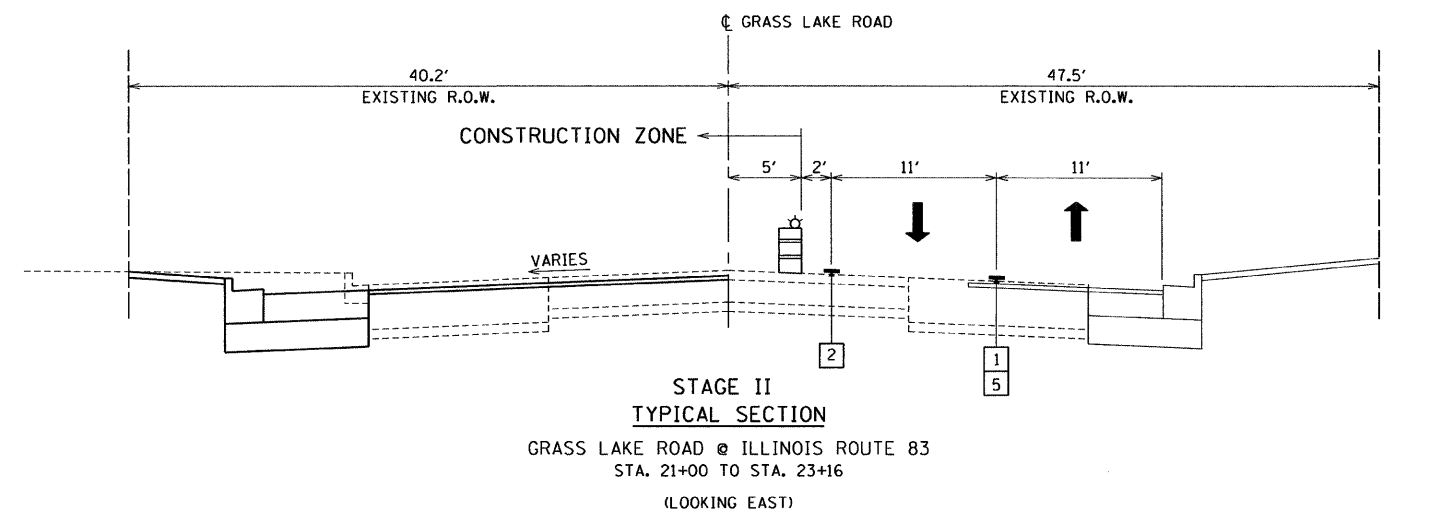
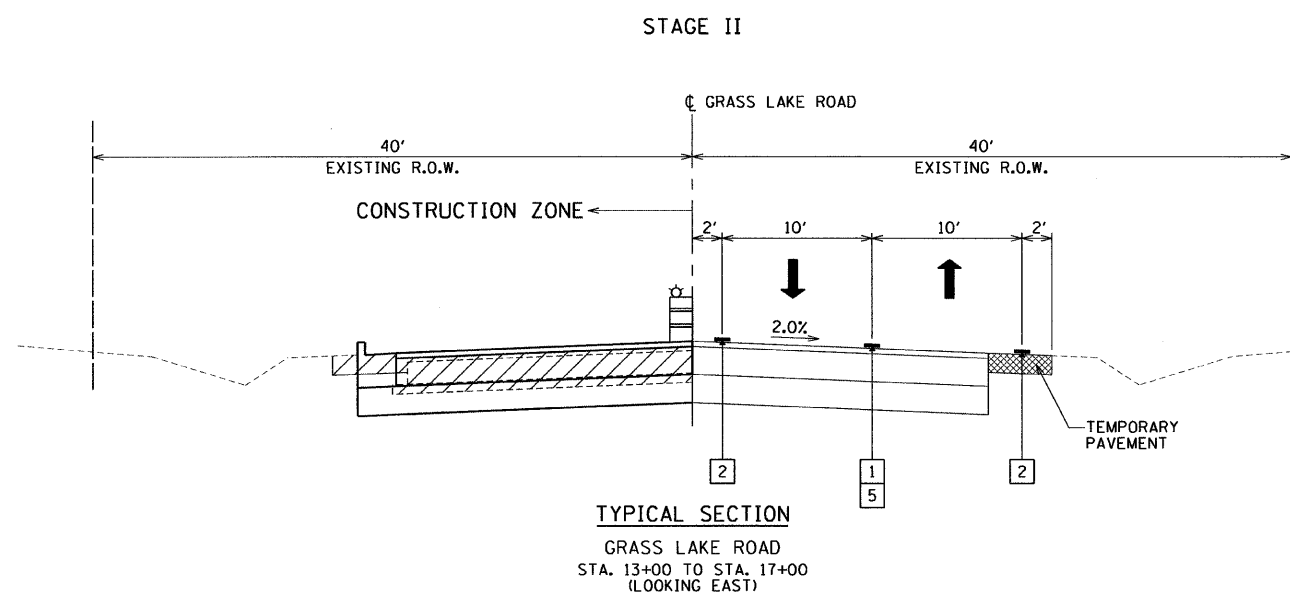
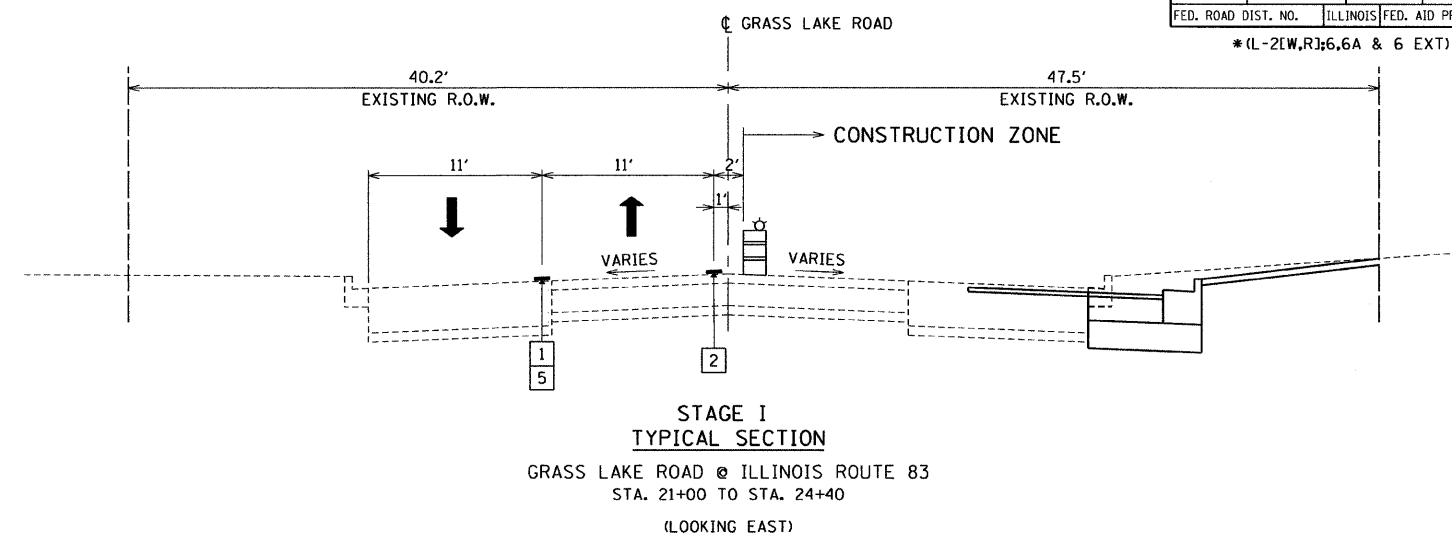
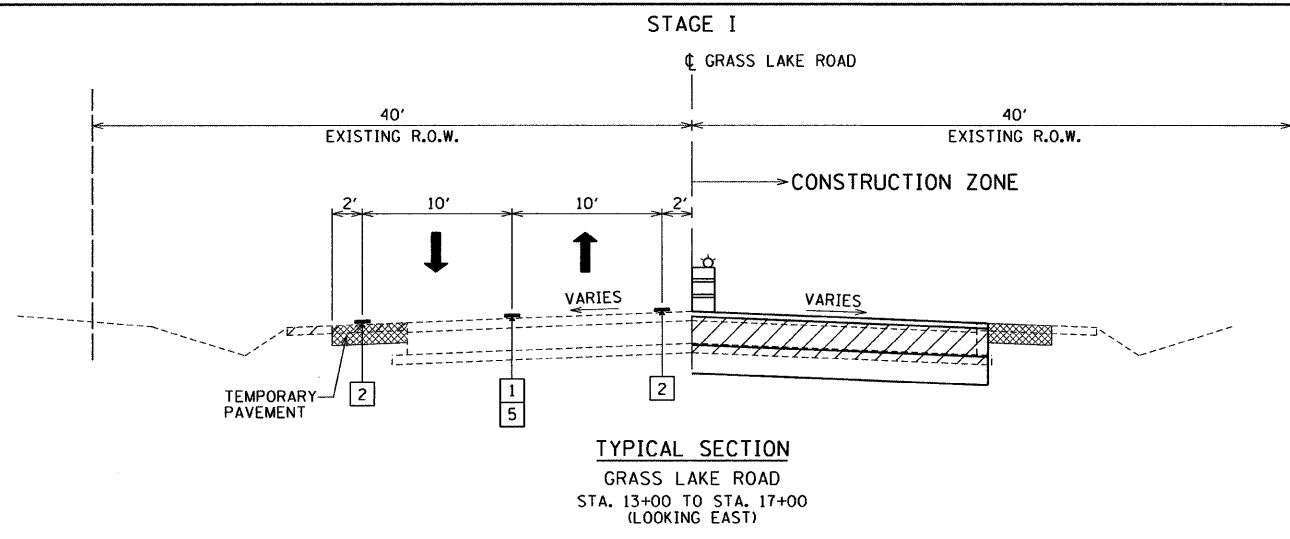

- PAVEMENT MARKING AND PAVEMENT MARKERS**
- 1 4 INCH DOUBLE YELLOW CENTERLINE
  - 2 4 INCH WHITE EDGE LINE
  - 3 4 INCH YELLOW EDGE LINE
  - 4 24 INCH WHITE STOP BAR
  - 5 TEMP. REFL. PVMT. MARKERS, 2 WAY AMBER, 40 FEET O/C

REVISIONS		ILLINOIS DEPARTMENT OF TRANSPORTATION ILLINOIS ROUTE 83 FROM THE WISCONSIN STATE LINE TO NORTH OF PETITE LAKE ROAD SUGGESTED CONSTRUCTION STAGING TYPICAL SECTIONS GRASS LAKE ROAD DATE: 1/30/09 DRAWN BY: EUB CHECKED BY: MW
NAME	DATE	
		GRAEF, ANHALT, SCHLOEMER & ASSOCIATES, INC. CHICAGO, ILLINOIS

G:\20004024\_N\mns\dgn\m01sec02.dgn  
 1/26/2009 9:36:50 AM