

F.A. ROUTE NO.	SECTION	COUNTY	TOTAL SHEETS	SHEET NO.
866	*	LAKE	554	93
FED. ROAD DIST. NO.		ILLINOIS FED. AID PROJECT		
*(L-2LW,R);6,6A & 6 EXT) WRS-1				

STAGE III

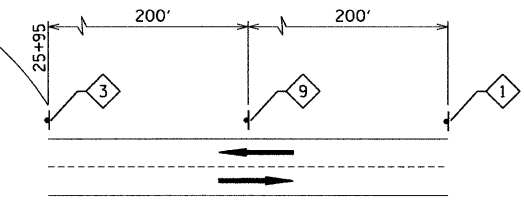
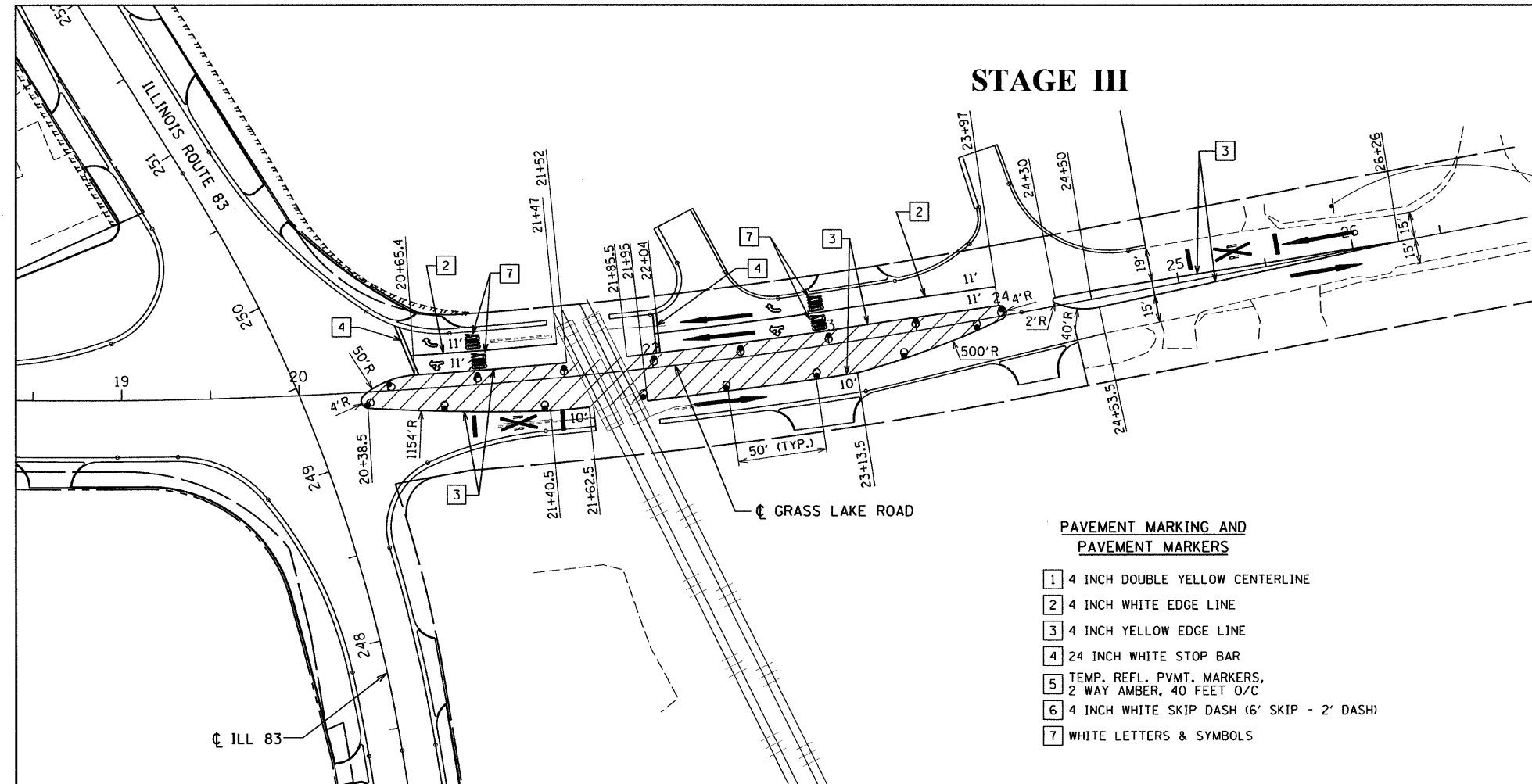

PAVEMENT MARKING AND PAVEMENT MARKERS

- 1 4 INCH DOUBLE YELLOW CENTERLINE
- 2 4 INCH WHITE EDGE LINE
- 3 4 INCH YELLOW EDGE LINE
- 4 24 INCH WHITE STOP BAR
- 5 TEMP. REFL. PVMT. MARKERS, 2 WAY AMBER, 40 FEET O/C
- 6 4 INCH WHITE SKIP DASH (6' SKIP - 2' DASH)
- 7 WHITE LETTERS & SYMBOLS

CONSTRUCTION NOTES

- CONSTRUCT CONCRETE MEDIANS
- INSTALL RAILROAD MEDIAN SIGNAL & GATE
- PLACE BITUMINOUS SURFACE COURSE

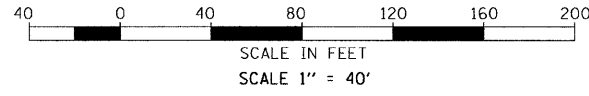

G:\2006\4024_N\ms\p\cnset\mofatf_09.dgn 1/26/2009 9:40:11AM

REVISIONS		ILLINOIS DEPARTMENT OF TRANSPORTATION ILLINOIS ROUTE 83 FROM THE WISCONSIN STATE LINE TO NORTH OF PETITE LAKE ROAD SUGGESTED CONSTRUCTION STAGING GRASS LAKE ROAD EAST OF ILLINOIS ROUTE 83 DRAWN BY: WPD CHECKED BY: MW
NAME	DATE	



GRAEF, ANHALT, SCHLOEMER & ASSOCIATES, INC.
CHICAGO, ILLINOIS