

F.A. ROUTE NO.	SECTION	COUNTY	TOTAL SHEETS	SHEET NO.
866	*	LAKE	554	94
FED. ROAD DIST. NO.		ILLINOIS FED. AID PROJECT		
*(L-2(W,R);6,6A & 6 EXT) WRS-1				

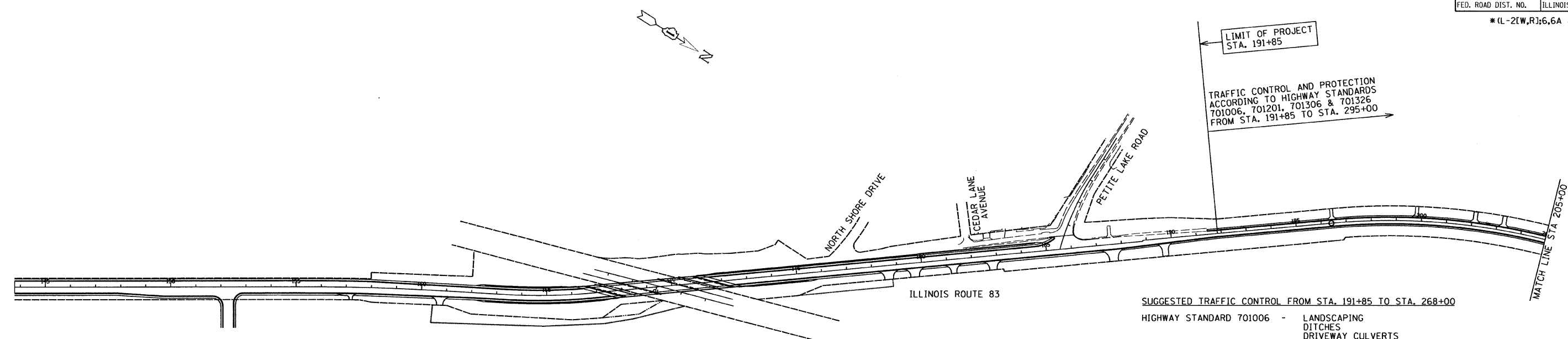

- SUGGESTED TRAFFIC CONTROL FROM STA. 191+85 TO STA. 268+00
- HIGHWAY STANDARD 701006 - LANDSCAPING  
DITCHES  
DRIVEWAY CULVERTS  
CULVERT EXTENSIONS
  - HIGHWAY STANDARD 701201 - STORM SEWER  
CULVERTS  
PATCHING
  - HIGHWAY STANDARD 701306 - PAVEMENT MILLING  
LEVEL BINDER  
PAVING
  - HIGHWAY STANDARD 701326 - PAVEMENT WIDENING  
SHOULDERS  
CURB AND GUTTER
- SEE DRAINAGE AND UTILITY PLANS FOR LOCATIONS
- NOTE: TRAFFIC CONTROL FOR ALL SIDE STREETS IS IN ACCORDANCE WITH THE ABOVE STANDARDS AND DISTRICT ONE STANDARD TC10.

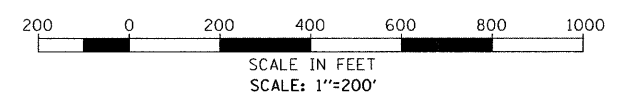
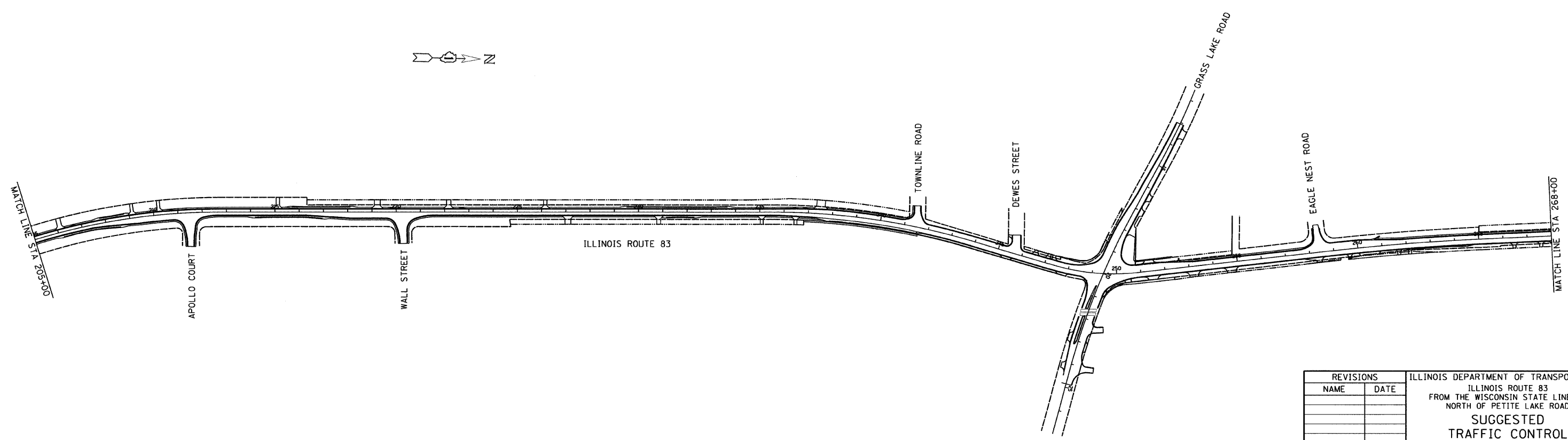

REVISIONS		ILLINOIS DEPARTMENT OF TRANSPORTATION ILLINOIS ROUTE 83 FROM THE WISCONSIN STATE LINE TO NORTH OF PETITE LAKE ROAD SUGGESTED TRAFFIC CONTROL STA 191+85 TO STA 268+00 DATE: 1/30/09
NAME	DATE	
		DRAWN BY: WPD CHECKED BY: MW GRAEF, ANHALT, SCHLOEMER & ASSOCIATES, INC. CHICAGO, ILLINOIS

G:\20004024 N\ms\plan\motalt\_04.dgn 1/26/2009 9:38:14 AM