

| | | | | |
|---------------------------------|---------|---------------------------|--------------|-----------|
| F.A. ROUTE NO. | SECTION | COUNTY | TOTAL SHEETS | SHEET NO. |
| 866 | * | LAKE | 554 | 96 |
| FED. ROAD DIST. NO. | | ILLINOIS FED. AID PROJECT | | |
| *(L-2(LW,R);6,6A & 6 EXT) WRS-1 | | | | |

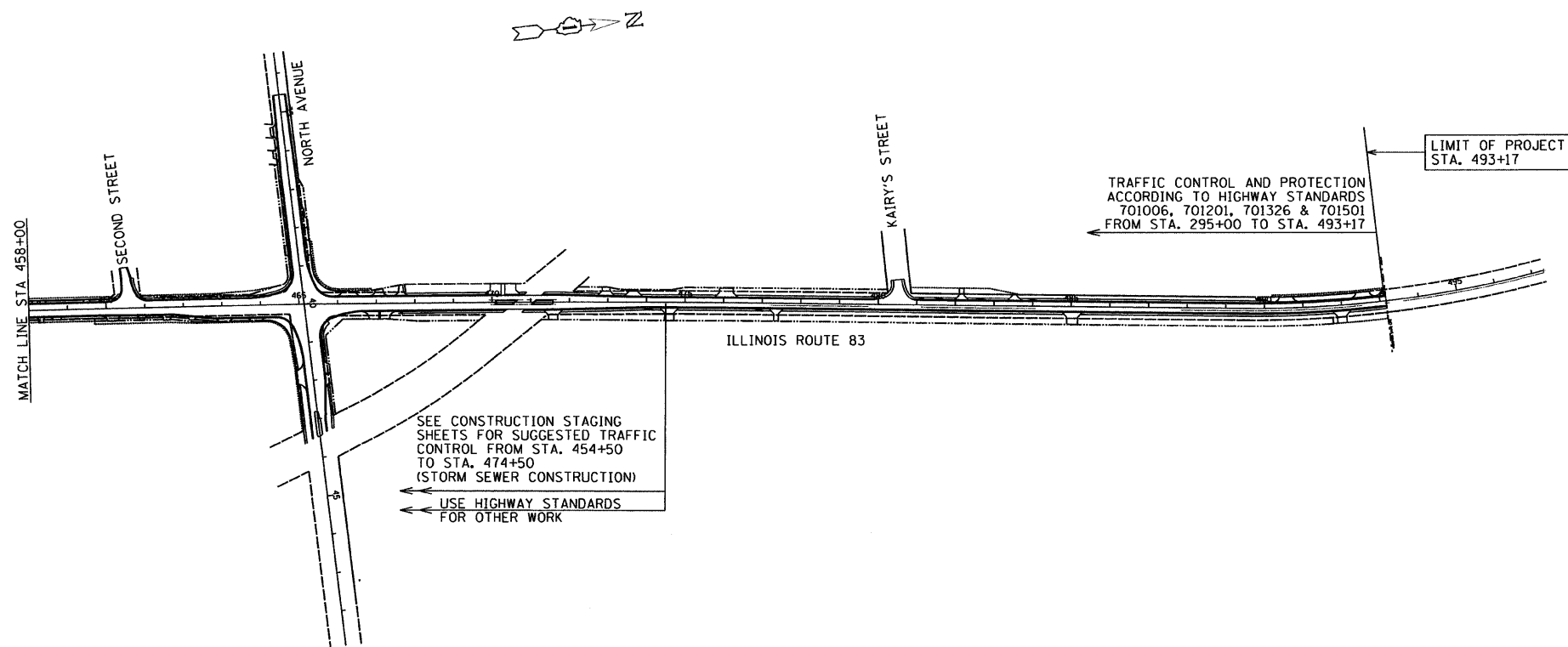

- SUGGESTED TRAFFIC CONTROL FROM STA. 458+00 TO STA. 493+17
- HIGHWAY STANDARD 701006 - LANDSCAPING
DITCHES
DRIVEWAY CULVERTS
CULVERT EXTENSIONS
 - HIGHWAY STANDARD 701201 - STORM SEWER
CULVERTS
PATCHING
 - HIGHWAY STANDARD 701326 - PAVEMENT WIDENING
SHOULDERS
CURB AND GUTTER
 - HIGHWAY STANDARD 701501 - PAVEMENT MILLING
LEVEL BINDER
PAVING
- SEE DRAINAGE AND UTILITY PLANS FOR LOCATIONS
- NOTE: TRAFFIC CONTROL FOR ALL SIDE STREETS IS IN ACCORDANCE WITH THE ABOVE STANDARDS

G:\2000\024-N.ms\p\chset\mofat\06.cgn 1/26/2009 9:35:01 AM

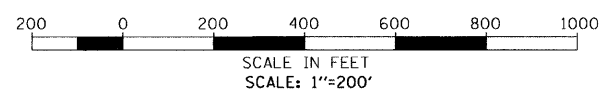

| REVISIONS | | ILLINOIS DEPARTMENT OF TRANSPORTATION ILLINOIS ROUTE 83 FROM THE WISCONSIN STATE LINE TO NORTH OF PETITE LAKE ROAD SUGGESTED TRAFFIC CONTROL STA 458+00 TO STA 495+00 DATE: 1/30/09 |
|-----------|------|--|
| NAME | DATE | |
| | | |
| | | |
| | | |
| | | |
| | | |
| | | |
| | | |
| | | |
| | | |
| | | |

DRAWN BY: WPD
CHECKED BY: MW

GRAEF ANHALT SCHLOEMER
GRAEF, ANHALT, SCHLOEMER & ASSOCIATES, INC.
CHICAGO, ILLINOIS