

F.A. ROUTE NO.	SECTION	COUNTY	TOTAL SHEETS	SHEET NO.
866	*	LAKE	554	261
FED. ROAD DIST. NO.	ILLINOIS FED. AID PROJECT			

*(L-2[W,R];6,6A & 6 EXT) WRS-1

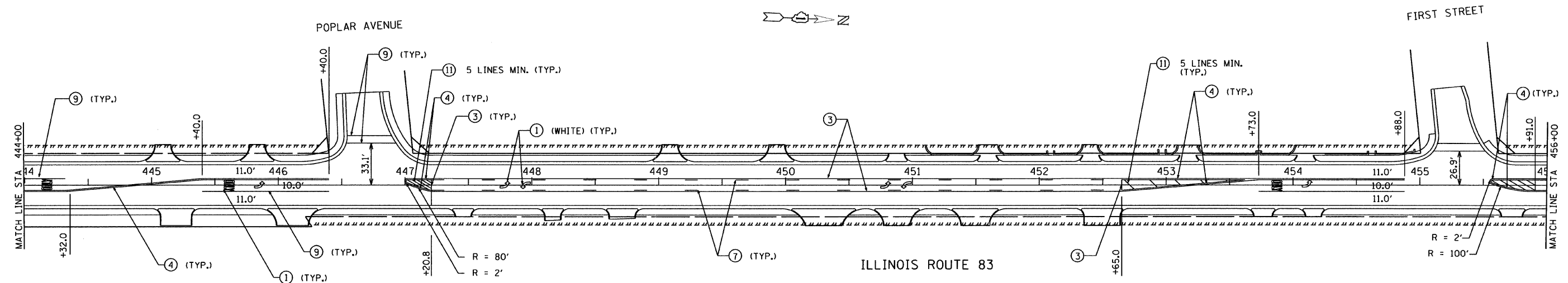
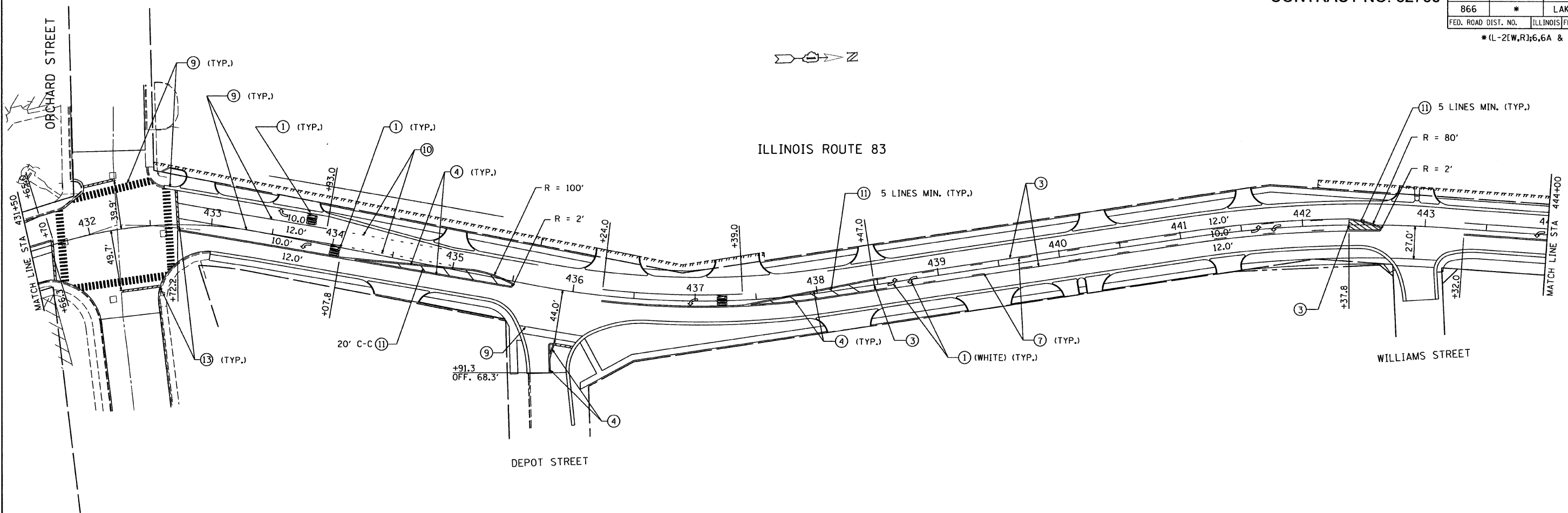

LEGEND:

- | | |
|---|--|
| ① THERMOPLASTIC PAVEMENT MARKING LETTERS AND SYMBOLS | ⑩ THERMOPLASTIC PAVEMENT MARKING - LINE 6" WHITE, 2' DASH, 6' SKIP |
| ② THERMOPLASTIC PAVEMENT MARKING - LINE 4" WHITE | ⑪ THERMOPLASTIC PAVEMENT MARKING - LINE 12" YELLOW |
| ③ THERMOPLASTIC PAVEMENT MARKING - LINE 4" YELLOW | ⑫ THERMOPLASTIC PAVEMENT MARKING - LINE 12" WHITE |
| ④ THERMOPLASTIC PAVEMENT MARKING - LINE 4" YELLOW, 2 AT 11" C-C | ⑬ THERMOPLASTIC PAVEMENT MARKING - LINE 24" WHITE |
| ⑤ THERMOPLASTIC PAVEMENT MARKING - LINE 4" WHITE, 10' DASH, 30' SKIP | |
| ⑥ THERMOPLASTIC PAVEMENT MARKING - LINE 8" WHITE | |
| ⑦ THERMOPLASTIC PAVEMENT MARKING - LINE 4" YELLOW, 10' DASH, 30' SKIP | |
| ⑧ THERMOPLASTIC PAVEMENT MARKING - LINE 5" WHITE | |
| ⑨ THERMOPLASTIC PAVEMENT MARKING - LINE 6" WHITE | |

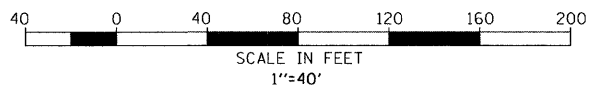

REVISIONS		ILLINOIS DEPARTMENT OF TRANSPORTATION ILLINOIS ROUTE 83 FROM THE WISCONSIN STATE LINE TO NORTH OF PETITE LAKE ROAD PAVEMENT MARKING
NAME	DATE	
		STA 431+50 TO STA 456+00
		DATE: 1/30/09
		DRAWN BY: GP
		CHECKED BY: MW

CRAEF, ANHALT, SCHLOEMER & ASSOCIATES, INC.
CHICAGO, ILLINOIS