

QUANTITY
 4 (100) LINE = 64.1 ft. (19.7 m)
 21.1 sq. ft. (1.97 sq. m)

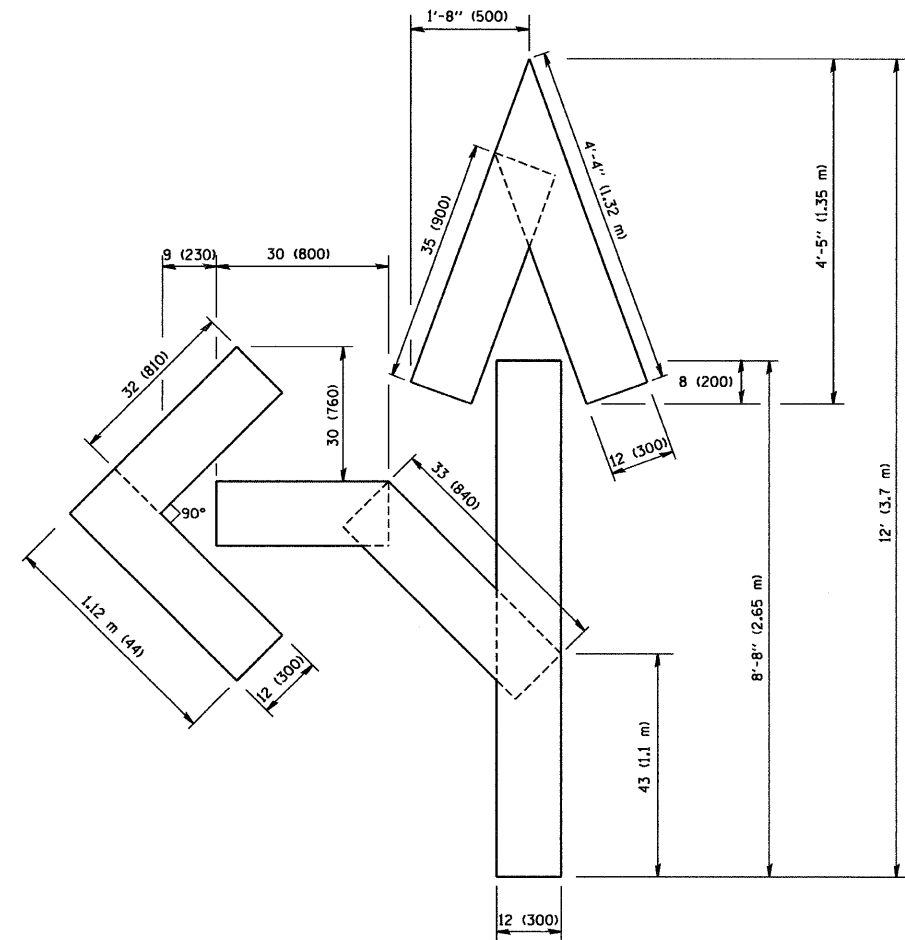

QUANTITY
 4 (100) LINE = 82.5 ft. (25.3 m)
 27.5 sq. ft. (2.53 sq. m)

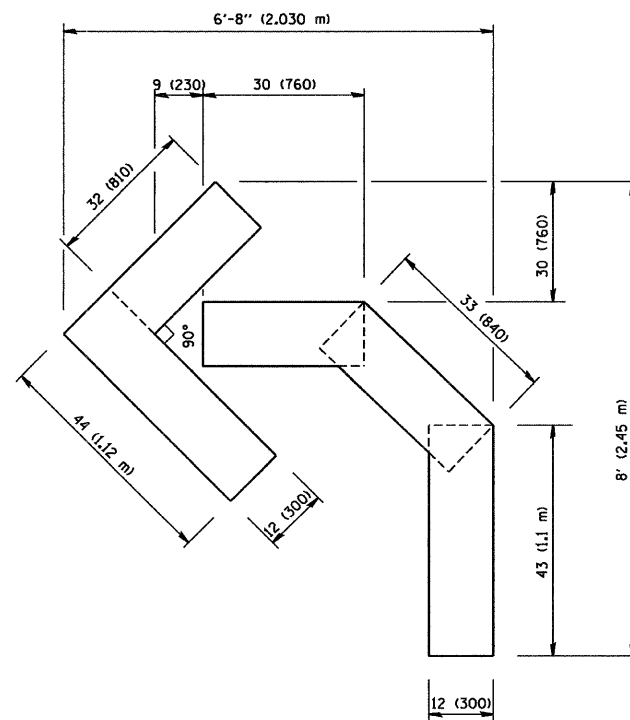

QUANTITY
 4 (100) LINE = 45.5 ft. (13.9 m)
 15.2 sq. ft. (1.39 sq. m)

All dimensions are in inches (millimeters) unless otherwise shown.
 * (L-2 [W, R]; 6, 6A & 6 EXT) WRS-1

FILE NAME = W:\diststd\22x34\tcl6.dgn	USER NAME = gegljanobt	DESIGNED -	REVISED -T, RAMMACHER 06-05-96
		DRAWN -	REVISED -T, RAMMACHER 11-04-97
	PLOT SCALE = 50.0000' / IN.	CHECKED -	REVISED -T, RAMMACHER 03-02-98
	PLOT DATE = 1/4/2008	DATE = 09-18-94	REVISED -E. GOMEZ 08-28-00

**STATE OF ILLINOIS
 DEPARTMENT OF TRANSPORTATION**

**PAVEMENT MARKING LETTERS AND SYMBOLS
 FOR TRAFFIC STAGING**

SCALE: NONE SHEET NO. 1 OF 1 SHEETS STA. TO STA.

F.A. RTE. 866	SECTION *	COUNTY LAKE	TOTAL SHEETS 554	SHEET NO. 335
TC-16		CONTRACT NO. 62700		
FED. ROAD DIST. NO. 1 ILLINOIS FED. AID PROJECT				