

F.A.I. RTE.	SECTION	COUNTY	TOTAL SHEETS	SHEET NO.
94 (1516.1&1717)	I-8	COOK	40	17
STA. 2248+65.17		TO STA. 2258+61.09		
FED. ROAD DIST. NO.	ILLINOIS	FED. AID PROJECT		

62972

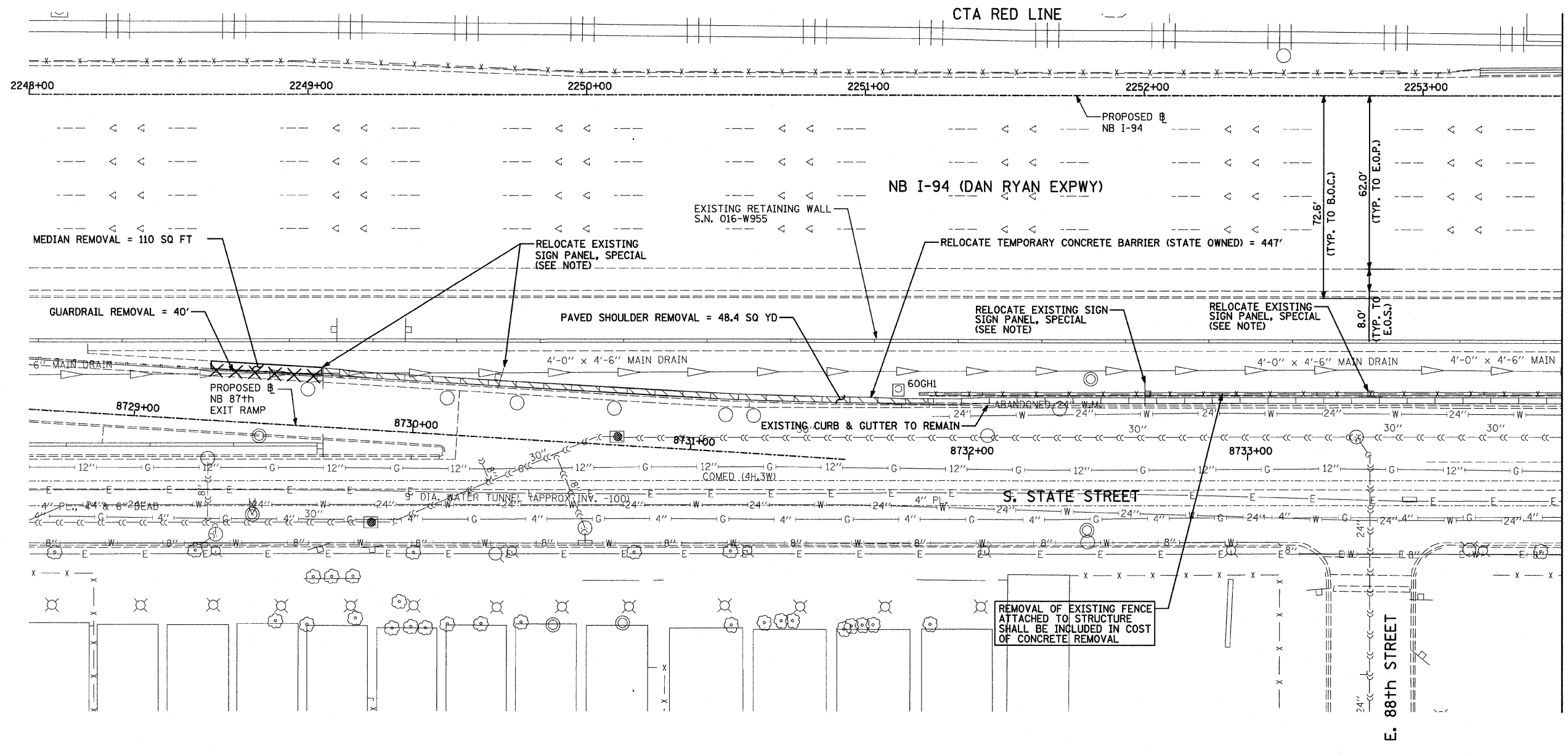

MATCHLINE NB STA. 2253+50.00

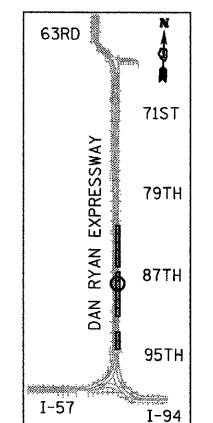

LOCATION MAP

- LEGEND:**
- PAVED SHOULDER REMOVAL
 - CHAIN LINK FENCE REMOVAL
 - CONCRETE BARRIER/GUARDRAIL REMOVAL

NOTE:
 SIGNS SHALL BE LOCATED AT A MINIMUM OF 3 FEET FROM THE FRONT FACE OF THE PROPOSED KNEE WALL OR MOUNTED TO THE FRONT FACE OF THE RECONSTRUCTED PARAPET. EXACT PLACEMENT SHALL BE DETERMINED BY THE ENGINEER. PAID FOR AS "RELOCATE EXISTING SIGN PANEL, SPECIAL".

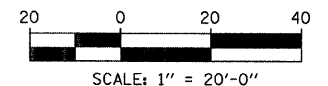

REVISIONS	
NAME	DATE

ILLINOIS DEPARTMENT OF TRANSPORTATION
 F.A.I. 94 (DAN RYAN EXPRESSWAY)
REMOVAL PLAN
 NB I-94 (DAN RYAN EXPRESSWAY)
 STA. 2248+00.00 TO 2253+50.00
 SCALE: 1"=20'
 DATE: OCTOBER 17, 2008
 DRAWN BY: AMB, MAF, TB
 CHECKED BY: TGB, MI

TYLIN INTERNATIONAL

P:\02373\road\2253+50.00\2253+50.00.dwg 10/17/2008 10:45:14 AM