

F.A.I. RTE.	SECTION	COUNTY	TOTAL SHEETS	SHEET NO.
94 (1516.1&1717) I-8	I-8	COOK	40	19
STA. 2248+65.17	TO STA. 2258+61.09			
FED. ROAD DIST. NO.	ILLINOIS	FED. AID PROJECT		

62972

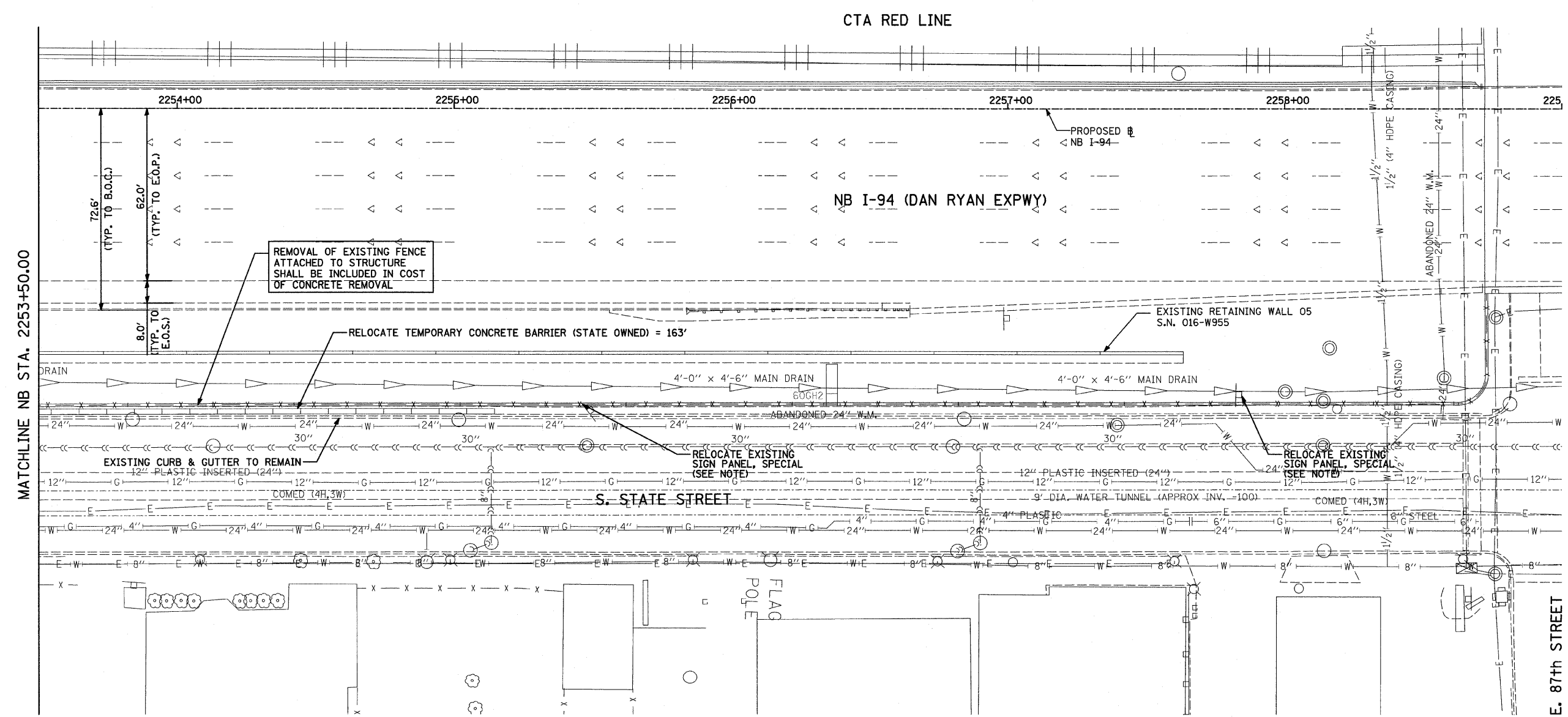
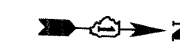

REMOVAL OF EXISTING FENCE ATTACHED TO STRUCTURE SHALL BE INCLUDED IN COST OF CONCRETE REMOVAL

RELOCATE TEMPORARY CONCRETE BARRIER (STATE OWNED) = 163'

EXISTING RETAINING WALL 05 S.N. 016-W955

RELOCATE EXISTING SIGN PANEL, SPECIAL (SEE NOTE)

RELOCATE EXISTING SIGN PANEL, SPECIAL (SEE NOTE)

**LEGEND:**

- PAVED SHOULDER REMOVAL
- CHAIN LINK FENCE REMOVAL
- CONCRETE BARRIER/GUARDRAIL REMOVAL

**NOTE:**

SIGNS SHALL BE LOCATED AT A MINIMUM OF 3 FEET FROM THE FRONT FACE OF THE PROPOSED KNEE WALL OR MOUNTED TO THE FRONT FACE OF THE RECONSTRUCTED PARAPET. EXACT PLACEMENT SHALL BE DETERMINED BY THE ENGINEER. PAID FOR AS "RELOCATE EXISTING SIGN PANEL, SPECIAL".

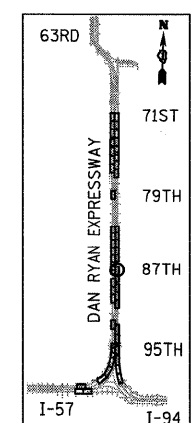

LOCATION MAP

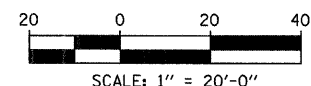

REVISIONS	
NAME	DATE

ILLINOIS DEPARTMENT OF TRANSPORTATION  
 F.A.I. 94 (DAN RYAN EXPRESSWAY)  
**REMOVAL PLAN**  
 NB I-94 (DAN RYAN EXPRESSWAY)  
 STA. 2253+50.00 TO 2259+00.00  
 SCALE: 1"=20'  
 DATE: OCTOBER 17, 2008  
 DRAWN BY: AMB, MAF, TB  
 CHECKED BY: TGB, MI

**TYLIN**INTERNATIONAL

10/17/2008 11:50:08 AM