

PROFILE SURVEYED	BY	DATE
POINTS CHECKED		
B.M. NOTED		
STRUCTURE NOTATING CIP/D		
NO.		

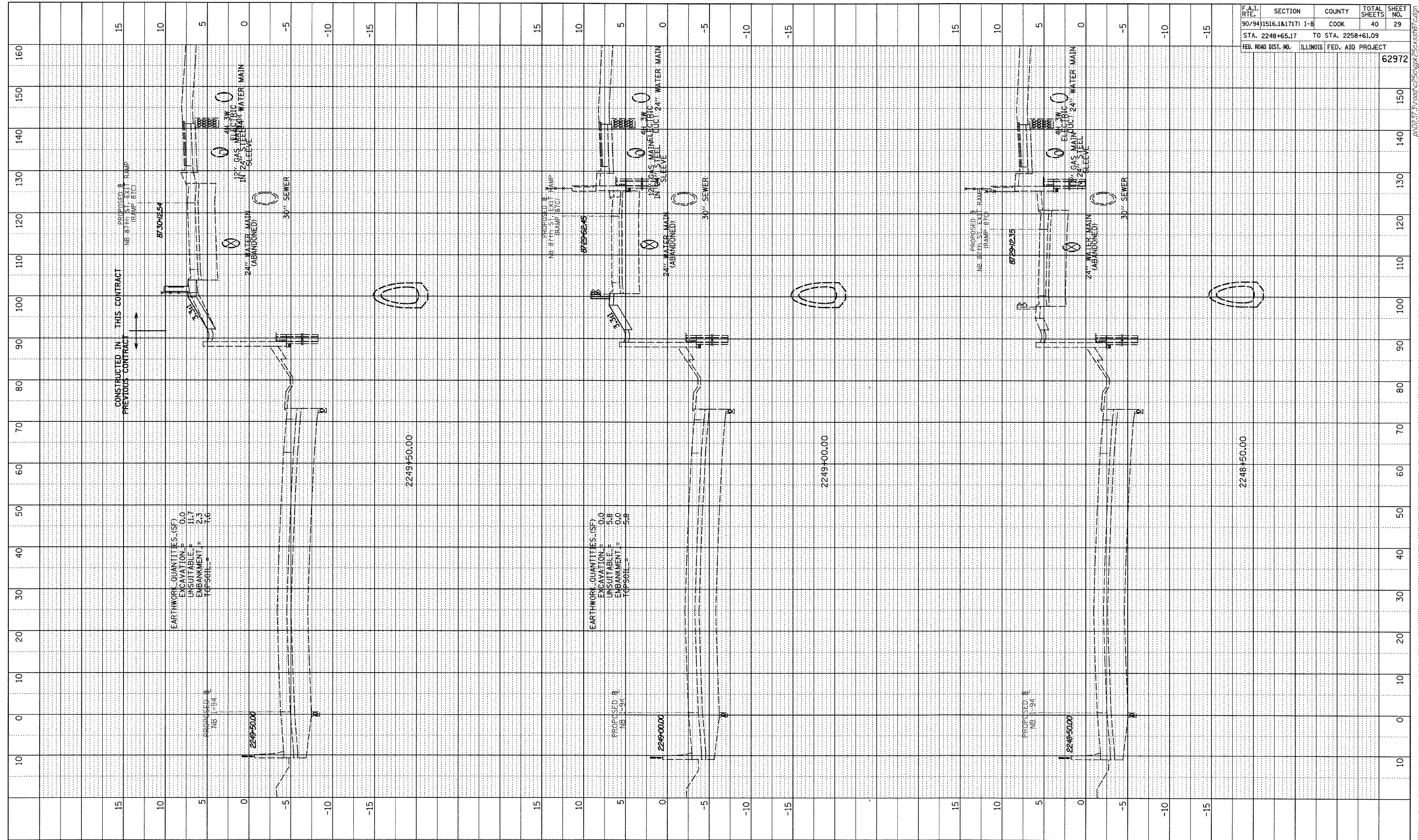

F.A.I. RTE.	SECTION	COUNTY	TOTAL SHEETS	SHEET NO.
90/94 (1516.1&1717) I-B		COOK	40	29
STA. 2248+65.17	TO STA. 2258+61.09			
FED. ROAD DIST. NO.	ILLINOIS FED. AID PROJECT			
			62972	

TYLIN INTERNATIONAL

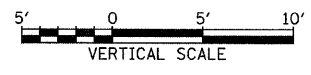
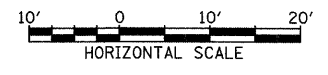

NB I-94 (DAN RYAN EXPRESSWAY)  
STA. 2248+50 TO STA. 2249+50

P:\0237\_3V\road\2550\pk2550\st87c.dgn