

PROFILE SURVEYED BY DATE  
 AS NOTED CHECKED  
 NOTE BOOK NO. DATE  
 B.M. NOTED CHECKED  
 STRUCTURE NOTATIONS C/P/R/D

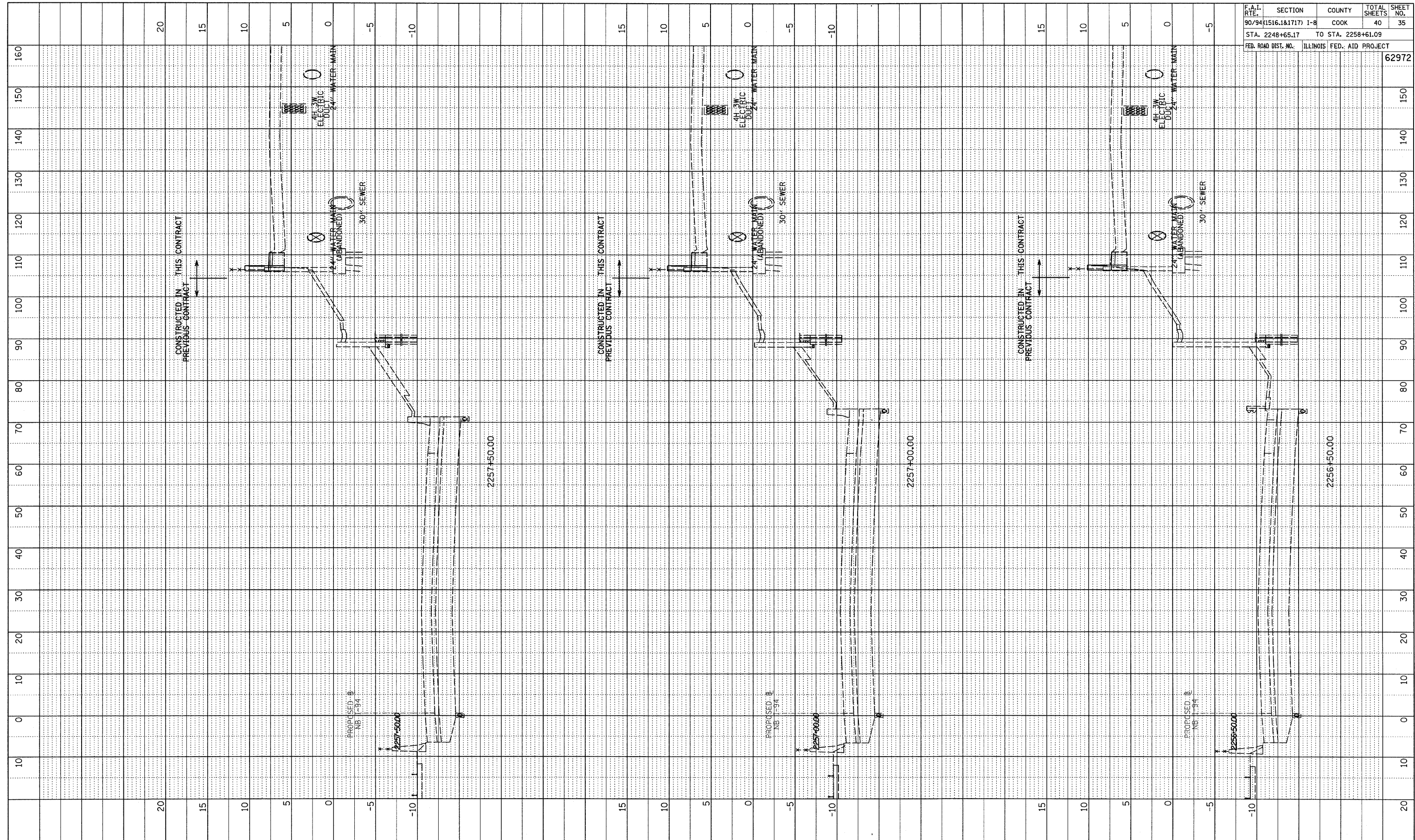

F.A.I. R.T.E.	SECTION	COUNTY	TOTAL SHEETS	SHEET NO.
90/94(1516.1&1717) I-B		COOK	40	35
STA. 2248+65.17	TO STA. 2258+61.09			
FED. ROAD DIST. NO.	ILLINOIS FED. AID PROJECT			

62972

TYLIN INTERNATIONAL

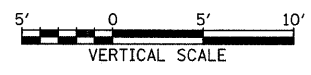
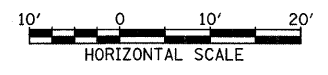

NB I-94 (DAN RYAN EXPRESSWAY)  
 STA. 2256+50 TO STA. 2257+50

R:\02-21-2004\256\256.dwg