

PROJECT BENCHMARKS

- BM NO. 19, EL. 724.233 - (NGVD 1929)
"ALUMINUM DISK" SET IN CONCRETE, 0.10 +/- MILE SOUTH OF GILBERT ST ON EAST SIDE OF ROUTE 25 4' +/- FROM SPLIT RAIL FENCE.
- BM NO. 21, EL. 747.595 - (NGVD 1929)
"BENCH TIE" (YELLOW) SET IN NORTH FACE OF 48" TREE JUST SOUTH OF CONCRETE AND ASPHALT SEAM OF DRIVEWAY FOR RESIDENCE #7N411 DUNHAM RD.
- BM NO. 22, EL. 767.353 - (NGVD 1929)
"CHISELED BOX CUT" SET AT THE TOP OF CONCRETE BRIDGE HEADWALL, AT THE NORTHEAST CORNER OF BRIDGE AT THE SOUTHEAST CORNER OF STEARNS RD AND DUNHAM RD.
- BM NO. 23, EL. 773.041 - (NGVD 1929)
"BENCH TIE" (YELLOW) SET IN NORTH FACE OF 52" TREE ON SOUTH SIDE OF STEARNS RD, 110 +/- EAST OF ASPHALT DRIVE TO RESIDENCE # 33W004.
- BM NO. 24, EL. 762.678 - (NGVD 1929)
"ALUMINUM DISK" SET IN CONCRETE, 0.50 +/- MILE EAST OF STEARNS RD AND DUNHAM RD AT THE SOUTH SIDE OF STEARNS RD.
- BM NO. WA07001, EL. 750.7511 - (NAVD 1988)
DUPAGE COUNTY BENCHMARK
- BM NO. WA05001, EL. 768.1444 - (NAVD 1988)
DUPAGE COUNTY BENCHMARK

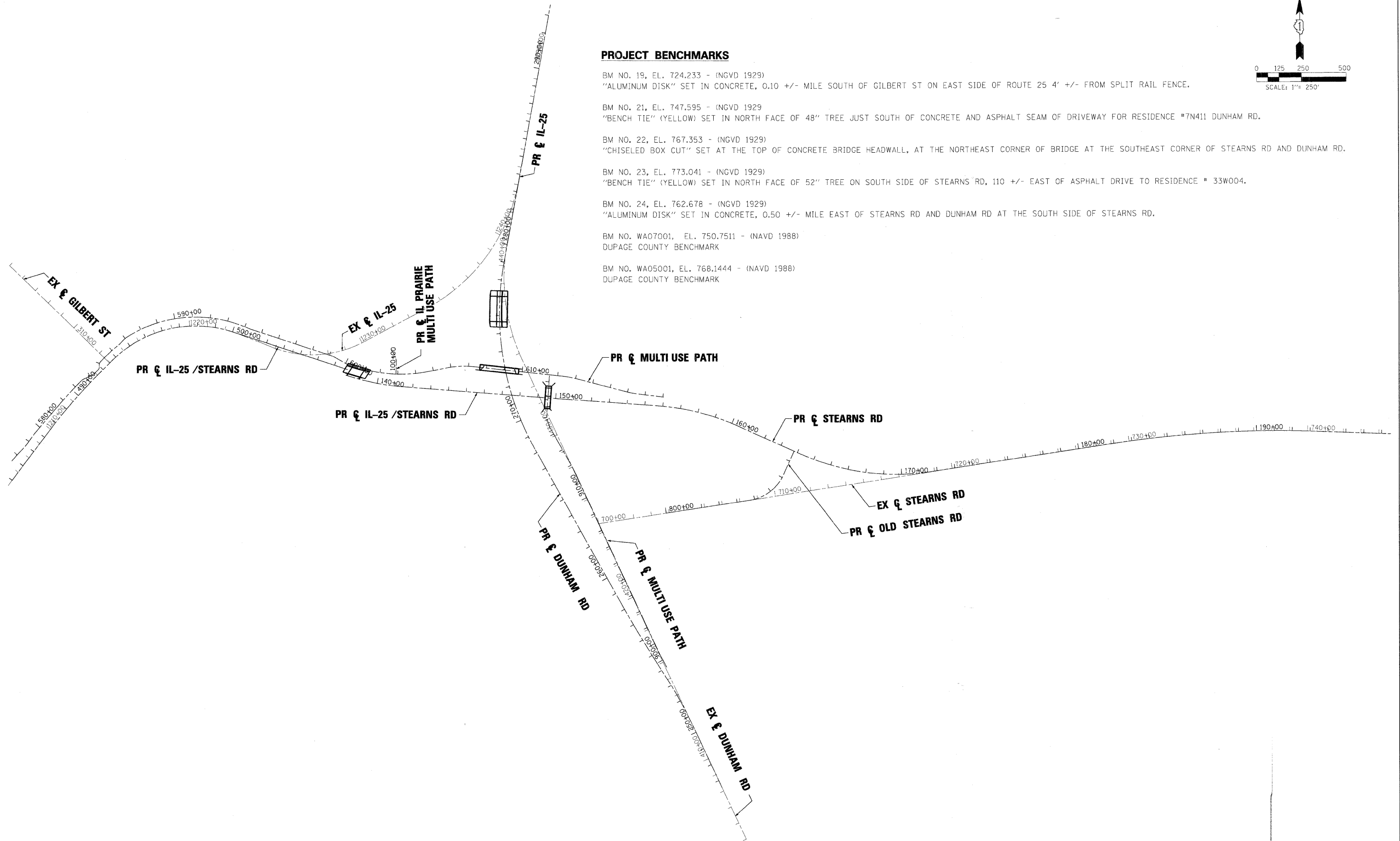

x:\2009\3944\engineering\documents\roadway\alignment_and_ties\pr\in_abc_keiplom.dgn

FILE NAME =	USER NAME = #USER#	DESIGNED - NMM	REVISED -	KANE COUNTY DIVISION OF TRANSPORTATION	OVERALL ALIGNMENT PLAN AND BENCHMARKS	F.A. RTE.	SECTION	COUNTY	TOTAL SHEETS	SHEET NO.	
#FILES#		DRAWN - NMM	REVISED -			361	06-00214-15-BR	KANE/DUPAGE	545	47	
	PLOT SCALE = 250.00' / IN.	CHECKED - JRM	REVISED -			SCALE: SHEET NO. OF SHEETS STA. TO STA.					
	PLOT DATE = 3/30/2009	DATE - 3/31/09	REVISED -			FED. ROAD DIST. NO. ILLINOIS FED. AID PROJECT					