

**LEGEND**

	PAVEMENT REMOVAL
	AGGREGATE REMOVAL (PAID FOR AS EARTH EXCAVATION)
	DRIVEWAY PAVEMENT REMOVAL
	SIDEWALK REMOVAL
	CONCRETE REMOVAL (PAID FOR AS EARTH EXCAVATION)
	BUILDING REMOVAL
	BIKE PATH PAVEMENT REMOVAL
	HOT-MIX ASPHALT SURFACE REMOVAL, VARIABLE DEPTH
	CURB AND GUTTER REMOVAL

	GUARDRAIL REMOVAL
	FENCE REMOVAL
	DRAINAGE PIPE REMOVAL
	TREE REMOVAL
	CATCH BASIN REMOVAL
	MANHOLE REMOVAL
	BOLLARD REMOVAL
	STRUCTURE REMOVAL
	SIGN REMOVAL

\* DENOTES SIGNS REMOVED BY KANE COUNTY. THE CONTRACTOR SHALL CONTACT RAY JOHNSON - KDOT AT 630-669-7912 A MINIMUM OF 72 HOURS PRIOR TO DESIRED TIME OF REMOVAL. THIS SHALL BE DONE AT NO ADDITIONAL COST TO THE CONTRACT

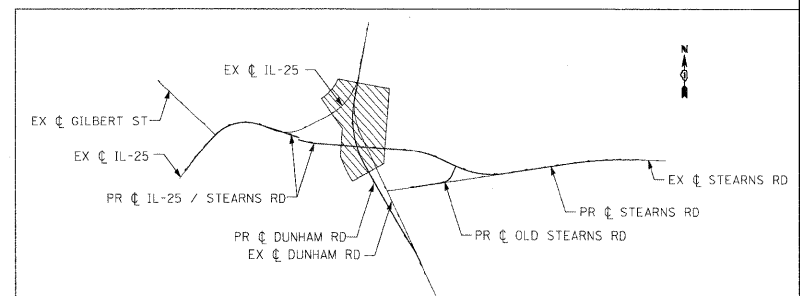

X:\39003\3944\eng\neer\ng\_documents\roads\Removal\p\p\in\_ARC\_DUN\_rsm\_03.dgn

FILE NAME =	USER NAME = #USER#	DESIGNED - NMM	REVISED -	<b>KANE COUNTY DIVISION OF TRANSPORTATION</b>	<b>REMOVAL PLAN DUNHAM ROAD / IL 25</b>	F.A. RTE.	SECTION	COUNTY	TOTAL SHEETS	SHEET NO.	
#FILES#		DRAWN - NMM	REVISED -			361	06-00214-15-BR	KANE/DUPAGE	545	78	
PLOT SCALE = 50,0000' / IN.	CHECKED - RMT	REVISIED -	REVISED -			CONTRACT NO. 63074					
PLOT DATE = 3/30/2009	DATE - 3/31/09	REVISED -	REVISED -			FED. ROAD DIST. NO. ILLINOIS FED. AID PROJECT					