

Benchmark BM-24:  
 "Aluminum Disk" set in concrete, 0.50+ mile east of Stearns Road and  
 Dunham Road at the south side of Stearns Road. Elev. 762.678  
 Existing Structure: None  
 Precast alternate is  
 not allowed.

STATE OF ILLINOIS  
 DEPARTMENT OF TRANSPORTATION

| ROUTE NO. | SECTION | COUNTY | TOTAL SHEETS | SHEET NO. |
|-----------|---------|--------|--------------|-----------|
| -         | -       | KANE   | 545          | 302       |

Contract # 63074

ROADWAY IMPROVEMENTS  
 NOT IN THIS CONTRACT

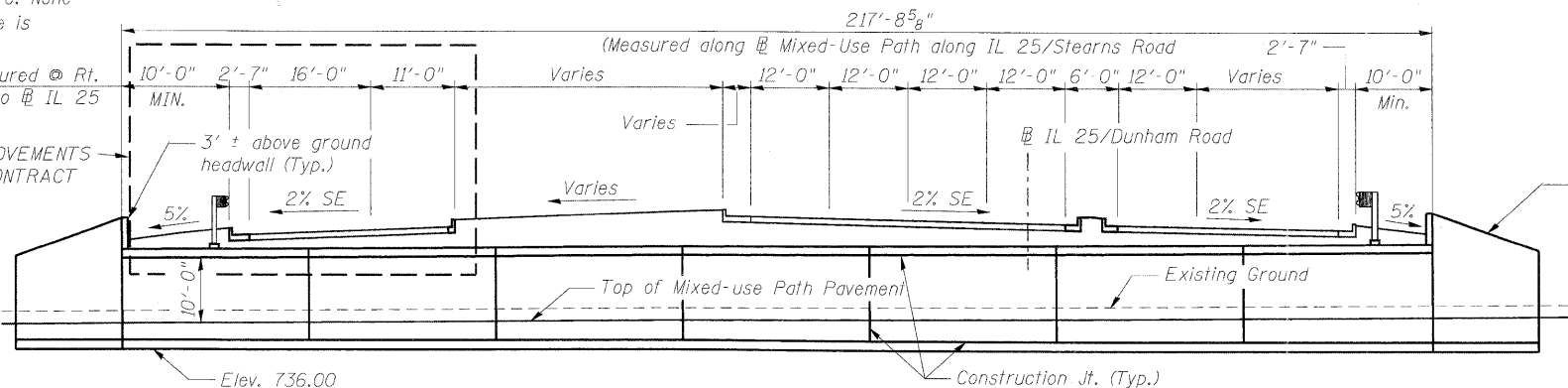

ELEVATION

**LOADING HS-20**  
 Allow 50#/sq. ft. for future wearing surface.

**DESIGN SPECIFICATIONS**  
 AASHTO Standard Specifications for Highway Bridges, 17th edition

**DESIGN STRESSES**

**FIELD UNITS**  
 $f'_c = 3,500$  psi  
 $f_y = 60,000$  psi (Reinforcement)

**MAXIMUM APPLIED BEARING PRESSURE**  
 3,000 psf

**SEISMIC DATA**  
 Seismic Performance Category (SPC) = A  
 Bedrock Acceleration Coefficient (A) = 0.037 g  
 Site Coefficient (S) = 1.0

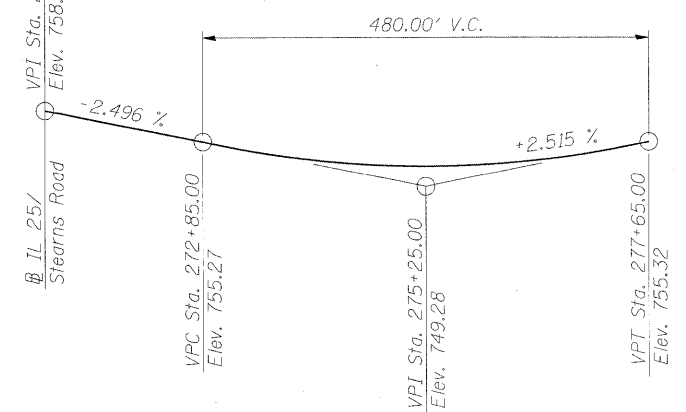

PROFILE GRADE  
 (IL 25/Dunham Road)

STATION 609+05.92  
 BUILT 2011 BY  
 STATE OF ILLINOIS  
 LOADING HS-20  
 STRUCTURE NO. 045-3174

**NAME PLATE**  
 See std. 515001  
 See sheet SB-12 for location

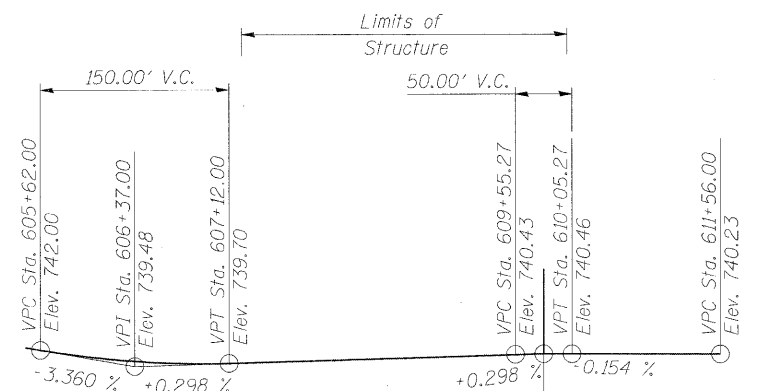

PROFILE GRADE  
 Mixed Use Path along IL 25/Stearns Road (under IL 25/Dunham)

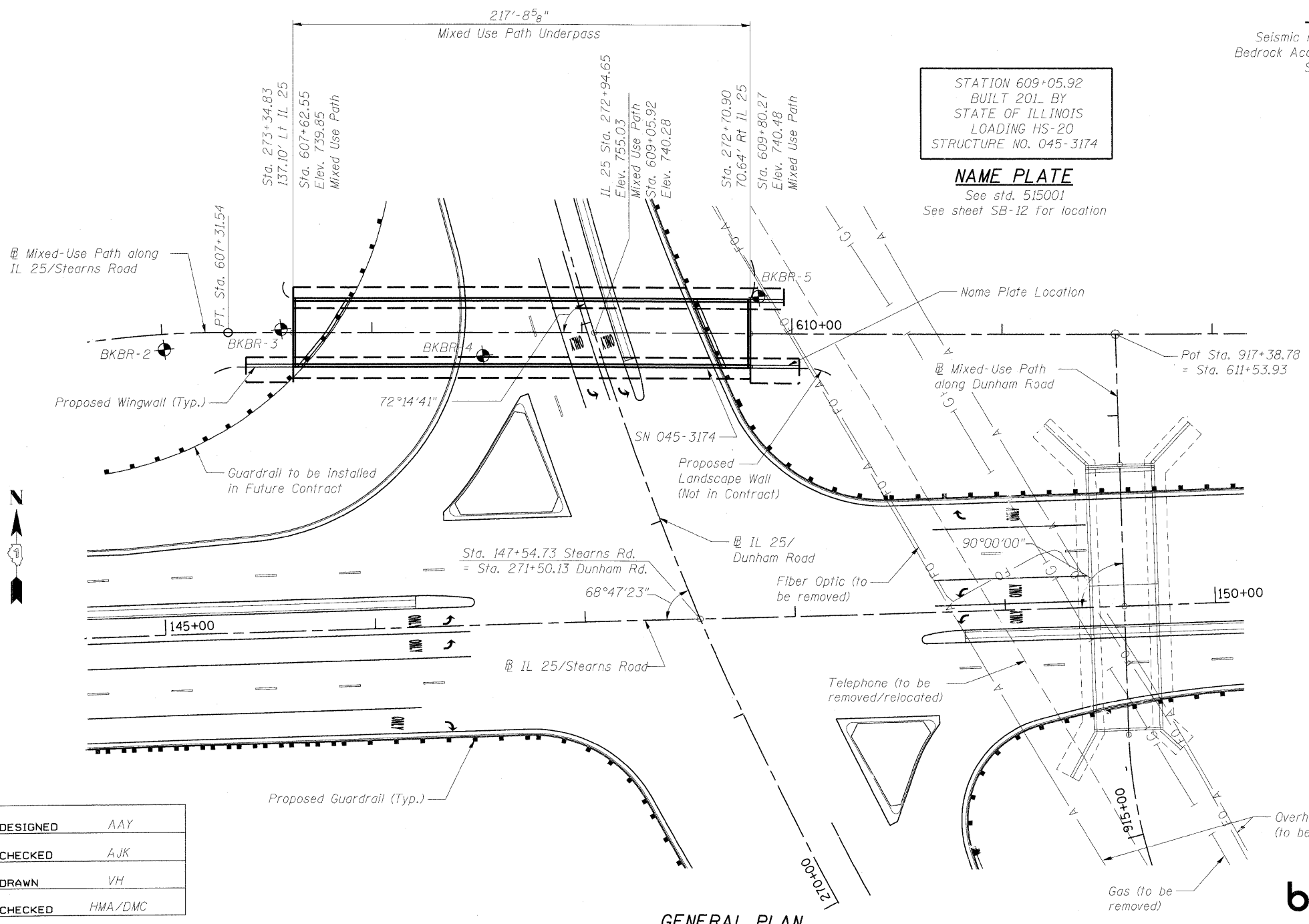

GENERAL PLAN

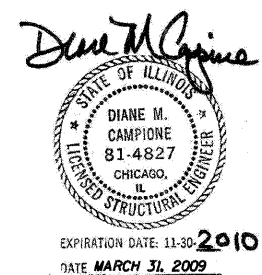

APPROVED  
 FOR STRUCTURAL ADEQUACY ONLY

Ralph E. Anderson  
 Engineer of Bridges and Structures

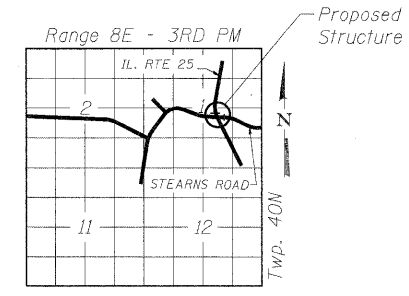

LOCATION SKETCH

**GENERAL PLAN AND ELEVATION  
 MIXED-USE PATH UNDER  
 IL 25/DUNHAM ROAD  
 F.A.P. 360 - SEC. 06-00214-15-BR  
 KANE COUNTY  
 STATION 609+05.92  
 STRUCTURE NO. 045-3174**

|          |         |
|----------|---------|
| DESIGNED | AAY     |
| CHECKED  | AJK     |
| DRAWN    | VH      |
| CHECKED  | HMA/DMC |

**benesch**  
 alfred benesch & company  
 Engineers • Surveyors • Planners  
 205 North Michigan Avenue, Suite 2400  
 Chicago, Illinois 60601  
 312-565-0450  
 Job # 3944