

STATE OF ILLINOIS
DEPARTMENT OF TRANSPORTATION

ROUTE NO.	SECTION	COUNTY	TOTAL SHEETS	SHEET NO.
-	-	KANE	545	324
FED. ROAD DIST. NO. 7		ILLINOIS	FED. AID PROJECT	

Contract # 63074

SHEET SD- 9
OF 34 SHEETS

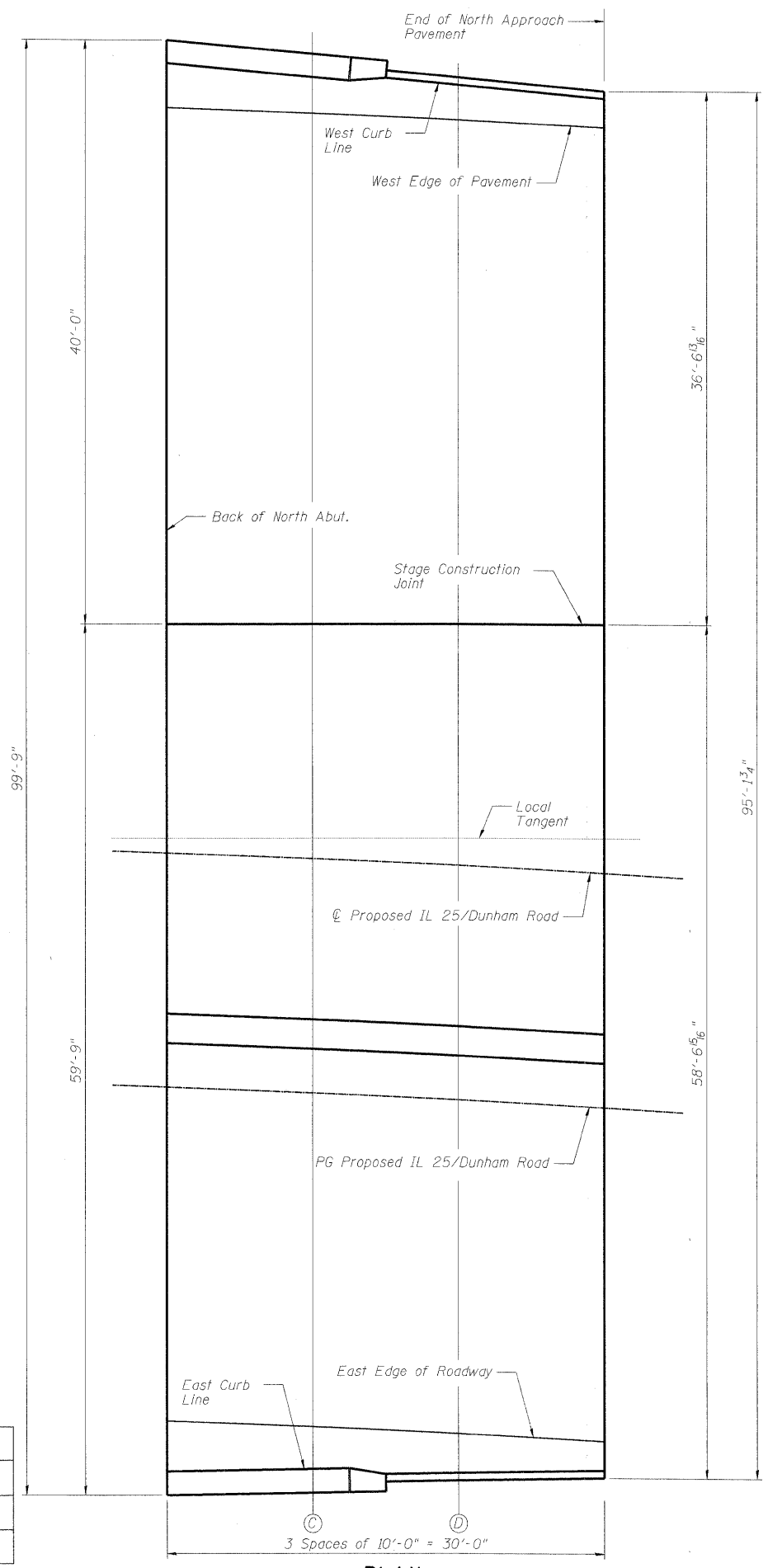

PLAN

DESIGNED	AJK
CHECKED	HMA
DRAWN	AYR
CHECKED	DMC

WEST CURB LINE

Location	Station	Offset	Theoretical Grade Elevations
Back of North Abutment	277+06.11	-54.03	755.40
C	277+15.80	-53.48	755.58
D	277+25.48	-53.42	755.77
End North Approach Pavement	277+35.19	-53.00	755.97

PG IL 25/DUNHAM ROAD

Location	Station	Offset	Theoretical Grade Elevations
Back of North Abutment	277+08.53	15.00	754.06
C	277+18.64	15.00	754.26
D	277+28.75	15.00	754.47
End North Approach Pavement	277+38.86	15.00	754.69

WEST EDGE OF ROADWAY

Location	Station	Offset	Theoretical Grade Elevations
Back of North Abutment	277+06.21	-51.00	755.34
C	277+15.90	-51.00	755.53
D	277+25.59	-51.00	755.73
End North Approach Pavement	277+35.29	-51.00	755.94

EAST EDGE OF ROADWAY

Location	Station	Offset	Theoretical Grade Elevations
Back of North Abutment	277+09.43	39.00	753.60
C	277+19.69	39.00	753.80
D	277+29.96	39.00	754.02
End North Approach Pavement	277+40.24	39.00	754.25

STAGE CONSTRUCTION JOINT

Location	Station	Offset	Theoretical Grade Elevations
Back of North Abutment	277+07.43	-15.64	754.65
C	277+17.33	-16.02	754.86
D	277+27.21	-16.47	755.07
End North Approach Pavement	277+37.09	-16.99	755.29

EAST CURB LINE

Location	Station	Offset	Theoretical Grade Elevations
Back of North Abutment	277+09.56	42.49	753.53
C	277+19.83	41.92	753.75
D	277+30.10	41.70	753.97
End North Approach Pavement	277+40.35	41.00	754.21

Notes:
1. For approach slab details, see sheets SD-29 and SD-30.

**TOP OF NORTH APPROACH
SLAB ELEVATIONS
IL 25/DUNHAM ROAD OVER THE
EAST BRANCH OF BREWSTER CREEK
F.A.P. 360 - SEC. 06-00214-15-BR
KANE COUNTY
STATION 276+36.96
STRUCTURE NO. 045-2032**

benesch
alfred benesch & company
Engineers • Surveyors • Planners
205 North Michigan Avenue, Suite 2400
Chicago, Illinois 60601
312-565-0450
Job # 3944

x:\3900s\3944\engineering\documents\1125-dunham_over_brewster_sn045-2032(inl)_sn045-2034(isb)\final\0452032-63074-009-ase2.dgn

11/2/03 AM

3/30/2009