

FINAL SURVEY PLOTTED AREAS CHECKED

ORIGINAL SURVEY PLOTTED AREAS CHECKED

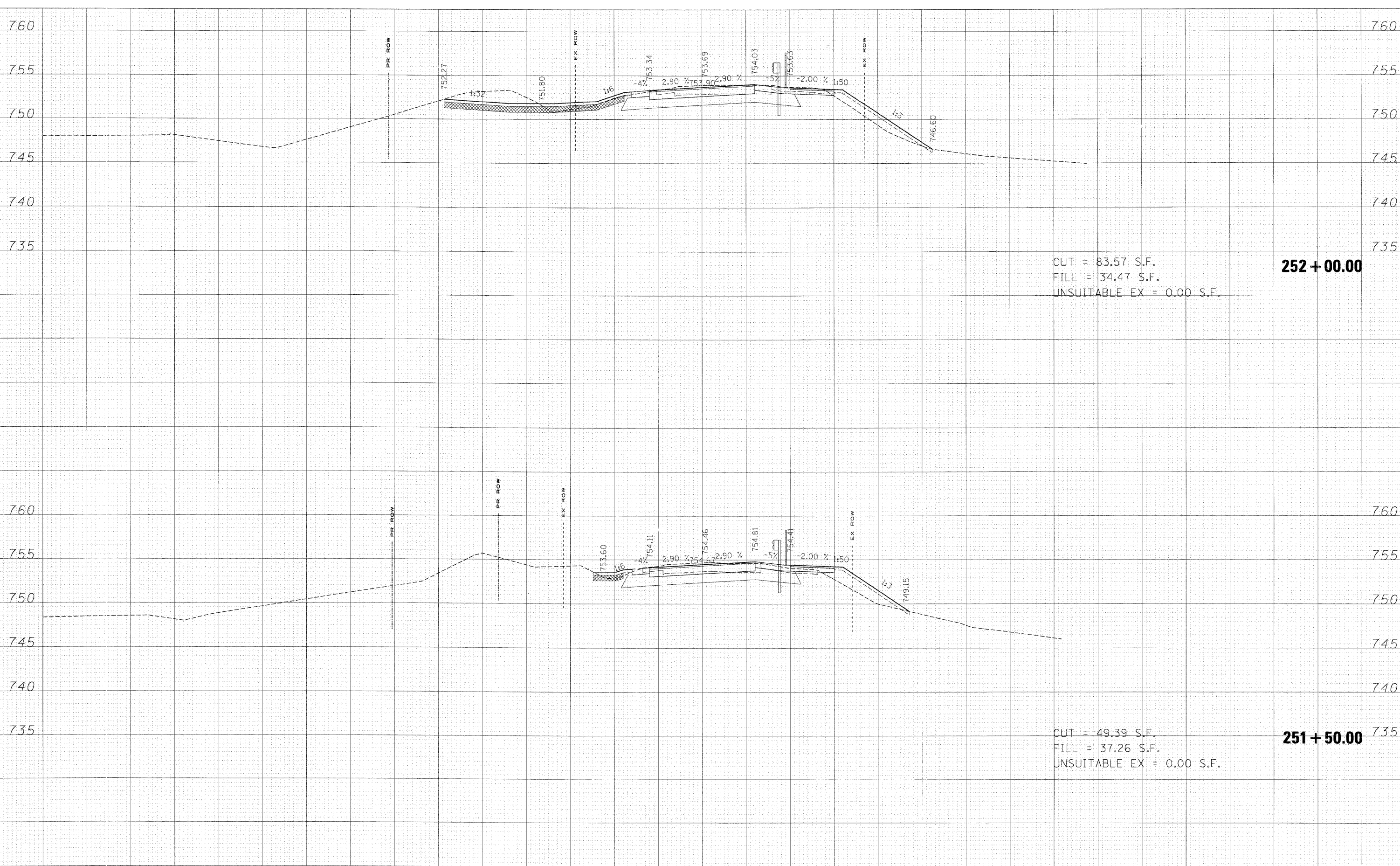

CUT = 83.57 S.F.
 FILL = 34.47 S.F.
 UNSUITABLE EX = 0.00 S.F.

252 + 00.00

CUT = 49.39 S.F.
 FILL = 37.26 S.F.
 UNSUITABLE EX = 0.00 S.F.

251 + 50.00

FILE NAME =	USER NAME = #USER#	DESIGNED - MAC	REVISED -	KANE COUNTY DIVISION OF TRANSPORTATION	DUNHAM ROAD CROSS SECTIONS				F.A. RTE.	SECTION	COUNTY	TOTAL SHEETS	SHEET NO.
FILES	PLOT SCALE = 10.0000' / IN.	DRAWN - MAC	REVISED -		SCALE:	SHEET NO.	OF	SHEETS	361	06-00214-15-BR	KANE/DUPAGE	545	383
	PLOT DATE = 3/31/2009	CHECKED - JJT	REVISED -		STA. 251+50.00	TO	STA. 252+00.00	FED. ROAD DIST. NO.	CONTRACT NO. 63074				
		DATE - 3/31/09	REVISED -					[ILLINOIS] FED. AID PROJECT					