

FINAL SURVEY SURVEYED PLOTTED TEMPLATE AREAS CHECKED
 NOTE BOOK NO.

ORIGINAL SURVEY SURVEYED PLOTTED TEMPLATE AREAS CHECKED
 NOTE BOOK NO.

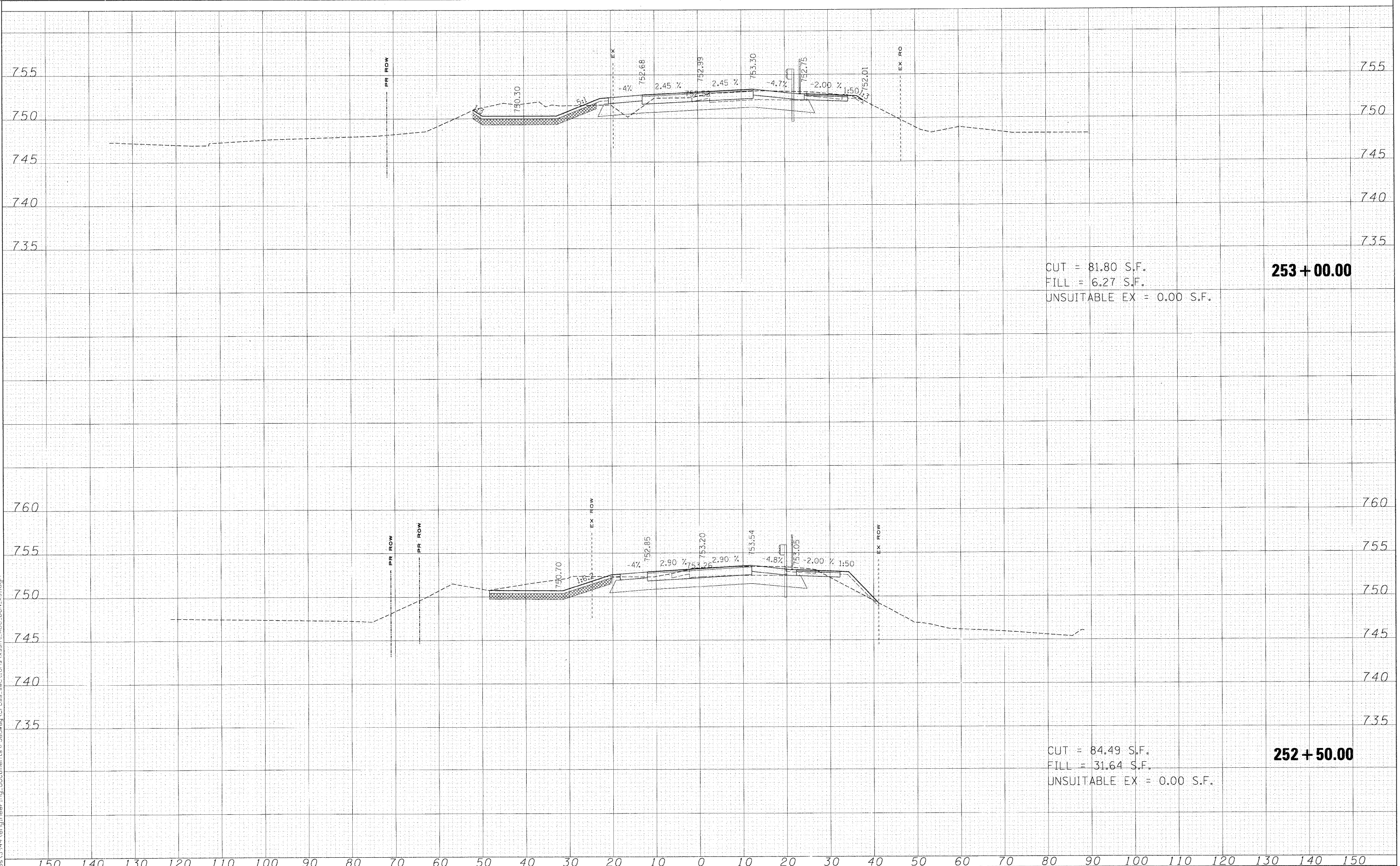

CUT = 81.80 S.F.
 FILL = 6.27 S.F.
 UNSUITABLE EX = 0.00 S.F.
253 + 00.00

CUT = 84.49 S.F.
 FILL = 31.64 S.F.
 UNSUITABLE EX = 0.00 S.F.
252 + 50.00

| | | | | | | | | | | | | | |
|-------------|--------------------|----------------|-----------|---|-----------------------------------|-------------------|----|--------|---------------------------|----------------|-------------|--------------|-----------|
| FILE NAME = | USER NAME = #USER* | DESIGNED - MAC | REVISED - | KANE COUNTY DIVISION OF TRANSPORTATION | DUNHAM ROAD CROSS SECTIONS | | | | F.A. RTE. | SECTION | COUNTY | TOTAL SHEETS | SHEET NO. |
| #FILES* | | DRAWN - MAC | REVISED - | | SCALE: | SHEET NO. | OF | SHEETS | 361 | 06-00214-15-BR | KANE/DUPAGE | 545 | 384 |
| | | CHECKED - JJT | REVISED - | | STA. 252+50.00 | TO STA. 253+00.00 | | | CONTRACT NO. 63074 | | | | |
| | | DATE - 3/31/09 | REVISED - | | | | | | ILLINOIS FED. AID PROJECT | | | | |