

FINAL SURVEY PLOTTED TEMPLATE AREAS CHECKED

ORIGINAL SURVEY PLOTTED TEMPLATE AREAS CHECKED

x:\3900s\3944\engineering\documents\Roads\Cross Sections\sheet-ABC.DUN.xls.dgn

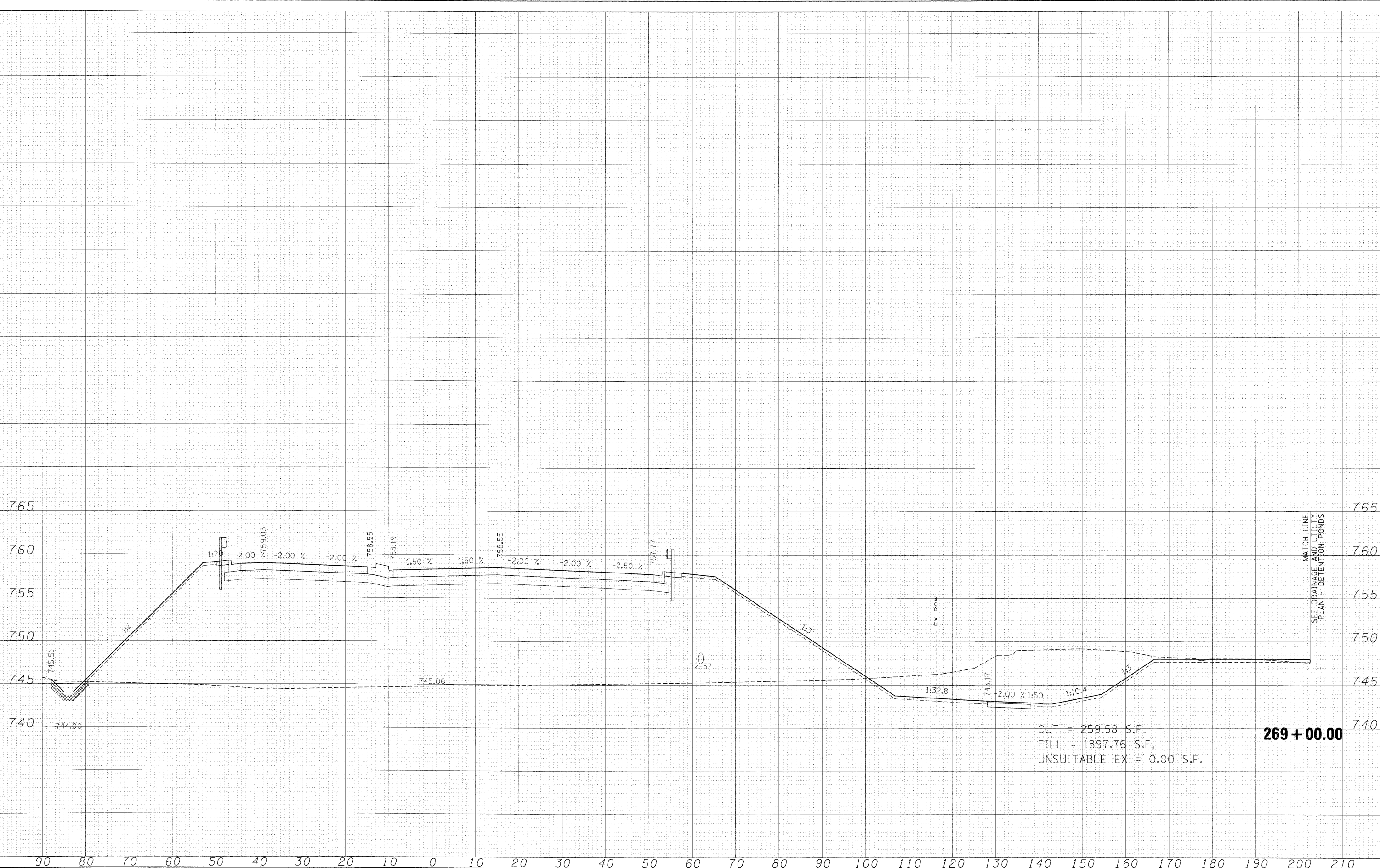

CUT = 259.58 S.F.  
 FILL = 1897.76 S.F.  
 UNSUITABLE EX = 0.00 S.F.

**269 + 00.00**

FILE NAME =  
 #FILES#

USER NAME = \*USER\*  
 PLOT SCALE = 10.0000' / 1" IN.  
 PLOT DATE 3/30/2009

DESIGNED - MAC  
 DRAWN - MAC  
 CHECKED - JJT  
 DATE - 3/31/09

REVISED -  
 REVISED -  
 REVISED -  
 REVISED -

**KANE COUNTY  
 DIVISION OF TRANSPORTATION**

**DUNHAM ROAD CROSS SECTIONS**

SCALE: SHEET NO. OF SHEETS STA. 269+00.00 TO STA. 269+00.00

|                                                 |                |             |              |           |
|-------------------------------------------------|----------------|-------------|--------------|-----------|
| F.A. RTE.                                       | SECTION        | COUNTY      | TOTAL SHEETS | SHEET NO. |
| 361                                             | 06-00214-15-BR | KANE/DUPAGE | 545          | 410       |
| CONTRACT NO. 63074                              |                |             |              |           |
| FED. ROAD DIST. NO. [ILLINOIS] FED. AID PROJECT |                |             |              |           |