

DATE: _____
 SURVEYED _____
 CHECKED _____
 NOTE BOOK _____
 AREAS CHECKED _____
 NO. _____

DATE: _____
 SURVEYED _____
 CHECKED _____
 NOTE BOOK _____
 AREAS CHECKED _____
 NO. _____

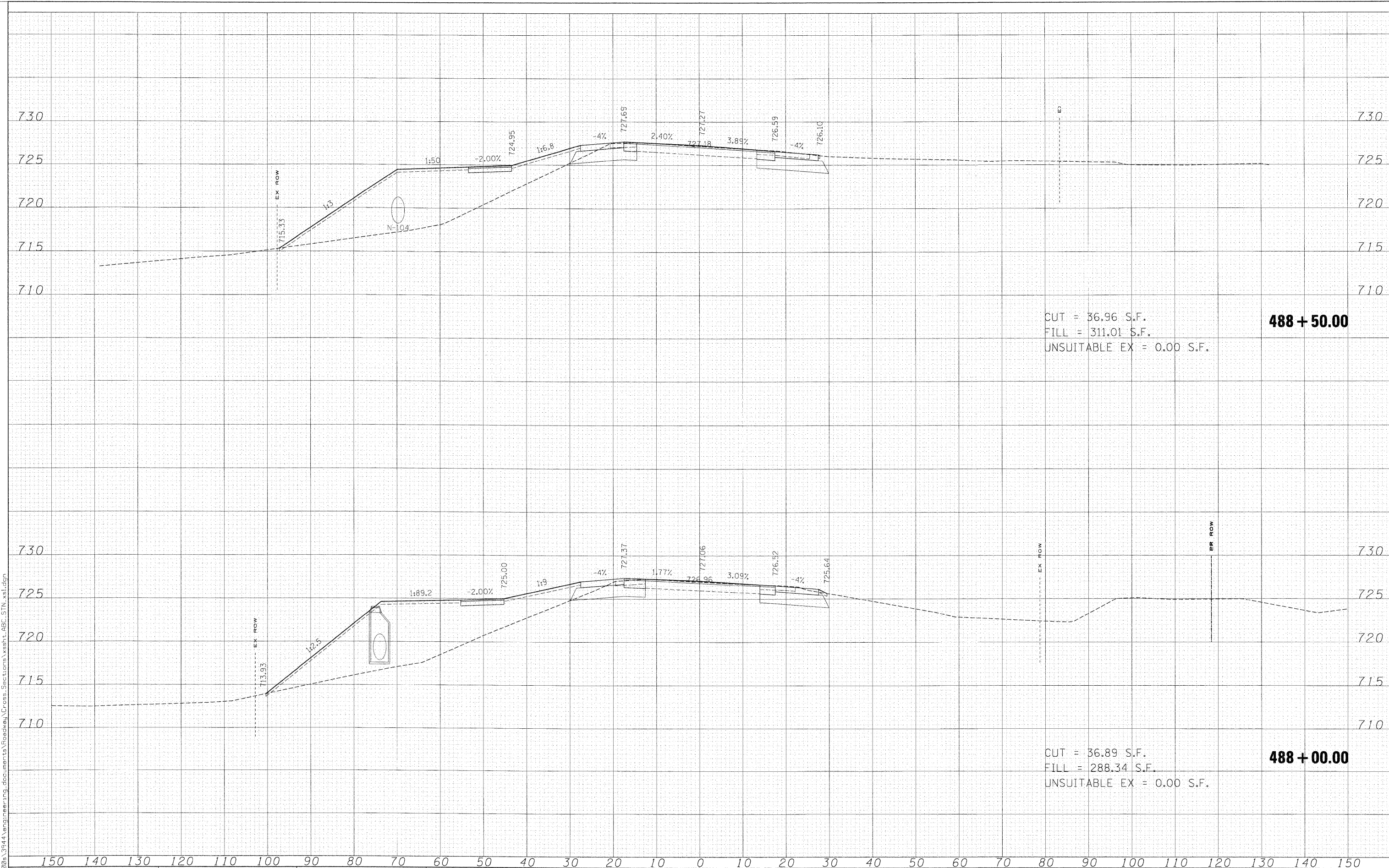

CUT = 36.96 S.F.
 FILL = 311.01 S.F.
 UNSUITABLE EX = 0.00 S.F.
488 + 50.00

CUT = 36.89 S.F.
 FILL = 288.34 S.F.
 UNSUITABLE EX = 0.00 S.F.
488 + 00.00

FILE NAME = x:\3900a\3944\engineering\documents\Roadway\Cross-Sections\sshts\ABC.STN_488.dgn
 FILES

USER NAME = *USER*	DESIGNED - MAC	REVISED -
PLOT SCALE = 10.0000' / IN.	DRAWN - MAC	REVISED -
PLOT DATE = 3/30/2009	CHECKED - JJT	REVISED -
	DATE - 3/31/09	REVISED -

**KANE COUNTY
 DIVISION OF TRANSPORTATION**

STEARNS ROAD CROSS SECTIONS

SCALE: SHEET NO. OF SHEETS STA. 488+00.00 TO STA. 488+50.00

F.A. RTE.	SECTION	COUNTY	TOTAL SHEETS	SHEET NO.
361	06-00214-15-BR	KANE/DUPAGE	545	446
CONTRACT NO. 63074				

FED. ROAD DIST. NO. ILLINOIS FED. AID PROJECT