

|         |  |
|---------|--|
| DATE    |  |
| FINAL   |  |
| CHECKED |  |
| SURVEY  |  |
| NOTED   |  |
| BOOK    |  |
| NO.     |  |
| AREAS   |  |
| CHECKED |  |

|          |  |
|----------|--|
| DATE     |  |
| ORIGINAL |  |
| SURVEY   |  |
| NOTED    |  |
| BOOK     |  |
| NO.      |  |
| AREAS    |  |
| CHECKED  |  |

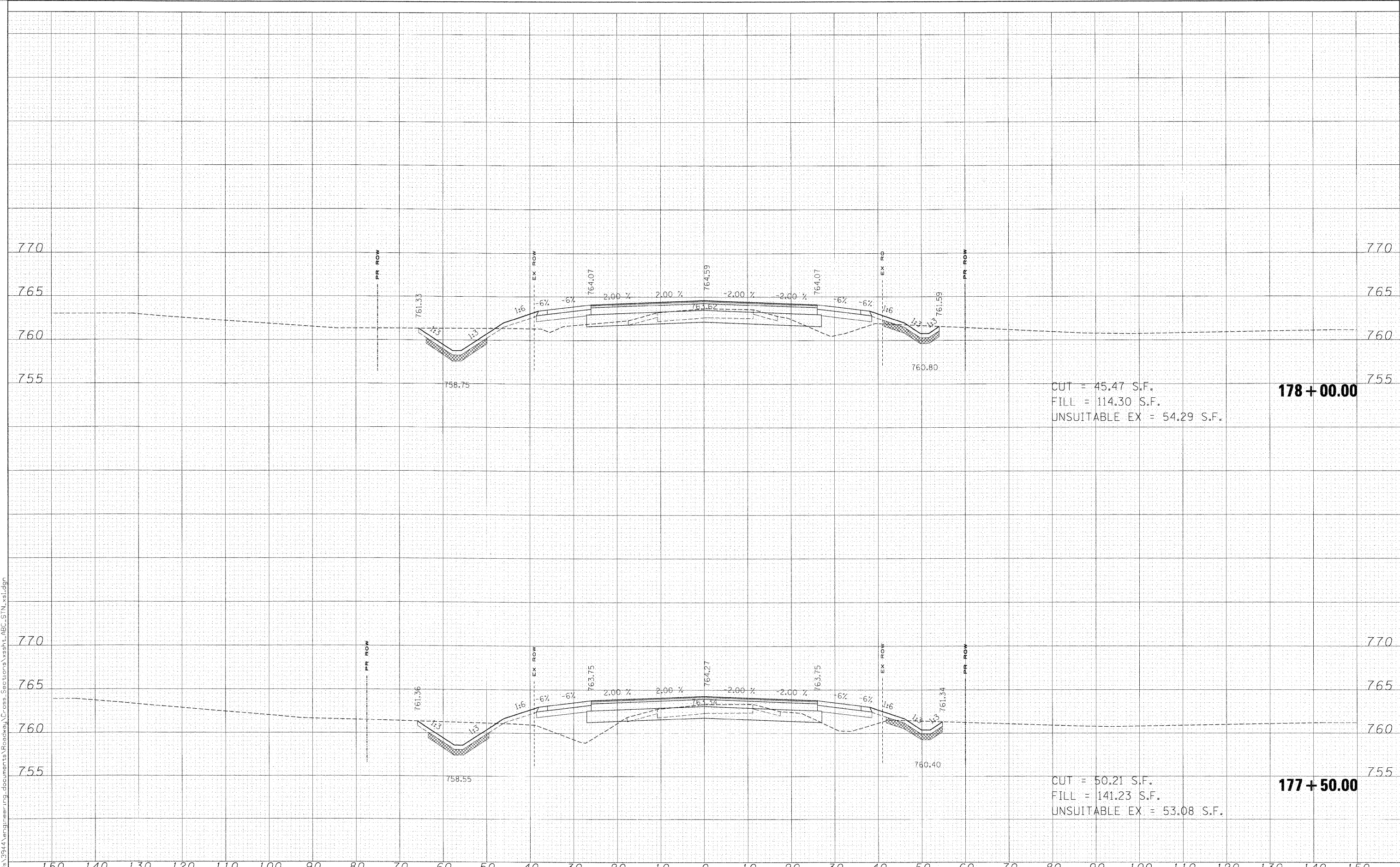

CUT = 45.47 S.F.  
 FILL = 114.30 S.F.  
 UNSUITABLE EX = 54.29 S.F.

**178 + 00.00**

CUT = 50.21 S.F.  
 FILL = 141.23 S.F.  
 UNSUITABLE EX = 53.08 S.F.

**177 + 50.00**

FILE NAME =  
 #FILES#

USER NAME = #USER#  
 DESIGNED - MAC  
 DRAWN - MAC  
 CHECKED - JJT  
 DATE - 3/31/09

REVISED -  
 REVISED -  
 REVISED -  
 REVISED -

**KANE COUNTY  
 DIVISION OF TRANSPORTATION**

**STEARNS ROAD CROSS SECTIONS**

SCALE: SHEET NO. OF SHEETS STA. 177+50.00 TO STA. 178+00.00

| F.A. RTE.                                     | SECTION        | COUNTY      | TOTAL SHEETS       | SHEET NO. |
|---|----------------|-------------|--------------------|-----------|
| 361   | 06-00214-15-BR | KANE/DUPAGE | 545                | 511       |
| FED. ROAD DIST. NO. ILLINOIS FED. AID PROJECT |                |             | CONTRACT NO. 63074 |           |