

FINAL SURVEY PLOTTED TEMPLATE AREAS CHECKED

ORIGINAL SURVEY PLOTTED TEMPLATE AREAS CHECKED

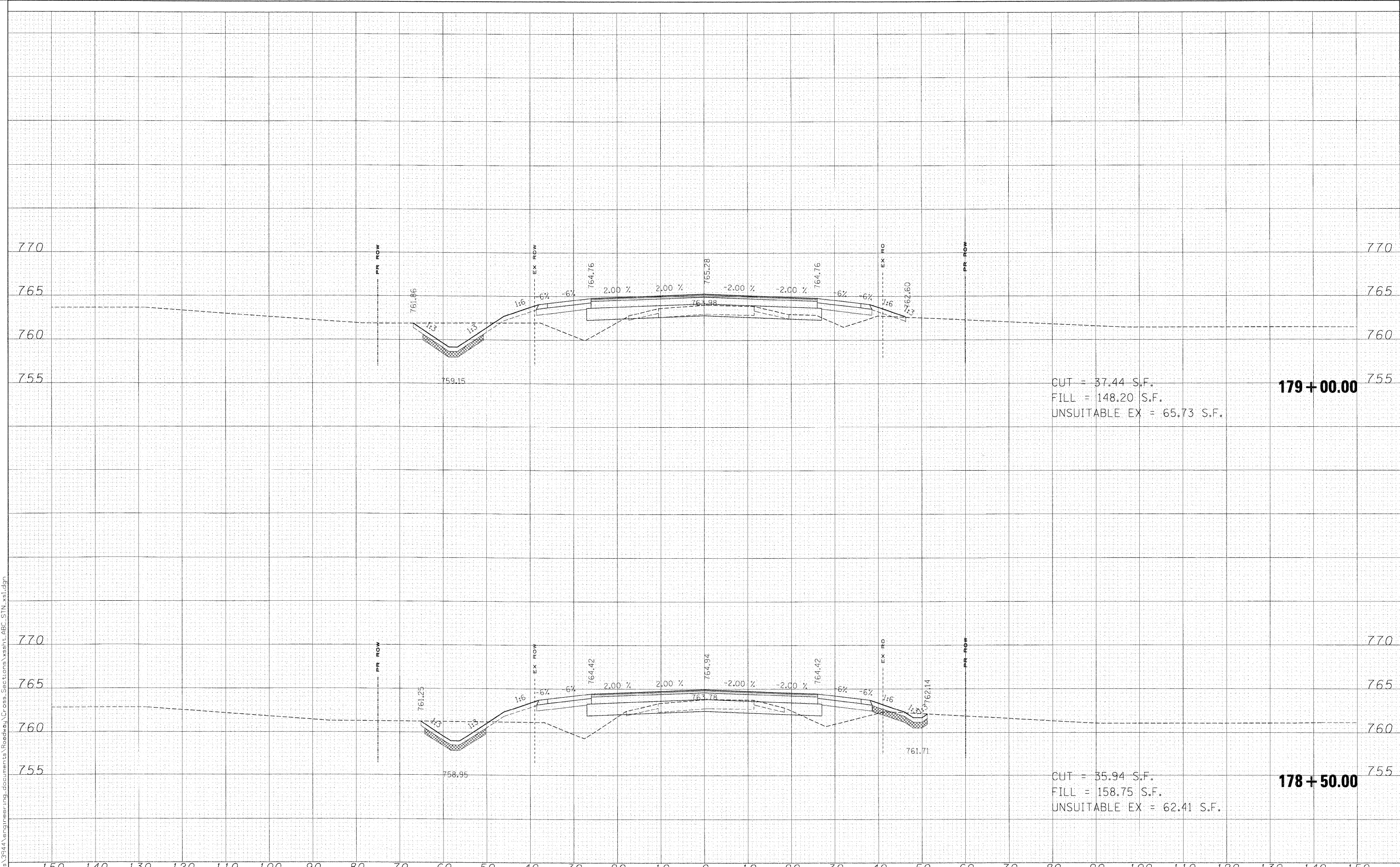

CUT = 37.44 S.F.
 FILL = 148.20 S.F.
 UNSUITABLE EX = 65.73 S.F.

179 + 00.00

CUT = 35.94 S.F.
 FILL = 158.75 S.F.
 UNSUITABLE EX = 62.41 S.F.

178 + 50.00

FILE NAME =
 #FILES#

USER NAME = #USER#
 PLOT SCALE = 10,000.00' / IN.
 PLOT DATE = 3/30/2009

DESIGNED - MAC
 DRAWN - MAC
 CHECKED - JJT
 DATE - 3/31/09

REVISED -
 REVISED -
 REVISED -
 REVISED -

**KANE COUNTY
 DIVISION OF TRANSPORTATION**

STEARNS ROAD CROSS SECTIONS

SCALE: SHEET NO. OF SHEETS STA. 178+50.00 TO STA. 179+00.00

F.A. RTE.	SECTION	COUNTY	TOTAL SHEETS	SHEET NO.
361	06-00214-15-BR	KANE/DUPAGE	545	512
FED. ROAD DIST. NO. ILLINOIS FED. AID PROJECT			CONTRACT NO. 63074	