

DATE: \_\_\_\_\_  
 SURVEYED \_\_\_\_\_  
 PLOTTED \_\_\_\_\_  
 NOTE BOOK \_\_\_\_\_  
 AREAS CHECKED \_\_\_\_\_  
 NO. \_\_\_\_\_

DATE: \_\_\_\_\_  
 SURVEYED \_\_\_\_\_  
 PLOTTED \_\_\_\_\_  
 NOTE BOOK \_\_\_\_\_  
 AREAS CHECKED \_\_\_\_\_  
 NO. \_\_\_\_\_

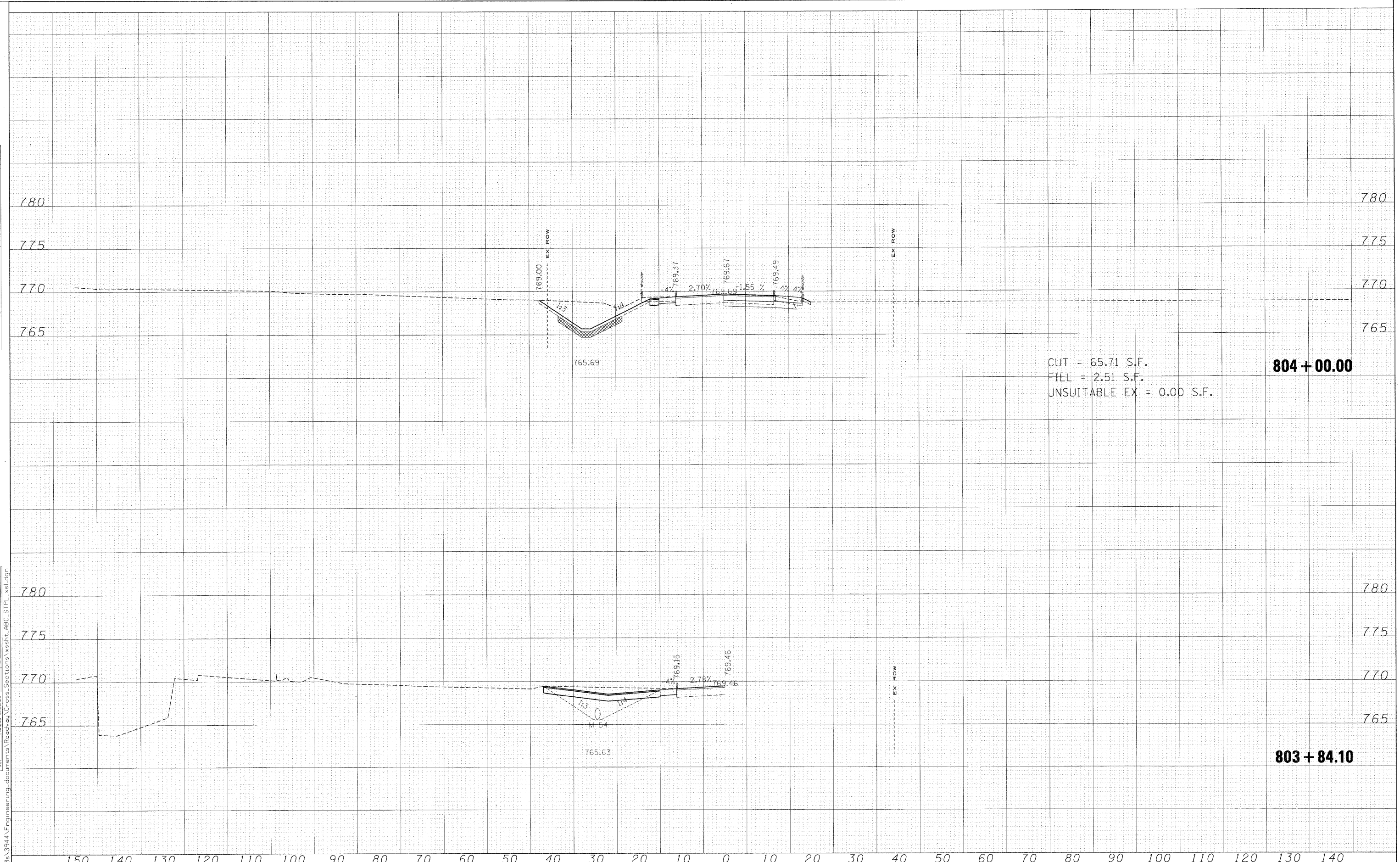

CUT = 65.71 S.F.  
 FILL = 2.51 S.F.  
 UNSUITABLE EX = 0.00 S.F.

**804 + 00.00**

**803 + 84.10**

FILE NAME =	USER NAME = #USERS	DESIGNED - MAC	REVISED -	<b>KANE COUNTY DIVISION OF TRANSPORTATION</b>	<b>OLD STEARNS ROAD CROSS SECTIONS</b>				F.A. RTE.	SECTION	COUNTY	TOTAL SHEETS	SHEET NO.
#FILES*		DRAWN - MAC	REVISED -		SCALE:	SHEET NO.	OF	SHEETS	361	06-00214-15-BR	KANE/DUPAGE	545	540
		CHECKED - JJT	REVISED -		STA. 803+84.10	TO STA. 804+00.00			CONTRACT NO. 63074				
		DATE - 3/31/09	REVISED -						ILLINOIS FED. AID PROJECT				