

TRAFFIC SIGNAL LEGEND

EXISTING	PROPOSED	EXISTING	PROPOSED



NOTES FOR TRAFFIC SIGNALS

1. THE VIDEO VEHICLE DETECTION SYSTEM'S MANUFACTURER'S REPRESENTATIVE SHALL PROVIDE ASSISTANCE IN ALL CABLE TERMINATIONS.
2. ALL DETECTION ZONES ARE APPROXIMATE. THE EXACT LOCATIONS SHALL BE DETERMINED AND LAID OUT IN THE FIELD BY THE MANUFACTURER'S TECHNICIAN AS APPROVED BY THE ENGINEER.
3. THE TRAFFIC SIGNAL CONTROLLER CABINET SHALL BE EQUIPPED WITH TWO 30 AMP CIRCUIT BREAKERS, ONE PROVIDED FOR THE TRAFFIC SIGNAL LOAD AND ONE PROVIDED FOR POTENTIAL FUTURE LIGHTING. THIS WORK SHALL BE INCLUDED IN THE COST OF "FULL ACTUATED CONTROLLER IN TYPE IV CABINET (SPECIAL)"
4. THE TYPE "E" CONCRETE FOUNDATIONS SHALL INCLUDE AN ADDITIONAL 2 1/2" RACEWAY FOR POTENTIAL FUTURE LIGHTING NEEDS.

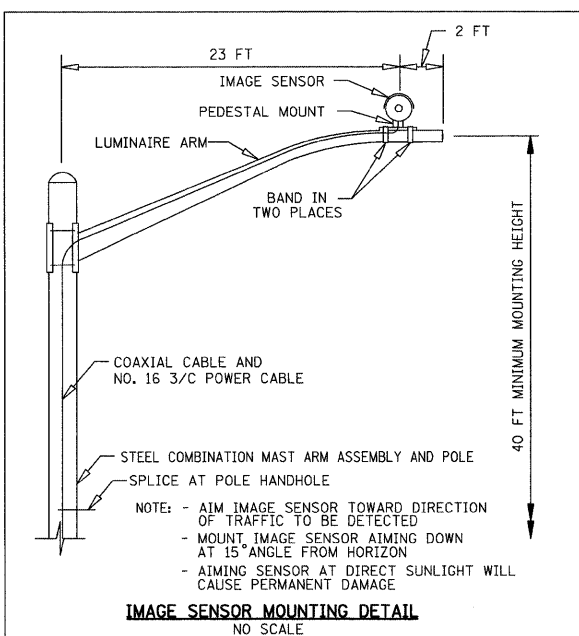

LEFT ON GREEN ARROW ONLY
R10-5
24"x30"
(TYP.) SIGN PANEL TYPE 1

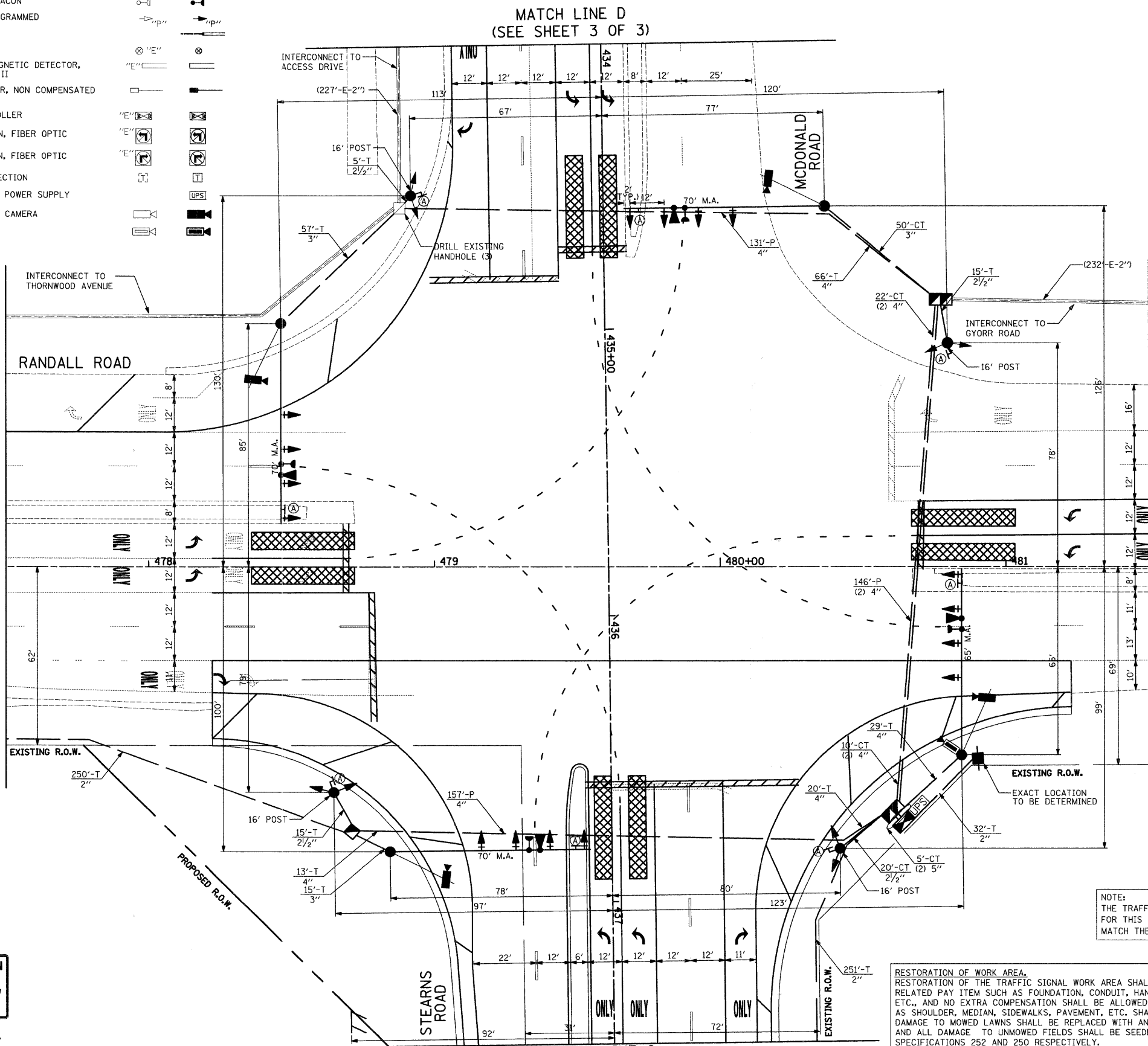

NOTE: THE TRAFFIC SIGNAL CONTROLLER EQUIPMENT FOR THIS PROJECT SHALL BE "EAGLE" TO MATCH THE EXISTING ADJACENT SYSTEM.

RESTORATION OF WORK AREA. RESTORATION OF THE TRAFFIC SIGNAL WORK AREA SHALL BE INCIDENTAL TO THE RELATED PAY ITEM SUCH AS FOUNDATION, CONDUIT, HANDHOLE, TRENCH AND BACKFILL, ETC., AND NO EXTRA COMPENSATION SHALL BE ALLOWED. ALL ROADWAY SURFACES SUCH AS SHOULDER, MEDIAN, SIDEWALKS, PAVEMENT, ETC. SHALL BE REPLACED IN KIND. ALL DAMAGE TO MOWED LAWNS SHALL BE REPLACED WITH AN APPROVED SALT TOLERANT SOD, AND ALL DAMAGE TO UNMOWED FIELDS SHALL BE SEEDING IN ACCORDANCE WITH STANDARD SPECIFICATIONS 252 AND 250 RESPECTIVELY.