

DATE	
BY	
SURVEYED	
PLOTTED	
TEMPLATE	
NOTE BOOK	
AREAS CHECKED	
NO.	

DATE	
BY	
SURVEYED	
PLOTTED	
TEMPLATE	
NOTE BOOK	
AREAS CHECKED	
NO.	

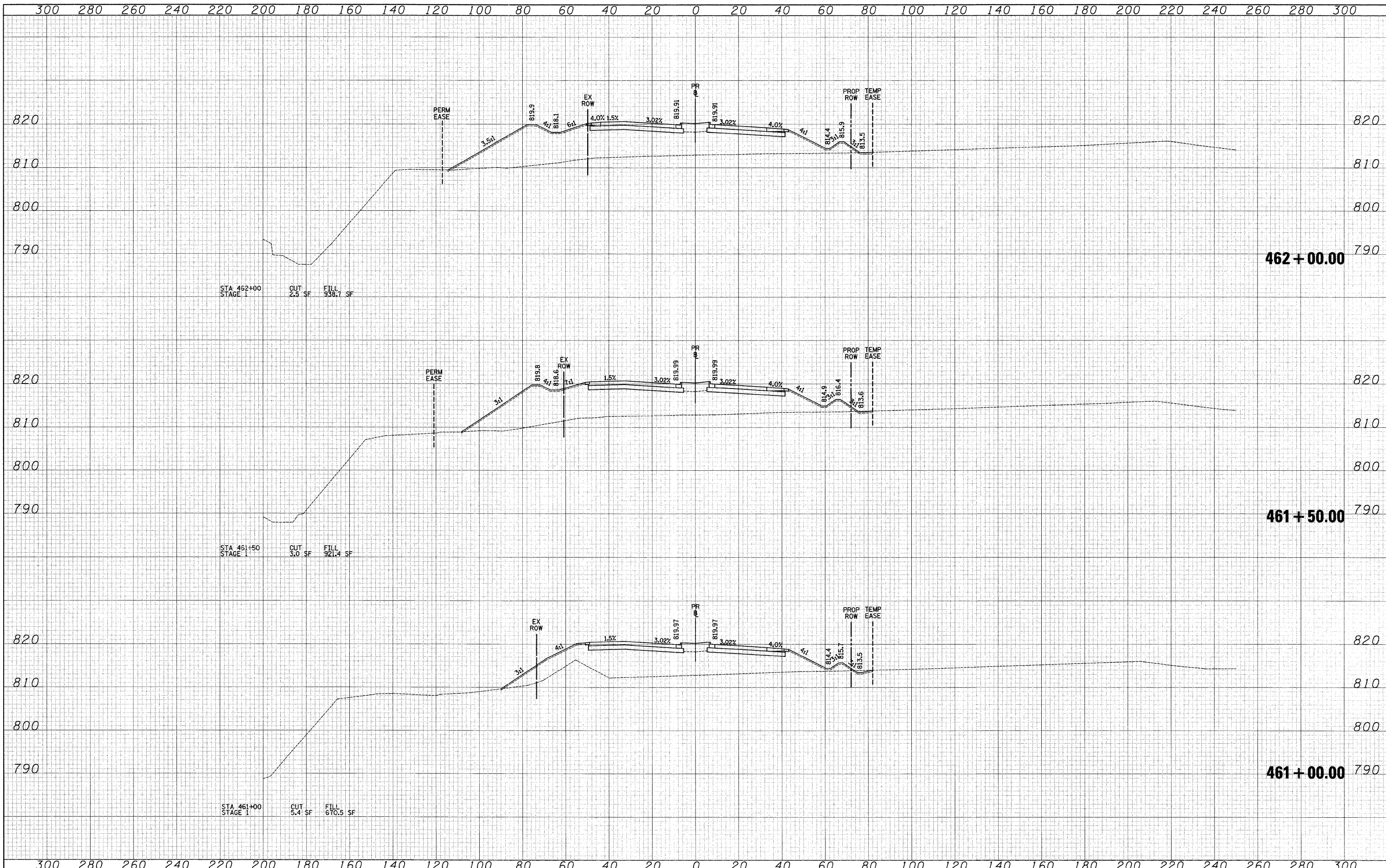

FILE NAME =	USER NAME = ead	DESIGNED - JSM	REVISED -	KANE COUNTY DEPARTMENT OF TRANSPORTATION	CROSS SECTIONS - STEARNS ROAD	F.A. RTE. 361	SECTION 06-00214-25-BR	COUNTY KANE	TOTAL SHEETS 220	SHEET NO. 165		
CIVILTECH	PLLOT SCALE = 20,000.00' / IN.	DRAWN - JSM	REVISED -			SCALE: 1"=10'V/20'H	SHEET NO. 20 OF 63 SHEETS	STA. 461+00.00	TO STA. 462+00.00	CONTRACT NO. 63076		
	CHECKED - DNM	DATE - 3/30/09	REVISED -			FED. ROAD DIST. NO. 1 ILLINOIS FED. AID PROJECT						
	PLLOT DATE = 3/27/2009		REVISED -									