

| | |
|---------------|--|
| DATE | |
| BY | |
| SURVEYED | |
| PLOTTED | |
| TEMPERATURE | |
| NOTE BOOK | |
| AREAS CHECKED | |
| NO. | |

| | |
|---------------|--|
| DATE | |
| BY | |
| SURVEYED | |
| PLOTTED | |
| TEMPERATURE | |
| NOTE BOOK | |
| AREAS CHECKED | |
| NO. | |

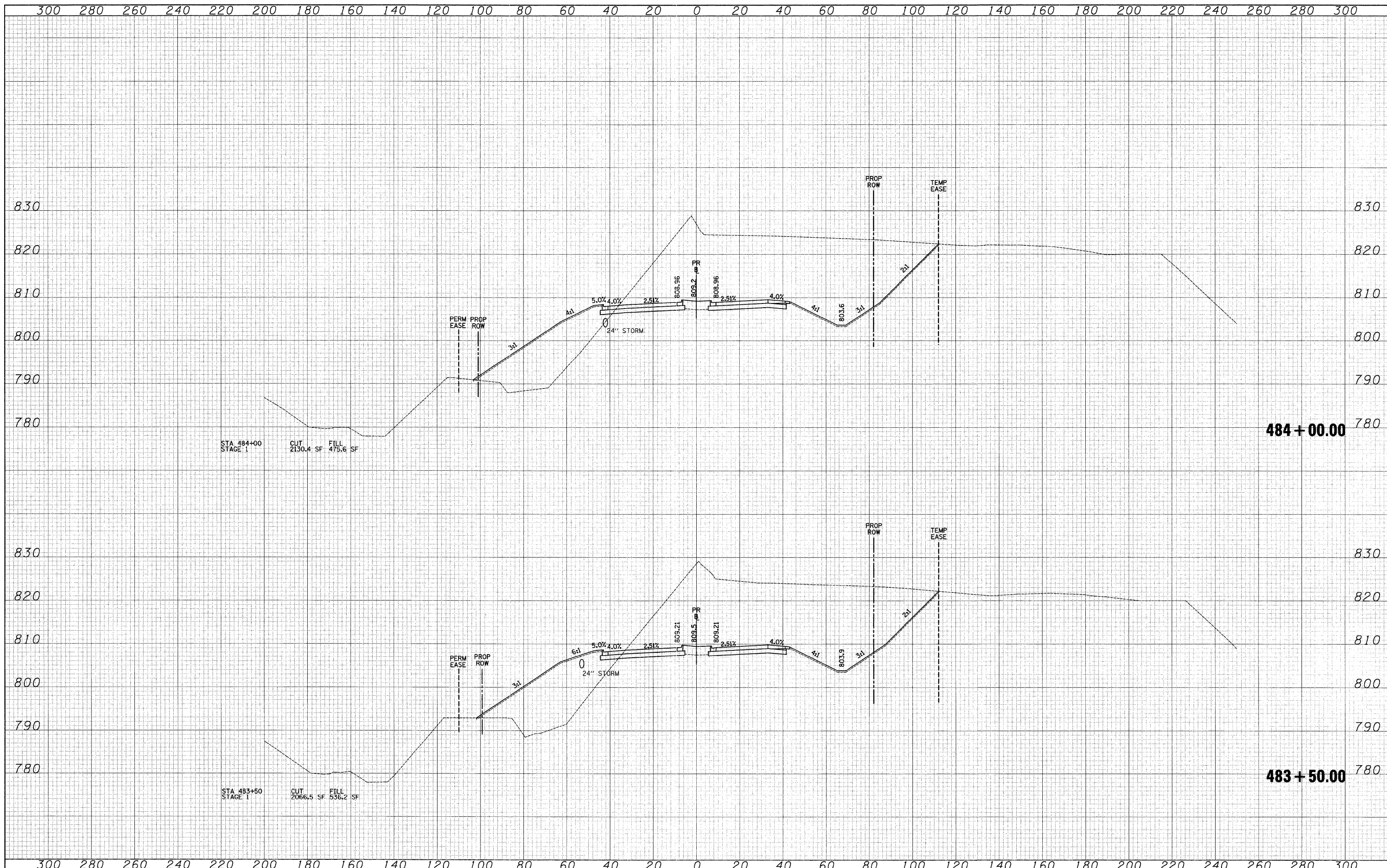

STA 484+00
STAGE 1
CUT 2130.4 SF FILL 475.6 SF

484+00.00

STA 483+50
STAGE 1
CUT 2066.5 SF FILL 536.2 SF

483+50.00

300 280 260 240 220 200 180 160 140 120 100 80 60 40 20 0 20 40 60 80 100 120 140 160 180 200 220 240 260 280 300

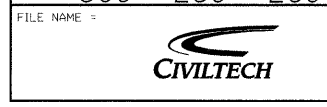

FILE NAME =
USER NAME = ead
DESIGNED - JSM
DRAWN - JSM
CHECKED - DNM
DATE - 3/30/09

REVISED -
REVISED -
REVISED -
REVISED -

**KANE COUNTY
DEPARTMENT OF TRANSPORTATION**

CROSS SECTIONS - STEARNS ROAD
SCALE: 1"=10'V/20'H SHEET NO. 39 OF 63 SHEETS STA. 483+50.00 TO STA. 484+00.00

| | | | | |
|--------------------|---------------------------|----------------|---------------------------|------------------|
| F.A. RTE. 361 | SECTION 06-00214-25-BR | COUNTY KANE | TOTAL SHEETS 220 | SHEET NO. 184 |
| CONTRACT NO. 63076 | | | ILLINOIS FED. AID PROJECT | |