

| | |
|-----------|--|
| DATE | |
| BY | |
| REVISIONS | |
| NO. | |
| DATE | |
| BY | |
| REVISIONS | |
| NO. | |
| DATE | |
| BY | |
| REVISIONS | |
| NO. | |

| | |
|-----------|--|
| DATE | |
| BY | |
| REVISIONS | |
| NO. | |
| DATE | |
| BY | |
| REVISIONS | |
| NO. | |
| DATE | |
| BY | |
| REVISIONS | |
| NO. | |

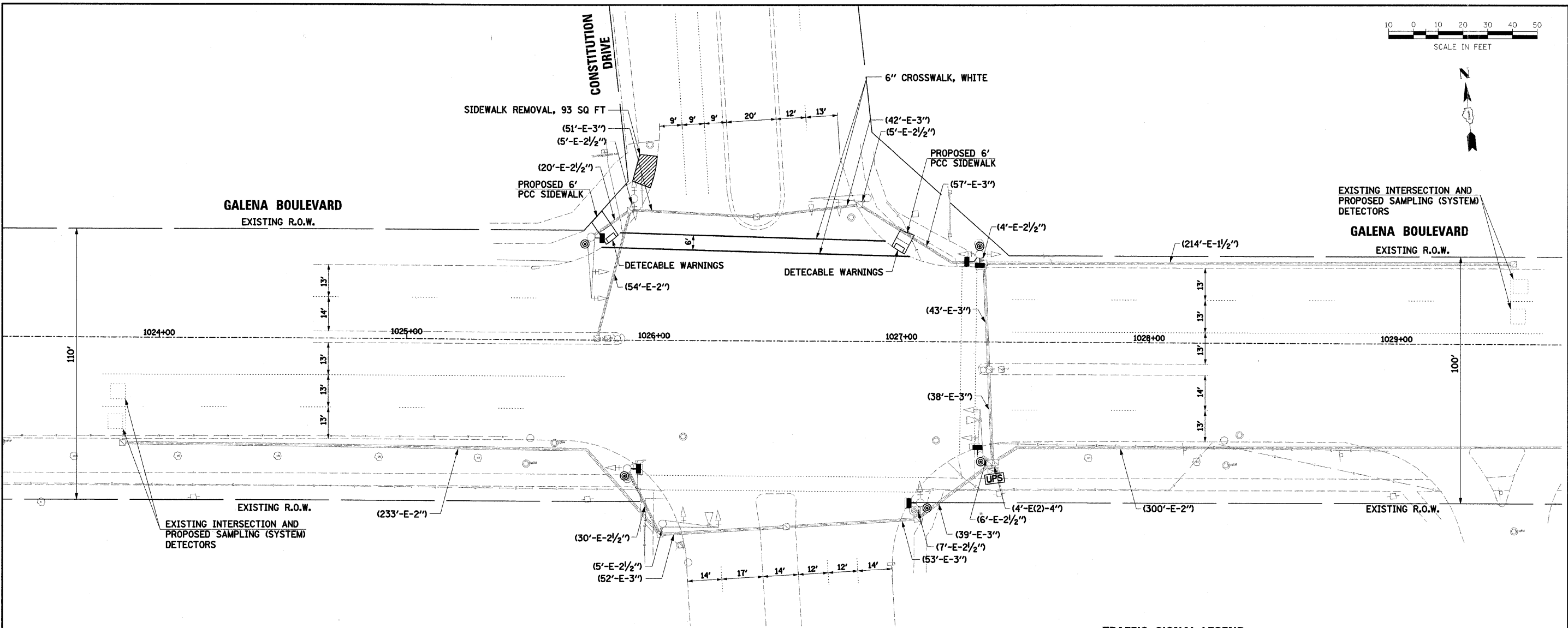

THE FOLLOWING ITEMS SHALL BE REMOVED BY THE CONTRACTOR AND SHALL BE DISPOSED OF BY HIM OUTSIDE THE RIGHT-OF-WAY AT HIS EXPENSE. THE SALVAGE VALUE OF THE REMOVED EQUIPMENT SHALL BE REFLECTED IN THE CONTRACT BID PRICE.

- 4 EACH PEDESTRIAN SIGNAL HEADS
- 4 EACH PEDESTRIAN PUSH BUTTONS

RESTORATION OF WORK AREA:
 RESTORATION OF THE TRAFFIC SIGNAL WORK AREA SHALL BE INCIDENTAL TO THE RELATED PAY ITEM SUCH AS FOUNDATION, CONDUIT, HANDHOLE, TRENCH AND BACKFILL, ETC., AND NO EXTRA COMPENSATION SHALL BE ALLOWED. ALL ROADWAY SURFACES SUCH AS SHOULDERS, MEDIANS, SIDEWALKS, PAVEMENT, ETC. SHALL BE REPLACED IN KIND. ALL DAMAGE TO MOWED LAWNS SHALL BE REPLACED WITH AN APPROVED SOD, AND ALL DAMAGE TO UNMOWED FIELDS SHALL BE SEEDED IN ACCORDANCE WITH STANDARD SPECIFICATIONS 252 AND 250 RESPECTIVELY.

TRAFFIC SIGNAL LEGEND

| | PROPOSED | EXISTING | | PROPOSED | EXISTING |
|--|----------|----------|--|----------|----------|
| CONTROLLER | | | DETECTOR LOOP | | |
| SERVICE INSTALLATION | | | CAST IRON JUNCTION BOX | | |
| SIGNAL HEAD | | | EMERGENCY VEHICLE LIGHT DETECTOR | | |
| SIGNAL HEAD WITH BACKPLATE | | | CONFIRMATION BEACON | | |
| SIGNAL HEAD, PEDESTRIAN | | | SIGNAL HEAD OPTICALLY PROGRAMMED | | |
| SIGNAL POST | | | CONDUIT SPLICE | | |
| MAST ARM ASSEMBLY AND POLE, STEEL | | | WOOD POLE | | |
| MAST ARM ASSEMBLY AND POLE, ALUMINUM | | | RACEWAY FOR MAGNETIC DETECTOR, TYPE I OR TYPE II | | |
| COMBINATION MAST ARM ASSEMBLY AND POLE, STEEL WITH LUMINAIRE | | | VEHICLE DETECTOR, NON COMPENSATED MAGNETIC TYPE | | |
| UNIT DUCT | UD | | RAILROAD CONTROL CABINET | | |
| COMMON TRENCH | CT | | TELEPHONE CONNECTION | | |
| HANDHOLE | | | ILLUMINATED SIGN "NO LEFT TURN" | | |
| HEAVY DUTY HANDHOLE | | | ILLUMINATED SIGN "NO RIGHT TURN" | | |
| DOUBLE HANDHOLE | | | UNINTERRUPTABLE POWER SUPPLY | UPS | UPS |
| G.S. CONDUIT IN TRENCH (T) OR PUSHED (P) | | | VIDEO DETECTION CAMERA | | |
| PEDESTRIAN PUSHBUTTON DETECTOR | | | VIDEO DETECTION AREA | | |