

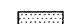
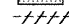
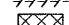

FAU RTE 1472 3569	SECTION 06-00073-00-LS	COUNTY COOK	TOTAL SHEETS 24	SHEET NO. 8
STA. TO STA.		FED. ROAD DIST. NO. ILLINOIS		
		FED. AID PROJECT CONTRACT NO. 63133		

LEGEND

-  -SIDEWALK REMOVAL
-  -COMBINATION CONCRETE CURB AND GUTTER REMOVAL
-  -PAVEMENT REMOVAL
-  -HOT-MIX ASPHALT SURFACE REMOVAL, 2 1/2"
-  -HOT-MIX ASPHALT SURFACE REMOVAL-BUTT JOINT

NOTES:

1) PAVEMENT REMOVAL CONSISTS OF FULL DEPTH REMOVAL OF EXISTING HOT-MIX ASPHALT PAVEMENT OR P.C.C. PAVEMENT REGARDLESS OF PAVEMENT THICKNESS.

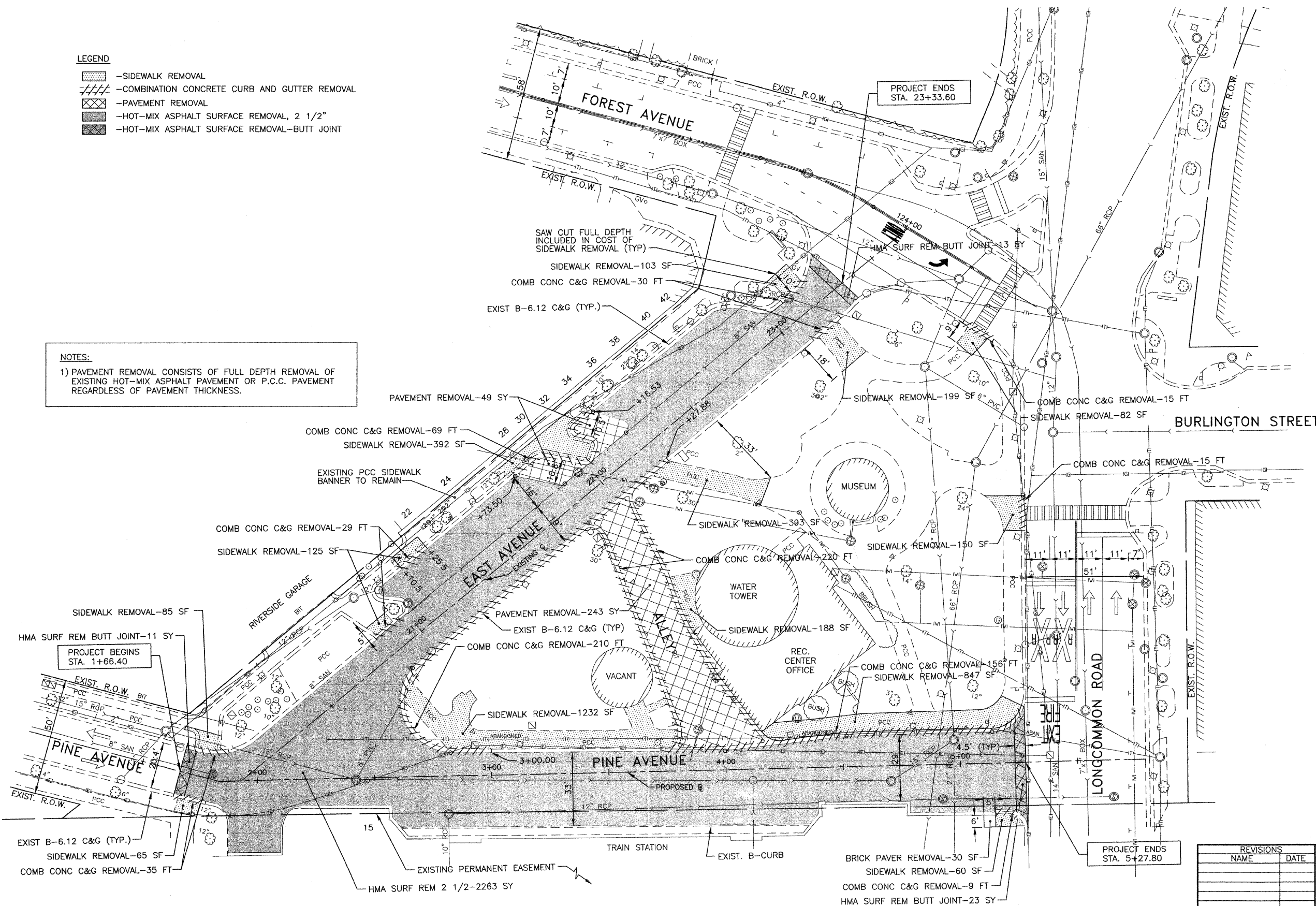

REVISIONS	
NAME	DATE

ILLINOIS DEPARTMENT OF TRANSPORTATION
 FAU ROUTES 1472 & 3569
 VILLAGE OF RIVERSIDE
 RAILWAY/WATER TOWER CAMPUS RESTORATION PROJECT

SITE PREPARATION PLAN

SCALE: 1"=20'
 DATE: 12/01/08

DRAWN BY: SMP
 CHECKED BY: BOH