

- LEGEND:**
- PAVEMENT REMOVAL
  - DRIVEWAY PAVEMENT REMOVAL
  - HMA PATH REMOVAL
  - CULVERT/STORM SEWER REMOVAL
  - 2" HMA SURFACE REMOVAL
  - SIDEWALK REMOVAL
  - MAILBOX TO BE RELOCATED
  - SIGN TO BE RELOCATED (INC.)
  - MANHOLES TO BE ADJUSTED WITH NEW FRAME, LID, & CHIMNEY SEAL

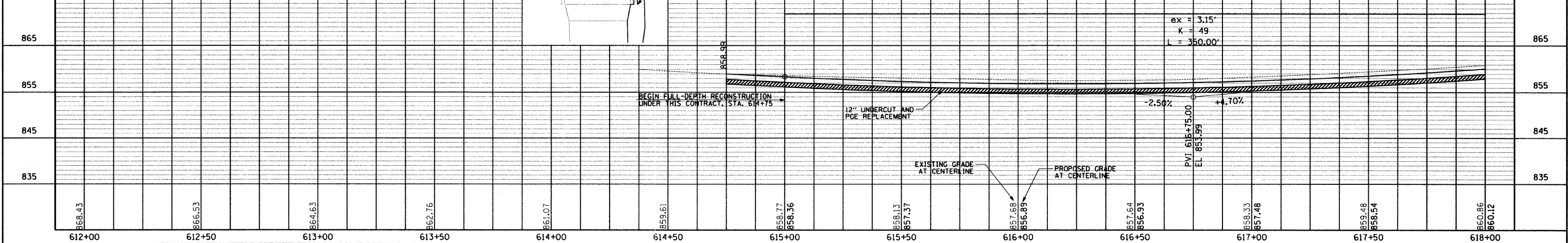
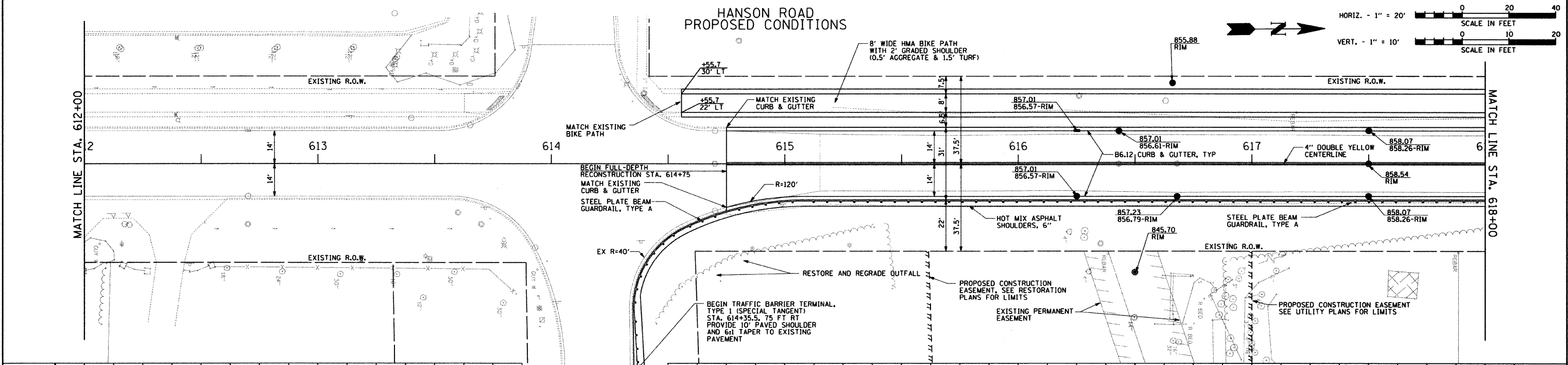
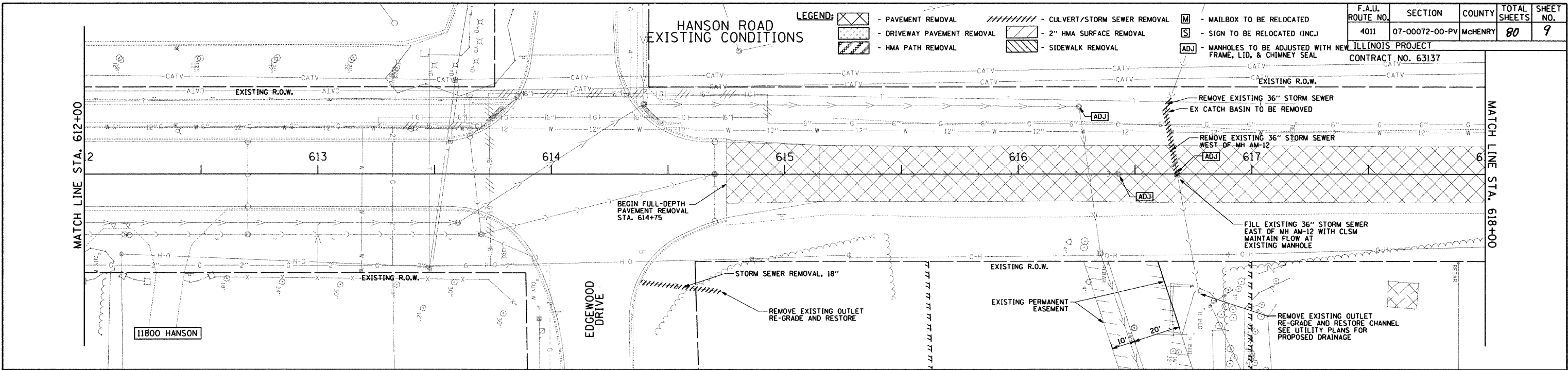

PLAN AND PROFILE

HANSON ROAD STA. 612+00 TO STA. 618+00