

F.A.P. RTE.	SECTION	COUNTY	TOTAL SHEETS	SHEET NO.
537	09-00001-00-RS	KANE	12	7
CONTRACT NO. 63153				

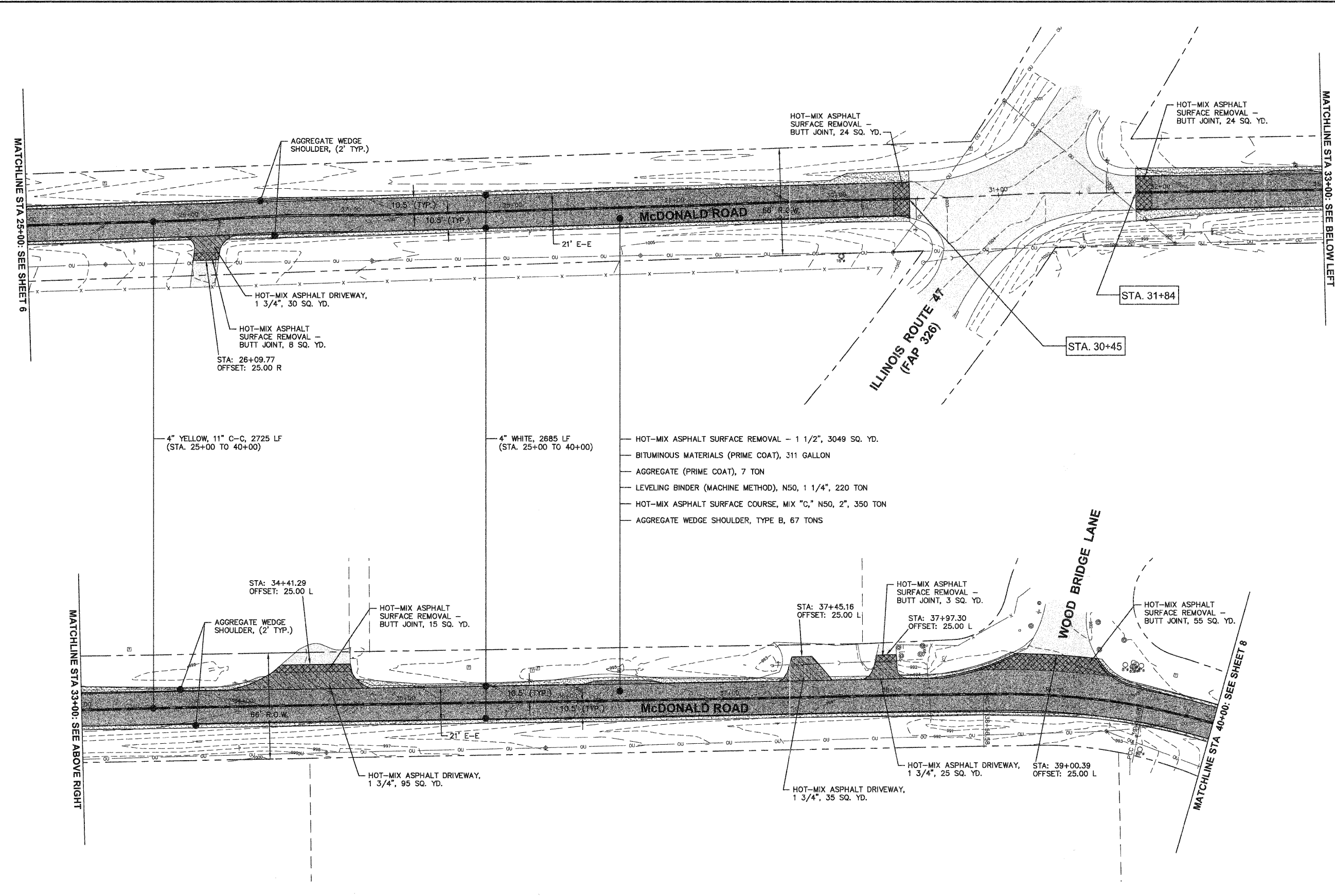
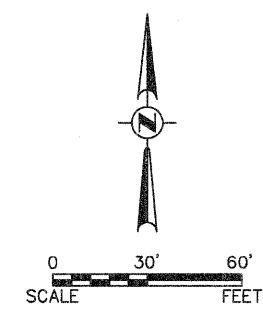

- HOT-MIX ASPHALT SURFACE REMOVAL - 1 1/2", 3049 SQ. YD.
- BITUMINOUS MATERIALS (PRIME COAT), 311 GALLON
- AGGREGATE (PRIME COAT), 7 TON
- LEVELING BINDER (MACHINE METHOD), N50, 1 1/4", 220 TON
- HOT-MIX ASPHALT SURFACE COURSE, MIX "C," N50, 2", 350 TON
- AGGREGATE WEDGE SHOULDER, TYPE B, 67 TONS

- RESURFACING
- CLASS D PATCHES
- HOT-MIX ASPHALT SURFACE REMOVAL - BUTT JOINT
- HOT-MIX ASPHALT DRIVEWAY, 1 3/4"
- AGGREGATE WEDGE SHOULDER, TYPE B

- NOTES:
1. AREA REFLECTIVE CRACK CONTROL TO BE USED IN ALL PATCHED AREAS AND AS DIRECTED BY THE ENGINEER.
  2. STRIP REFLECTIVE CRACK CONTROL TO BE USED FOR ALL LONGITUDINAL CRACKS, AND TRANSVERSE CRACKS AS DIRECTED BY THE ENGINEER.

Plotted: February 17, 2009 @ 3:31 PM By: Jim Cole - Tab: 07 Plan 22334  
 COPYRIGHT © 2009 ENGINEERING ENTERPRISES, INC.

**Engineering Enterprises, Inc.**  
 CONSULTING ENGINEERS  
 52 Wheeler Road  
 Sugar Grove, Illinois 60554  
 630.466.6700 / www.eeiweb.com

**VILLAGE OF CAMPTON HILLS**  
 KANE COUNTY, ILLINOIS

NO.	DATE	REVISIONS
1	02-17-09	REVISED PER IDOT COMMENTS

**McDONALD ROAD**  
 LAPP IMPROVEMENTS

**PLAN, CONSTRUCTION**  
**NOTES, AND DETAILS**  
 STA. 25+00 TO STA. 40+00

DATE: DECEMBER 2008
PROJECT NO: CH0803
FILE NO: CH0803-PLAN
SHEET <b>7</b> OF <b>12</b>

Path: \\S:\S\PROJ\CH0803\DWG\JWG\_FINAL\_ENG\CH0803-PLAN