

F. A. U. SHEET	SECTION	COUNTY	TOTAL SHEETS	SHEET NO.
0281	07-00050-00-FP	WILL	33	17
STA.	TO STA.			
FED. ROAD DIST. NO. 1	ILLINOIS	FED. AID PROJECT		

CONTRACT #63157

EROSION CONTROL NOTES:

- BEFORE STARTING SITE GRADING WORK, SILT FENCES SHALL BE INSTALLED AS SHOWN ON THE PLANS. IF DIRECTED BY THE MUNICIPAL ENGINEER, THE CONTRACTOR SHALL INSTALL ADDITIONAL SILT FENCES WHERE NEEDED.
- WITHIN 24 HOURS FROM THE TIME SEEDING HAS BEEN PERFORMED, THE SEED AREA SHALL BE GIVEN A COVERING OF MULCH. THE MULCH SHALL CONSIST OF HAND OR MACHINE APPLICATION OF STRAW, MULCH AT RATE OF 2 TON PER ACRE. MULCH SHALL EITHER BE ANCHORED WITH A MECHANICAL STABILIZER OR PARTIALLY COATED WITH EMULSIFIED ASPHALT. THIS WORK SHALL BE INCIDENTAL TO THE CONTRACT.
- ALL EROSION CONTROL PRACTICES SHALL BE INSTALLED PRIOR TO STARTING EACH PHASE OF CONSTRUCTION.
- ANY OBSERVED DISRUPTION TO THE EROSION CONTROL PRACTICES SHALL BE IMMEDIATELY REPAIRED BY THE CONTRACTOR.
- ANY EXISTING SUBSURFACE DRAINAGE SYSTEM OR FIELD TILES THAT ARE DISTURBED DURING CONSTRUCTION SHALL BE RESTORED.
- ANY DUST OR MUD TRACKED ONTO STREETS SHALL BE CLEANED AT THE END OF EACH WORKING DAY.
- ALL SOIL EROSION, AND SEDIMENTATION CONTROL PRACTICES SHALL BE IN ACCORDANCE WITH THE ILLINOIS URBAN MANUAL.
- ALL SOIL SHALL BE STABILIZED WITHIN 7 DAYS OF SOIL DISTURBANCE.
- STOCK PILES SHALL BE STABILIZED WITHIN 7 DAYS OF SOIL DISTURBANCE BY MEANS OF TEMPORARY SEEDING.
- THE CONTRACTOR SHALL BE RESPONSIBLE FOR INSPECTION AND MAINTENANCE OF EROSION CONTROL PRACTICES. REQUIRED INSPECTION REPORTS SHALL BE SUBMITTED TO THE WILL/SOUTH COOK SOIL AND WATER CONSERVATION DISTRICT AT 1201 GOUGAR ROAD, NEW LENOX 60451.
- ALL EROSION CONTROL PRACTICES SHALL BE INSPECTED WEEKLY AND AFTER ANY RAINFALL GREATER THAN 0.5".
- THE SEEDING DATES FOR CLASS 2A SEEDING SHALL BE EARLY SPRING TO JUNE 1, AUGUST 1 TO SEPTEMBER 1, OR NOVEMBER 15 TO MARCH 1. THE SEEDING DATES FOR TEMPORARY SEEDING SHALL BE EARLY SPRING TO SEPTEMBER 30. THE SEEDING DATES FOR BARE EARTH SEEDING AND INTER SEEDING CLASS 4 AND CLASS 4B SHALL BE FROM MAY 15 TO JUNE 30 AND FROM OCTOBER 15 TO DECEMBER 1.
- PERMANENT SEEDING SHALL BE FERTILIZED WITH 1000 LBS/ACRE OF 12-12-12 FERTILIZER OR EQUIVALENT.
- TEMPORARY SEEDING SHALL BE FERTILIZED WITH 500 LBS/ACRE OF 10-10-10 FERTILIZER OR EQUIVALENT. (TO BE USED AT THE DISCRETION OF VILLAGE OF ROMEOVILLE AND/OR VILLAGE ENGINEER).
- AT THE COMPLETION OF THE PROJECT, ALL STORM SEWER PIPES AND STRUCTURES SHALL BE CLEANED AND FREE OF DIRT AND DEBRIS. THE SEDIMENTATION SHALL BE REMOVED FROM THE STORM SEWER SYSTEM AND SHALL NOT BE WASHED OUT IN THE STORM SEWER SYSTEM.

STORM WATER POLLUTION PREVENTION NOTES:

- THE CONTRACTOR IS RESPONSIBLE FOR HAVING THE SWPPP ON SITE AT ALL TIMES.
- THE CONTRACTOR SHALL TAKE THE NECESSARY STEPS TO CONTROL WASTE SUCH AS DISCARDED BUILDING MATERIALS, CONCRETE TRUCK WASHOUT, CHEMICALS, LITTER AND SANITARY WASTE AT THE CONSTRUCTION SITE THAT MAY CAUSE ADVERSE IMPACTS TO WATER QUALITY.

SEEDING MIXTURES SHALL BE AS FOLLOWS

Class	Seeds	lbs/acre	Pure Live Seed
2A	Alta Fescue or Ky 31	70	
	Perennial Ryegrass	20	
	Dawsons Red Fescue	20	
	Scaldis Hard Fescue	20	
	Fults Salt Grass 1/	70	

TEMPORARY SEEDING

Seeds	lbs/acre	Pure Live Seed
Oats	90	
or Cereal Rye	90	
or Wheat	90	
or Perennial Ryegrass	25	

PLAN NOTES:

- EXISTING AND FUTURE DRAINAGE PATTERNS ARE THE SAME.
- TOTAL AREA OF SOIL DISTURBANCE IS APPROXIMATELY 4.0 ACRES.

SOIL PROTECTION CHART

STABILIZATION TYPE	JAN	FEB	MAR	APR	MAY	JUN	JUL	AUG	SEP	OCT	NOV	DEC
PERMANENT SEEDING			A			*	*					
DORMANT SEEDING	B										B	
TEMPORARY SEEDING			C			*	D*					
SODDING			E**									
MULCHING	F											

- A. KENTUCKY BLUEGRASS 90 LBS/AC MIXED WITH PERENNIAL RYEGRASS 30 LBS/AC
- B. KENTUCKY BLUEGRASS 135 LBS/AC MIXED WITH PERENNIAL RYEGRASS 45 LBS/AC + 2 TONS STRAW MULCH/AC
- C. SPRING OATS 100 LBS/AC
- D. WHEAT OR CEREAL RYE 150 LBS/AC
- E. SOD (NURSERY GROWN KENTUCKY BLUEGRASS)
- F. STRAW MULCH 2 TONS/AC

* IRRIGATION NEEDED DURING JUNE AND JULY
 ** IRRIGATION NEEDED FOR 2 TO 3 WEEKS AFTER APPLYING SOD

LEGEND

- SF- PERIMETER EROSION BARRIER* (TO BE PLACED 6" INSIDE ROW)
- ◆ INLET FILTER
- ▨ SODDING, SPECIAL

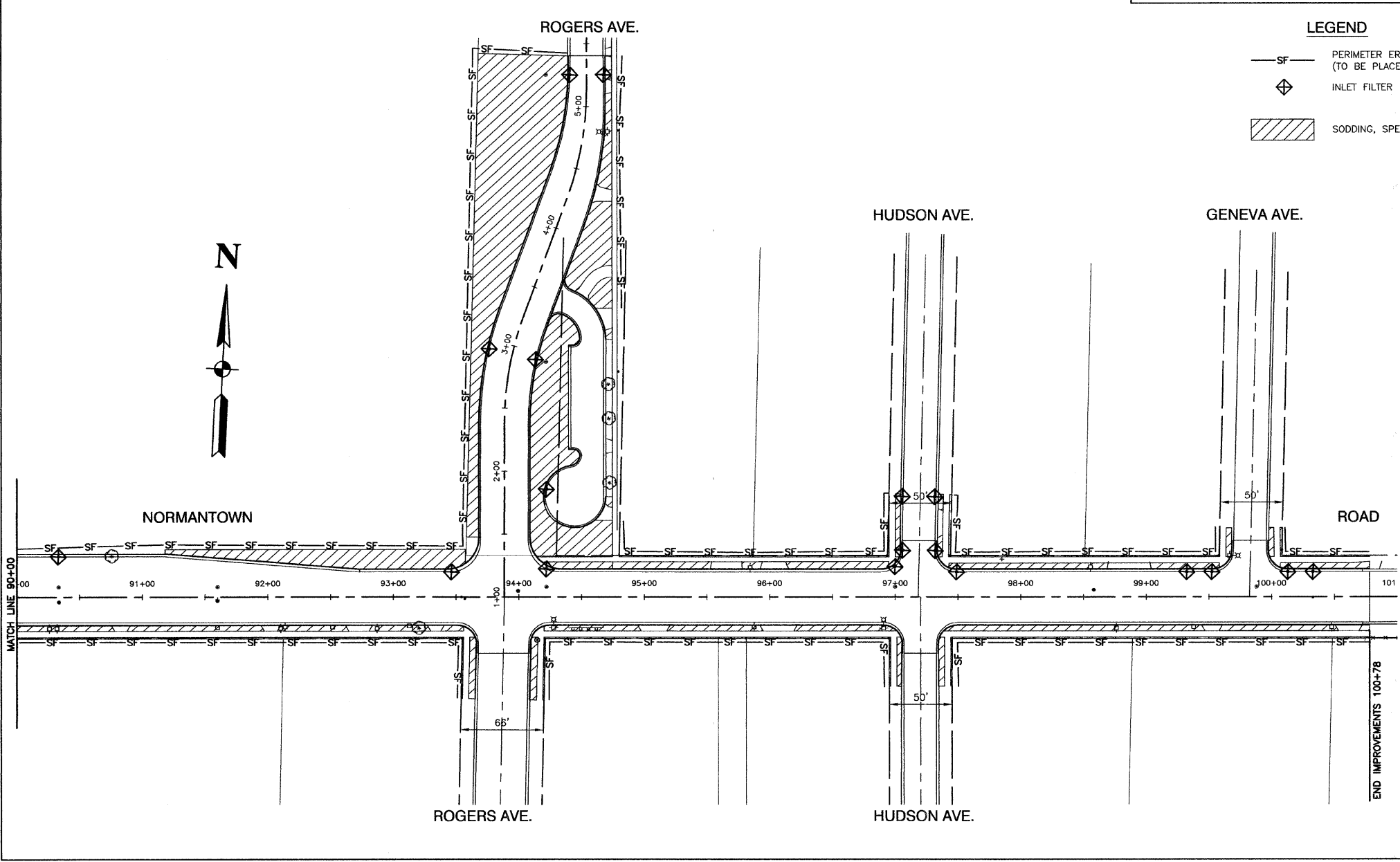
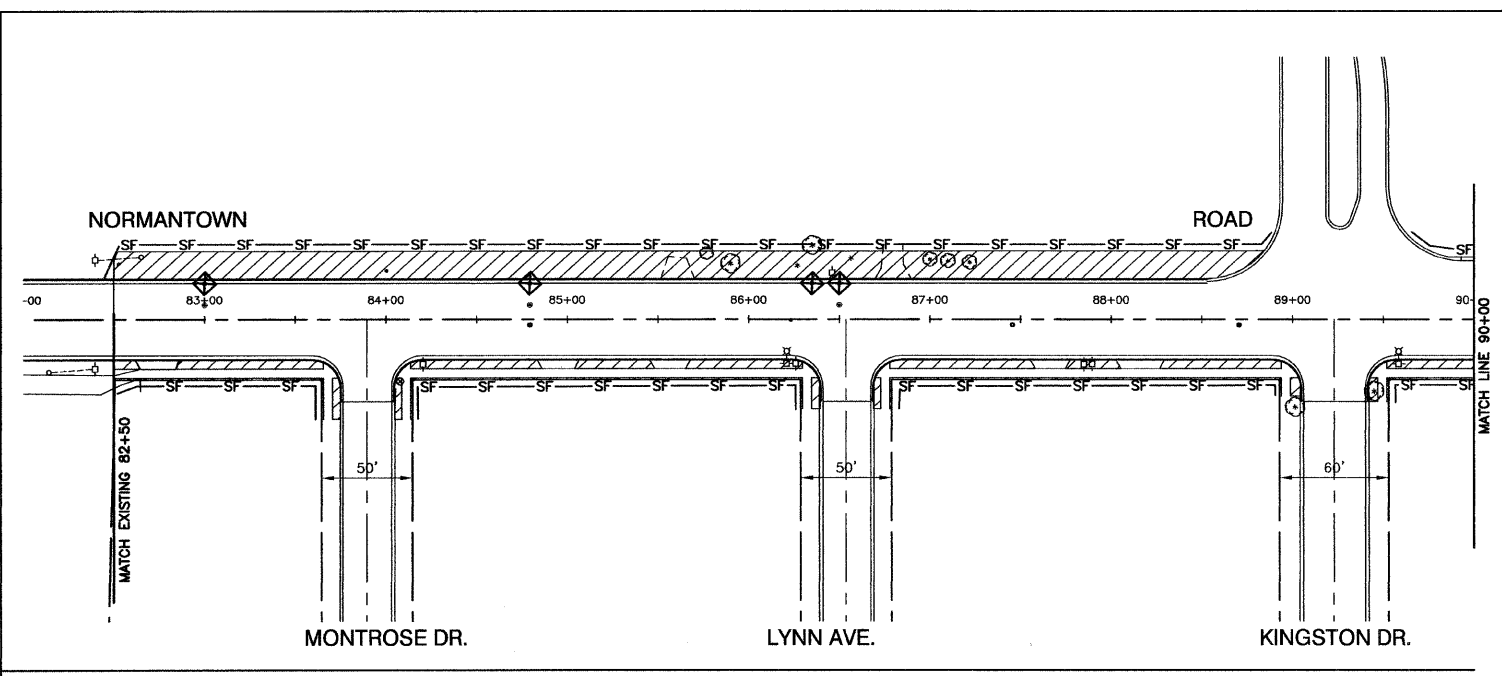

REVISIONS	
NAME	DATE

ILLINOIS DEPARTMENT OF TRANSPORTATION
**NORMANTOWN ROAD RECONSTRUCTION
 ROMEOVILLE
 LANDSCAPING AND EROSION CONTROL PLAN**

SCALE: VERT. N/A
 HORIZ. 1" = 50'
 DATE 01/19/2009
 DRAWN BY JJB
 CHECKED BY BDB