

FAU RTE	SECTION	COUNTY	TOTAL SHEETS	SHEET NO.
2612	08-00041-00-RS	COOK	14	1
F.H.W.A. REG.	ILLINOIS PROJECT	M-8003(981)		

CONTRACT NO. 63174

STATE OF ILLINOIS
DEPARTMENT OF TRANSPORTATION
DIVISION OF HIGHWAYS

**PLANS FOR PROPOSED
FEDERAL AID HIGHWAY**

STATE STREET (FAU RTE. 2612)
FROM 127TH STREET (FAU 1591) TO ILLINOIS STREET
LAPP RESURFACING
FEDERAL PROJECT M-8003(981)
SECTION NO. 08-00041-00-RS
VILLAGE OF LEMONT
COOK COUNTY
JOB NO. C-91-355-08

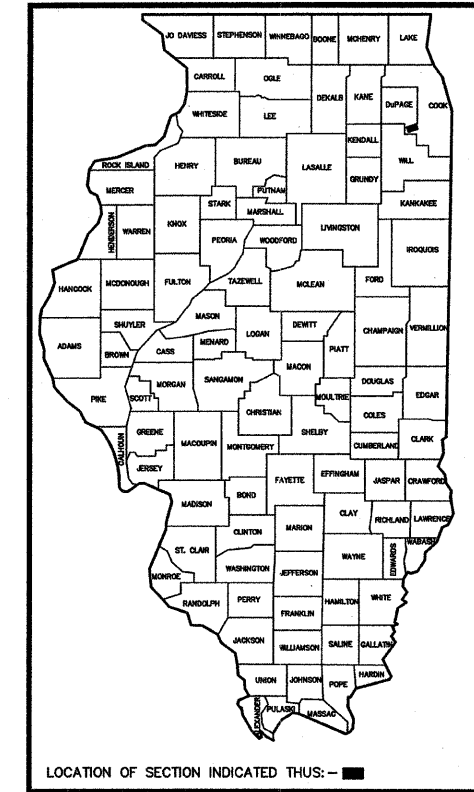

- INDEX OF SHEETS**
- COVER SHEET, INDEX OF SHEETS, LOCATION MAP, INDEX OF STATE STANDARDS
 - GENERAL NOTES, JOINT DETAILS, AND SUMMARY OF QUANTITIES
 - TYPICAL CROSS SECTIONS, HOT-MIX ASPHALT MIXTURE REQUIREMENTS
 - PLAN: STATE STREET (RESURFACING) - 127TH ST. TO STA. 31+00
 - PLAN: STATE STREET (RESURFACING) - STA. 31+00 TO ILLINOIS ST.
 - PLAN: STATE STREET (PAVEMENT MARKINGS) - 127TH ST. TO STA. 31+00
 - PLAN: STATE STREET (PAVEMENT MARKINGS) - STA. 31+00 TO ILLINOIS ST.
 - DISTRICT ONE TYPICAL PAVEMENT MARKINGS
 - PAVEMENT MARKING LETTERS AND SYMBOLS FOR TRAFFIC STAGING
 - TRAFFIC CONTROL AND PROTECTION FOR SIDEROADS, INTERSECTIONS, AND DRIVEWAYS
 - SIGNING FOR FLAGGING OPERATION AT WORK ZONE OPENINGS
 - CURB OR CURB AND GUTTER REMOVAL AND REPLACEMENT
 - FRAMES AND LIDS ADJUSTMENTS WITH MILLING
 - BUTT JOINT AND HOT-MIX ASPHALT TAPER DETAILS

STATE STANDARDS

- 000001-05 STANDARD SYMBOLS, ABBREVIATIONS, AND PATTERNS
- 424001-05 CURB RAMPS FOR SIDEWALK
- 442201-03 CLASS C AND D PATCHES
- 604001-03 FRAME & LIDS, TYPE 1
- 606001-04 CONCRETE CURB AND COMBINATION CONCRETE CURB & GUTTER
- 701301-03 LANE CLOSURE, 2 L, 2 W, SHORT TIME OPERATIONS
- 701501-05 URBAN LANE CLOSURE, 2 L, 2 W UNDIVIDED
- 701502-03 URBAN LANE CLOSURE, 2 L, 2 W BIDIRECTIONAL LEFT TURN LANE
- 701701-06 URBAN LANE CLOSURE, MULTILANE INTERSECTION
- 701801-04 LANE CLOSURE MULTILANE 1W OR 2W CROSSWALK OR SIDEWALK CLOSURE
- 701901-01 TRAFFIC CONTROL DEVICES
- 780001-02 TYPICAL PAVEMENT MARKINGS
- 781001-03 RAISED REFLECTIVE PAVEMENT MARKERS
- 886001-01 DETECTOR LOOP INSTALLATIONS
- 886006-01 TYPICAL LAYOUTS FOR DETECTION LOOPS

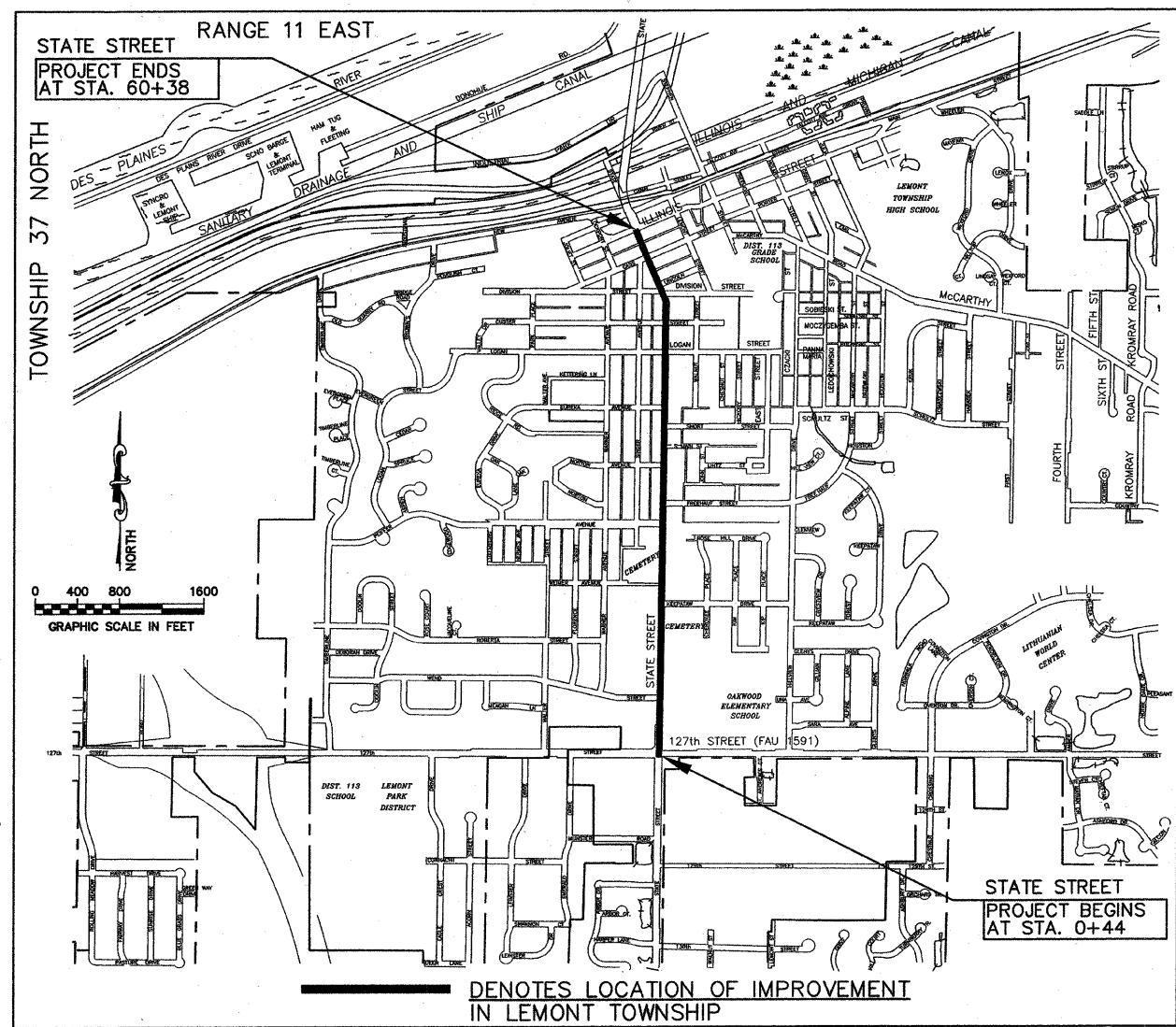

LOCATION MAP

LENGTH OF PROJECT

GROSS LENGTH OF PROJECT 5,994 FEET (1.3523 MILES)
NET LENGTH OF PROJECT 5,994 FEET (1.3523 MILES)

FIELD ENGINEER: MELCHOR MANGOBA (847)705-4408
CONSULTANT: FRANK NOVOTNY AND ASSOCIATES, INC. (630)887-8640

STATE OF ILLINOIS
DEPARTMENT OF TRANSPORTATION
DIVISION OF HIGHWAYS

APPROVED: APRIL 2 2009

VILLAGE PRESIDENT: John F. Piazza
JOHN F. PIAZZA, MAYOR

PASSED: APRIL 06, 2009
Chet Chenneth
DISTRICT #1 ENGINEER OF LOCAL ROADS & STREETS

RELEASING FOR BID BASED ON LIMITED REVIEW: APRIL 6, 2009
Diana M. O'Keefe
DEPUTY DIRECTOR OF HIGHWAYS, REGION #1 ENGINEER

PROJECT LOCATED IN THE VILLAGE OF LEMONT

PRINTED BY THE AUTHORITY OF THE STATE OF ILLINOIS

SEE SHEET 3 FOR DESIGN DETAILS

TRAFFIC DATA:
ADT (2007): 20,300
POSTED SPEED LIMIT = 35 MPH
DESIGN SPEED LIMIT = 35 MPH

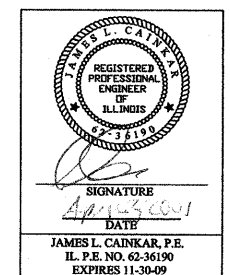
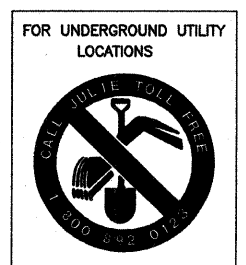

CONTRACT NO. 63174

REVISIONS			
NO.	BY	DATE	DESCRIPTION
1	THK	4/02/09	PER I.D.O.T. REVIEW

Frank Novotny & Associates, Inc.
825 Midway Drive • Willowbrook, IL • 60527 • Telephone: (630) 887-8640 • Fax: (630) 887-0132
ILLINOIS PROFESSIONAL DESIGN FIRM NO. 184-000828

FNA JOB # 07434

GENERAL CONSTRUCTION NOTES PAVING AND STORM SEWERS

SPECIFICATIONS

THE LATEST EDITIONS OF THE "STANDARD SPECIFICATIONS FOR ROAD AND BRIDGE CONSTRUCTION", THE "SUPPLEMENTAL SPECIFICATIONS AND RECURRING SPECIAL PROVISIONS", PREPARED BY THE ILLINOIS DEPARTMENT OF TRANSPORTATION AND THE "MANUAL OF UNIFORM TRAFFIC CONTROL DEVICES" SHALL GOVERN ALL WORK ASSOCIATED WITH THIS PROJECT. THE "STANDARD SPECIFICATIONS FOR WATER AND SEWER MAIN CONSTRUCTION IN ILLINOIS" MAY GOVERN OTHER WORK ON THIS PROJECT AS INDICATED BY REFERENCE.

CARE IN EXCAVATION

CARE SHALL BE EXERCISED BY THE CONTRACTOR IN CARRYING OUT EARTH AND/OR TRENCHING OPERATIONS SO THAT LOCAL SERVICES, WATER VALVES, MANHOLES, CATCH BASINS, INLETS, BUFFALO BOXES, AND OTHER STRUCTURES ARE NOT DAMAGED OR REMOVED. ANY DAMAGE DONE BY THE CONTRACTOR, WHETHER THE STRUCTURE OR SERVICE IS VISIBLE AT THE GROUND SURFACE OR NOT, SHALL BE REPAIRED OR REPLACED BY THE CONTRACTOR AS REQUIRED BY THE ENGINEER AT THE CONTRACTOR'S EXPENSE, AND NO ADDITIONAL COMPENSATION WILL BE ALLOWED.

NOTIFICATION OF PUBLIC UTILITIES

PRIOR TO STARTING CONSTRUCTION, THE CONTRACTOR SHALL NOTIFY THE OFFICIALS OF THE PUBLIC WORKS DEPARTMENT OF THE LOCAL MUNICIPALITY, J.U.L.I.E. AT 1-800-892-0123, AND OTHER PUBLIC AND PRIVATE UTILITIES SO THAT ARRANGEMENTS CAN BE MADE TO LOCATE THEIR VARIOUS FACILITIES WITHIN THE LIMITS OF CONSTRUCTION UNDER THIS CONTRACT, AS WELL AS TO PROVIDE ADEQUATE PROTECTION AND INSPECTION THEREOF. IT SHALL BE THIS CONTRACTOR'S RESPONSIBILITY TO DETERMINE THE ACTUAL LOCATION OF ALL SUCH FACILITIES IN THE FIELD.

TRAFFIC CONTROL DEVICES

BARRICADES AND WARNING SIGNS SHALL BE PROVIDED IN ACCORDANCE WITH ARTICLE 107.14 OF THE "STANDARD SPECIFICATIONS FOR ROAD AND BRIDGE CONSTRUCTION". ADEQUATE LIGHTING SHALL BE MAINTAINED FROM DUSK TO DAWN AT ALL LOCATIONS WHERE CONSTRUCTION OPERATIONS WARRANT, OR AS DESIGNATED BY THE ENGINEER.

PROTECTION OF SIGNS AND PROPERTY

ALL TRAFFIC SIGNS, STREET SIGNS, ETC., THAT INTERFERE WITH THE CONSTRUCTION OPERATIONS SHALL BE REMOVED AND PLACED AT NEW LOCATIONS AS DESIGNATED BY THE ENGINEER. THIS WORK SHALL BE CONSIDERED INCIDENTAL TO THE CONTRACT, AND NO ADDITIONAL COMPENSATION WILL BE ALLOWED. IN ADDITION, ALL MAIL BOXES THAT INTERFERE WITH CONSTRUCTION SHALL BE SIMILARLY RELOCATED AT NO ADDITIONAL COST IN ACCORDANCE WITH ARTICLES 107.20 AND 107.21 OF THE "STANDARD SPECIFICATIONS FOR ROAD AND BRIDGE CONSTRUCTION".

SUPERINTENDENCE

SPECIAL ATTENTION IS DRAWN TO ARTICLE 105.06 OF THE "STANDARD SPECIFICATIONS FOR ROAD AND BRIDGE CONSTRUCTION" WHICH REQUIRES THE CONTRACTOR TO HAVE A COMPETENT SUPERINTENDENT ON THE PROJECT SITE AT ALL TIMES, IRRESPECTIVE OF THE AMOUNT OF WORK SUBJECT. THE SUPERINTENDENT SHALL BE CAPABLE OF READING AND UNDERSTANDING THE PLANS AND SPECIFICATIONS, SHALL HAVE FULL AUTHORITY TO EXECUTE ORDERS TO EXPEDITE THE PROJECT AND SHALL BE RESPONSIBLE FOR SCHEDULING AND HAVING CONTROL OF ALL THE WORK AS THE AGENT OF THE GENERAL CONTRACTOR. FAILURE TO COMPLY WITH THIS PROVISION WILL RESULT IN A SUSPENSION OF WORK AS PROVIDED IN ARTICLE 108.07.

SAWING EXISTING IMPROVEMENTS

ALL PERMANENT TYPE PAVEMENTS OR OTHER PERMANENT IMPROVEMENTS WHICH ABUT THE PROPOSED IMPROVEMENT AND MUST BE REMOVED, SHALL BE SAWED AS DIRECTED PRIOR TO REMOVAL. ALL ITEMS SO REMOVED SHALL BE REPLACED WITH SIMILAR CONSTRUCTION MATERIALS TO THEIR ORIGINAL CONDITION OR BETTER. PAYMENT FOR SAWING SHALL BE INCLUDED IN THE COST FOR THE REMOVAL OF EACH ITEM, AND REPLACEMENT WILL BE PAID FOR UNDER THE RESPECTIVE ITEMS IN THE CONTRACT UNLESS OTHERWISE INDICATED. SAW CUTTING FOR PATCHES WILL BE INCIDENTAL TO THE PATCHING ITEM.

CONSTRUCTION LAYOUT STAKES

THE CONTRACTOR SHALL PROVIDE THE ENGINEER WITH WOODEN STAKES OR OTHER LAYOUT MATERIALS FOR LAYOUT OF THE LINES AND GRADES OF THE PROJECT. FAILURE TO PROVIDE STAKES IN A TIMELY MANNER WILL RESULT IN A DELAY IN STAKEOUT WHICH WILL BE APPLICABLE AGAINST THE TIME LIMIT FOR COMPLETION SHOWN IN THE PROJECT SPECIFICATIONS. LINE AND GRADE WILL BE ESTABLISHED BY THE ENGINEER AT REGULAR INTERVALS ON PERMANENTLY PAVED SURFACES, SIDEWALKS OR STAKES AT THE ENGINEER'S OPTION, ALL WITHIN THE PUBLIC RIGHT-OF-WAY AND SHALL BE TRANSFERRED BY THE CONTRACTOR TO THE ACTUAL LINE OF CONSTRUCTION.

PROJECT SAFETY

BARRICADES: THE CONTRACTOR SHALL PROVIDE AND INSTALL TWO (2) WEIGHTED SAND BAGS ON EACH TYPE I OR TYPE II BARRICADE USED ONE (1) WEIGHTED SAND BAG ACROSS EACH BOTTOM RAIL.

WHEN MILLED PAVEMENT IS OPEN TO TRAFFIC THE MAXIMUM GRADE DIFFERENTIAL BETWEEN PASSES OF THE MILLING MACHINE SHALL NOT EXCEED 1-1/2 INCHES WHERE THE SPEED LIMIT IS 45 MPH OR LESS AND 1 INCH WHERE THE SPEED LIMIT IS GREATER THAN 45 MPH. WITH WRITTEN APPROVAL FROM THE ENGINEER, A MAXIMUM GRADE DIFFERENTIAL OF 3 INCHES MAY BE ALLOWED IF THE EDGE OF THE MILLING IS SLOPED A MINIMUM 1:3 (V:H).

BUTT JOINTS WILL BE INSTALLED AT THE ENDS OF ALL RESURFACING (WHERE RESURFACING MEETS EXISTING PAVEMENT), IN ACCORDANCE WITH THE "BUTT JOINT AND HOT-MIX ASPHALT TAPER DETAILS" SHEET INCLUDED IN THE PLANS, UNLESS OTHERWISE SPECIFIED.

THE CONTRACTOR SHALL COMPLY WITH AND OBSERVE THE RULES AND REGULATIONS OF O.S.H.A. AND APPROPRIATE AUTHORITIES REGARDING SAFETY PROVISIONS. THE CONTRACTOR, ENGINEER, AND OWNER SHALL EACH BE RESPONSIBLE FOR THEIR OWN RESPECTIVE AGENTS AND EMPLOYEES.

THE ENGINEER AND OWNER ARE NOT RESPONSIBLE FOR THE CONSTRUCTION MEANS, METHODS, TECHNIQUES, SEQUENCES OR PROCEDURES, TIME OF PERFORMANCE, PROGRAMS, OR FOR ANY SAFETY PRECAUTIONS USED BY THE CONTRACTOR. THE CONTRACTOR IS SOLELY RESPONSIBLE FOR EXECUTION OF HIS WORK IN ACCORDANCE WITH THE DOCUMENTS AND SPECIFICATIONS.

ALL ITEMS ASSOCIATED WITH CURB AND GUTTER, DRIVEWAYS AND PATCHING WILL NOT EXCEED THE QUANTITIES LISTED IN THE SUMMARY OF QUANTITIES.

DRAINAGE STRUCTURE REPLACEMENT OR RECONSTRUCTION

NOTE: LOCATIONS OF CATCH BASINS AND INLETS TO BE REMOVED AND REPLACED, OR CATCH BASINS AND MANHOLES TO BE RECONSTRUCTED, SHALL BE DETERMINED IN THE FIELD BY THE ENGINEER.

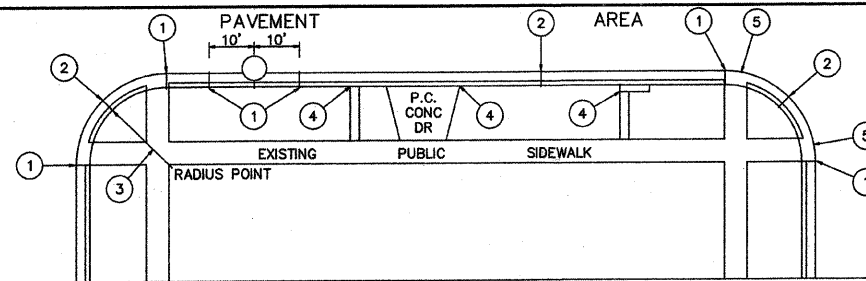

- EXPANSION JOINTS AT TANGENT POINTS AND 150 FOOT INTERVALS, CONSISTING OF ONE INCH PREMOLDED JOINT FILLER MATERIAL WITH #8 DOWEL BARS, 18" IN LENGTH, GREASED, PROVIDE EXPANSION CAP ON ONE END. ALSO CONSTRUCT THIS JOINT TEN FEET EACH SIDE OF PROPOSED UNDERGROUND STRUCTURE.
- CONTRACTION JOINTS AT TWENTY-FIVE FOOT INTERVALS AND AT THE CENTER OF RETURNS.
- ALL RADII SHALL BE 25 FEET TO THE BACK OF CURB UNLESS OTHERWISE DIRECTED BY THE ENGINEER.
- LONGITUDINAL EXPANSION JOINT CONSISTING OF ONE INCH PREMOLDED JOINT FILLER.
- DEPRESS CURB AT LOCATIONS WHERE PUBLIC WALKS INTERSECT CURB LINE AT STREET INTERSECTIONS, ALLEYS, AND OTHER LOCATIONS AS DIRECTED, FOR THE CONSTRUCTION OF RAMPED SIDEWALKS FOR ACCESS BY THE HANDICAPPED.

JOINT DETAILS

SUMMARY OF QUANTITIES

Item No	Description	Unit	Quantity	Code
40600200	BITUMINOUS MATERIALS (PRIME COAT)	TON	10	
40600300	AGGREGATE (PRIME COAT)	TON	25	
40600895	CONSTRUCTING TEST STRIP	EACH	1	
40600982	HOT-MIX ASPHALT SURFACE REMOVAL - BUTT JOINT	SQ YD	239	
40603340	HOT-MIX ASPHALT SURFACE COURSE, MIX "D", N70	TON	2150	
40800050	INCIDENTAL HOT-MIX ASPHALT SURFACING	TON	75	
42300300	PORTLAND CEMENT CONCRETE DRIVEWAY PAVEMENT, 7 INCH	SQ YD	40	
42400200	PORTLAND CEMENT CONCRETE SIDEWALK 5 INCH	SQ FT	1394	
42400800	DETECTABLE WARNINGS	SQ FT	415	
44000158	HOT-MIX ASPHALT SURFACE REMOVAL, 2 1/4"	SQ YD	24925	
44000200	DRIVEWAY PAVEMENT REMOVAL	SQ YD	482	
44000600	SIDEWALK REMOVAL	SQ FT	1394	
44201745	CLASS D PATCHES, TYPE III, 8 INCH	SQ YD	23	
44201747	CLASS D PATCHES, TYPE IV, 8 INCH	SQ YD	213	
60250200	CATCH BASINS TO BE ADJUSTED	EACH	47	
60250300	CATCH BASINS TO BE ADJUSTED (SPECIAL)	EACH	1	
60255500	MANHOLES TO BE ADJUSTED	EACH	2	
60255600	MANHOLES TO BE ADJUSTED (SPECIAL)	EACH	39	
60260100	INLETS TO BE ADJUSTED	EACH	23	
60265700	VALVE VAULTS TO BE ADJUSTED	EACH	1	
60265800	VALVE VAULTS TO BE ADJUSTED (SPECIAL)	EACH	8	
60266610	VALVE BOXES TO BE ADJUSTED (SPECIAL)	EACH	3	
60406000	FRAMES AND LIDS, TYPE 1, OPEN LID	EACH	1	
60406100	FRAMES AND LIDS, TYPE 1, CLOSED LID	EACH	1	
67100100	MOBILIZATION	L.SUM	1	
70101700	TRAFFIC CONTROL AND PROTECTION	L.SUM	1	
70106800	CHANGEABLE MESSAGE SIGN	CAL MO	4	
70300100	SHORT-TERM PAVEMENT MARKING	FOOT	13110	
70301000	WORK ZONE PAVEMENT MARKING REMOVAL	SQ FT	1457	
* 78000100	THERMOPLASTIC PAVEMENT MARKING - LETTERS AND SYMBOLS	SQ FT	1019	
* 78000200	THERMOPLASTIC PAVEMENT MARKING - LINE 4"	FOOT	12648	
* 78000400	THERMOPLASTIC PAVEMENT MARKING - LINE 6"	FOOT	2789	
* 78000600	THERMOPLASTIC PAVEMENT MARKING - LINE 12"	FOOT	342	
* 78000650	THERMOPLASTIC PAVEMENT MARKING - LINE 24"	FOOT	326	
* 78001100	PAINT PAVEMENT MARKING - LETTERS & SYMBOLS	SQ FT	74	
* 78001110	PAINT PAVEMENT MARKING - LINE 4"	FOOT	566	
* 78001130	PAINT PAVEMENT MARKING - LINE 6"	FOOT	386	
* 78001150	PAINT PAVEMENT MARKING - LINE 12"	FOOT	159	
* 78001180	PAINT PAVEMENT MARKING - LINE 24"	FOOT	32	
* 78300200	RAISED REFLECTIVE PAVEMENT MARKER REMOVAL	EACH	150	
* 81400115	HANDHOLES TO BE ADJUSTED	EACH	4	
* 88600600	DETECTOR LOOP REPLACEMENT	FOOT	550	
X4067107	POLYMERIZED LEVELING BINDER (MACHINE METHOD), IL-4.75, N50	TON	1435	
44001100	Combination Concrete Curb and Gutter Removal and Replacement	FOOT	850	
* XX006257	RECESSED REFLECTIVE PAVEMENT MARKER	EACH	305	

REVISIONS

NO.	BY	DATE	DESCRIPTION
1	THK	4/02/09	PER I.D.O.T. REVIEW
2	THK	4/07/09	PER I.D.O.T. REVIEW

GENERAL NOTES
JOINT DETAILS
SUMMARY OF QUANTITIES

FAU RTE	SECTION	COUNTY	TOTAL SHEETS	SHEET NO.
FAU 2916	08-00041-00-RS	COOK	14	2
F.H.W.A. REG.	ILLINOIS	PROJECT	M-8003(981)	

CONTRACT NO. 63174

PROJECT

VILLAGE OF LEMONT, ILLINOIS
STATE STREET LAPP RESURFACING
SECTION 08-00041-00-RS

PROJECT NO.	SCALE	SHEET
07434	NONE	2
DRAWN/DESIGNED JEP/THK	DATE FEB., 2009	OF 14
CHECKED/APPROVED JFP/JLC	FIELD BOOK NO. FILE	SHEETS



Frank Novotny & Associates, Inc.

Civil Engineers / Municipal Consultants
825 Midway Drive • Willowbrook, IL • 60527 • Telephone: (630) 887-8640 • Fax: (630) 887-0132
Illinois Professional Design Firm No. 184-000928

HOT-MIX ASPHALT MIXTURE REQUIREMENTS

FAU RTE	SECTION	COUNTY	TOTAL SHEETS	SHEET NO.
FAU 2916	08-00041-00-RS	COOK	14	3
F.H.W.A. REG.	ILLINOIS	PROJECT	M-8003(981)	

CONTRACT NO. 63174

MIXTURE TYPE	AC TYPE	PERCENT AIR VOIDS
ROADWAY		
HOT-MIX ASPHALT SURFACE COURSE, MIX "D", N70, 1-1/2" (IL-9.5mm)	PG 64-22	4% @ 70 GYR
POLYMERIZED LEVELING BINDER (MACHINE METHOD), IL-4.75, N50, 1"	SBS/SBR PG 76-28/-22	4% @ 50 GYR
DRIVEWAYS		
INCIDENTAL HOT-MIX ASPHALT SURFACING, MIX "C", N50, (IL 9.5 mm), 3"	PG 64-22	4% @ 50 GYR
PATCHING		
CLASS D PATCHES, TYPE III-IV, 8", (HMA BINDER IL-19.0mm)	*PG 64-22	4% @ 70 GYR

THE UNIT WEIGHT TO CALCULATE ALL HOT-MIX ASPHALT SURFACE MIXTURE QUANTITIES IS 112 LBS/SQ YD/IN.
* WHEN RAP EXCEEDS 20%, THE NEW ASPHALT BINDER IN THE MIX SHALL BE PG 58-22.

IMPORTANT!

FULL SIZE PLANS HAVE BEEN PREPARED USING STANDARD ENGINEERING SCALES. REDUCED PLANS WILL NOT CONFORM TO STANDARD SCALES INDICATED IN TITLE BLOCK.

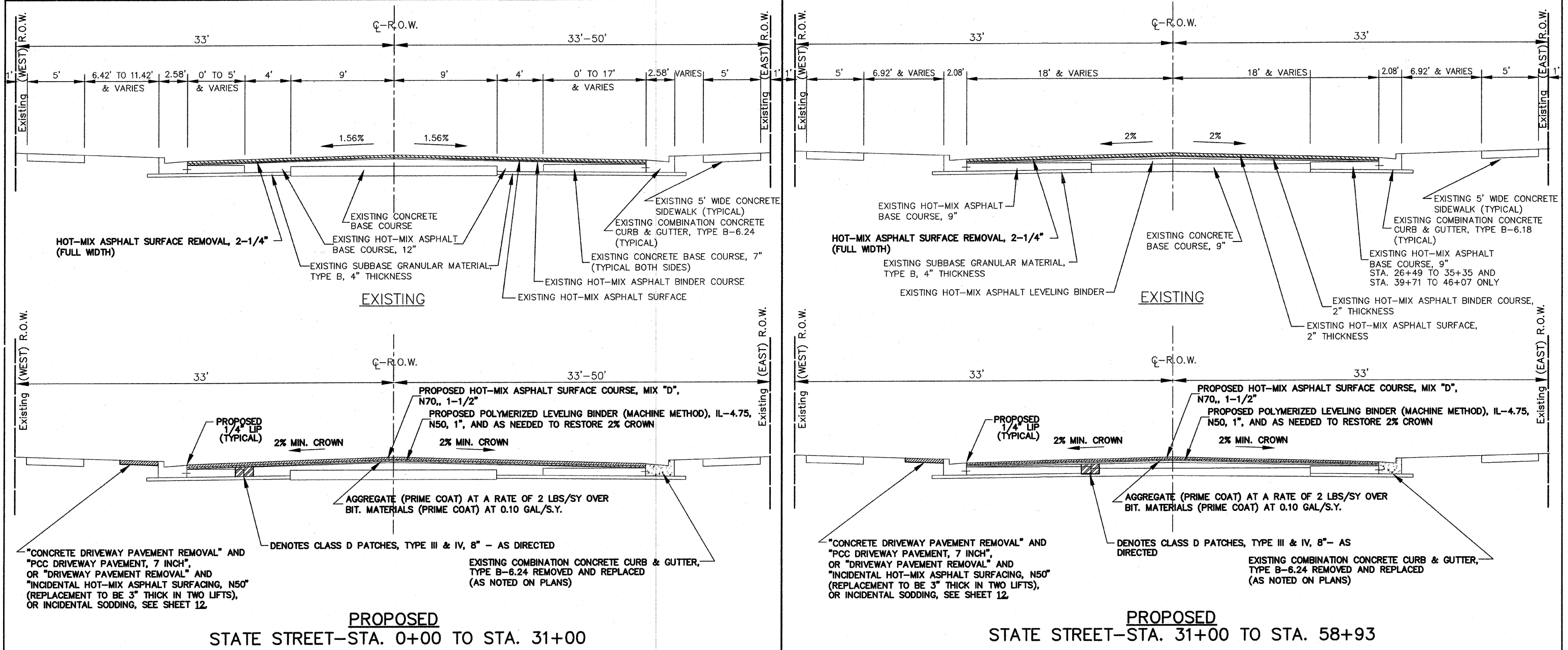

TYPICAL CROSS SECTIONS

SCALE: 1"=4'

Frank Novotny & Associates, Inc.

Civil Engineers/ Municipal Consultants 825 Midway Drive • Willowbrook, IL • 60527 • Telephone: (630) 887-8640 • Fax: (630) 887-0132
Illinois Professional Design Firm No. 184-000928

PROJECT **VILLAGE OF LEMONT, ILLINOIS**
STATE STREET LAPP RESURFACING
SECTION 08-00041-00-RS

R E V I S I O N S			
NO.	BY	DATE	DESCRIPTION
1	THK	4/02/09	PER I.D.O.T. REVIEW
2	THK	4/07/09	PER I.D.O.T. REVIEW

TYPICAL CROSS SECTIONS
HOT-MIX ASPHALT
MIXTURE REQUIREMENTS

PROJECT NO. 07434	SCALE AS NOTED	SHEET 3 OF 14 SHEETS
DRAWN/DESIGNED JEP/THK	DATE FEB., 2009	
CHECKED/APPROVED JFP/JLC	FIELD BOOK NO. FILE	

FAU RTE	SECTION	COUNTY	TOTAL SHEETS	SHEET NO.
FAU 2916	08-00041-00-RS	COOK	14	4
F.H.W.A. REG.	ILLINOIS PROJECT	M-8003(981)		

CONTRACT NO. 63174

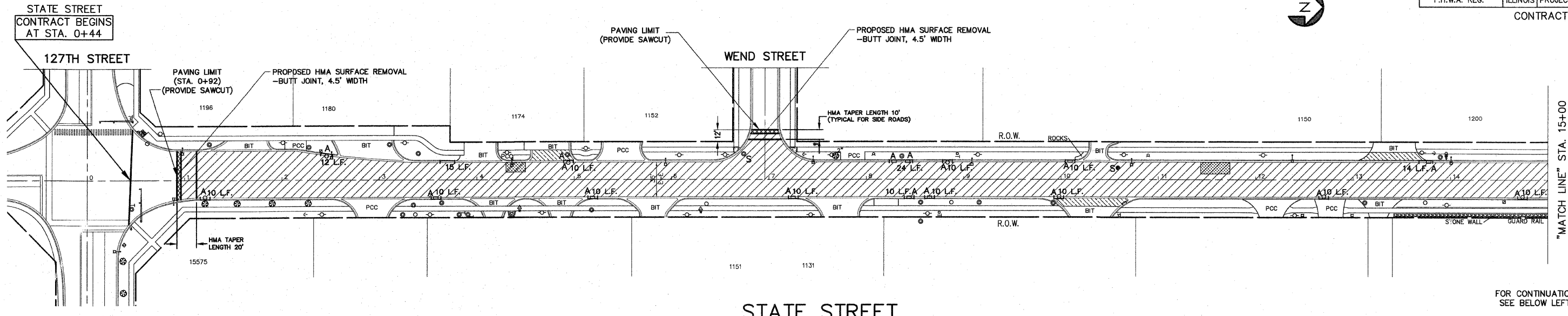

STATE STREET

FOR CONTINUATION
SEE BELOW LEFT

LEGEND

- DENOTES HOT-MIX ASPHALT SURFACE REMOVAL (SEE SHEET 3 FOR SCOPE OF WORK)
- DENOTES HOT-MIX ASPHALT SURFACE REMOVAL-BUTT JOINT, (4.5' WIDTH)
- DENOTES DRIVEWAY PAVEMENT REMOVAL, 3" AND INCIDENTAL HOT-MIX ASPHALT SURFACING, 3"
- DENOTES CLASS D PATCHES, TYPE III-IV, 8", - AS DIRECTED
- DENOTES PCC DRIVEWAY REMOVAL AND REPLACEMENT
- DENOTES P.C. CONCRETE SIDEWALK, 5" REMOVAL & REPLACEMENT, WITH TACTILE STRIP FOR HANDICAP RAMPS PER I.D.O.T. STANDARD 424001-05 (DETECTABLE WARNINGS)

- "A" DENOTES EXISTING VALVE VAULTS, VALVE BOXES, INLETS, CATCH BASINS, MANHOLES AND HANDHOLES TO BE CLEANED, GROUDED, AND ADJUSTED TO GRADE WITH NEW ADJUSTING RINGS. (ALL TOP BANDS OF FALLEN, COMMON OR CONCRETE BRICK TO BE REPLACED WITH PRECAST CONCRETE ADJUSTING RINGS)
- "S" DENOTES EXISTING STRUCTURES TO BE ADJUSTED (SPECIAL) (SEE SHEET 12 FOR DETAIL)
- 8 FT DENOTES COMBINATION CONCRETE CURB & GUTTER REMOVAL AND REPLACEMENT PROVIDE DETECTABLE WARNINGS AND RAMPS AT ALL SIDEWALK

FOR TYPICAL CROSS SECTION OF NEW PAVEMENT WORK
SEE SHEET 3

- NOTE:**
- 1 ALL EXISTING FRAMES AND LIDS THAT ARE TO BE REPLACED (AS DIRECTED BY THE ENGINEER) SHALL BE SALVAGED TO THE CONTRACTOR.
 - 2 ALL SAW CUTS SHALL BE CONSIDERED INCIDENTAL TO THE CONTRACT

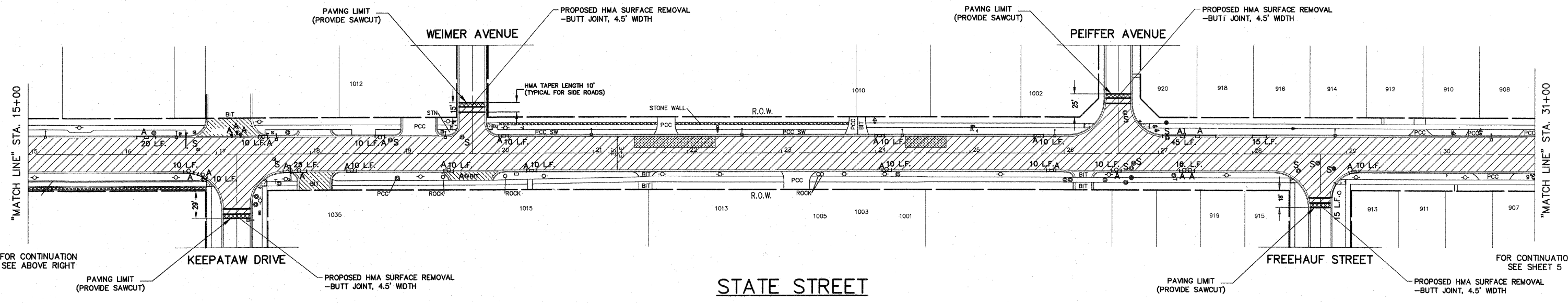

STATE STREET

IMPORTANT!
FULL SIZE PLANS HAVE BEEN PREPARED USING STANDARD ENGINEERING SCALES. REDUCED SIZED PLANS WILL NOT CONFORM TO STANDARD SCALES INDICATED IN TITLE BLOCK.

Frank Novotny & Associates, Inc.
Civil Engineers/Municipal Consultants
825 Midway Drive • Willowbrook, IL • 60527 • Telephone: (630) 887-8640 • Fax: (630) 887-0132
Illinois Professional Design Firm No. 184-000928

PROJECT
VILLAGE OF LEMONT, ILLINOIS
STATE STREET LAPP RESURFACING
SECTION 08-00041-00-RS

REVISIONS			
NO.	BY	DATE	DESCRIPTION
1	THK	4/02/09	PER I.D.O.T. REVIEW

PLAN:
STATE STREET-
127TH ST. to STA. 31+00
(RESURFACING)

PROJECT NO. 07434	SCALE 1"=50'	SHEET 4
DRAWN/DESIGNED JEP/THK	DATE FEB., 2009	OF 14
CHECKED/APPROVED JFP/JLC	FIELD BOOK NO. FILE	SHEETS

FAU RTE	SECTION	COUNTY	TOTAL SHEETS	SHEET NO.
FAU 2916	08-00041-00-RS	COOK	14	5
F.H.W.A. REG.	ILLINOIS	PROJECT	M-8003(981)	

CONTRACT NO. 63174

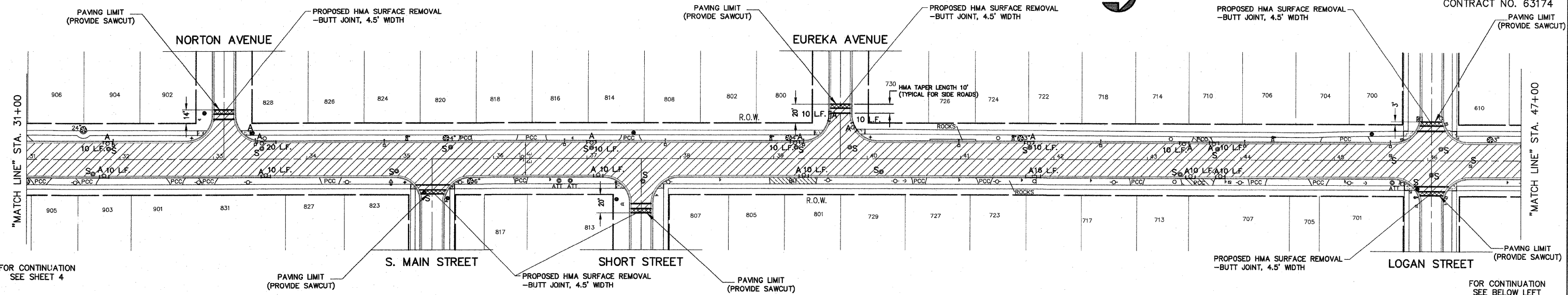

FOR CONTINUATION SEE SHEET 4

FOR CONTINUATION SEE BELOW LEFT

LEGEND

- DENOTES HOT-MIX ASPHALT SURFACE REMOVAL (SEE SHEET 3 FOR SCOPE OF WORK)
- DENOTES HOT-MIX ASPHALT SURFACE REMOVAL-BUTT JOINT, (4.5' WIDTH)
- DENOTES DRIVEWAY PAVEMENT REMOVAL, 3" AND INCIDENTAL HOT-MIX ASPHALT SURFACING, 3"
- DENOTES CLASS D PATCHES, TYPE III-IV, 8", - AS DIRECTED
- DENOTES PCC DRIVEWAY REMOVAL AND REPLACEMENT
- DENOTES P.C. CONCRETE SIDEWALK, 5" REMOVAL & REPLACEMENT, WITH TACTILE STRIP FOR HANDICAP RAMPS PER I.D.O.T. STANDARD 424001-05 (DETECTABLE WARNINGS)
- "A"** DENOTES EXISTING VALVE VAULTS, VALVE BOXES, INLETS, CATCH BASINS, MANHOLES AND HANDHOLES TO BE CLEANED, GROUTED, AND ADJUSTED TO GRADE WITH NEW ADJUSTING RINGS. (ALL TOP BANDS OF FALLEN, COMMON OR CONCRETE BRICK TO BE REPLACED WITH PRECAST CONCRETE ADJUSTING RINGS)
- "S"** DENOTES EXISTING STRUCTURES TO BE ADJUSTED (SPECIAL) (SEE SHEET 12 FOR DETAIL)
- 8 FT DENOTES COMBINATION CONCRETE CURB & GUTTER REMOVAL AND REPLACEMENT PROVIDE DETECTABLE WARNINGS AND RAMPS AT ALL SIDEWALK

STATE STREET CONTRACT ENDS AT STA. 60+38

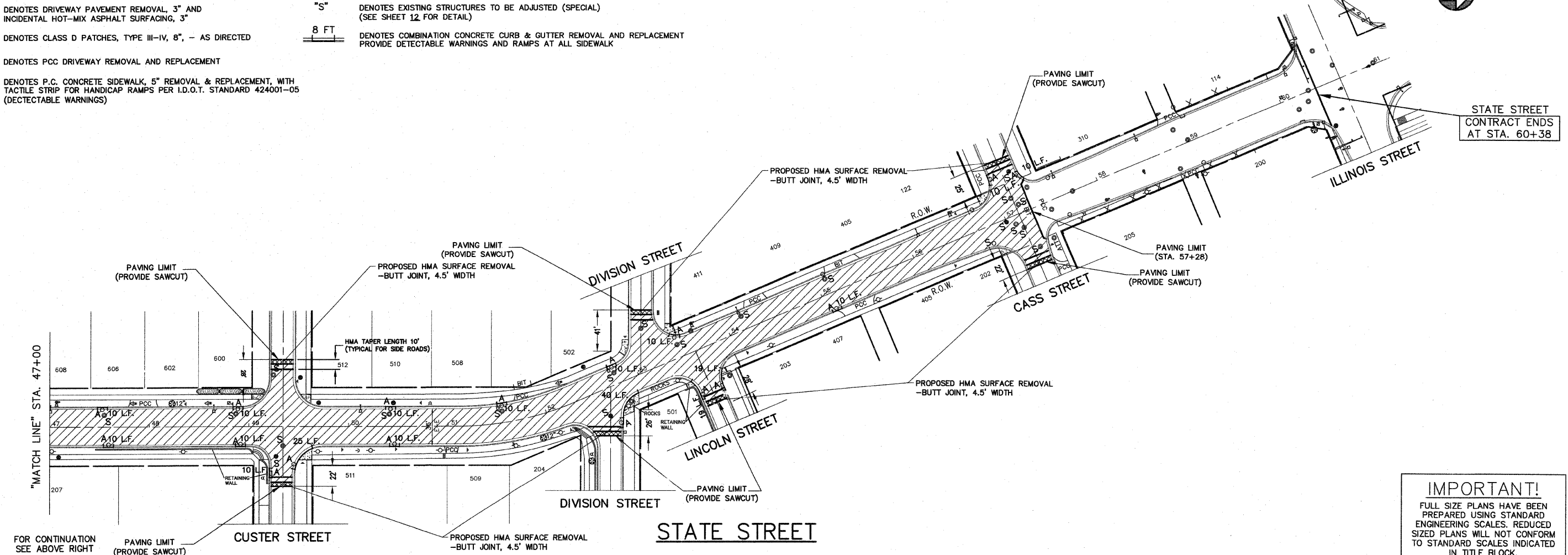

FOR CONTINUATION SEE ABOVE RIGHT

IMPORTANT!
FULL SIZE PLANS HAVE BEEN PREPARED USING STANDARD ENGINEERING SCALES. REDUCED SIZE PLANS WILL NOT CONFORM TO STANDARD SCALES INDICATED IN TITLE BLOCK.

Frank Novotny & Associates, Inc.
Civil Engineers/Municipal Consultants
825 Midway Drive ♦ Willowbrook, IL ♦ 60527 ♦ Telephone: (630) 887-8640 ♦ Fax: (630) 887-0132
Illinois Professional Design Firm No. 184-000928

PROJECT
VILLAGE OF LEMONT, ILLINOIS
STATE STREET LAPP RESURFACING
SECTION 08-00041-00-RS

REVISIONS			
NO.	BY	DATE	DESCRIPTION
1	THK	4/02/09	PER I.D.O.T. REVIEW

PLAN
STATE STREET-
STA. 31+00 TO ILLINOIS ST.
(RESURFACING)

PROJECT NO. 07434	SCALE 1"=50'	SHEET 5 OF 14 SHEETS
DRAWN/DESIGNED JEP/THK	DATE FEB., 2009	
CHECKED/APPROVED JFP/JLC	FIELD BOOK NO. FILE	

FAU RTE	SECTION	COUNTY	TOTAL SHEETS	SHEET NO.
2916	08-00041-00-RS	COOK	14	6
F.H.W.A. REG.	ILLINOIS PROJECT	M-8003(981)		

CONTRACT NO. 63174

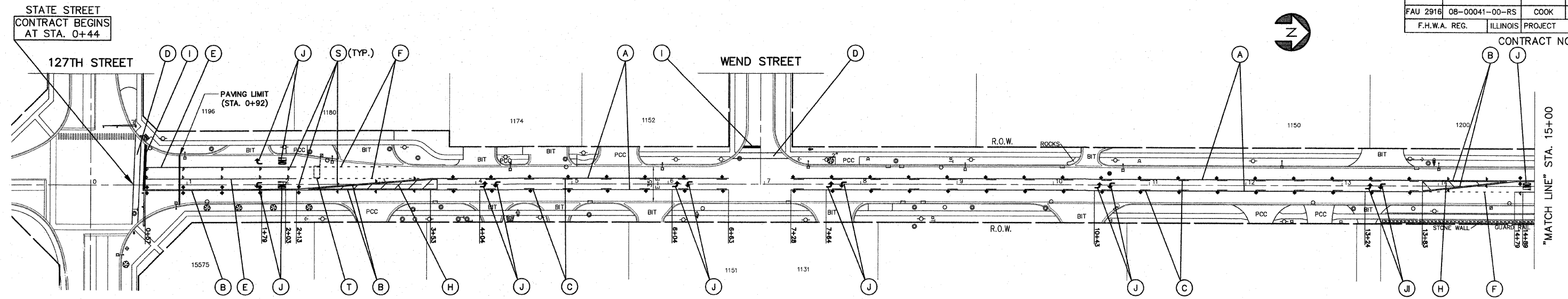

STATE STREET

FOR CONTINUATION SEE BELOW LEFT

THERMOPLASTIC STRIPING CODE

- (A) PROPOSED SOLID YELLOW THERMOPLASTIC PAVEMENT MARKING - LINE 4" (LANE LINE)
- (B) PROPOSED DOUBLE SOLID YELLOW THERMOPLASTIC PAVEMENT MARKING - CENTER LINE 4", 11" O/C
- (C) PROPOSED SKIP-DASH YELLOW THERMOPLASTIC PAVEMENT MARKING - LINE 4" - 10' DASH, 30' SKIP (LANE LINE)
- (D) PROPOSED SOLID WHITE THERMOPLASTIC PAVEMENT MARKING - LINE 6" (CROSSWALK LINE)
- (E) PROPOSED SOLID WHITE THERMOPLASTIC PAVEMENT MARKING - LINE 6" (LANE LINE)
- (F) PROPOSED SOLID WHITE THERMOPLASTIC PAVEMENT MARKING - LINE 6" - 2' DASH, 6' SKIP (LANE LINE)
- (G) PROPOSED SOLID WHITE THERMOPLASTIC PAVEMENT MARKING - LINE 12" (PEDESTRIAN SCHOOL CROSSING)
- (H) PROPOSED SOLID YELLOW THERMOPLASTIC PAVEMENT MARKING - LINE 12", 45° DIAGONALS, (MEDIAN LINE)
- (I) PROPOSED SOLID WHITE THERMOPLASTIC PAVEMENT MARKING - LINE 24" (STOP BAR)
- (J) PROPOSED SOLID WHITE THERMOPLASTIC PAVEMENT MARKING - LETTERS & SYMBOLS

NOTE:
ALL "ARROWS" AND "ONLYS" SHALL BE 8" IN HEIGHT.

NOTE:
PROPOSED DOUBLE SOLID YELLOW THERMOPLASTIC PAVEMENT MARKING - CENTER LINE 4", 11" O/C (NOTE: (B)) IS MEASURED PER LINE. TOTAL QUANTITY AND PAYMENT LENGTH IS FOR EACH LINEAR FOOT OF SINGLE 4" STRIPE INSTALLED.

NOTE:
SHORT-TERM PAVEMENT MARKING IS PROPOSED ON THE MILLED PAVEMENT, NEW BINDER AND ON THE NEW SURFACE. SEE ARTICLE 703.04 OF THE LATEST EDITION OF THE "STANDARD SPECIFICATIONS FOR ROAD AND BRIDGE CONSTRUCTION".

REFLECTIVE PAVEMENT MARKERS

- (S) PROPOSED RECESSED REFLECTIVE PAVEMENT MARKERS - 80' O/C OR AS SHOWN
 - ◆ TWO-WAY AMBER MARKER
 - ▶ ONE-WAY AMBER MARKER
 - ▷ ONE-WAY CRYSTAL MARKER

DETECTOR LOOPS

- (T) PROPOSED DETECTOR LOOP REPLACEMENT

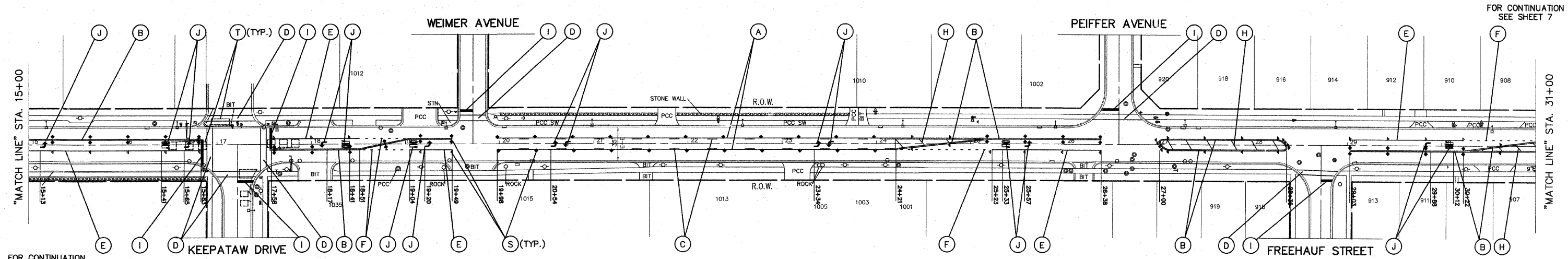

STATE STREET

FOR CONTINUATION SEE ABOVE RIGHT

FOR CONTINUATION SEE SHEET 7

IMPORTANT!
FULL SIZE PLANS HAVE BEEN PREPARED USING STANDARD ENGINEERING SCALES. REDUCED SIZED PLANS WILL NOT CONFORM TO STANDARD SCALES INDICATED IN TITLE BLOCK.

Frank Novotny & Associates, Inc.
Civil Engineers/Municipal Consultants
825 Midway Drive • Willowbrook, IL • 60527 • Telephone: (630) 887-8640 • Fax: (630) 887-0132
Illinois Professional Design Firm No. 184-000928

PROJECT
VILLAGE OF LEMONT, ILLINOIS
STATE STREET LAPP RESURFACING
SECTION 08-00041-00-RS

REVISIONS			
NO.	BY	DATE	DESCRIPTION
1	THK	4/02/09	PER I.D.O.T. REVIEW

PLAN:
STATE STREET-
127TH ST. to STA. 31+00
(PAVEMENT MARKING)

PROJECT NO. 07434	SCALE 1"=50'	SHEET 6
DRAWN/DESIGNED JEP/THK	DATE FEB., 2009	OF 14
CHECKED/APPROVED JFP/JLC	FIELD BOOK NO. FILE	SHEETS

FAU RTE	SECTION	COUNTY	TOTAL SHEETS	SHEET NO.
FAU 2916	08-00041-00-RS	COOK	14	7
F.H.W.A. REG.	ILLINOIS PROJECT	M-8003(981)		

CONTRACT NO. 63174

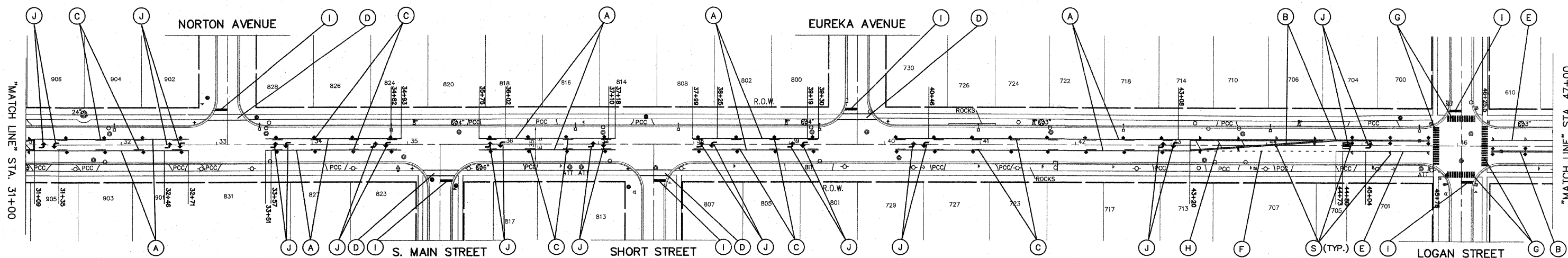

FOR CONTINUATION
SEE SHEET 6

FOR CONTINUATION
SEE BELOW LEFT

THERMOPLASTIC STRIPING CODE

- (A) PROPOSED SOLID YELLOW THERMOPLASTIC PAVEMENT MARKING - LINE 4" (LANE LINE)
- (B) PROPOSED DOUBLE SOLID YELLOW THERMOPLASTIC PAVEMENT MARKING - CENTER LINE 4", 11" O/C
- (C) PROPOSED SKIP-DASH YELLOW THERMOPLASTIC PAVEMENT MARKING - LINE 4" - 10' DASH, 30' SKIP (LANE LINE)
- (D) PROPOSED SOLID WHITE THERMOPLASTIC PAVEMENT MARKING - LINE 6" (CROSSWALK LINE)
- (E) PROPOSED SOLID WHITE THERMOPLASTIC PAVEMENT MARKING - LINE 6" (LANE LINE)
- (F) PROPOSED SOLID WHITE THERMOPLASTIC PAVEMENT MARKING - LINE 6" - 2' DASH, 6' SKIP (LANE LINE)
- (G) PROPOSED SOLID WHITE THERMOPLASTIC PAVEMENT MARKING - LINE 12" (PEDESTRIAN SCHOOL CROSSING)
- (H) PROPOSED SOLID YELLOW THERMOPLASTIC PAVEMENT MARKING - LINE 12", 45' DIAGONALS, (MEDIAN LINE)
- (I) PROPOSED SOLID WHITE THERMOPLASTIC PAVEMENT MARKING - LINE 24" (STOP BAR)
- (J) PROPOSED SOLID WHITE THERMOPLASTIC PAVEMENT MARKING - LETTERS & SYMBOLS

PAINTED STRIPING CODE

- (K) PROPOSED DOUBLE SOLID YELLOW PAINTED PAVEMENT MARKING - CENTER LINE 4", 11" O/C
- (L) PROPOSED SKIP-DASH YELLOW PAINTED PAVEMENT MARKING - LINE 4" - 10' DASH, 30' SKIP (LANE LINE)
- (M) PROPOSED SOLID WHITE PAINTED PAVEMENT MARKING - LINE 6" (LANE LINE)
- (N) PROPOSED SOLID WHITE PAINTED PAVEMENT MARKING - LINE 6" (BICYCLE & EQUESTRIAN)
- (O) PROPOSED SOLID WHITE PAINTED PAVEMENT MARKING - LINE 6" - 2' DASH, 6' SKIP (LANE LINE)
- (P) PROPOSED SOLID WHITE PAINTED PAVEMENT MARKING - LINE 12", 45' DIAGONALS (BICYCLE & EQUESTRIAN)
- (Q) PROPOSED SOLID WHITE PAINTED PAVEMENT MARKING - LINE 24" (STOP BAR)
- (R) PROPOSED SOLID WHITE PAINTED PAVEMENT MARKING - LETTERS & SYMBOLS

REFLECTIVE PAVEMENT MARKERS

- (S) PROPOSED RECESSED REFLECTIVE PAVEMENT MARKERS - 80' O/C OR AS SHOWN
 - ◆ TWO-WAY AMBER MARKER
 - ▶ ONE-WAY AMBER MARKER
 - ▶ ONE-WAY CRYSTAL MARKER

NOTE:
ALL "ARROWS" AND "ONLYS" SHALL BE 8" IN HEIGHT.

NOTE:
PROPOSED DOUBLE SOLID YELLOW THERMOPLASTIC PAVEMENT MARKING - CENTER LINE 4", 11" O/C (NOTE: (B) & (K)) IS MEASURED PER LINE. TOTAL QUANTITY AND PAYMENT LENGTH IS FOR EACH LINEAR FOOT OF SINGLE 4" STRIPE INSTALLED.

NOTE:
SHORT-TERM PAVEMENT MARKING IS PROPOSED ON THE MILLED PAVEMENT, NEW BINDER AND ON THE NEW SURFACE. SEE ARTICLE 703.04 OF THE LATEST EDITION OF THE "STANDARD SPECIFICATIONS FOR ROAD AND BRIDGE CONSTRUCTION".

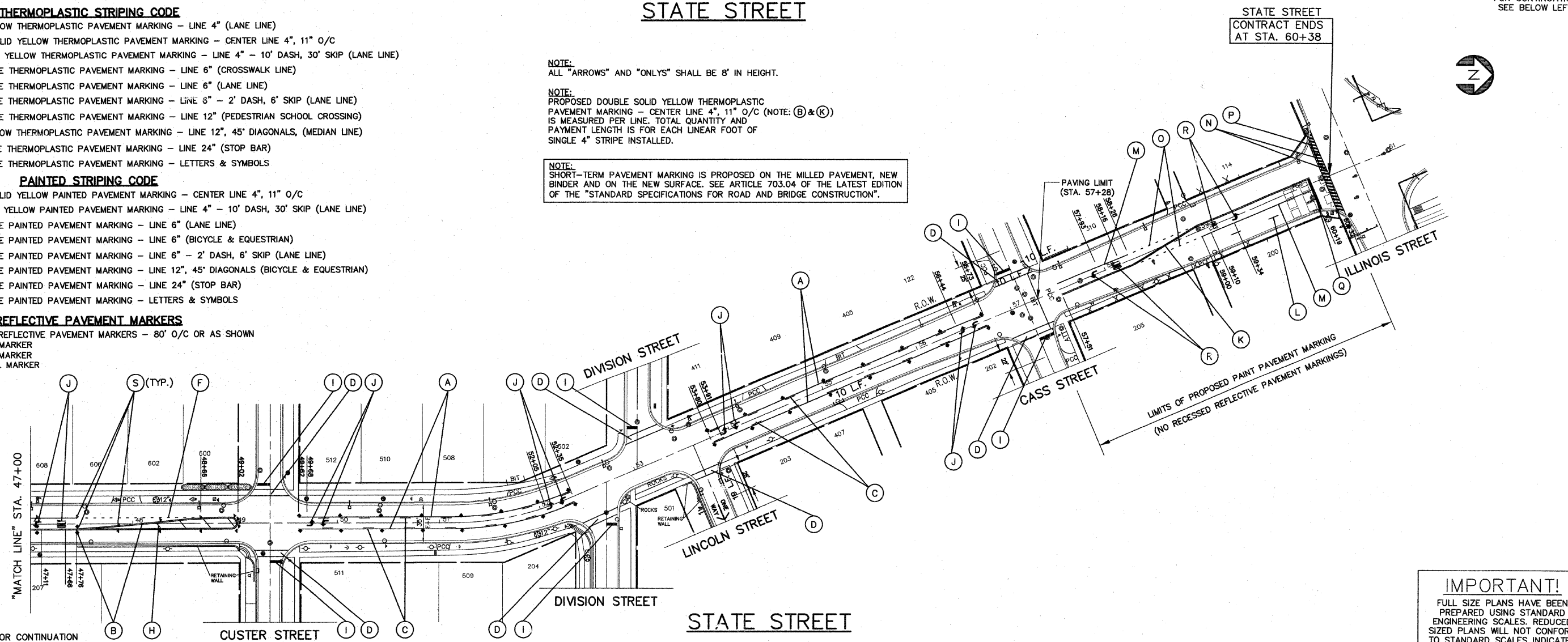

FOR CONTINUATION
SEE ABOVE RIGHT

IMPORTANT!
FULL SIZE PLANS HAVE BEEN PREPARED USING STANDARD ENGINEERING SCALES. REDUCED SIZED PLANS WILL NOT CONFORM TO STANDARD SCALES INDICATED IN TITLE BLOCK.

Frank Novotny & Associates, Inc.
Civil Engineers/Municipal Consultants
825 Midway Drive • Willowbrook, IL • 60527 • Telephone: (630) 887-8640 • Fax: (630) 887-0132
Illinois Professional Design Firm No. 184-000928

PROJECT
VILLAGE OF LEMONT, ILLINOIS
STATE STREET LAPP RESURFACING
SECTION 08-00041-00-RS

REVISIONS			
NO.	BY	DATE	DESCRIPTION
1	THK	4/02/09	PER I.D.O.T. REVIEW

PLAN
STATE STREET-
STA. 31+00 TO ILLINOIS ST.
(PAVEMENT MARKING)

PROJECT NO. 07434	SCALE 1"=50'	SHEET 7
DRAWN/DESIGNED JEP/THK	DATE FEB., 2009	OF 14
CHECKED/APPROVED JFP/JLC	FIELD BOOK NO. FILE	SHEETS

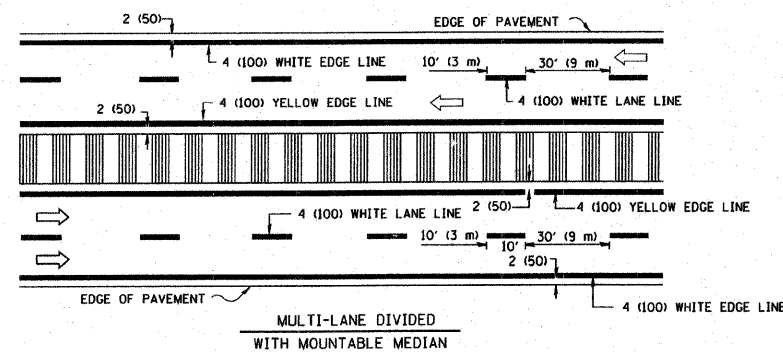
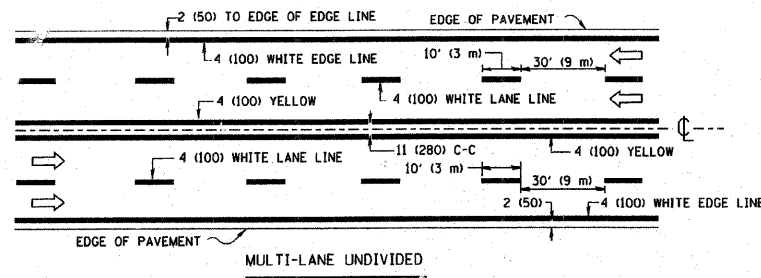
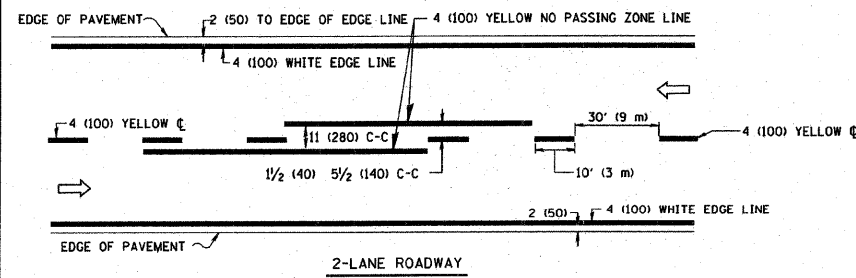

NOTE: MEDIANS WITH BARRIER CURB DO NOT REQUIRE AN EDGE LINE

TYPICAL LANE AND EDGE LINE MARKING

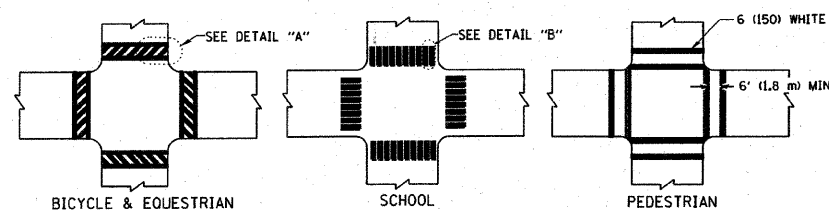

TYPICAL CROSSWALK MARKING

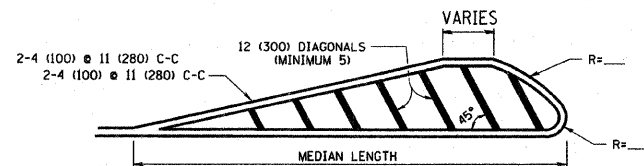
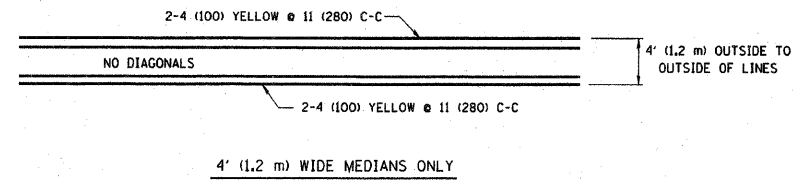
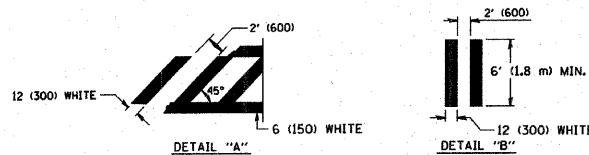

FOR MEDIAN LENGTHS WHERE DIAGONAL SPACING CANNOT BE ATTAINED, USE 5 (FIVE) EQUALLY SPACED DIAGONAL LINES.

DIAGONAL LINE SPACING: 50' (15 m) C-C (LESS THAN 30MPH (50 km/h))
 75' (25 m) C-C 30MPH (50 km/h) TO 45MPH (70 km/h)
 150' (45 m) C-C (MORE THAN 45MPH (70 km/h))

MEDIANS OVER 4' (1.2 m) WIDE

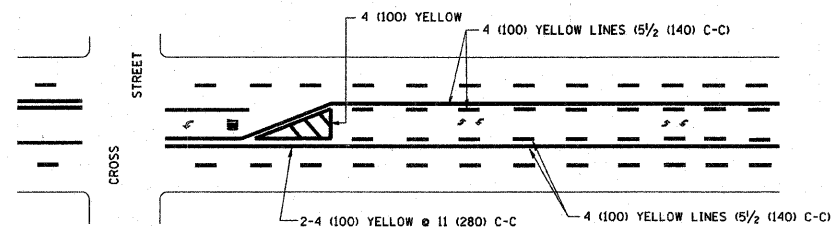

A MINIMUM OF TWO PAIRS OF TURN ARROWS SHALL BE USED, WHITE IN COLOR. ADDITIONAL PAIRS SHALL BE PLACED AT 200' (60 m) TO 300' (90 m) INTERVALS.

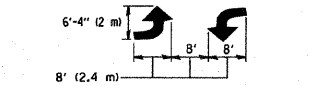

TYPICAL PAINTED MEDIAN MARKING

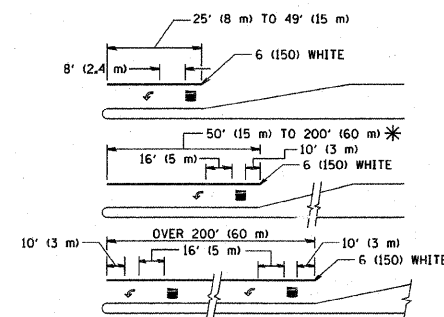

FULL SIZE LETTERS 8' (2.4 m) AND ARROWS SHALL BE USED.
 AREA = 15.6 SQ. FT. (1.5 m²) ONLY AREA = 20.8 SQ. FT. (1.9 m²)

* TURN LANES IN EXCESS OF 400' (120 m) IN LENGTH MAY HAVE AN ADDITIONAL SET OF ARROW - "ONLY" INSTALLED MIDWAY BETWEEN THE OTHER TWO SETS OF ARROW - "ONLY".

TYPICAL LEFT (OR RIGHT) TURN LANE

TYPICAL TURN LANE MARKING

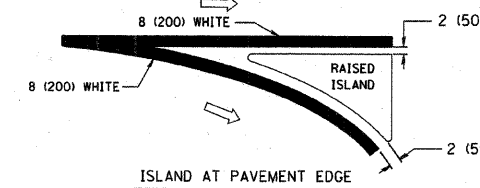
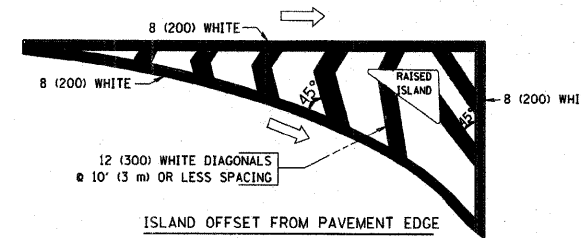

TYPICAL ISLAND MARKING

TYPE OF MARKING	WIDTH OF LINE	PATTERN	COLOR	SPACING / REMARKS
CENTERLINE ON 2 LANE PAVEMENT	4 (100)	SKIP-DASH	YELLOW	10' (3 m) LINE WITH 30' (9 m) SPACE
CENTERLINE ON MULTI-LANE UNDIVIDED PAVEMENT	2 @ 4 (100)	SOLID	YELLOW	11 (280) C-C
NO PASSING ZONE LINES: FOR ONE DIRECTION FOR BOTH DIRECTIONS	4 (100) 2 @ 4 (100)	SOLID SOLID	YELLOW YELLOW	5/2 (140) C-C FROM SKIP-DASH CENTERLINE 11 (280) C-C OMIT SKIP-DASH CENTERLINE BETWEEN
LANE LINES	4 (100) 5 (125) ON FREEWAYS	SKIP-DASH SKIP-DASH	WHITE WHITE	10' (3 m) LINE WITH 30' (9 m) SPACE
DOTTED LINES (EXTENSIONS OF CENTER, LANE OR TURN LANE MARKINGS)	SAME AS LINE BEING EXTENDED	SKIP-DASH	SAME AS LINE BEING EXTENDED	2' (600) LINE WITH 6' (1.8 m) SPACE
EDGE LINES	4 (100)	SOLID	YELLOW-LEFT WHITE-RIGHT	OUTLINE MOUNTABLE MEDIANS IN YELLOW; EDGE LINES ARE NOT USED NEXT TO BARRIER CURB
TURN LANE MARKINGS	6 (150) LINE; FULL SIZE LETTERS & SYMBOLS (8' (2.4m))	SOLID	WHITE	SEE TYPICAL TURN LANE MARKING DETAIL
TWO WAY LEFT TURN MARKING	2 @ 4 (100) EACH DIRECTION 8' (2.4m) LEFT ARROW	SKIP-DASH AND SOLID IN PAIRS	YELLOW WHITE	10' (3 m) LINE WITH 30' (9 m) SPACE FOR SKIP-DASH; 5/2 (140) C-C BETWEEN SOLID LINE AND SKIP-DASH LINE SEE TYPICAL TWO-WAY LEFT TURN MARKING DETAIL
CROSSWALK LINES (PEDESTRIAN) A. DIAGONALS (BIKE & EQUESTRIAN) B. LONGITUDINAL BARS (SCHOOL)	2 @ 6 (150) 12 (300) @ 45° 12 (300) @ 90°	SOLID SOLID SOLID	WHITE WHITE WHITE	NOT LESS THAN 6' (1.8 m) APART 2' (600) APART 2' (600) APART SEE TYPICAL CROSSWALK MARKING DETAILS.
STOP LINES	24 (600)	SOLID	WHITE	PLACE 4' (1.2 m) IN ADVANCE OF AND PARALLEL TO CROSSWALK, IF PRESENT. OTHERWISE, PLACE AT DESIRED STOPPING POINT, PARALLEL TO CROSSROAD CENTERLINE, WHERE POSSIBLE
PAINTED MEDIANS	2 @ 4 (100) WITH 12 (300) DIAGONALS @ 45° NO DIAGONALS USED FOR 4' (1.2 m) WIDE MEDIANS	SOLID	YELLOW; TWO WAY TRAFFIC WHITE; ONE WAY TRAFFIC	11 (280) C-C FOR THE DOUBLE LINE SEE TYPICAL PAINTED MEDIAN MARKING.
GORE MARKING AND CHANNELIZING LINES	8 (200) WITH 12 (300) DIAGONALS @ 45°	SOLID	WHITE	DIAGONALS: 15' (4.5 m) C-C (LESS THAN 30MPH (50 km/h)) 20' (6 m) C-C 30MPH (50 km/h) TO 45MPH (70 km/h) 30' (9 m) C-C (OVER 45MPH (70 km/h))
RAILROAD CROSSING	24 (600) TRANSVERSE LINES; "RR" 15' (4.5 m) LINE FOR "X"	SOLID	WHITE	SEE STATE STANDARD 780001 AREA OF: "R"=3.6 SQ. FT. (0.33 m ²) EACH "X"=54.0 SQ. FT. (5.0 m ²)
SHOULDER DIAGONALS	12 (300) @ 45°	SOLID	WHITE - RIGHT YELLOW - LEFT	50' (15 m) C-C (LESS THAN 30MPH (50 km/h)) 75' (25 m) C-C (30 MPH (50 km/h) TO 45MPH (70 km/h)) 150' (45 m) C-C (OVER 45MPH (70 km/h))

FOR FURTHER DETAILS ON PAVEMENT MARKING REFER TO STANDARD SPECIFICATIONS FOR ROAD AND BRIDGE CONSTRUCTION AND STATE STANDARD 780001.

	LARGE SIZE	SMALL SIZE
THROUGH ARROW	1.07 (11.5)	0.60 (6.5)
LEFT OF RIGHT ARROW	1.47 (15.8)	0.60 (6.5)
COMBINATION LEFT (RIGHT) AND THROUGH ARROW	2.42 (26.0)	1.37 (14.7)
RAILROAD "R" 1.8m (6ft.)	0.33 (3.6)	-
RAILROAD "X" 6.1m (20ft.)	5.02(54.0)	-
HANDICAPPED SYMBOL	0.43 (4.6)	-

REVISIONS	
NAME	DATE
EVERS	03-19-90
T. RAMMACHER	10-27-94
ALEX HOUSEH	10-09-96
ALEX HOUSEH	10-17-96
T. RAMMACHER	01-06-00

ILLINOIS DEPARTMENT OF TRANSPORTATION
 DISTRICT ONE
 TYPICAL PAVEMENT MARKINGS

SCALE: NONE
 DRAWN BY CADD
 CHECKED BY
 TC-13

PLOT DATE = 3/6/2007
 PLOT SCALE = 50.0000 / IN.
 USER NAME = bnewell



Frank Novotny & Associates, Inc.

825 Midway Drive ♦ Willowbrook, IL ♦ 60527 ♦ Telephone: (630) 887-8640 ♦ Fax: (630) 887-0132
 Illinois Professional Design Firm No. 184-000928

PROJECT

VILLAGE OF LEMONT, ILLINOIS
 STATE STREET LAPP RESURFACING
 SECTION 08-00041-00-RS

REVISIONS			
NO.	BY	DATE	DESCRIPTION

PAVEMENT MARKING STANDARDS

PROJECT NO. 07434	SCALE NONE	SHEET 8
DRAWN/DESIGNED JEP/THK	DATE FEB., 2009	OF 14
CHECKED/APPROVED JFP/JLC	FIELD BOOK NO. FILE	SHEETS

FAU RTE	SECTION	COUNTY	TOTAL SHEETS	SHEET NO.
FAU 2916	08-00041-00-RS	COOK	14	9
F.H.W.A. REG.	ILLINOIS PROJECT	M-8003(981)		

CONTRACT NO. 63174

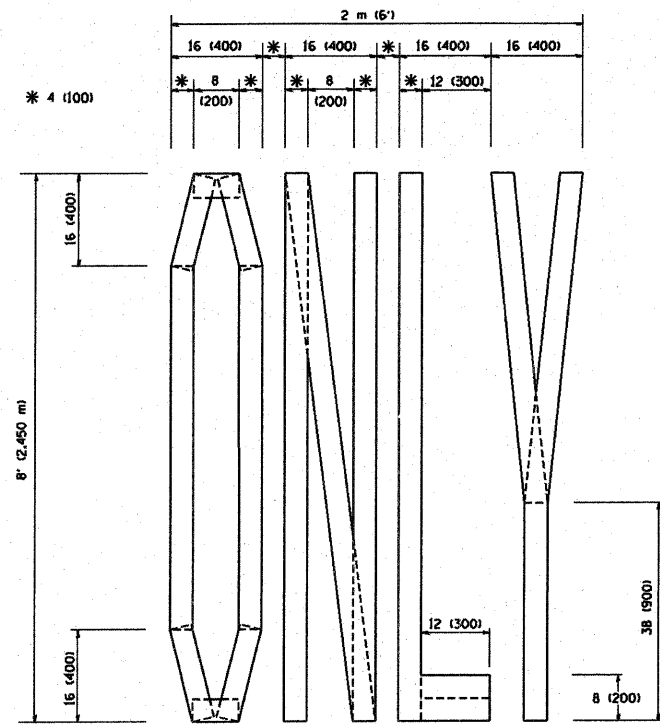

QUANTITY
4 (100) LINE = 64.1 ft. (19.7 m)
21.1 sq. ft. (1.97 sq. m)

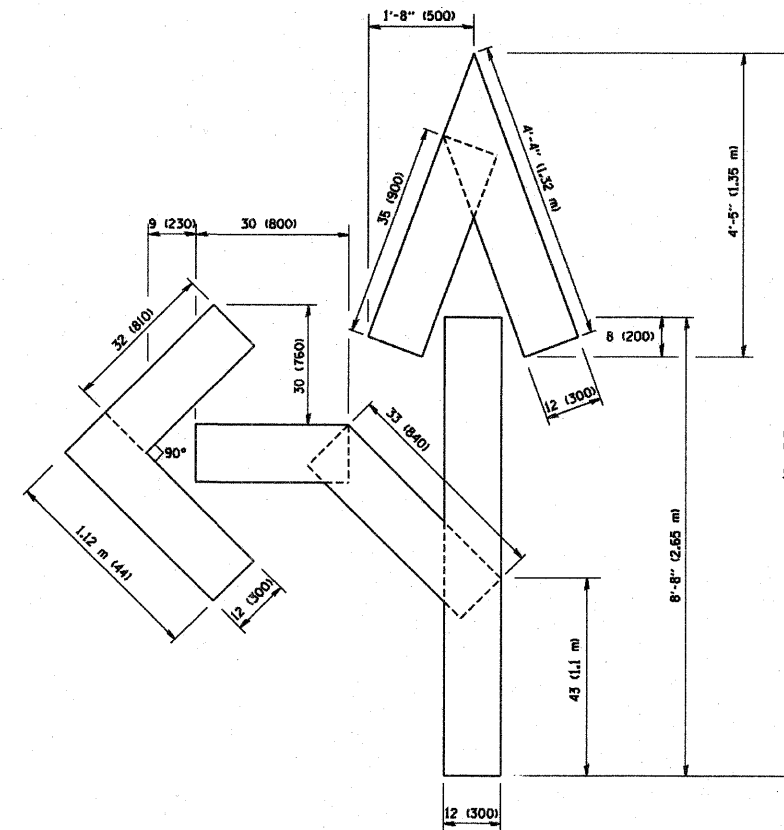

QUANTITY
4 (100) LINE = 82.5 ft. (25.3 m)
27.5 sq. ft. (2.53 sq. m)

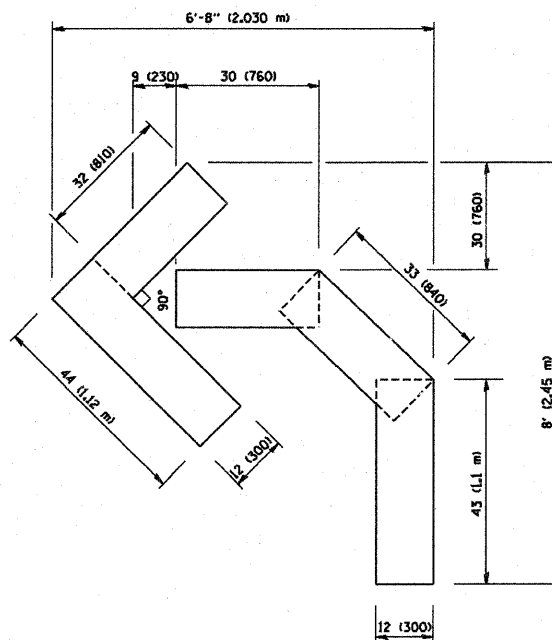

QUANTITY
4 (100) LINE = 45.5 ft. (13.9 m)
15.2 sq. ft. (1.39 sq. m)

All dimensions are in inches (millimeters) unless otherwise shown.

REVISIONS		ILLINOIS DEPARTMENT OF TRANSPORTATION
NO.	DATE	
T. RAMMACHER	09/18/94	<p>PAVEMENT MARKING LETTERS AND SYMBOLS FOR TRAFFIC STAGING</p> <p>SCALE: NONE</p> <p>DRAWN BY CADD CHECKED BY TC-16</p>
J. OBERLE	06/01/96	
T. RAMMACHER	06/05/96	
T. RAMMACHER	11/04/97	
T. RAMMACHER	03/02/98	
E. GOMEZ	08/28/00	

PLT DATE = 3/7/2007
FILE NAME = K:\Projects\07434\07434.dwg
PLOT SCALE = 1/8" = 1'-0"
USER NAME = bward

REVISIONS			
NO.	BY	DATE	DESCRIPTION

FAU RTE	SECTION	COUNTY	TOTAL SHEETS	SHEET NO.
FAU 2916	08-00041-00-RS	COOK	14	10
F.H.W.A. REG.	ILLINOIS PROJECT	M-8003(981)		

CONTRACT NO. 63174

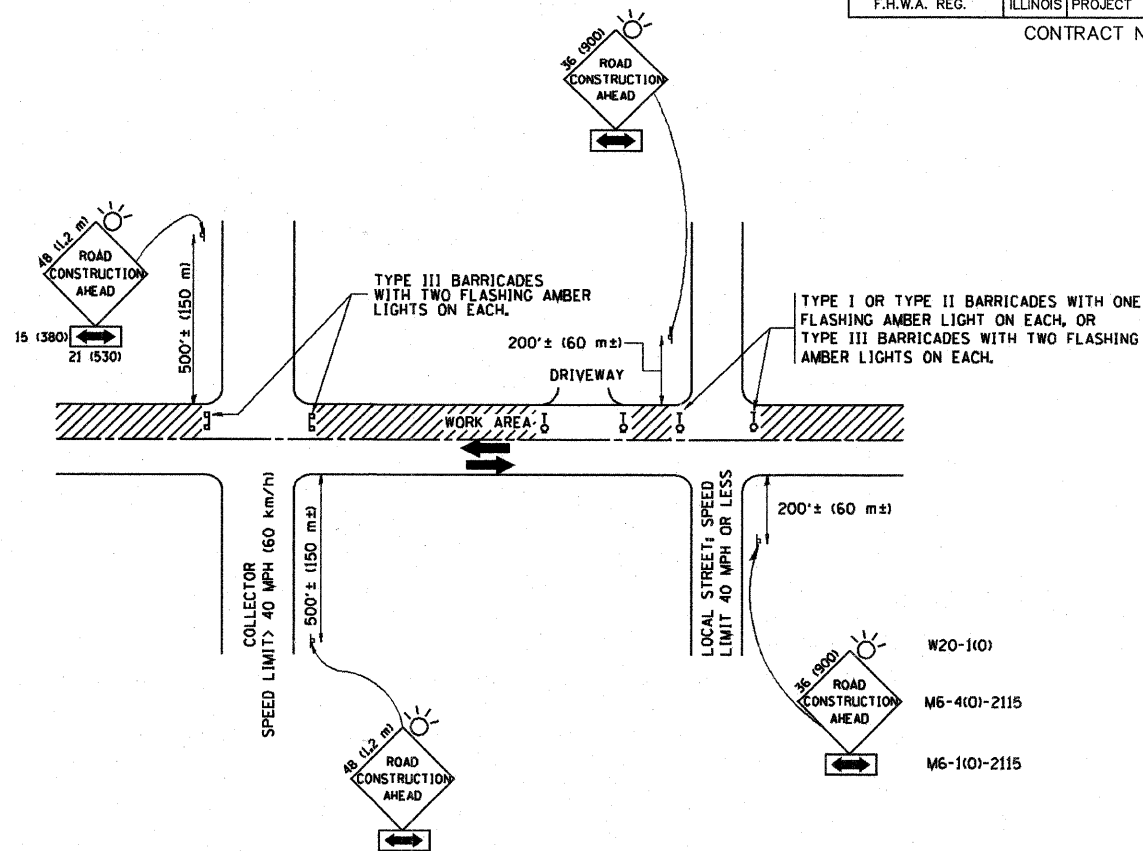

TRAFFIC CONTROL AND PROTECTION FOR SIDE ROADS, INTERSECTIONS, AND DRIVEWAYS

NOTES:

A. FOR NO LANE RESTRICTION ON THE SIDE ROAD OR DRIVEWAYS

- SIDE ROAD WITH A SPEED LIMIT OF 40 MPH (60 km/h) OR LESS AS SHOWN ON THE DRAWING AND AS DIRECTED BY THE ENGINEER:
 - ONE ROAD CONSTRUCTION AHEAD SIGN 36 x 36 (900x900) WITH A FLASHER AND FLAG MOUNTED ON IT APPROXIMATELY 200' (60 m) IN ADVANCE OF THE MAIN ROUTE.
 - THE CLOSED PORTION OF THE MAIN ROUTE SHALL BE PROTECTED BY BLOCKING WITH TYPE I, TYPE II OR TYPE III BARRICADES, 1/3 OF THE CROSS SECTION OF THE CLOSED PORTION.
- SIDE ROAD WITH A SPEED LIMIT GREATER THAN 40 MPH (60 km/h) AS SHOWN ON THE DRAWING AND AS DIRECTED BY THE ENGINEER:
 - ONE ROAD CONSTRUCTION AHEAD SIGN 48 x 48 (1.2 m x 1.2 m) WITH A FLASHER MOUNTED ON IT APPROXIMATELY 500' (150 m) IN ADVANCE OF THE MAIN ROUTE.
 - THE CLOSED PORTION OF THE MAIN ROUTE SHALL BE PROTECTED BY BLOCKING WITH TYPE III BARRICADES, 1/2 OF THE CROSS SECTION OF THE CLOSED PORTION.
- WHEN THE SIDE ROAD LIES BETWEEN THE BEGINNING OF THE MAINLINE SIGNING AND THE WORK ZONE, A SINGLE HEADED ARROW (M6-1) SHALL BE USED IN LIEU OF THE DOUBLE HEADED ARROW (M6-4).

B. FOR A LANE CLOSURE ON A SIDE ROAD OR DRIVEWAYS

USE APPLICABLE PORTIONS OF THE TYPICAL APPLICATION OF TRAFFIC CONTROL DEVICES (STD. 701501, STD. 701606 OR THE APPROPRIATE STANDARD). THE SPACING OF SIGNS AND BARRICADES SHALL BE ADJUSTED FOR FIELD CONDITIONS AS DIRECTED BY THE ENGINEER. THE DIRECTIONAL ARROW SHALL BE COVERED OR REMOVED WHEN NO LONGER CONSISTENT WITH THE SIDE ROAD LANE CLOSURE.

C. ADVANCE WARNING SIGNS ARE TO BE OMITTED ON DRIVEWAY UNLESS OTHERWISE NOTED.

D. THE TRAFFIC CONTROL AND PROTECTION FOR SIDE ROADS, INTERSECTIONS, AND DRIVEWAYS SHALL BE INCIDENTAL TO THE COST OF SPECIFIED TRAFFIC CONTROL STANDARDS OR ITEMS.

All dimensions are in millimeters (inches) unless otherwise shown.

REVISIONS	
NAME	DATE
LHA	6/7/89
T. RAMMACHER	09/08/94
J. OBERLE	10/18/95
A. HOUSEH	03/06/96
A. HOUSEH	10/15/96
T. RAMMACHER	01/06/00

ILLINOIS DEPARTMENT OF TRANSPORTATION
TRAFFIC CONTROL AND PROTECTION
FOR
SIDE ROADS, INTERSECTIONS, AND
DRIVEWAYS

SCALE: NONE

DRAWN BY
CHECKED BY
TC-10

PLT DATE: 03/09/09
FILE NAME: M:\Projects\08-00041-00-RS\08-00041-00-RS-10.dwg
PLOT SCALE: 1/8"=1'-0"
USER NAME: jrb



Frank Novotny & Associates, Inc.

825 Midway Drive ♦ Willowbrook, IL ♦ 60527 ♦ Telephone: (630) 887-8640 ♦ Fax: (630) 887-0132
Illinois Professional Design Firm No. 184-000928

PROJECT

VILLAGE OF LEMONT, ILLINOIS
STATE STREET LAPP RESURFACING
SECTION 08-00041-00-RS

REVISIONS			
NO.	BY	DATE	DESCRIPTION

TRAFFIC CONTROL &
PROTECTION FOR SIDE
ROADS, INTERSECTIONS,
& DRIVEWAYS

PROJECT NO. 07434	SCALE NONE
DRAWN/DESIGNED JEP/THK	DATE FEB., 2009
CHECKED/APPROVED JFP/JLC	FIELD BOOK NO. FILE

SHEET
10
OF
14
SHEETS

FAU RTE	SECTION	COUNTY	TOTAL SHEETS	SHEET NO.
FAU 2916	08-00041-00-RS	COOK	14	11
F.H.W.A. REG.	ILLINOIS PROJECT	M-8003(981)		

CONTRACT NO. 63174

SIGNING FOR FLAGGING OPERATIONS AT WORK ZONE OPENINGS

WORK ZONE EXIT OPENING

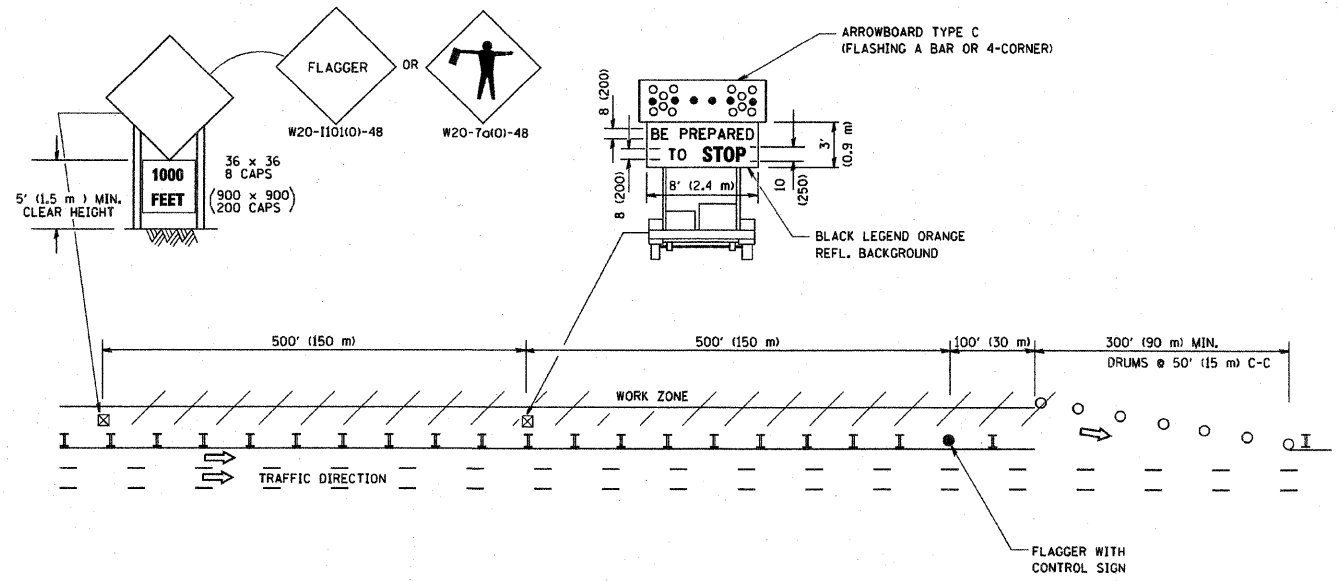

WORK ZONE ENTRY OPENING

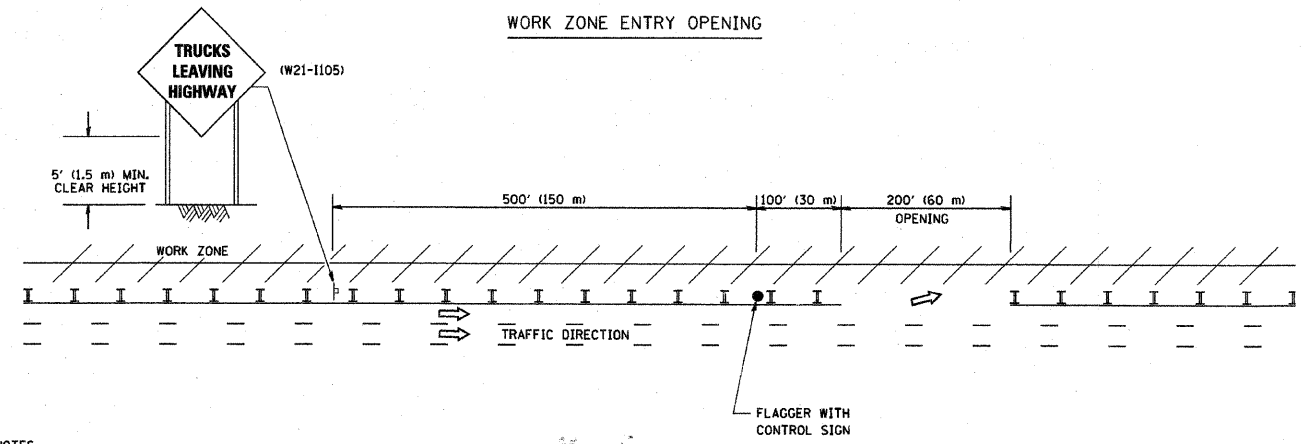

NOTES:

1. The Arrowboard, the Flagger Ahead trailer mounted sign, and the Trucks Leaving Highway sign shall be removed or turned away from traffic and the exit and entry openings shall be closed when the flagging operation ceases.
2. Work Zone Exit Openings should be a minimum of one half mile apart.
3. Exiting the work zone at any place other than at a Work Zone Exit Opening will be prohibited.
4. All vehicles shall enter the work zone at entry openings, using their turn signals to warn motorists

ALL DIMENSIONS ARE IN INCHES (MILLIMETERS) UNLESS OTHERWISE SHOWN

REVISIONS	
NO.	DATE
DWS	8/98
JAF	4/03
JAF	2/06
SPB	1/07

ILLINOIS DEPARTMENT OF TRANSPORTATION
SIGNING FOR FLAGGING OPERATIONS AT WORK ZONE OPENINGS

SCALE: NONE DRAWN BY CADD CHECKED BY TC-18

PLOT DATE = 3/7/2007
FILE NAME = K:\data\2006\Bldg
PLOT SCALE = 08.000 / 1
USER NAME = bsmrml

REVISIONS			
NO.	BY	DATE	DESCRIPTION

FAU RTE	SECTION	COUNTY	TOTAL SHEETS	SHEET NO.
FAU 2916	08-00041-00-RS	COOK	14	12
F.H.W.A. REG.	ILLINOIS PROJECT	M-8003(981)		

CONTRACT NO. 63174

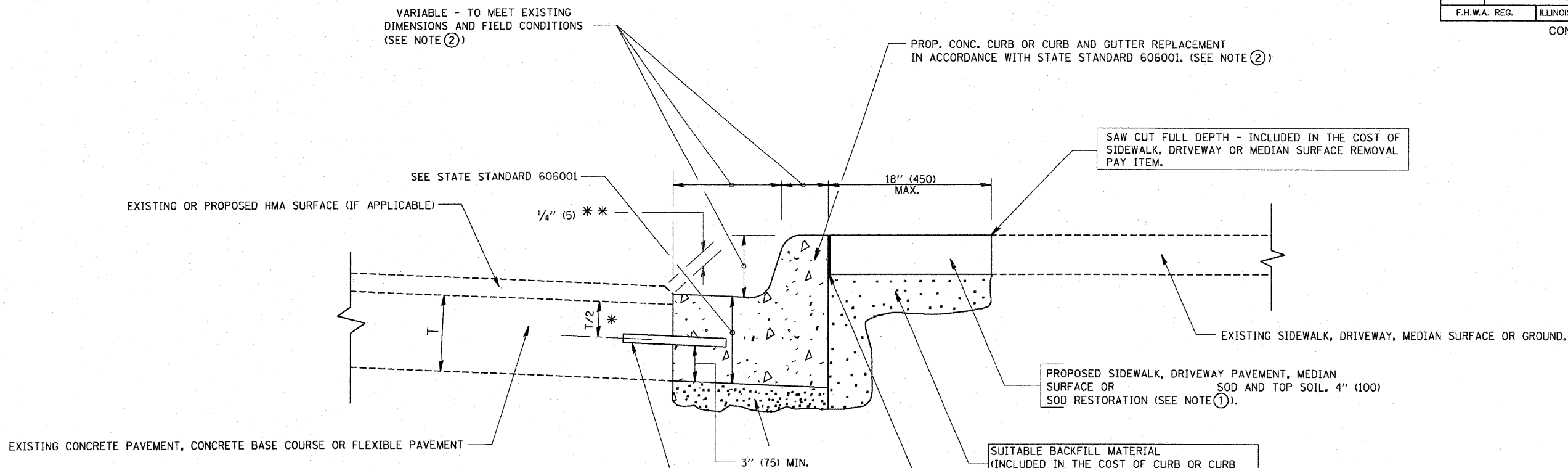

- * 3" (75) MINIMUM FROM TOP AND BOTTOM OF THE CONCRETE PAVEMENT OR BASE COURSE.
- ** IF THE FINAL SURFACE OF THE PAVEMENT IS CONCRETE, THE GUTTER IS TO BE FLUSH WITH THE PAVEMENT.

- NOTE: ① SIDEWALK, DRIVEWAY PAVEMENT OR MEDIAN SURFACE SHALL BE SIMILAR TO THE MATERIAL BEING REMOVED AND WILL BE PAID FOR SEPARATELY.
- SALT TOLERANT SOD AND TOP SOIL, 4" (100) RESTORATION WILL NOT BE PAID FOR SEPARATELY, BUT SHALL BE INCLUDED IN THE COST OF CURB OR CURB AND GUTTER REMOVAL AND REPLACEMENT.
- ② CURB OR CURB AND GUTTER REPLACEMENT SHALL MATCH THE SHAPE OF THE EXISTING CURB OR CURB AND GUTTER UNLESS OTHERWISE SPECIFIED.
- ③ FOR CURB OR CURB AND GUTTER REMOVAL AND REPLACEMENT ADJACENT TO FLEXIBLE PAVEMENT DELETE EPOXY COATED TIE BARS.
- ④ LONGITUDINAL BARS, IF ENCOUNTERED IN THE EXISTING CURB OR CURB AND GUTTER, ARE NOT TO BE REPLACED. CUTTING AND REMOVING LONGITUDINAL BARS SHALL BE INCLUDED IN THE COST OF CURB OR CURB AND GUTTER REMOVAL AND REPLACEMENT.
- ⑤ THE COST OF HMA SURFACE REMOVAL IN THE EXISTING GUTTER FLAG SHALL BE INCLUDED IN THE COST OF THE CURB AND GUTTER REMOVAL AND REPLACEMENT.
- ⑥ THE REMOVAL AND REPLACEMENT OF THE EXISTING CURB OR CURB AND GUTTER SHALL BE DONE IN ACCORDANCE WITH THE APPLICABLE PORTIONS OF SECTION 440 AND 606 OF THE STANDARD SPECIFICATIONS.
- ⑦ THE LOCATIONS OF REMOVAL AND REPLACEMENT OF EXISTING CURB OR CURB AND GUTTER SHALL BE DETERMINED BY THE RESIDENT ENGINEER AT THE TIME OF CONSTRUCTION.

- UNSUITABLE SUB-BASE MATERIAL TO BE REMOVED, IF DIRECTED BY THE ENGINEER, SHALL BE REPLACED WITH EITHER SUB-BASE GRANULAR MATERIAL, TYPE B OR ADDITIONAL THICKNESS OF CONCRETE.
- REMOVAL AND REPLACEMENT 4" (100) OR LESS IS INCLUDED IN THE COST OF CURB OR CURB AND GUTTER REMOVAL AND REPLACEMENT.
- REMOVAL AND REPLACEMENT IN EXCESS OF 4" (100) WILL BE PAID FOR IN ACCORDANCE WITH ARTICLE 109.04 OF THE STANDARD SPECIFICATIONS.
- PROPOSED #6 (20) EPOXY COATED TIE BARS 24" (600) LONG AT 24" (600) CENTERS WILL NOT BE PAID FOR SEPARATELY. DELETE EPOXY COATED TIE BARS IF EXISTING TIE BARS ARE USUABLE AS DETERMINED BY THE ENGINEER. (SEE NOTE ③).

BASIS OF PAYMENT:
 THIS WORK WILL BE PAID FOR AT THE CONTRACT UNIT PRICE PER FOOT FOR "CURB & GUTTER REMOVAL" AND "COMBINATION CONCRETE CURB & GUTTER" OF THE TYPE INDICATED.

ALL DIMENSIONS ARE IN INCHES (MILLIMETERS) UNLESS OTHERWISE SHOWN.

CURB OR CURB AND GUTTER REMOVAL AND REPLACEMENT

REVISIONS	
NAME	DATE
A. HOUSEH	03/11/94
R. SHAH	02/24/95
R. SHAH	03/02/95
R. SHAH	08/19/96
R. SHAH	09/12/96
R. SHAH	09/19/96
R. SHAH	10/03/96
A. ABBAS	03/21/97
M. GOMEZ	01/22/01
R. BORO	01/01/07

ILLINOIS DEPARTMENT OF TRANSPORTATION

CURB OR CURB AND GUTTER REMOVAL AND REPLACEMENT

SCALE: VERT. NONE
 HORIZ. NONE

DRAWN BY
 CHECKED BY
 BD600-06 (BD-24)

PLOT DATE = 3/5/2007
 FILE NAME = K:\winiso\iso24.dgn
 PLOT SCALE = 1/8" = 1'-0"
 USER NAME = bbor01

Frank Novotny & Associates, Inc.
 Civil Engineers/Municipal Consultants
 825 Midway Drive • Willowbrook, IL • 60527 • Telephone: (630) 887-8640 • Fax: (630) 887-0132
 Illinois Professional Design Firm No. 184-000928

PROJECT: **VILLAGE OF LEMONT, ILLINOIS**
STATE STREET LAPP RESURFACING
 SECTION 08-00041-00-RS

REVISIONS			
NO.	BY	DATE	DESCRIPTION

CURB OR CURB AND GUTTER REMOVAL AND REPLACEMENT

PROJECT NO. 07434	SCALE NONE
DRAWN/DESIGNED JEP/THK	DATE FEB., 2009
CHECKED/APPROVED JFP/JLC	FIELD BOOK NO. FILE

SHEET 12 OF 14 SHEETS

FAU RTE	SECTION	COUNTY	TOTAL SHEETS	SHEET NO.
FAU 2916	08-00041-00-RS	COOK	14	13
F.H.W.A. REG.	ILLINOIS PROJECT	M-8003(981)		

CONTRACT NO. 63174

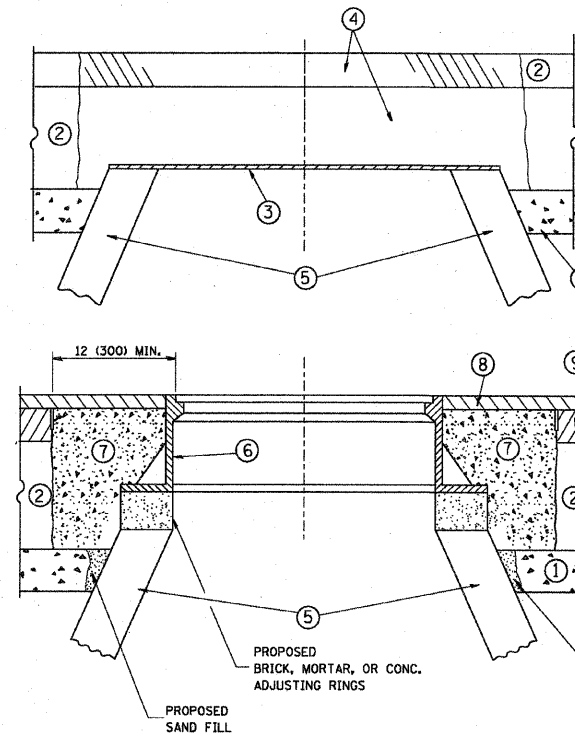

CONSTRUCTION PROCEDURES

STAGE 1 (BEFORE PAVEMENT MILLING)

- A) REMOVE A MINIMUM OF 12 (300) OF THE PAVEMENT FROM AROUND THE STRUCTURE.
- B) REMOVE THE EXISTING FRAME AND LID FROM THE STRUCTURE.
- C) COVER THE STRUCTURE OPENING WITH A 36 (900) DIAMETER METAL PLATE.
- D) BACKFILL WITH CRUSHED STONE AND A MINIMUM 1/2 (40) THICK HMA SURFACE MIX APPROVED BY THE ENGINEER.

STAGE 2 (AFTER PAVEMENT MILLING)

- A) REMOVE THE HMA SURFACE MIX AND CRUSHED STONE.
- B) INSTALL THE FRAME AND LID; ADJUST THE FRAME TO ITS FINAL SURFACE ELEVATION.
- C) THE SURROUNDING SPACE SHALL BE FILLED WITH CLASS S1 CONCRETE, OR HMA SURFACE COURSE OR HMA BINDER COURSE TO THE ELEVATION OF THE SURFACE OF THE EXISTING BASE COURSE OR THE BINDER COURSE.

THE PROCEDURE EXPLAINED ABOVE SHALL CONFORM TO THE APPLICABLE PORTIONS OF SECTIONS 353, 406, 602, AND 603 OF THE STANDARD SPECIFICATIONS.

LEGEND

- ① SUB-BASE GRANULAR MATERIAL
- ② EXISTING PAVEMENT
- ③ 36 (900) DIAMETER METAL PLATE
- ④ PROPOSED CRUSHED STONE AND HMA SURFACE MIX
- ⑤ EXISTING STRUCTURE
- ⑥ FRAME AND LID (SEE NOTES)
- ⑦ CLASS S1 CONCRETE, HMA SURFACE COURSE OR HMA BINDER COURSE
- ⑧ PROPOSED HMA SURFACE COURSE
- ⑨ PROPOSED HMA BINDER COURSE

LOCATION OF STRUCTURES:

THE CONTRACTOR WILL BE REQUIRED TO KEEP A RECORD OF THE LOCATIONS OF THE BURIED STRUCTURES ACCORDING TO THE STATION AND DISTANCE LEFT OR RIGHT OF THE CENTERLINE OF PAVEMENT. UPON COMPLETION OF THE WORK, THE CONTRACTOR WILL DELIVER THE RECORD TO THE ENGINEER.

BASIS OF PAYMENT: THIS WORK WILL BE PAID FOR AT THE CONTRACT UNIT PRICE PER EACH FOR

NEW FRAMES AND LIDS, WHEN SPECIFIED, WILL BE PAID FOR SEPARATELY.

NOTES:

EXISTING BROKEN FRAMES AND LIDS SHALL BE REMOVED AND DISPOSED OF BY THE CONTRACTOR AND SHALL BE REPLACED AS DIRECTED BY THE ENGINEER. REPLACEMENT FRAMES AND LIDS WILL BE PAID FOR IN ACCORDANCE WITH ARTICLE 109.04 OF THE STANDARD SPECIFICATIONS UNLESS A SEPARATE PAY ITEM HAS BEEN PROVIDED.

IF THE EXISTING LIDS ARE OPEN, THE FRAME WILL BE ADJUSTED TO THE ELEVATION OF THE MILLED PAVEMENT SURFACE PRIOR TO THE MILLING OPERATION. THE FRAME WILL NOT BE REMOVED AND COVERED BY THE METAL PLATE.

CITY OF CHICAGO CASTINGS ARE THE PROPERTY OF THE CITY AND THE CONTRACTOR SHALL NOTIFY THE CITY FOR REMOVAL AND DISPOSITION OF THE CASTINGS.

THE METAL PLATE USED TO COVER THE STRUCTURE SHALL REMAIN THE PROPERTY OF THE CONTRACTOR.

WHEN STRUCTURES ARE TO BE ADJUSTED OR RECONSTRUCTED, THE LOWERING AND RAISING OF THE FRAMES AND LIDS WILL NOT BE PAID FOR SEPARATELY BUT WILL BE INCLUDED IN THE COST OF THE CORRESPONDING PAY ITEM.

DETAILS FOR FRAMES AND LIDS ADJUSTMENT WITH MILLING

ALL DIMENSIONS ARE IN INCHES (MILLIMETERS) UNLESS OTHERWISE SHOWN

REVISIONS	
NAME	DATE
R. SHAH	10/25/94
R. SHAH	01/30/95
R. SHAH	03/10/95
A. ABBAS	03/21/97
R. WIEDEMAN	05/14/04
R. BORO	01/01/07

ILLINOIS DEPARTMENT OF TRANSPORTATION
**DETAILS FOR
FRAMES AND LIDS ADJUSTMENT
WITH MILLING**

SCALE: VERT. NONE
HORIZ.

DRAWN BY
CHECKED BY

BD600-03 (BD-8)

PLOT DATE = 3/6/2007
FILE NAME = K:\data\user\BR.dgn
PLOT SCALE = 8L 8000 / IN.
USER NAME = bshah001

REVISIONS			
NO.	BY	DATE	DESCRIPTION

FAU RTE	SECTION	COUNTY	TOTAL SHEETS	SHEET NO.
FAU 2916	08-00041-00-RS	COOK	14	14
F.H.W.A. REG.	ILLINOIS PROJECT	M-8003(981)		

CONTRACT NO. 63174

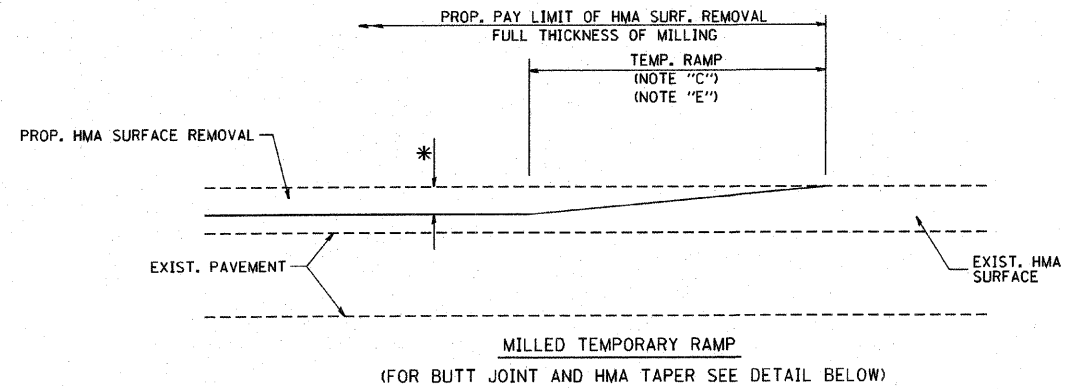

OPTION 1

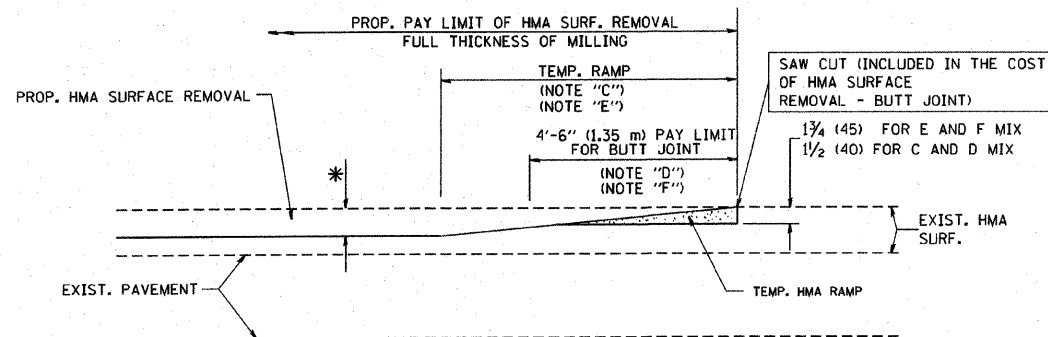

OPTION 2

TYPICAL TEMPORARY RAMP

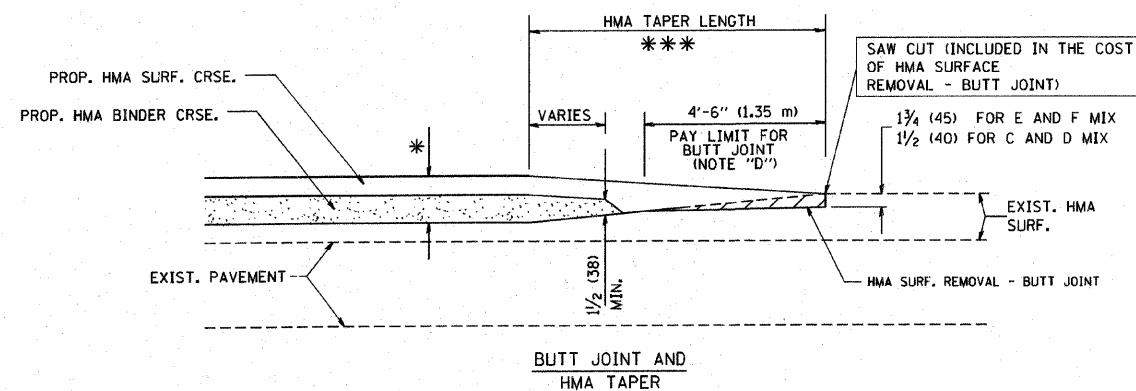

TYPICAL BUTT JOINT AND HMA TAPER FOR MILLING AND RESURFACING

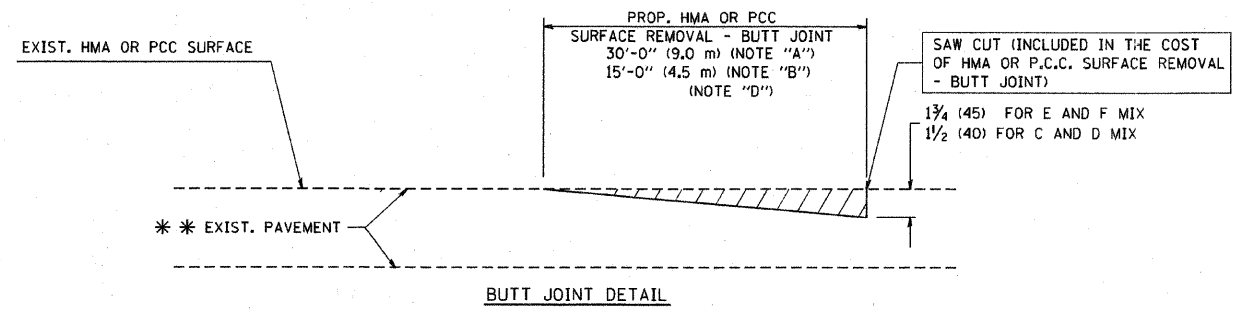

BUTT JOINT DETAIL

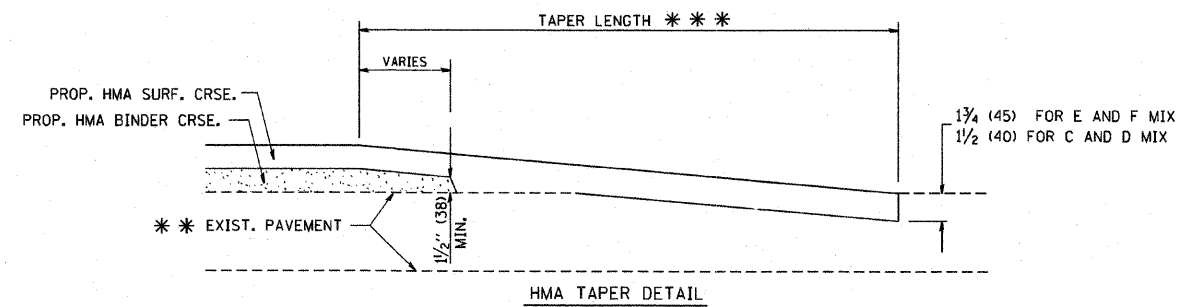

TYPICAL BUTT JOINT AND HMA TAPER FOR RESURFACING ONLY

*** PC CONCRETE, HMA OR HMA RESURFACED PAVEMENT.

NOTES

- A: MAINLINE ROADWAYS AND MAJOR SIDE ROADS.
 - B: MINOR SIDE ROADS.
 - C: THE TEMP. RAMP SHALL BE CONSTRUCTED IMMEDIATELY UPON REMOVAL OF THE EXISTING HMA SURFACE.
 - D: THE BUTT JOINT SHALL BE CONSTRUCTED IMMEDIATELY PRIOR TO PLACING THE PROPOSED HMA COURSES.
 - E: TAPER THE TEMP. RAMP AT A RATE OF 3'-0" (900 mm) PER 1 INCH (25 mm) OF MILLING THICKNESS.
 - F: INSTALLATION AND REMOVAL OF THE 4'-6" (1.35 m) TEMP. RAMP IS INCLUDED IN COST OF HMA SURFACE REMOVAL - BUTT JOINT
 - G: SEE ARTICLE 406.08 AND 406.14 OF THE STANDARD SPECIFICATIONS FOR 'HMA AND/OR PCC SURFACE REMOVAL, BUTT JOINT'.
- * SEE TYPICAL SECTIONS FOR MILLING THICKNESS.
- *** 20'-0" (6.1 m) PER 1 (25) RESURFACING (NOTE "A")
10'-0" (3.0 m) PER 1 (25) RESURFACING (NOTE "B")

ALL DIMENSIONS ARE IN INCHES (MILLIMETERS) UNLESS OTHERWISE SHOWN.

BASIS OF PAYMENT:

THE BUTT JOINT WILL BE PAID FOR AT THE CONTRACT UNIT PRICE PER SQUARE YARD (SQUARE METER) FOR "HOT-MIX ASPHALT SURFACE REMOVAL - BUTT JOINT" OR FOR "PORTLAND CEMENT CONCRETE SURFACE REMOVAL - BUTT JOINT".

REVISIONS	
NAME	DATE
M. DE YONG	6-13-90
M. DE YONG	7-3-90
M. DE YONG	3-27-92
R. SHAH	09/09/94
R. SHAH	10/25/94
A. ABBAS	03/21/97
M. GOMEZ	04/06/01
R. BORO	01/01/07

ILLINOIS DEPARTMENT OF TRANSPORTATION

BUTT JOINT AND HMA TAPER DETAILS

SCALE: VERT. NONE
HORIZ.

DRAWN BY
CHECKED BY
BD400-05 (V1-BD32)

PLOT DATE = 3/4/2007
FILE NAME = K:\Users\jv432.dgn
PLOT SCALE = 80.0000 / IN.
USER NAME = bward



Frank Novotny & Associates, Inc.

825 Midway Drive ♦ Willowbrook, IL ♦ 60527 ♦ Telephone: (630) 887-8640 ♦ Fax: (630) 887-0132
Illinois Professional Design Firm No. 184-000928

PROJECT

VILLAGE OF LEMONT, ILLINOIS
STATE STREET LAPP RESURFACING
SECTION 08-00041-00-RS

REVISIONS			
NO.	BY	DATE	DESCRIPTION

BUTT JOINT AND HMA TAPER DETAILS

PROJECT NO. 07434	SCALE NONE	SHEET 14
DRAWN/DESIGNED JEP/THK	DATE FEB., 2009	OF 14
CHECKED/APPROVED JFP/JLC	FIELD BOOK NO. FILE	SHEETS