

0264428-1111-001-01.dgn 3/24/2009 11:40:03 AM

SQUAD LEADER: JENNIFER LUBBS (815)284-5958 PROJECT ENGINEER: BECKY MARRUFFO

INDEX OF SHEETS

SHEET NO.	DESCRIPTION
1.	COVER SHEET
2.	GENERAL NOTES AND STANDARDS
3.	SUMMARY OF QUANTITIES
ROADWAY PLANS - SN 037-0173	
4.-5.	TYPICAL SECTIONS
6.-7.	SCHEDULE OF QUANTITIES
8.	HORIZONTAL AND VERTICAL CONTROL
9.-10.	FAP RTE 638 (IL 82) PLAN AND PROFILE
11.	DETOUR DETAILS
12.	EROSION CONTROL AND DRAINAGE PLAN
13.	MISCELLANEOUS DETAILS
STRUCTURE PLANS - SN 037-0173	
14.	GENERAL PLAN
15.	GENERAL DATA
16.-17.	BOX CULVERT DETAILS
18.	SOIL BORING LOGS
EXISTING STRUCTURE PLANS - SN 037-0106	
19.-21.	EXISTING STRUCTURE PLANS
CROSS SECTIONS - SN 037-0172	
22.-26.	FAP RTE 638 (IL 82) CROSS SECTIONS
ROADWAY PLANS - SN 037-0172	
27.-28.	TYPICAL SECTIONS
29.-30.	SCHEDULE OF QUANTITIES
31.	HORIZONTAL AND VERTICAL CONTROL
32.-34.	FAP RTE 638 (IL 82) PLAN AND PROFILE
35.-36.	STAGE CONSTRUCTION PLANS
37.	STAGE CONSTRUCTION DETAILS
38.	EROSION CONTROL AND DRAINAGE PLAN
39.	MISCELLANEOUS DETAILS
STRUCTURE PLANS - SN 037-0172	
40.	GENERAL PLAN
41.	GENERAL DATA
42.	STAGE CONSTRUCTION DETAILS
43.-44.	BOX CULVERT DETAILS
45.	SOIL BORING LOGS
46.	TEMPORARY CONCRETE BARRIER FOR STAGE CONSTRUCTION
EXISTING STRUCTURE PLANS - SN 037-0091	
47.-51.	EXISTING STRUCTURE PLANS
CROSS SECTIONS - SN 037-0172	
52.-57.	FAP RTE 638 (IL 82) CROSS SECTIONS
DISTRICT 2 STANDARDS	
58.-67.	CUTTER OUTLET ADJACENT TO STABILIZED SHOULDER (15.4) GRADING AROUND WINGWALLS (20.4) DETAIL OF HOT-MIX ASPHALT SHOULDER AT GUARD RAIL (23.4) HOT-MIX ASPHALT SHOULDER (23.4a) CONCRETE CUTTER, TYPE A (MODIFIED) (36.4) DELINEATOR AND POST ORIENTATION (37.4) ROAD CLOSED TO OVERSIZED LOADS (40.4) TYPICAL BENCHING DETAIL ON EXISTING EMBANKMENT (50.4) LAND SECTION & REFERENCE MARKERS (63.4) STOP LINE SIGN FOR TEMPORARY SIGNALS (99.4) EROSION CONTROL DETAILS FOR SILT FENCE (29.2) INFORMATIONAL WARNING SIGN (FOR NARROW TRAVEL LANES) (39.2) WITNESS MARKER & PERMANENT SURVEY MARKERS, TYPE II (66.2) ENTRANCE SIGN FOR USE WITH TEMPORARY SIGNALS (75.2) STORM WATER POLLUTION PREVENTION PLAN (2.1) TRAFFIC CONTROL FOR ROAD CLOSURE (40.1) TYPICAL PAVEMENT MARKINGS (41.1)



FULL SIZE PLANS HAVE BEEN PREPARED USING STANDARD ENGINEERING SCALES. REDUCED SIZED PLANS WILL NOT CONFORM TO STANDARD SCALES. IN MAKING MEASUREMENTS ON REDUCED PLANS, THE ABOVE SCALES MAY BE USED.

J.U.L.I.E.
JOINT UTILITY LOCATION INFORMATION FOR EXCAVATION
1-800-892-0123
OR 811

MUNSON TOWNSHIP, SEC. 28, 29
CAMBRIDGE TOWNSHIP, SEC. 4, 5

CONTRACT NO. 64428

FAP 638 (IL 82) SECTION 136BR-1, 137-1BR HENRY COUNTY

STATE OF ILLINOIS
DEPARTMENT OF TRANSPORTATION
DIVISION OF HIGHWAYS
**PROPOSED
HIGHWAY PLANS**
FAP ROUTE 638 (IL 82)
SECTION 136BR-1, 137-1BR
PROJECT ACF-0638(011)
HENRY COUNTY

C 92-060-09
STRUCTURE REPLACEMENTS
OVER NORTH AND SOUTH BRANCHES OF SPRING CREEK
4TH PM

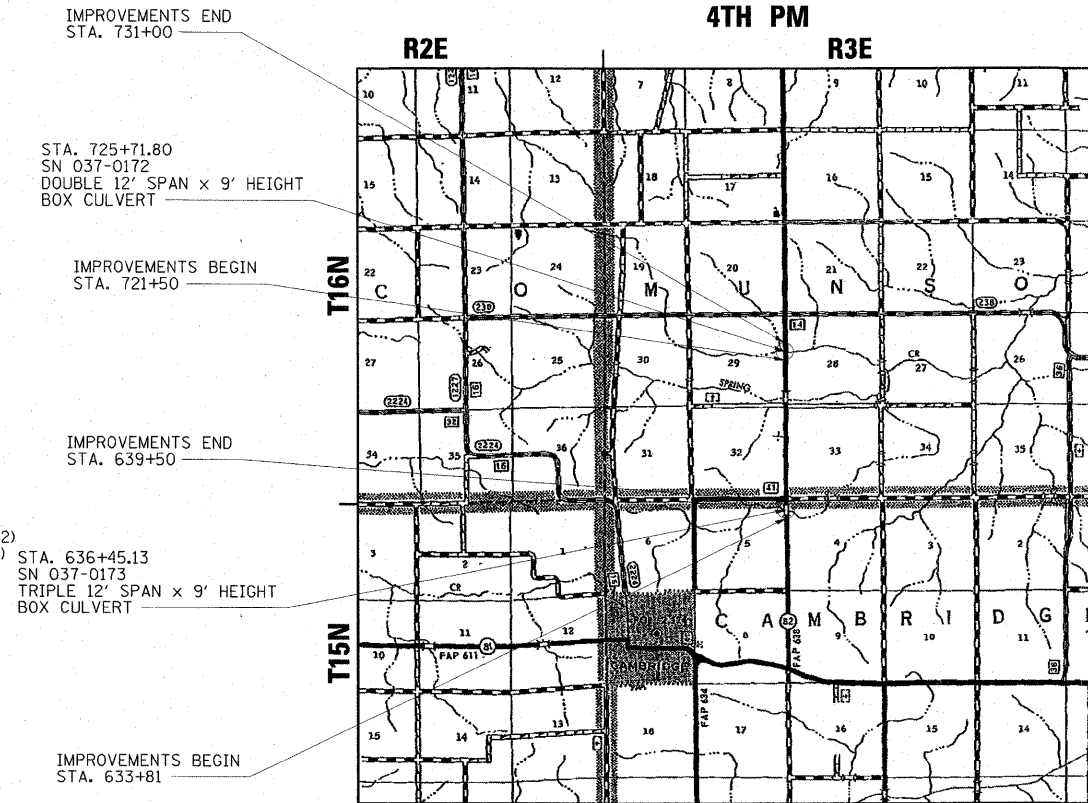

LOCATION MAP

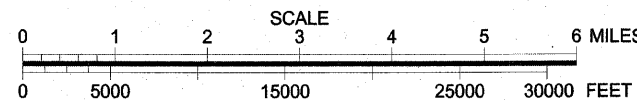

SECTION	GROSS LENGTH	NET LENGTH
136BR-1	950 FT. = 0.18 MI.	950 FT. = 0.18 MI.
137-1BR	560 FT. = 0.11 MI.	560 FT. = 0.11 MI.



ESCA
CONSULTANTS, INC.
CIVIL & STRUCTURAL ENGINEERS
URBANA, ILLINOIS
(217)384-0505
PROJECT ENGINEER: ERIC HENKEL

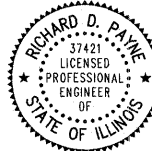

Richard D. Payne DATE: 03/20/09
ILLINOIS PROFESSIONAL LICENSE NO. 37421
(EXPIRATION DATE: 11-30-09)

F.A.P. RTE.	SECTION	COUNTY	TOTAL SHEETS	SHEET NO.
638	136BR-1, 137-1BR	HENRY	67	1
FED. ROAD DIST. NO.		ILLINOIS	CONTRACT NO. 64428	

D-92-061-99

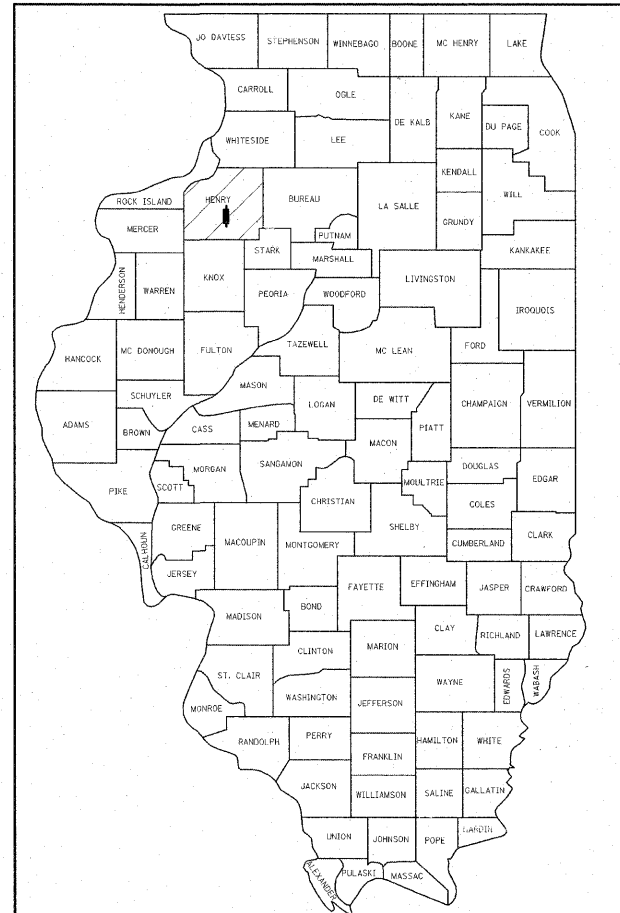

LOCATION OF SECTION INDICATED THUS: -

FUNCTIONAL CLASSIFICATION: MINOR ARTERIAL (NON URBAN)
DESIGN SPEED: 55 mph
POSTED SPEED: 55 mph
SECTION: 136BR-1 137-1BR
ADT: 2550 1500 (2008)
PV: 95.0% 92.8%
SU: 3.0% 4.1%
MU: 2.0% 3.1%

STATE OF ILLINOIS
DEPARTMENT OF TRANSPORTATION
DIVISION OF HIGHWAYS

SUBMITTED *March 25, 2009*
Steven F. Payne
DEPUTY DIRECTOR OF HIGHWAYS, REGION ENGINEER

May 8, 2009
Charles J. Ingersoll
ENGINEER OF DESIGN AND ENVIRONMENT

May 8, 2009
Christine M. Reed
DIRECTOR OF HIGHWAYS, CHIEF ENGINEER

PRINTED BY THE AUTHORITY
OF THE STATE OF ILLINOIS