

STATE OF ILLINOIS
DEPARTMENT OF TRANSPORTATION

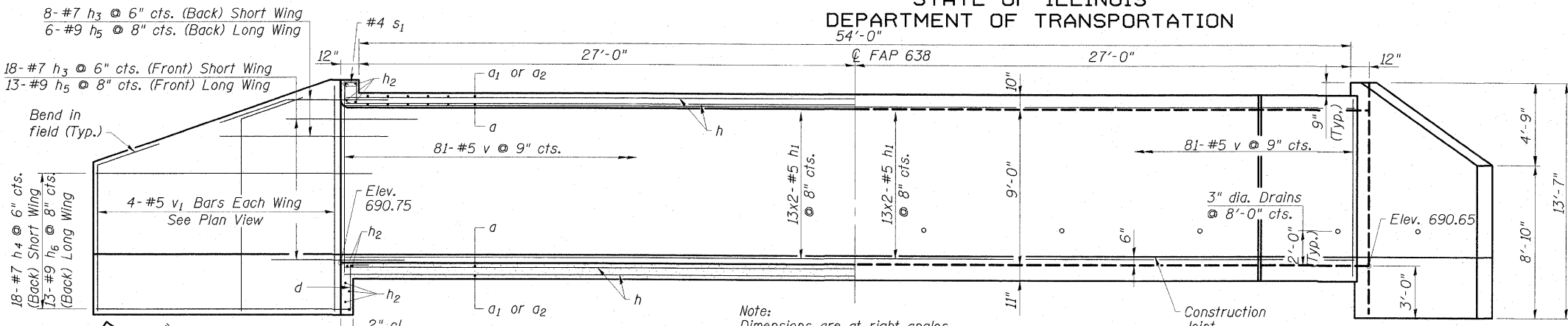

- NOTES**
1. See Sheet No. 4 of 5 for Section B-B.
 2. Bars indicated thus T8x2-#7 etc. indicates 78 lines with 2 lengths per line.

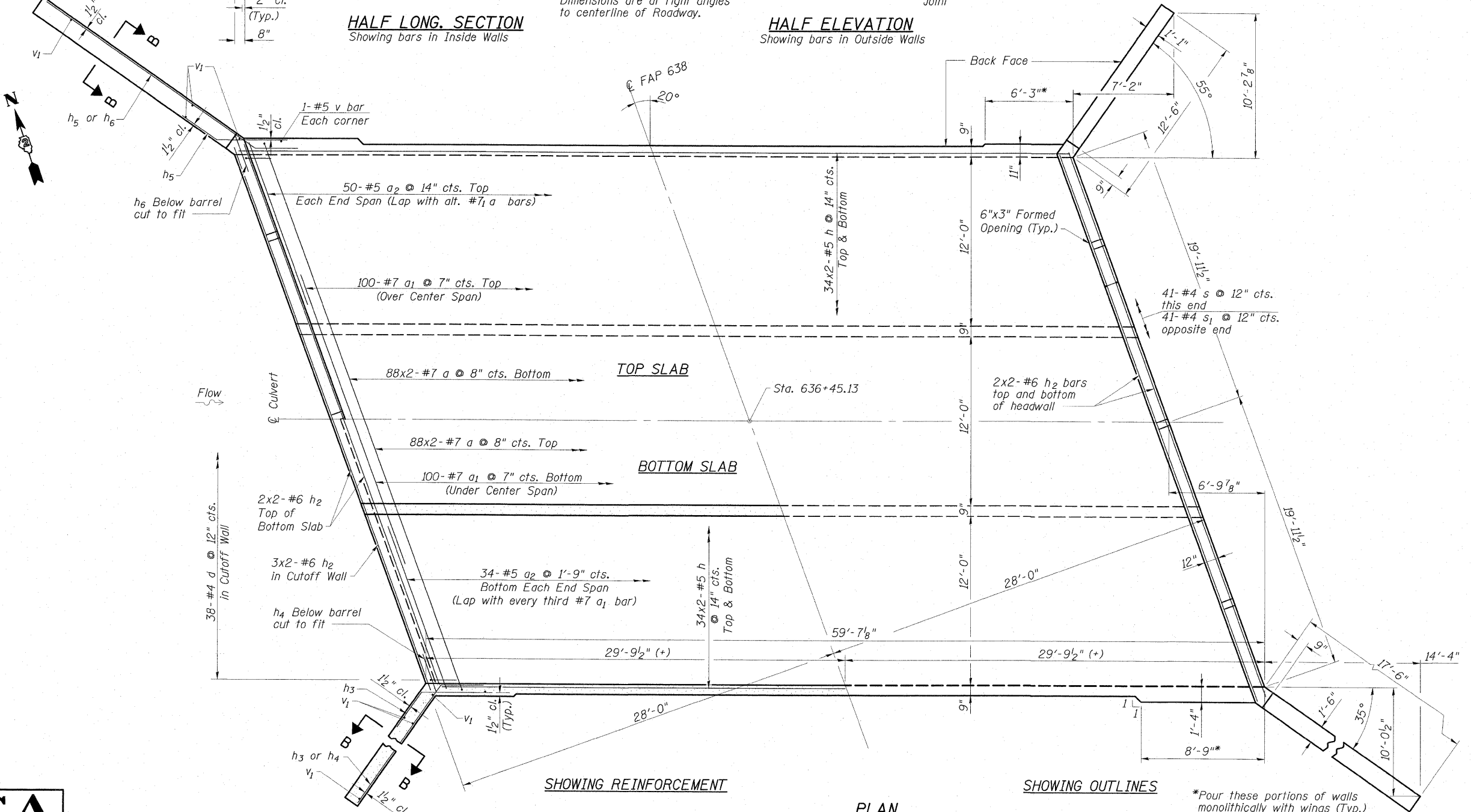

ESCA
CONSULTANTS, INC.

DESIGNED BY:	JMS	11/08
DRAWN BY:	DWH/cj	11/08
CHECKED BY:	RDP	02/09
APPROVED BY:	RDP	02/09

**BOX CULVERT DETAILS
STRUCTURE NO. 037-0173**

SHEET NO. 3 5 SHEETS	F.A.P. RTE.	SECTION	COUNTY	TOTAL SHEETS	SHEET NO.
	638	137-1BR	HENRY	67	16
CONTRACT NO. 64428					
FED. ROAD DIST. NO.		ILLINOIS FED. AID PROJECT			

9370173-B-4428-03-B-CV-1013.dgn 3/23/2009 9:55:02 AM HRS