

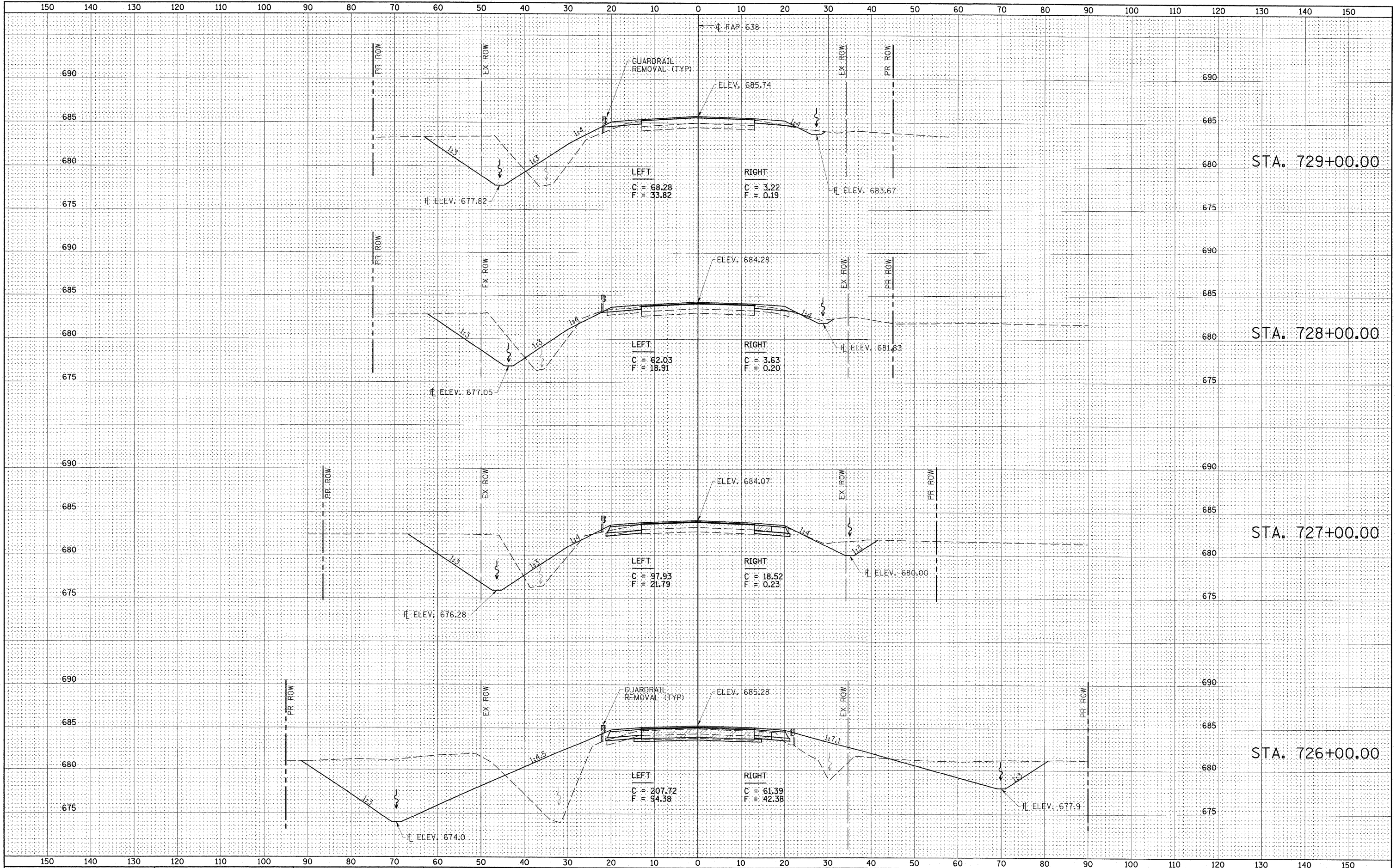

DATE: \_\_\_\_\_ BY: \_\_\_\_\_  
 SURVEYED: \_\_\_\_\_ PLOTTED: \_\_\_\_\_  
 ORIGINAL SURVEY: \_\_\_\_\_ NOTE BOOK: \_\_\_\_\_  
 NO. \_\_\_\_\_ AREAS CHECKED: \_\_\_\_\_

DATE: \_\_\_\_\_ BY: \_\_\_\_\_  
 SURVEYED: \_\_\_\_\_ PLOTTED: \_\_\_\_\_  
 ORIGINAL SURVEY: \_\_\_\_\_ NOTE BOOK: \_\_\_\_\_  
 NO. \_\_\_\_\_ AREAS CHECKED: \_\_\_\_\_



FILE NAME = Y:\DOT\829-04_64428\CADD\Highway\CADD Sheets\0264428-shr-xssht01.dgn	USER NAME = HAS	DESIGNED - JMS	REVISED	<b>STATE OF ILLINOIS DEPARTMENT OF TRANSPORTATION</b>	<b>IL ROUTE 82 CROSS SECTIONS</b>			F.A.P. RTE. 638	SECTION 136BR-1	COUNTY HENRY	TOTAL SHEETS 67	SHEET NO. 55
PLOT SCALE = 1/8" = 1' / IN.	PLOT DATE = 3/23/2009	DRAWN - JPC	REVISED -		SCALE: 1"=10'-0"	SHEET NO. 4 OF 6 SHEETS	STA. 726+00 TO STA. 729+00	FED. ROAD DIST. NO.	ILLINOIS FED. AID PROJECT	CONTRACT NO. 64428		
		CHECKED - ELH	REVISED -									
		DATE - 03/13/09	REVISED -									