

STAGE 1

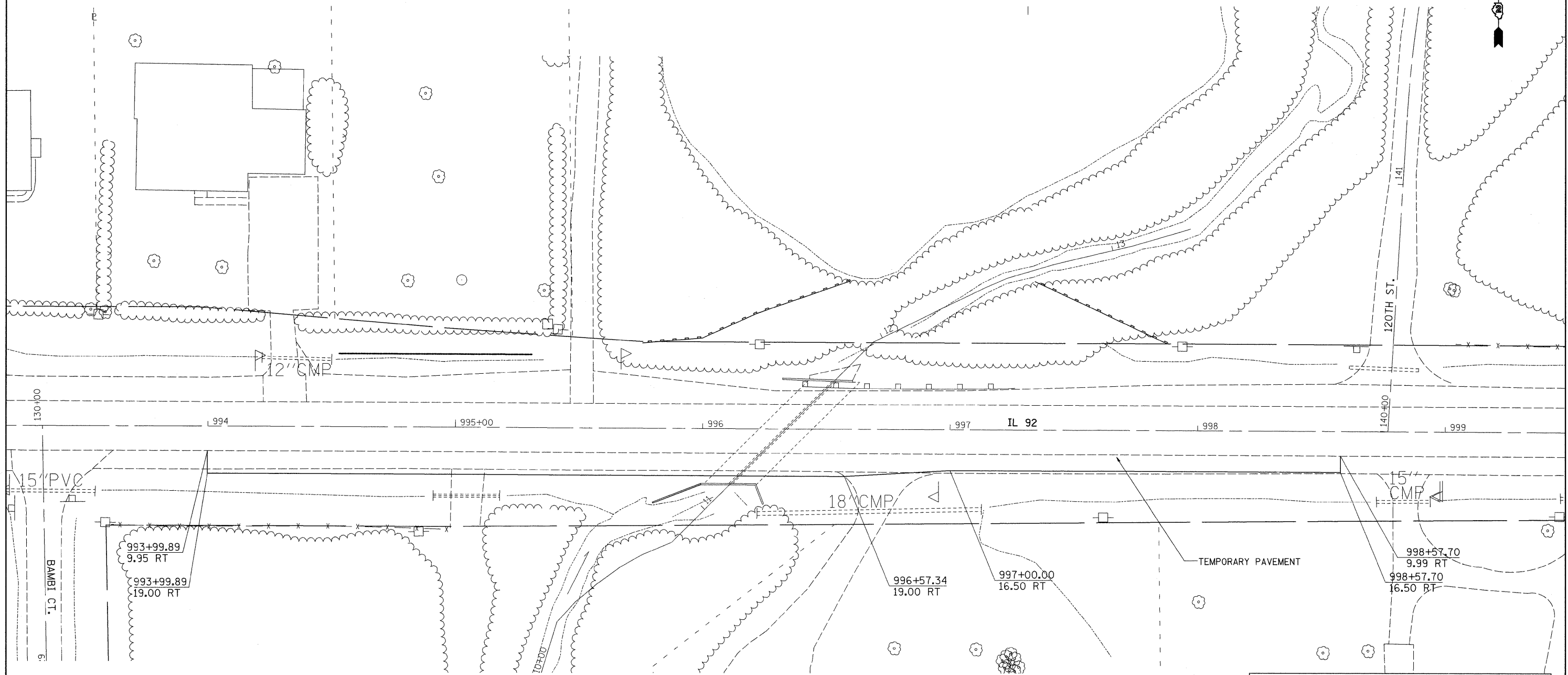

STAGE 1 NOTES

1. USE STANDARD 701326 FOR SHOULDER WORK.
2. PLACE TEMPORARY SHOULDERS FROM RT STA. 993+99.89 TO RT STA. 998+57.70

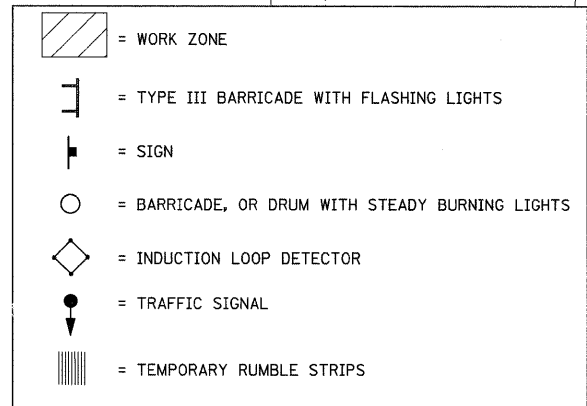

FILE NAME =	USER NAME = hensonke	DESIGNED -	REVISED -
cc:\pw_work\pwsdot\hensonke\dms34329\dl0001stg.dgn		DRAWN -	REVISED -
	PLOT SCALE = 20.0000 ft / IN.	CHECKED -	REVISED -
	PLOT DATE = Thu Dec 04 13:36:17 2008	DATE -	REVISED -

**STATE OF ILLINOIS
DEPARTMENT OF TRANSPORTATION**

STAGING DETAIL SHEET

SCALE: SHEET NO. OF SHEETS STA. TO STA.

F.A.P. RTE.	SECTION	COUNTY	TOTAL SHEETS	SHEET NO.
599	103MFT-T	ROCK ISLAND	55	19
CONTRACT NO. 64737				
FED. ROAD DIST. NO.		ILLINOIS FED. AID PROJECT		