

| | | | | |
|---|---|------------------------|--------------|-----------|
| F.A.P. RTE. | SECTION | COUNTY | TOTAL SHEETS | SHEET NO. |
| 505 | 111RS-4, 111BR-1, YG-15d-RS-1, & (W-15d)T-1 | STEPHENSON & WINNEBAGO | 335 | 54 |
| STA. 10625+00 | | TO STA. 10639+50 | | |
| FED. ROAD DIST. NO. 2 ILLINOIS FED. AID PROJECT | | | | |
| CONTRACT NO. 64970 | | | | |

| | |
|------|----|
| DATE | BY |
| | |
| DATE | BY |
| | |
| DATE | BY |
| | |

| | |
|------|----|
| DATE | BY |
| | |
| DATE | BY |
| | |
| DATE | BY |
| | |

PLOT DATE = 3/3/2009
 FILE NAME = k:\11195800\11_75_3p_east\cead\design\195800_PL_N62.dgn
 PLOT SCALE = 1"=50'
 USER NAME = JTreney
 PDELT = Default

REMOVAL LEGEND

- TREE REMOVAL, UNIT
- TREE REMOVAL, ACRE
- PAVEMENT REMOVAL
- DRIVEWAY REMOVAL

STA 10631+65.11 (IL RTE 75)=
 STA 370+00 (MAIN ST)

STA 10635+51.05 (IL RTE 75)=
 STA 380+00 (BARNEY RD)

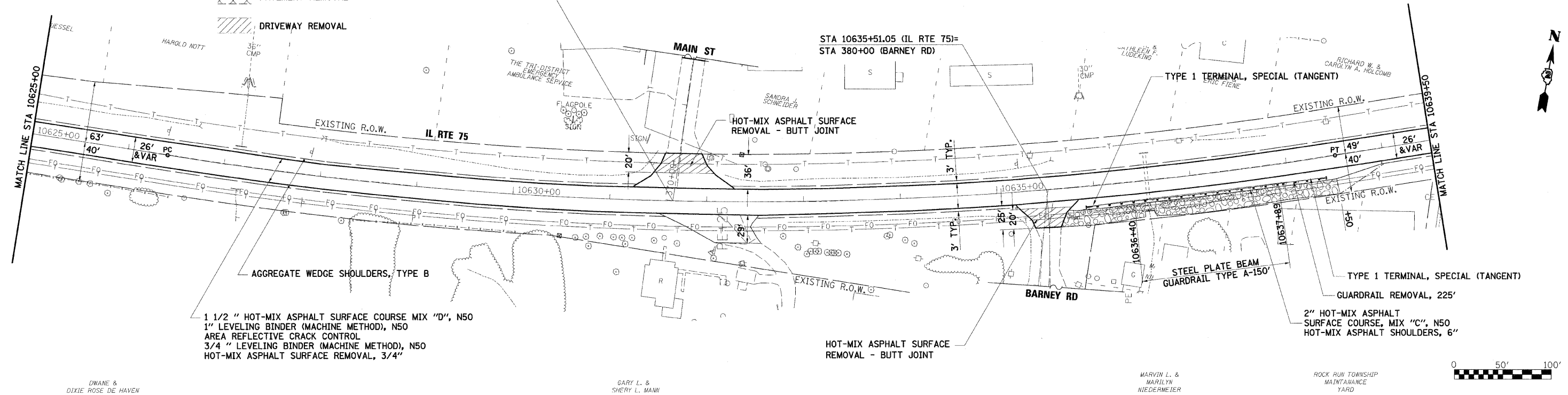

1 1/2" HOT-MIX ASPHALT SURFACE COURSE MIX "D", N50
 1" LEVELING BINDER (MACHINE METHOD), N50
 AREA REFLECTIVE CRACK CONTROL
 3/4" LEVELING BINDER (MACHINE METHOD), N50
 HOT-MIX ASPHALT SURFACE REMOVAL, 3/4"

STA. 10635+70 TO 10639+00
 EARTH EX. = 86 CU. YDS.
 EMB. = 127 CU. YDS.
 WASTE = -63 CU. YDS.

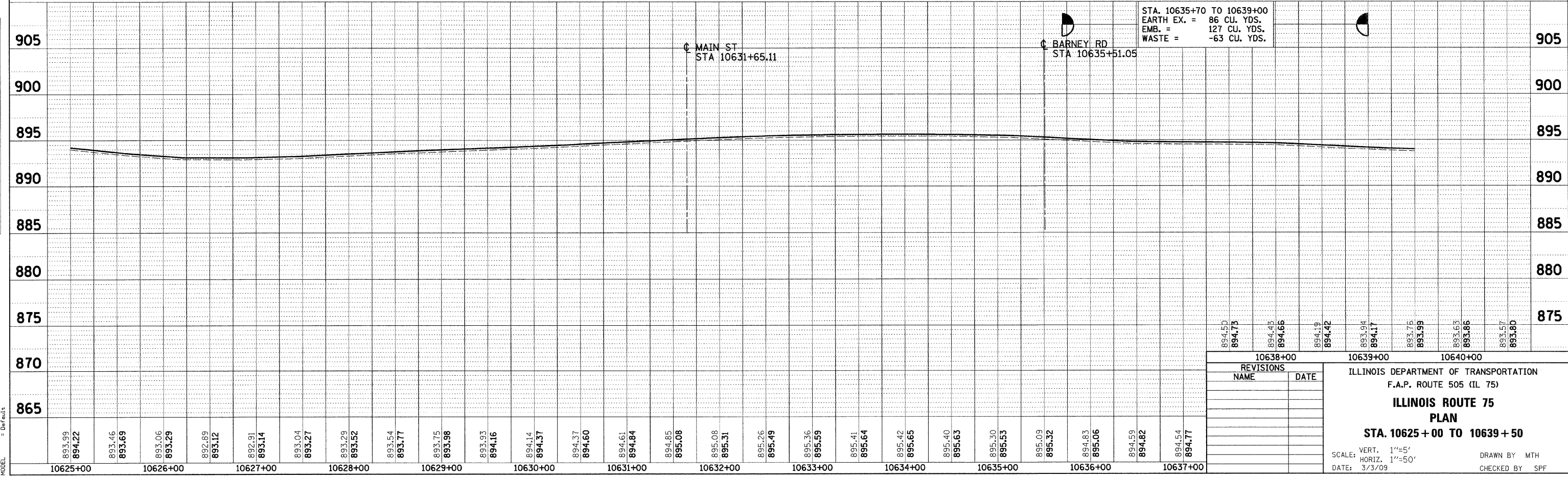

| REVISIONS | |
|-----------|------|
| NAME | DATE |
| | |
| | |
| | |
| | |
| | |

ILLINOIS DEPARTMENT OF TRANSPORTATION
 F.A.P. ROUTE 505 (IL 75)
ILLINOIS ROUTE 75
PLAN
STA. 10625 + 00 TO 10639 + 50

SCALE: VERT. 1"=5'
 HORIZ. 1"=50'
 DATE: 3/3/09

DRAWN BY MTH
 CHECKED BY SPF