





F.A.P. RTE.	SECTION	COUNTY	TOTAL SHEETS	SHEET NO.
505	111RS-4, 111BR-1, Yg-15d-RS-1, & (W-15d)T-1	STEPHENSON & WINNEBAGO	335	55
STA.		TO STA.		
FED. ROAD DIST. NO. 2		ILLINOIS FED. AID PROJECT		
CONTRACT NO. 64970				
WILLIAM L. & SYLVIA R. HILLMAN				

REMOVAL LEGEND

-  TREE REMOVAL, UNIT
-  TREE REMOVAL, ACRE
-  PAVEMENT REMOVAL
-  DRIVEWAY REMOVAL

WAYNE A. &
JOANNE M. KOMPROD

DATE	BY
DATE	BY
DATE	BY

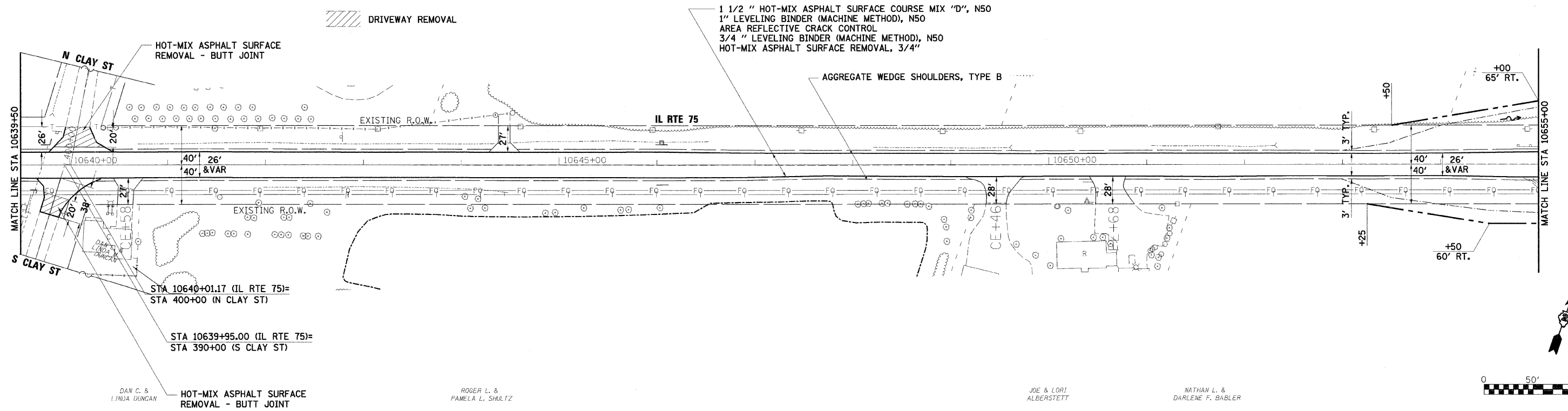

DAN C. &
LINDA DUNGAN

ROGER L. &
PAMELA L. SHULTZ

JOE & LORI
ALBERSTETT

NATHAN L. &
DARLENE F. BABLER

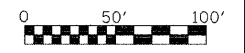

DATE	BY
DATE	BY
DATE	BY

PROFILE SURVEYED
NOTE BOOK
NO.

PLANNING
NOTE BOOK
NO.

DATE: 3/3/2009
FILE NAME: k:\11958000\11_75_3p_east\cadd\design\1958000_FLN02a.dgn
PLOT SCALE: 1"=50'
USER NAME: jfreese
PANEL: default

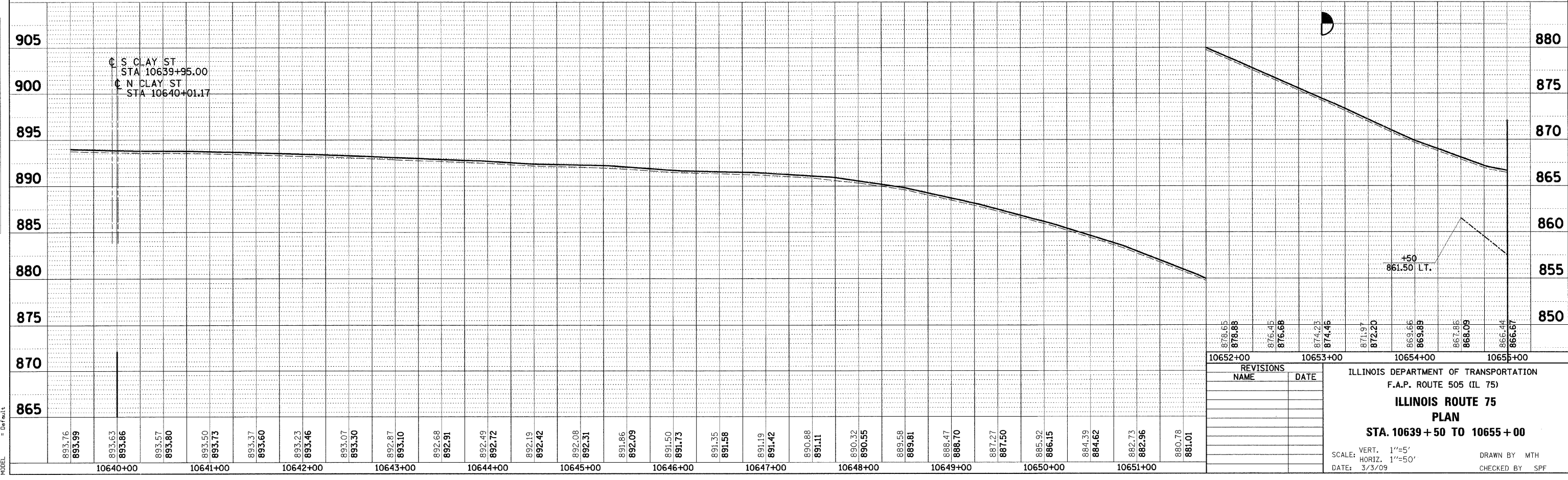

REVISIONS	NAME	DATE

ILLINOIS DEPARTMENT OF TRANSPORTATION
F.A.P. ROUTE 505 (IL 75)
**ILLINOIS ROUTE 75
PLAN**
STA. 10639 + 50 TO 10655 + 00

SCALE: VERT. 1"=5'
HORIZ. 1"=50'
DATE: 3/3/09

DRAWN BY: MTH
CHECKED BY: SPF