

F.A.P. RTE.	SECTION	COUNTY	TOTAL SHEETS	SHEET NO.
505	111RS-4, 111BR-1, Ya-15d-RS-1, & (W-15d)T-1	STEPHENSON & WINNEBAGO	335	56
STA. 10655+00		TO STA. 10670+00		
FED. ROAD DIST. NO. 2 ILLINOIS FED. AID PROJECT				
CONTRACT NO. 64970				

WILLIAM L. & SYLVIA R. HILLMAN

WILLIAM L. & SYLVIA R. HILLMAN

STA 10665+48.91 (IL RTE 75)=
STA 420+00 (N EGGERT RD)

STA 10665+30.70 (IL RTE 75)=
STA 410+00 (S EGGERT RD)

NATHAN L. & DARLENE F. BABLER

MICHAEL W. & ANDREA J. GIBSON

NATHAN L. & DARLENE F. BABLER

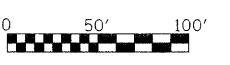

DATE	
BY	
SURVEYED	
PLAN	
NOTE BOOK	
ALIGNMENT CHECKED	
CAD FILE NAME	
NO.	

DATE	
BY	
SURVEYED	
PROFILE	
NOTE BOOK	
GRADES CHECKED	
PLAN NOTED	
PLOT SCALE	
USER NAME	
NO.	

PLOT DATE = 3/3/2009
FILE NAME = k:\11198800\11_75_3p_east\cadd\design\198801.PL03.dgn
PLOT SCALE = 1/8" = 1' - 0"
USER NAME = J.Treney
MODEL = Default

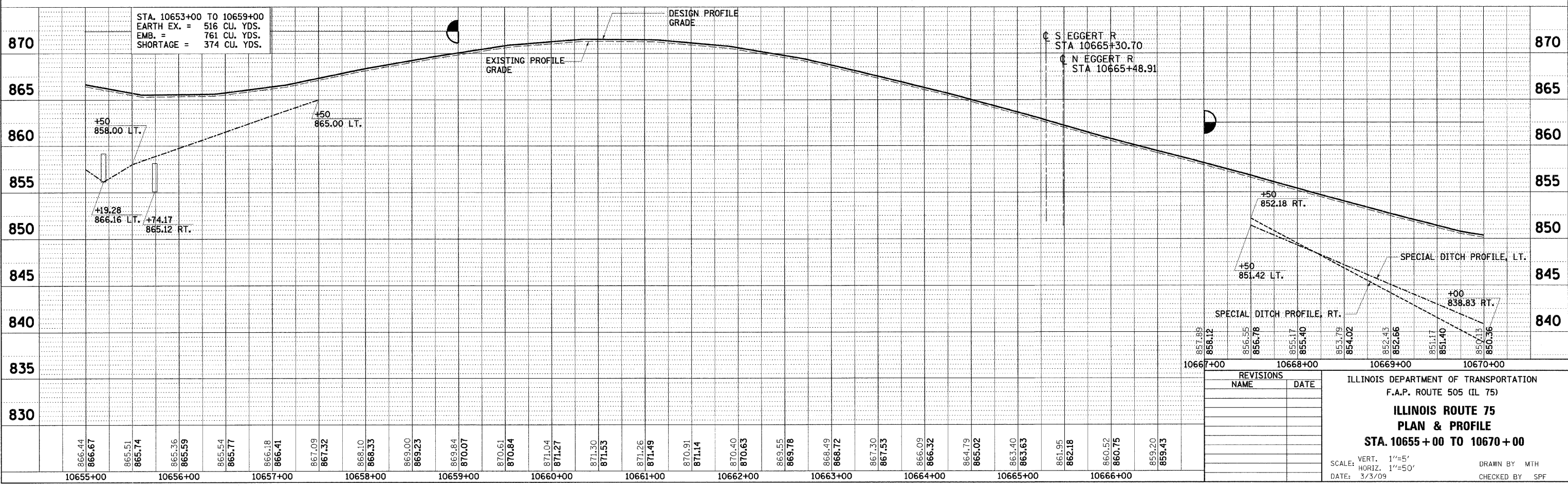
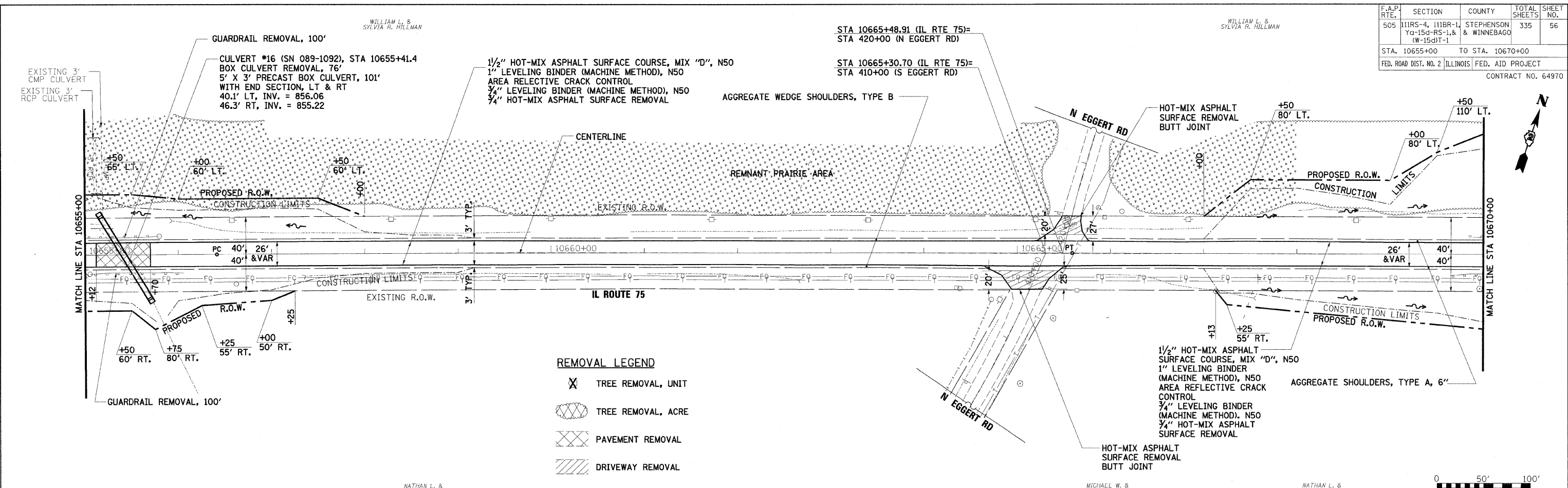

REVISIONS	
NAME	DATE

ILLINOIS DEPARTMENT OF TRANSPORTATION
F.A.P. ROUTE 505 (IL 75)
**ILLINOIS ROUTE 75
PLAN & PROFILE
STA. 10655 + 00 TO 10670 + 00**

SCALE: VERT. 1"=5'
HORIZ. 1"=50'
DATE: 3/3/09

DRAWN BY MTH
CHECKED BY SPF