

F.A.P. RTE.	SECTION	COUNTY	TOTAL SHEETS	SHEET NO.
505	111RS-4, 111BR-1, Yg-15d-RS-1, & (W-15d)T-1	STEPHENSON & WINNEBAGO	335	85
STA.		TO STA.		
FED. ROAD DIST. NO. 2		ILLINOIS FED. AID PROJECT		
CONTRACT NO. 64970				

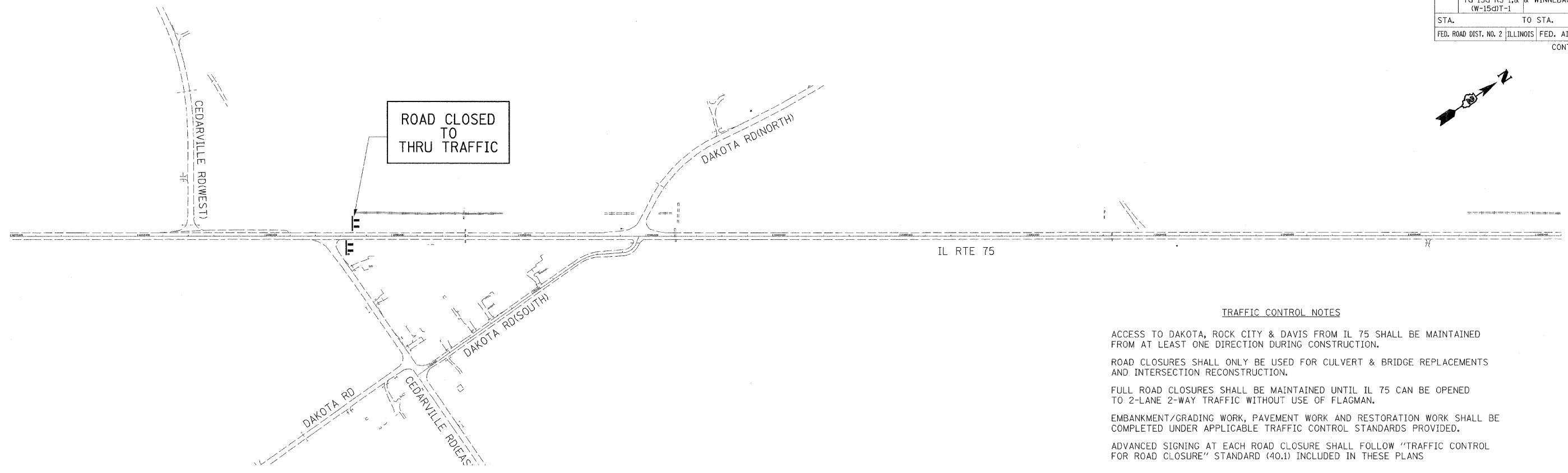
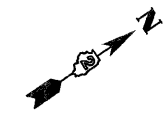

TRAFFIC CONTROL NOTES

ACCESS TO DAKOTA, ROCK CITY & DAVIS FROM IL 75 SHALL BE MAINTAINED FROM AT LEAST ONE DIRECTION DURING CONSTRUCTION.

ROAD CLOSURES SHALL ONLY BE USED FOR CULVERT & BRIDGE REPLACEMENTS AND INTERSECTION RECONSTRUCTION.

FULL ROAD CLOSURES SHALL BE MAINTAINED UNTIL IL 75 CAN BE OPENED TO 2-LANE 2-WAY TRAFFIC WITHOUT USE OF FLAGMAN.

EMBANKMENT/GRADING WORK, PAVEMENT WORK AND RESTORATION WORK SHALL BE COMPLETED UNDER APPLICABLE TRAFFIC CONTROL STANDARDS PROVIDED.

ADVANCED SIGNING AT EACH ROAD CLOSURE SHALL FOLLOW "TRAFFIC CONTROL FOR ROAD CLOSURE" STANDARD (40.1) INCLUDED IN THESE PLANS

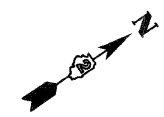

REVISIONS	
NAME	DATE

ILLINOIS DEPARTMENT OF TRANSPORTATION
F.A.P. ROUTE 505 (IL 75)

**ILLINOIS ROUTE 75
TRAFFIC CONTROL PLAN
ROAD CLOSURES**

SCALE: VERT. 1"=50'
HORIZ. 1"=50'
DATE: 3/3/09

DRAWN BY: MTH
CHECKED BY: SPF

PLOT DATE = 3/3/2009
FILE NAME = K:\11150820\11_75_3p_000\000\design\1150820\11_75_3p_000\000\Traf_Con_RC_Plot.dgn
PLOT SCALE = 1:200
PLOT NAME = 11200
MODEL = 11200