

F.A.P. RTE.	SECTION	COUNTY	TOTAL SHEETS	SHEET NO.
505	111RS-4, 111BR-1, 111C-1, 111D-1, 111E-1, 111F-1, 111G-1, 111H-1, 111I-1, 111J-1, 111K-1, 111L-1, 111M-1, 111N-1, 111O-1, 111P-1, 111Q-1, 111R-1, 111S-4, 111T-1, 111U-1, 111V-1, 111W-1, 111X-1, 111Y-1, 111Z-1	STEPHENSON & WINNEBAGO	335	96
STA.		TO STA.		
FED. ROAD DIST. NO. 2 ILLINOIS FED. AID PROJECT				
CONTRACT NO. 64970				

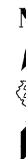

① REMOVE EXISTING METAL END SECTION AND EXTEND CULVERT WITH 50'-15" CMP. INSTALL NEW SLOPE METAL END SECTION WITH GRATE, 15-INCH

1/2" HMA SURFACE COURSE, MIX "D", N50

PROPOSED PAVEMENT (PAID FOR AS HOT-MIX ASPHALT PAVEMENT (FULL DEPTH, 12")
2", HOT-MIX ASPHALT SURFACE COURSE, MIX "D", N50
10", HOT-MIX ASPHALT BINDER COURSE, IL-19.0, N50
SUB-BASE GRANULAR MATERIAL, TYPE A 12"

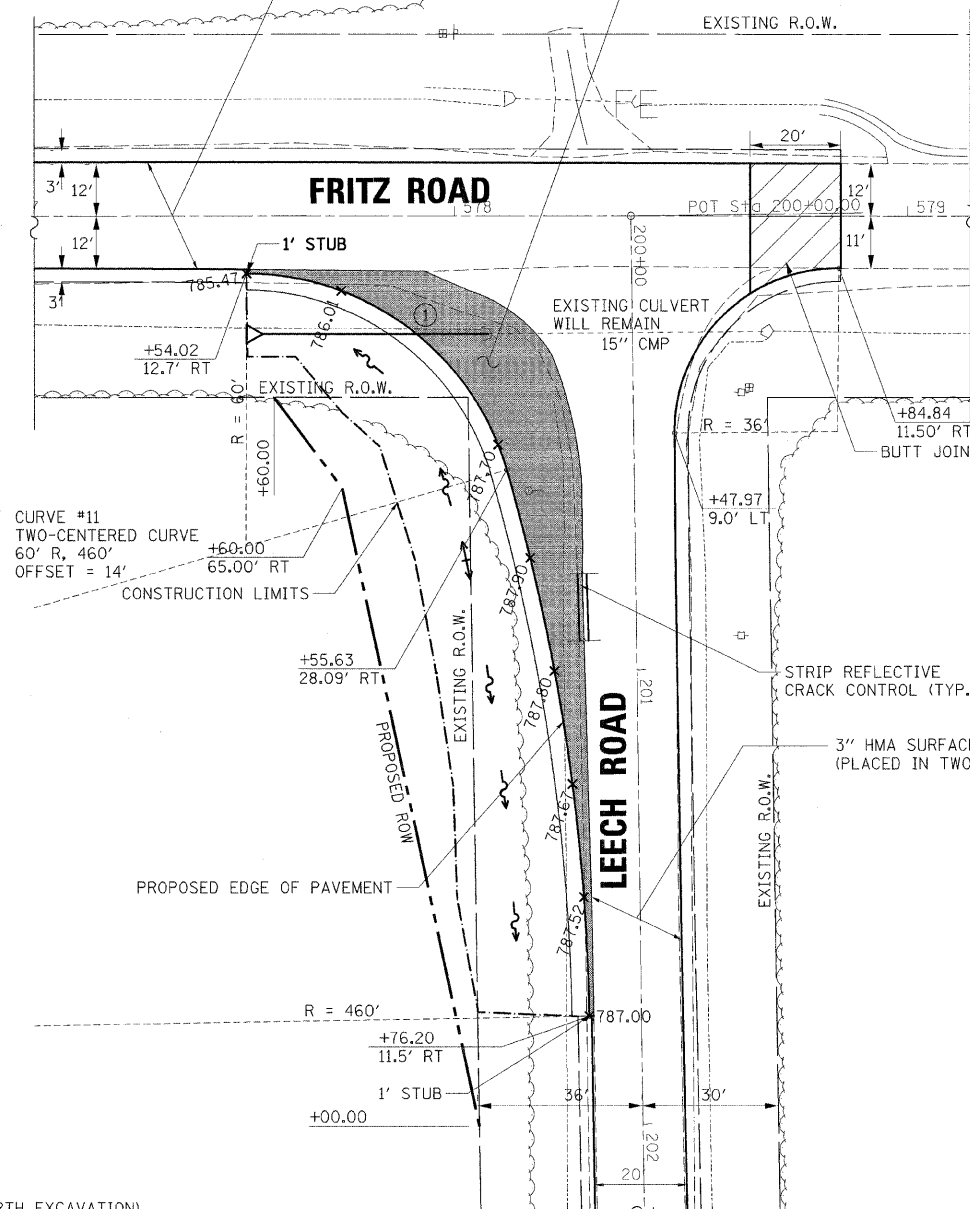

EXIST. CURVE 1280
PI STA. = 578+79.54
 $\Delta = 0^\circ 45' 31''$ (RT)
 $D = 0^\circ 07' 01''$
 $R = 49,029.81'$
 $T = 324.54'$
 $L = 649.07'$
 $E = 1.07'$
 $e =$
 $T.R. =$
S.E. RUN =
P.C. STA. = 575+55.00
P.T. STA. = 582+04.07

DETOUR INTERSECTION EARTHWORK VOLUME

EARTH EXCAVATION = 430 CY
EMBANKMENT = 21 CY
TOPSOIL PLACEMENT = 67 CY
TOPSOIL STRIPPING = 61 CY

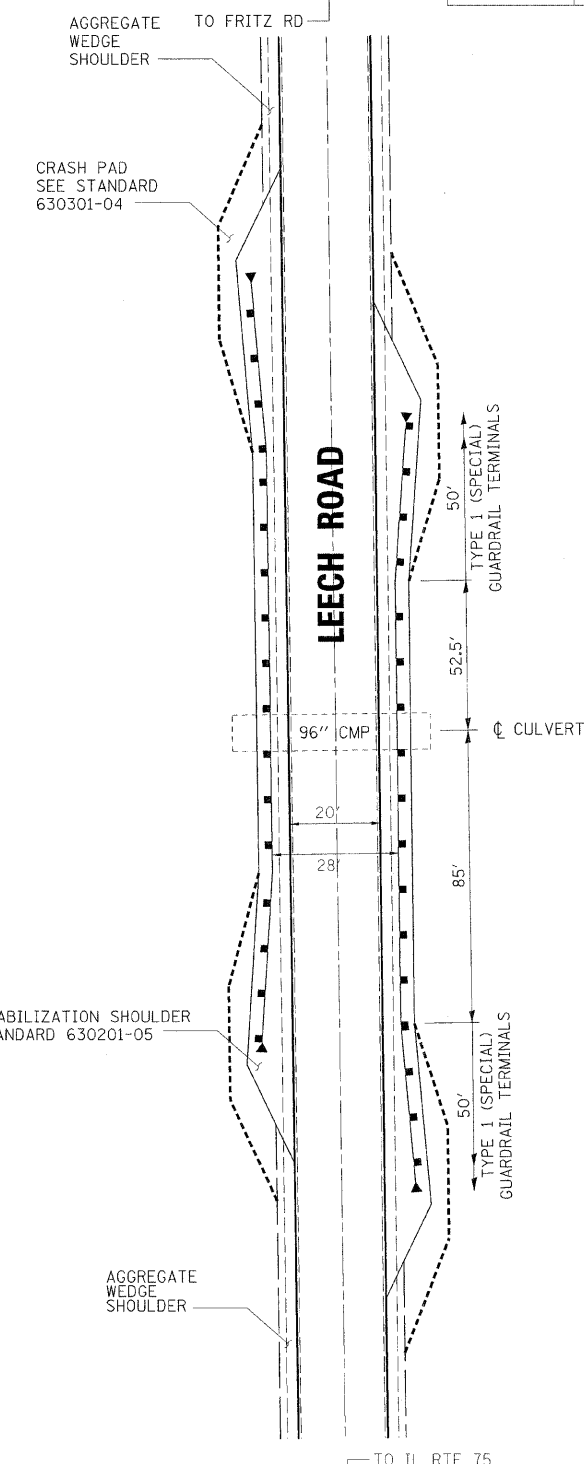

REMOVAL LEGEND

- DRIVEWAY PAVEMENT REMOVAL (PAID FOR AS EARTH EXCAVATION)
- BARRIER MEDIAN REMOVAL
- HOT-MIX ASPHALT REMOVAL

REVISIONS	
NAME	DATE

ILLINOIS DEPARTMENT OF TRANSPORTATION
F.A.P. ROUTE 505 (IL 75)
TRAFFIC CONTROL PLAN
DETOUR PAVING DETAILS
LEECH ROAD & FRITZ ROAD

SCALE: VERT. 1" = 20'
HORIZ. 1" = 20'
DATE: 3/3/09

DRAWN BY: MTH
CHECKED BY: SPF

PLOT DATE = 3/3/2009
 FILE NAME = K:\11198800\1175-3p_eest\acad\design\198801_Des_Traf_Con_04.dgn
 PLOT SCALE = 1:20
 PLOT NAME = 11198800.dwg
 MODEL = 11198800