

STAGE 1

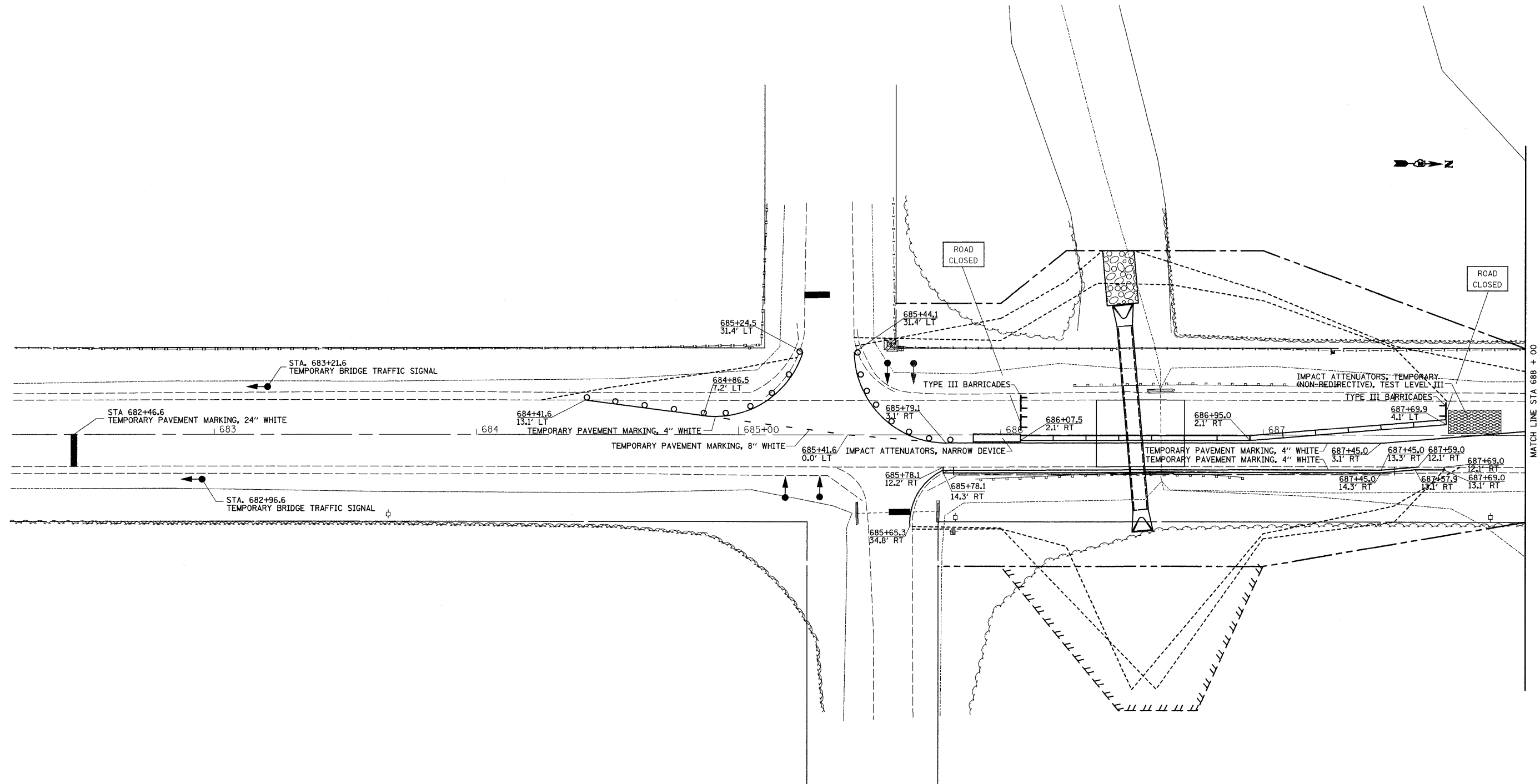

MATCH LINE STA 688 + 00

NOTE: 1. WIDENING WILL BE CONSTRUCTED USING TRAFFIC CONTROL AND PROTECTION STANDARD 701326.
 2. SIDE ROAD SIGNAL HEADS WILL REMAIN IN PLACE FOR STAGE 2. NO ADDITIONAL COMPENSATION IF HEADS NEED TO BE RELOCATED.

FILE NAME = #FILEL#	USER NAME = fordjd	DESIGNED -	REVISED -	STATE OF ILLINOIS DEPARTMENT OF TRANSPORTATION	IL ROUTE 40				F.A.P. RTE.	SECTION	COUNTY	TOTAL SHEETS	SHEET NO.
	PLOT SCALE = 20.0000' / IN.	DRAWN -	REVISED -		646	4T-2	CARROLL	63	37				
	PLOT DATE = Fri Mar 13 12:12:47 2009	CHECKED -	REVISED -		SCALE: SHEET NO. OF SHEETS STA. TO STA.				CONTRACT NO. 64D12				
ILLINOIS FED. AID PROJECT													