

F.A.I. RTE.	SECTION	COUNTY	TOTAL SHEETS	SHEET NO.
80	D3 TREE PLANTING 2010-1	GRUNDY	5	1
FED. ROAD DIST. NO.	ILLINOIS	CONTRACT NO. 66928		

STATE OF ILLINOIS  
DEPARTMENT OF TRANSPORTATION  
DIVISION OF HIGHWAYS

**PROPOSED  
HIGHWAY PLANS**

FAI ROUTE 80 (I-80)  
SECTION D3 TREE PLANTING 2010-1

GRUNDY COUNTY

C - 93 - 063 - 09

INDEX OF SHEETS

- 1 COVER SHEET
- 2 GENERAL NOTES, SUMMARY OF QUANTITIES, AND SCHEDULE OF QUANTITIES
- 3 PLANTING DETAILS
4. TOPO WEST HALF I-80 & RIDGE ROAD INTERCHANGE
5. TOPO EAST HALF I-80 & RIDGE ROAD INTERCHANGE

STANDARDS

- 000001-05 STANDARD SYMBOLS, ABBREVIATIONS AND PATTERNS  
701101-02 OFF-ROAD OPERATIONS MULTILANE, 4.5 m (15') TO 600 mm (24") FROM PAVEMENT EDGE  
701106-02 OFF-ROAD OPERATIONS, MULTILANE, MORE THAN 4.5 m (15') AWAY  
701901-01 TRAFFIC CONTROL DEVICES

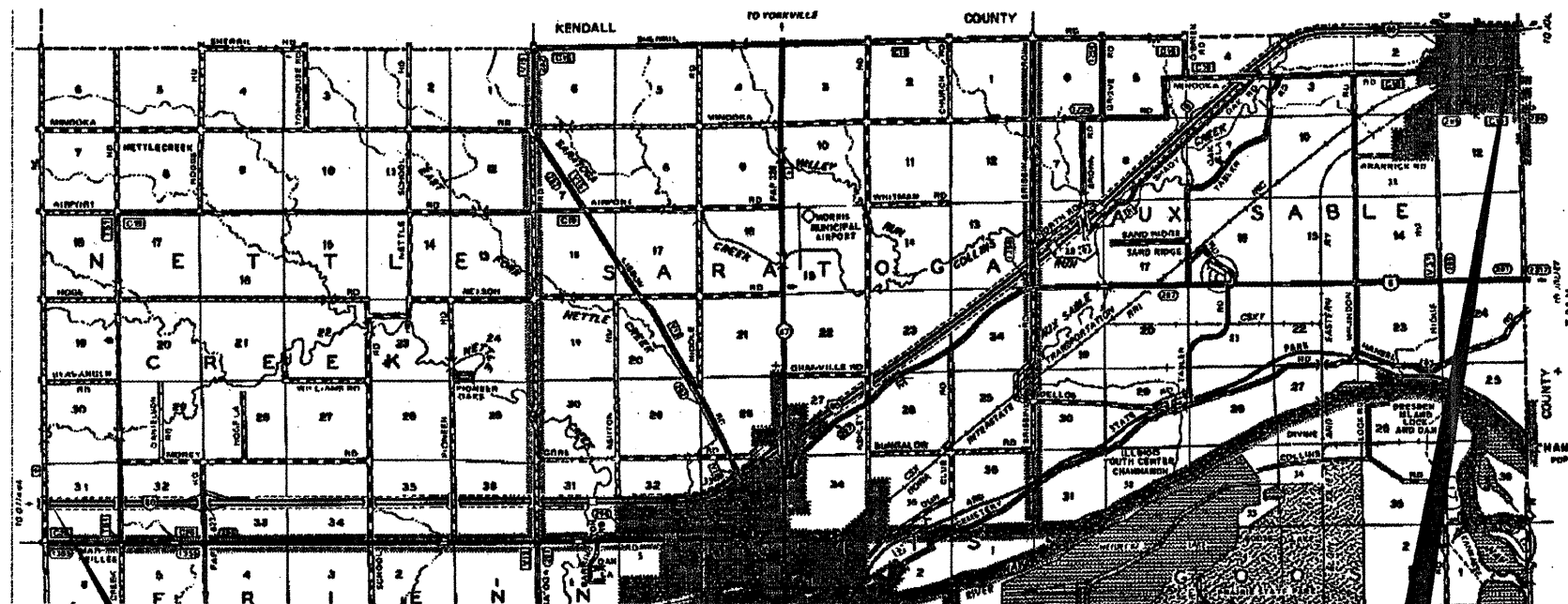
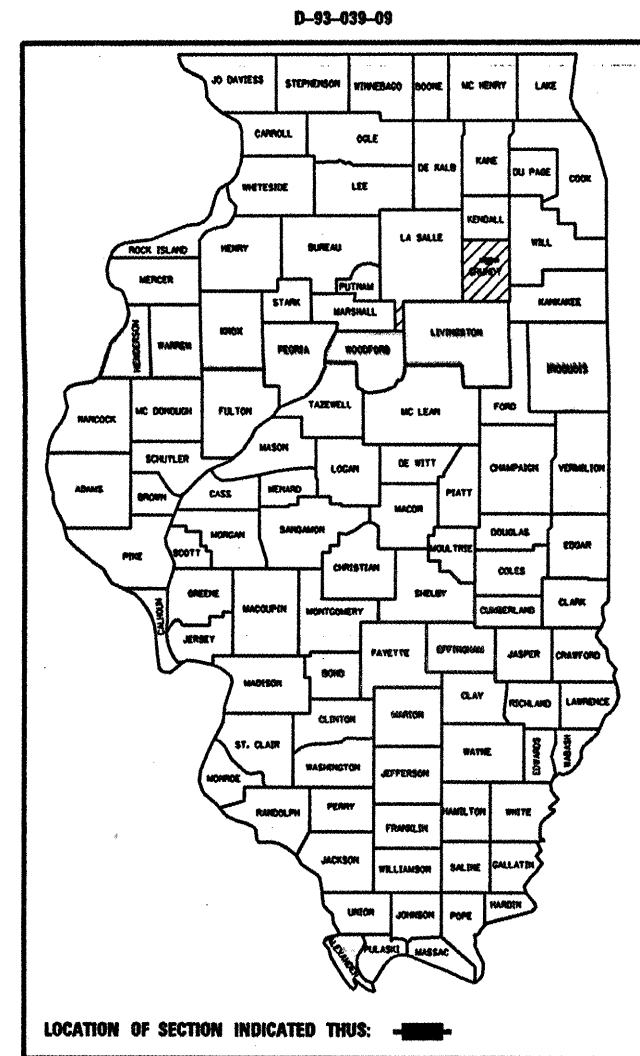

MICROFILMED \_\_\_\_\_  
REEL NUMBER \_\_\_\_\_  
AWARDED \_\_\_\_\_  
RESIDENT ENGINEER \_\_\_\_\_  
AS BUILT CHANGES WERE MADE  
ON THE FOLLOWING SHEETS \_\_\_\_\_

J.U.L.I.E.  
JOINT UTILITY LOCATION INFORMATION FOR EXCAVATION  
1-800-892-0123  
OR 811

PROJECT ENGINEER: CRAIG REED  
UNIT CHIEF: MARK JONES  
DISTRICT 3 NO. (815) 434-6131  
CONTRACT NO. 66928

BEGIN PROJECT I-80 MILE MARKER 103.0

END PROJECT I-80 MILE MARKER 122.5

I-80 GROSS LENGTH = 19.5 MI.

STATE OF ILLINOIS  
DEPARTMENT OF TRANSPORTATION  
DIVISION OF HIGHWAYS

SUBMITTED 20  
*Heary Ryan*  
DEPUTY DIRECTOR OF HIGHWAYS, REGION ENGINEER

May 8, 2009  
*Charles J. Ingersoll*  
ENGINEER OF DESIGN AND ENVIRONMENT

May 8, 2009  
*Christine M. Reed*  
DIRECTOR OF HIGHWAYS, CHIEF ENGINEER

PRINTED BY THE AUTHORITY  
OF THE STATE OF ILLINOIS

PLOT DATE = Mar 26, 2009 - 01:20:08 PM  
FILE NAME = c:\p\work\PI\DOT\SCHWANKER\0127080\0366928-sht-cover.dgn  
PLOT SCALE = 100.00000 1/ IN.  
USER NAME = schwankeg

**GENERAL NOTES**  
(Revised January 23, 2009)

ABANDONED UNDERGROUND UTILITIES THAT CONFLICT WITH CONSTRUCTION SHALL BE DISPOSED OF OUTSIDE THE LIMITS OF THE RIGHT OF WAY ACCORDING TO ARTICLE 202.03 OF THE STANDARD SPECIFICATIONS AND AS DIRECTED BY THE ENGINEER. THIS WORK WILL NOT BE PAID FOR SEPARATELY, BUT SHALL BE INCLUDED IN THE COST OF EARTH EXCAVATION.

ANY REFERENCE TO A STANDARD IN THESE PLANS SHALL BE INTERPRETED TO MEAN THE EDITION AS INDICATED BY THE SUBNUMBER SHOWN IN THE LIST OF STANDARDS OR THE COPY INCLUDED IN THESE PLANS.

THE CONTRACTOR'S ATTENTION IS DIRECTED TO THE PRESENCE OF DEPARTMENT-OWNED UNDERGROUND ELECTRICAL CABLE WITHIN THE LIMITS OF THE PROPOSED IMPROVEMENT. THE CONTRACTOR SHALL REQUEST THE ILLINOIS DEPARTMENT OF TRANSPORTATION IN OTTAWA (815-434-8417) TO LOCATE THE UNDERGROUND FACILITIES, PROVIDING A MINIMUM OF 72 HOURS NOTICE. THE DEPARTMENT IS NOT A MEMBER OF THE JOINT UTILITY LOCATING INFORMATION FOR EXCAVATORS (JULIE) SYSTEM.

ALL DAMAGE TO DEPARTMENT OWNED UNDERGROUND FACILITIES, CAUSED BY THE CONTRACTOR SHALL BE REPAIRED TO THE SATISFACTION OF THE DEPARTMENT AT THE CONTRACTOR'S EXPENSE. THIS SHALL INCLUDE ALL TEMPORARY REPAIRS REQUIRED TO KEEP THE FACILITY OPERATIONAL WHILE MATERIAL IS BEING OBTAINED TO MAKE PERMANENT REPAIRS. SPLICING OF ELECTRIC CABLE SHALL NOT BE ALLOWED. ELECTRIC CABLE SHALL BE REPLACED FROM POLE TO POLE OR CONTROLLER.

MEMBERS OF JULIE KNOWN TO BE WITHIN THE LIMITS OF THE IMPROVEMENT ARE:  
COMMONWEALTH EDISON COMPANY  
N.I.C.O.R.  
AT&T  
COMCAST  
CITY OF MINOOKA  
CITY OF MORRIS  
KINDER MORGAN ENERGY

NON-MEMBERS OF JULIE KNOWN TO BE WITHIN THE LIMITS OF THE IMPROVEMENT ARE:  
STATE OF ILLINOIS

THE CONTRACTOR SHALL CONTACT JULIE AT LEAST 48 HOURS PRIOR TO EXCAVATION TO DETERMINE WHICH UTILITIES ARE IN THE AREA.

SUMMARY OF QUANTITIES			URBAN Y003 TOTAL
CODE NO.	ITEM	UNIT	
67100100	MOBILIZATION	L SUM	1
A2005020	TREE, GYMNOCLADUS DIOICUS (KENTUCKY COFFEETREE), 2-1/2" CALIPER, BALLED AND BURLAPPED	EACH	18
B2002724	TREE, MALUS ADIRONDACK (ADIRONDACK CRAB APPLE), 3" CALIPER, TREE FORM, BALLED AND BURLAPPED	EACH	21
C2C005G3	SHRUB, CORYLUS AMERICANA (AMERICAN FILBERT), CONTAINER GROWN, 3-GALLON	EACH	280
C2C008G3	SHRUB, RHUS AROMATICA (FRAGRANT SUMAC), CONTAINER GROWN, 3-GALLON	EACH	275
C2C016G3	SHRUB, CORNUS RACEMOSA (GRAY DOGWOOD), CONTAINER GROWN, 3-GALLON	EACH	330
C2012826	SHRUB, VIBURNUM TRILOBUM (AMERICAN CRANBERRY VIBURNUM), 30" HEIGHT, BALLED AND BURLAPPED	EACH	255
C2C00524	SHRUB, ARONIA MELANOCARPA (BLACK CHOKEBERRY), 2' HEIGHT, CONTAINER	EACH	1095
D2C015G3	EVERGREEN, JUNIPERUS VIRGINIANA (EASTERN RED CEDAR), CONTAINER GROWN, 3-GALLON	EACH	1095

STATE OF ILLINOIS  
DEPARTMENT OF TRANSPORTATION  
DISTRICT THREE

PREPARED BY: *Rich Powell*  
DISTRICT STUDIES & PLANS ENGINEER

DATE: 3-26-09

EXAMINED BY: *[Signature]*  
DISTRICT CONSTRUCTION ENGINEER

*[Signature]*  
DISTRICT MATERIALS ENGINEER  
*[Signature]*  
DISTRICT OPERATIONS ENGINEER

FILE NAME *	USER NAME * sahwertorg	DESIGNED -	REVISED -
as:\pwork\PM1001\SDHWERTORG\036928-shr-coover.dgn		DRAWN -	REVISED -
PLOT SCALE = 1/8"=1'-0"		CHECKED -	REVISED -
PLOT DATE = Mar 26, 2009 - 02:19:24 PM		DATE -	REVISED -

STATE OF ILLINOIS  
DEPARTMENT OF TRANSPORTATION

GENERAL NOTES AND SUMMARY OF QUANTITIES

SCALE: SHEET NO. OF SHEETS STA. TO STA.

F.A.I. RTE.	SECTION	COUNTY	TOTAL SHEETS	SHEET NO.
80	03 TREE PLANTING 2010-1	GRUNDY	5	2
FED. ROAD DIST. NO.			ILLINOIS FED. AID PROJECT	
			CONTRACT NO. 66928	

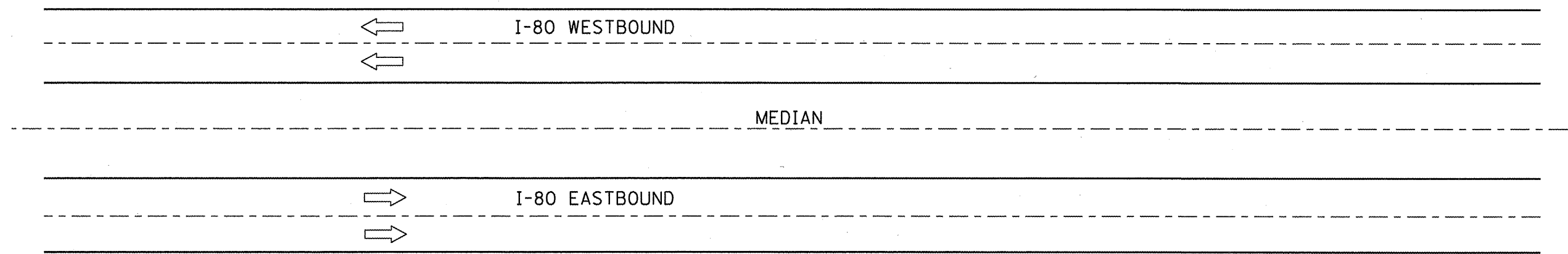
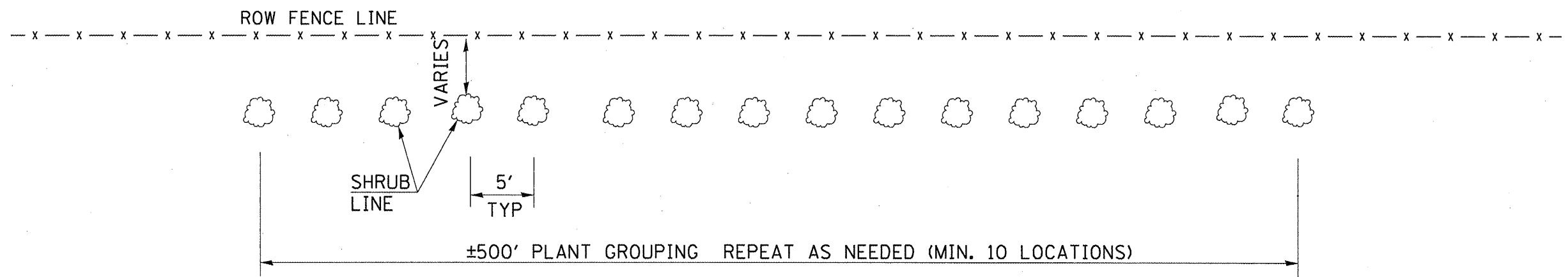

**SHRUB PLACEMENT DETAIL**  
FOR ALL BLACK CHOKECHERRY AND  
EASTERN RED CEDAR PLANTINGS

**NOTES**

PLACE PLANTINGS ALONG R.O.W. ON NORTH SIDE OF HIGHWAY/I-80 WESTBOUND.

PLACEMENT OF SHRUBS AND TREES SHALL NOT INTERFERE WITH EXISTING PREVIOUSLY DEPARTMENT PLANTED SHRUB OR TREE LINES

ITEM C2C00524 AND D2C015G3 WILL BE PLANTED BETWEEN MP 103 AND MP 122.5. CONTACT LANDSCAPE ARCHITECT (KATHY CINDRICH), 815-434-8445 TWO WEEKS PRIOR TO PLANTING FOR EXACT LOCATIONS.

FILE NAME =	USER NAME = schwankeg	DESIGNED -	REVISED -	<b>STATE OF ILLINOIS DEPARTMENT OF TRANSPORTATION</b>	<b>PLANTING DETAIL</b>			F.A.I. RTE.	SECTION	COUNTY	TOTAL SHEETS	SHEET NO.
ca:\pki_work\PIWIDOT\SCHWANKERG\0127008\366928-sht-cover.dgn	DRAWN -	REVISED -	80					D3 TREE PLANTING 2010-1	GRUNDY	5	3	
PLOT SCALE = 100.0000' / IN.	CHECKED -	REVISED -	CONTRACT NO. 66928									
PLOT DATE = Mar 26, 2009 - 11:32:22 AM	DATE -	REVISED -	SCALE:		SHEET NO.	OF SHEETS	STA.	TO STA.	FED. ROAD DIST. NO.	ILLINOIS FED. AID PROJECT		

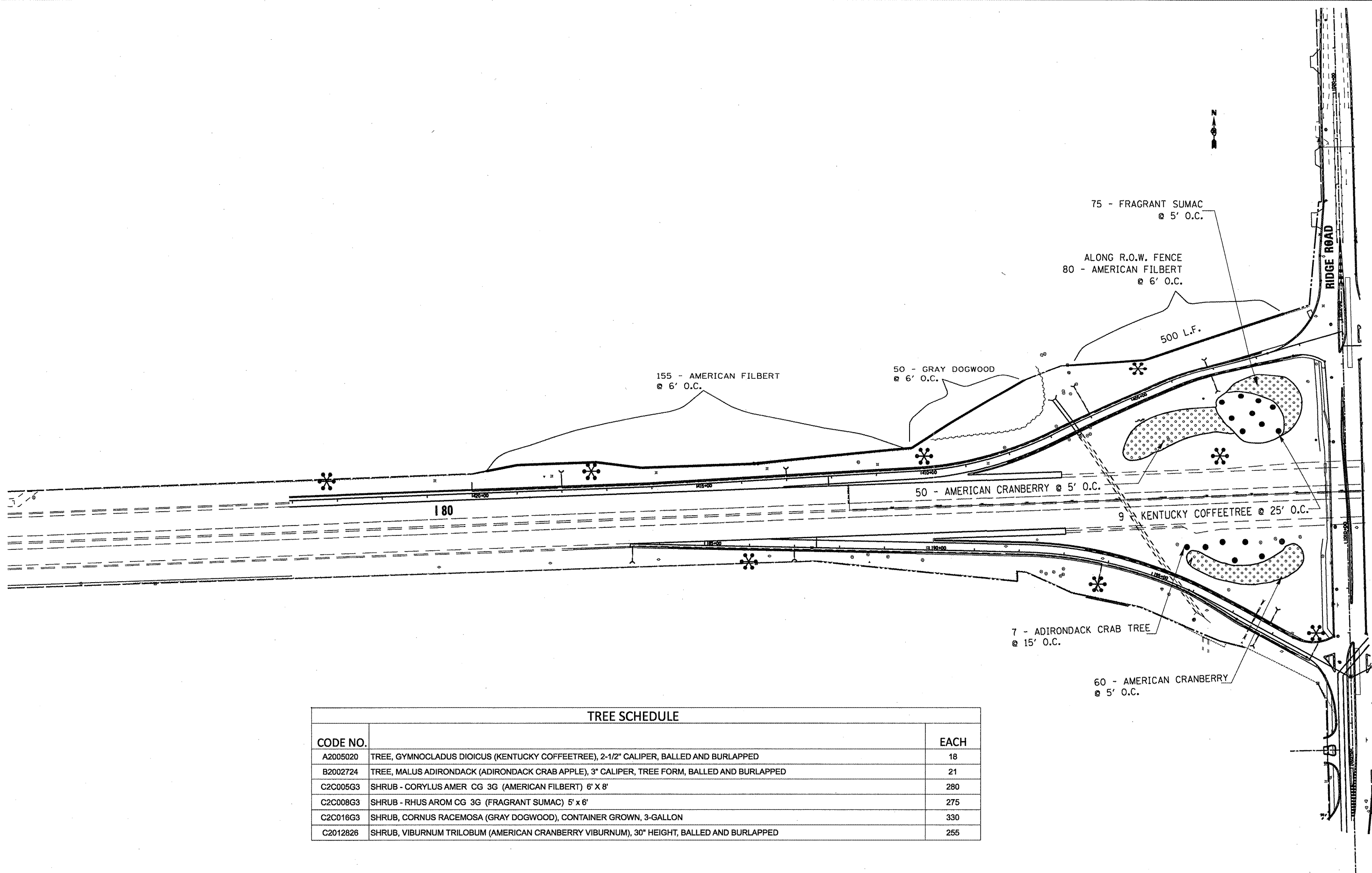

TREE SCHEDULE		
CODE NO.		EACH
A2005020	TREE, GYMNOCLADUS DIOICUS (KENTUCKY COFFEETREE), 2-1/2" CALIPER, BALLED AND BURLAPPED	18
B2002724	TREE, MALUS ADIRONDACK (ADIRONDACK CRAB APPLE), 3" CALIPER, TREE FORM, BALLED AND BURLAPPED	21
C2C005G3	SHRUB - CORYLUS AMER CG 3G (AMERICAN FILBERT) 6' X 8'	280
C2C008G3	SHRUB - RHUS AROM CG 3G (FRAGRANT SUMAC) 5' X 6'	275
C2C016G3	SHRUB, CORNUS RACEMOSA (GRAY DOGWOOD), CONTAINER GROWN, 3-GALLON	330
C2012826	SHRUB, VIBURNUM TRILOBUM (AMERICAN CRANBERRY VIBURNUM), 30" HEIGHT, BALLED AND BURLAPPED	255

FILE NAME =  
 USER NAME = schwankeg  
 DESIGNED -  
 DRAWN -  
 PLOT SCALE = 200.0000' / IN.  
 CHECKED -  
 PLOT DATE = Mar 26, 2009 - 11:32:50 AM  
 DATE -

REVISED -  
 REVISED -  
 REVISED -  
 REVISED -

**STATE OF ILLINOIS  
 DEPARTMENT OF TRANSPORTATION**

**LANDSCAPE DETAIL AT INTERCHANGE /WEST  
 MILE POST 122**

SCALE: SHEET NO. OF SHEETS STA. TO STA.

F.A.I. RTE.	SECTION	COUNTY	TOTAL SHEETS	SHEET NO.
80	D3 TREE PLANTING 2010-1	GRUNDY	5	4
CONTRACT NO. 66928				
ILLINOIS FED. AID PROJECT				

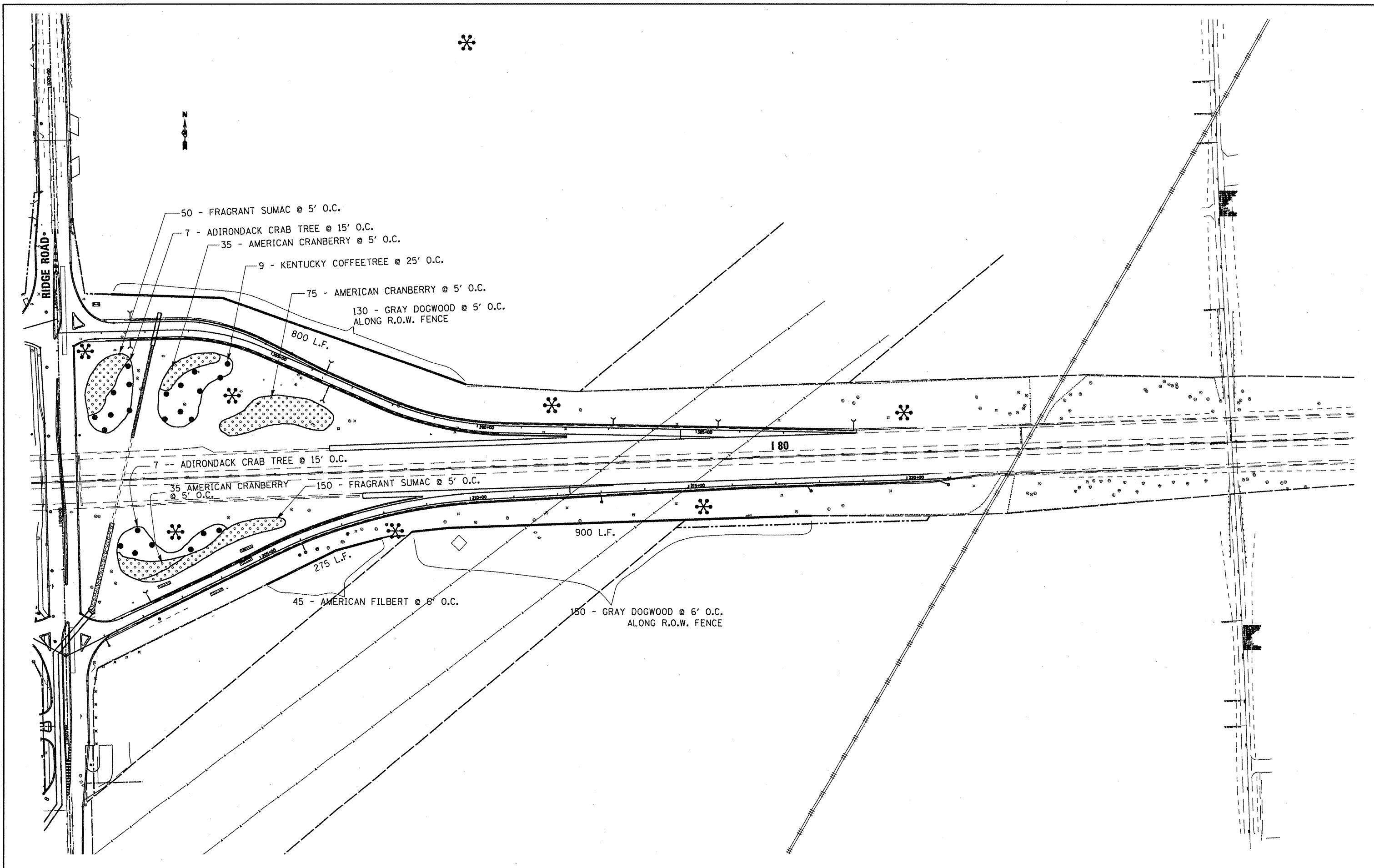

FILE NAME =	USER NAME = schwankerg	DESIGNED -	REVISED -
at:\pwork\p\WIDOT\SCHWANKERG\d0127008\366928-sht-cover.dgn		DRAWN -	REVISED -
PLOT SCALE = 200.0000' / IN.		CHECKED -	REVISED -
PLOT DATE = Mar 26, 2009 - 11:33:16 AM		DATE -	REVISED -

**STATE OF ILLINOIS  
DEPARTMENT OF TRANSPORTATION**

**LANDSCAPE DETAIL AT INTERCHANGE /EAST  
MILE POST 122**

SCALE: SHEET NO. OF SHEETS STA. TO STA.

F.A.I. RTE.	SECTION	COUNTY	TOTAL SHEETS	SHEET NO.
80	D3 TREE PLANTING 2010-1	GRUNDY	5	5
CONTRACT NO. 66928				
ILLINOIS FED. AID PROJECT				