

**PLAN**

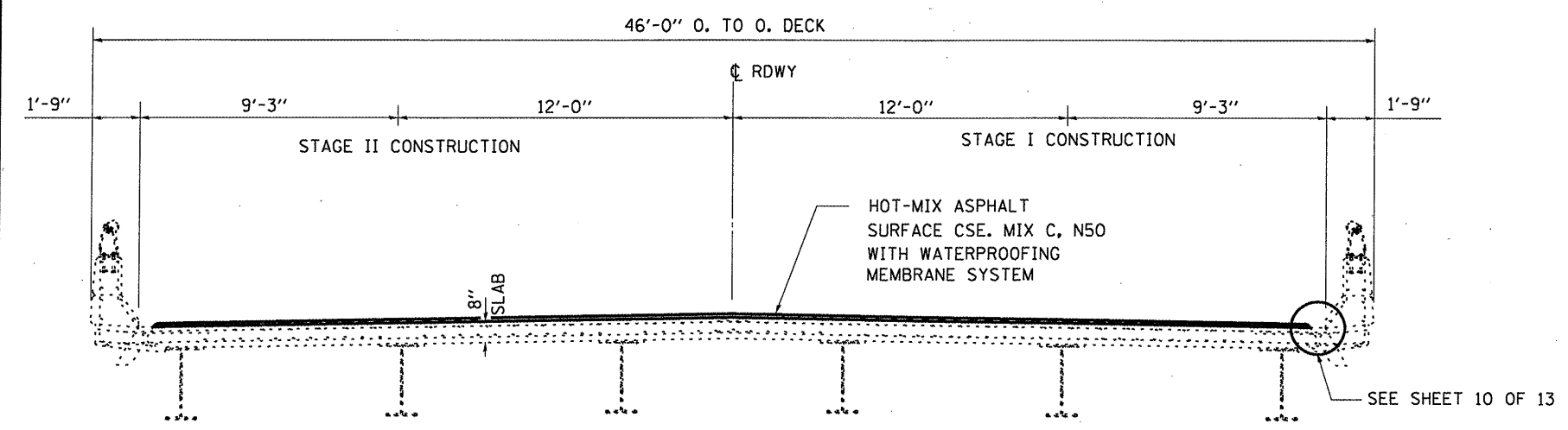

**CROSS SECTION**  
LOOKING NORTH

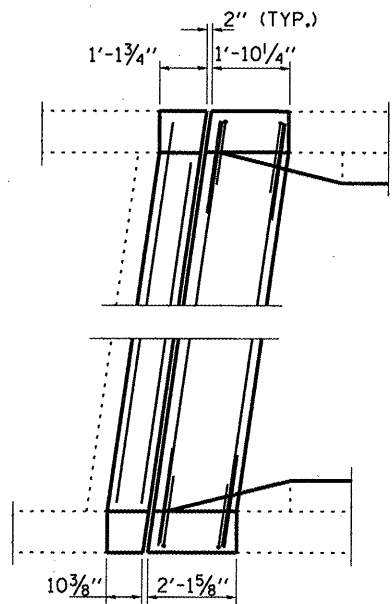

**CORNER DETAIL**  
(TYPICAL)

**BILL OF MATERIAL**

Bar	No.	Size	Length	Shape
a(E)	24	#6	22'-6"	—
a <sub>1</sub> (E)	12	#6	4'-0"	—
d(E)	12	#4	4'-7"	—
d <sub>1</sub> (E)	12	#5	3'-1"	—
h(E)	24	#6	22'-0"	—
v(E)	16	#6	6'-11"	—
REINFORCEMENT BARS, EPOXY COATED		POUND	1940	
BAR SPLICERS		POUND	24	
CONCRETE REMOVAL		CU YD	13	
CONCRETE STRUCTURES		CU YD	0.7	
CONCRETE SUPERSTRUCTURE		CU YD	12.3	
PREFORMED JOINT STRIP SEAL		FOOT	90	
HMA SURFACE REMOVAL (DECK)		SQ YD	687	
WATERPROOFING MEMBRANE SYSTEM		SQ YD	687	
HMA SURFACE CSE, MIX C, N50		TON	58	
Flex DRAIN EXTENSIONS		EACH	20	
PLUG EXISTING DECK DRAINS		EACH	20	