

F.A.P. RTE.	SECTION	COUNTY	TOTAL SHEETS	SHEET NO.
*	**	FORD	7	1
ILLINOIS CONTRACT NO. 66941				

* FAP 693,697 (IL 9), FAP 71 (IL 54)
 ** D3 AGGREGATE SHOULDERS 2010-1

INDEX OF SHEETS

1. COVER SHEET
2. GENERAL NOTES
3. SUMMARY OF QUANTITIES
4. TYPICAL SECTIONS
5. AGGREGATE SHOULDER SCHEDULE - FAP 693,697 (IL 9)
6. AGGREGATE SHOULDER SCHEDULE - FAP 71 (IL 54)
7. AGGREGATE SHOULDER DETAILS

STANDARDS

- | | |
|-----------|--|
| 701001-02 | OFF-ROAD OPERATIONS 2L, 2W, MORE THAN 4.5 m (15') AWAY |
| 701006-03 | OFF-ROAD OPERATIONS 2L, 2W, 4.5 m (15') TO 600 mm (24") FROM PAVEMENT EDGE |
| 701011-02 | OFF-ROAD MOVING OPERATIONS 2L, 2W, DAY ONLY |
| 701301-03 | LANE CLOSURE, 2L, 2W, SHORT TIME OPERATIONS |
| 701306-02 | LANE CLOSURE, 2L, 2W, SLOW MOVING OPERATIONS DAY ONLY, FOR SPEEDS > 45 MPH |
| 701901-01 | TRAFFIC CONTROL DEVICES |

STATE OF ILLINOIS
DEPARTMENT OF TRANSPORTATION
DIVISION OF HIGHWAYS
PROPOSED
HIGHWAY PLANS

FAP ROUTE 693 & 697 (IL 9)
FAP ROUTE 71 (IL 54)
SECTION D3 AGGREGATE SHOULDERS 2010-1

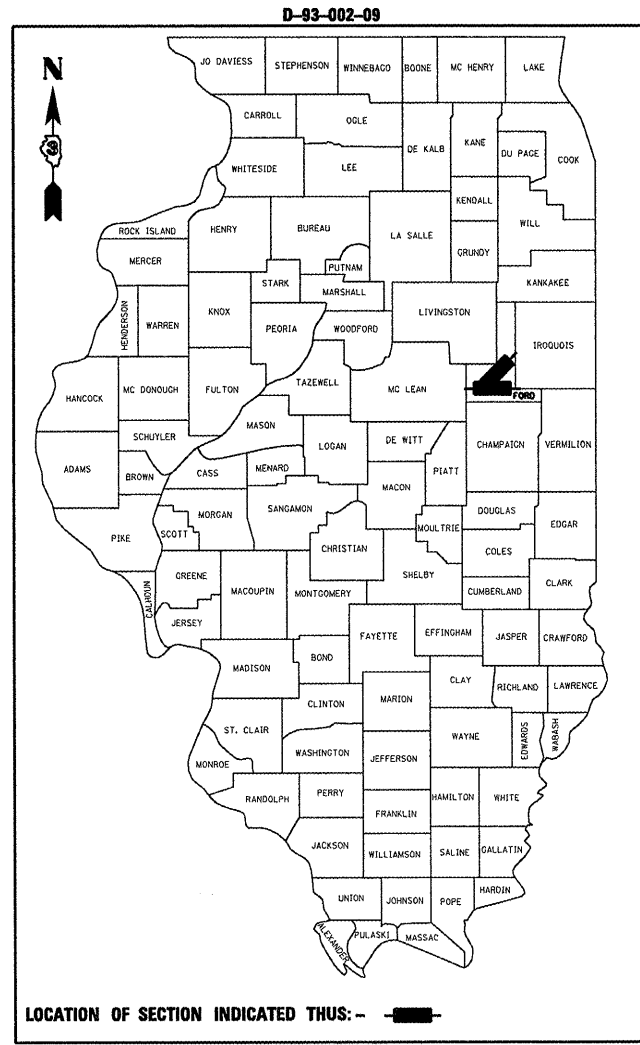

LOCATION OF SECTION INDICATED THUS: - ■ -

FUNCTIONAL CLASSIFICATION
 RURAL - MINOR ARTERIAL
 F.A.P. ROUTE 697 (IL 9)
 2007 ADT = 1750
 P.V = 87.4% M.U. = 8.6% S.U. = 4.0%

FUNCTIONAL CLASSIFICATION
 RURAL - MINOR ARTERIAL
 F.A.P. ROUTE 71 (IL 54)
 2007 ADT = 1500
 P.V = 83.3% M.U. = 10.0% S.U. = 6.7%

PROJECT END
IL ROUTE 54
1400 N. ROAD AT ROBERTS

SHOULDER STONE PLACEMENT
FORD COUNTY
C-93-077-09

PROJECT BEGIN
IL ROUTE 54
500 N. ROAD AT GIBSON CITY

PROJECT END
IL ROUTE 9
McLEAN COUNTY LINE

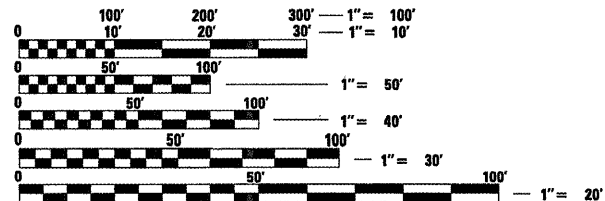
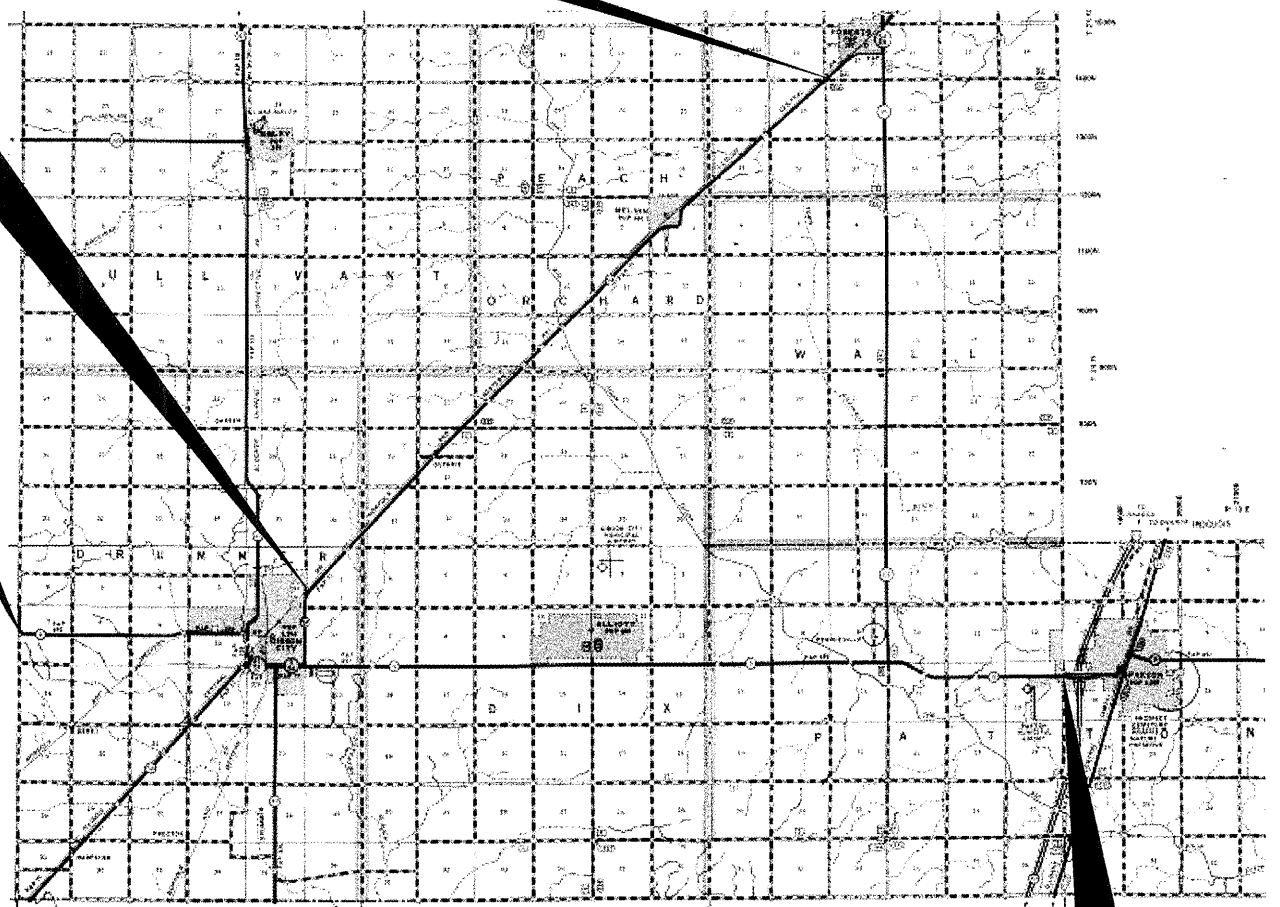

FULL SIZE PLANS HAVE BEEN PREPARED USING STANDARD ENGINEERING SCALES. REDUCED SIZED PLANS WILL NOT CONFORM TO STANDARD SCALES. IN MAKING MEASUREMENTS ON REDUCED PLANS, THE ABOVE SCALES MAY BE USED.

J.U.L.I.E.
 JOINT UTILITY LOCATION INFORMATION FOR EXCAVATION
 1-800-892-0123
 OR 811

PROJECT ENGINEER: JOE KANNEL
UNIT CHIEF: RON WOODSHANK
TOWNSHIP: VARIOUS
CONTRACT NO. 66941

GROSS LENGTH IL RTE 9 = 98102 FT. = 18.58 MILE
 NET LENGTH IL RTE 9 = 58978 FT. = 11.17 MILE

GROSS LENGTH IL RTE 54 = 67478 FT. = 12.78 MILE
 NET LENGTH IL RTE 54 = 61934 FT. = 11.73 MILE

PROJECT BEGIN
IL ROUTE 9
AT 1800 E. ROAD (PAXTON)

STATE OF ILLINOIS
DEPARTMENT OF TRANSPORTATION
DIVISION OF HIGHWAYS

SUBMITTED 4/12 2009
George Rejman
 DEPUTY DIRECTOR OF HIGHWAYS, REGION ENGINEER

May 8, 2009
Charles G. Jorgensen
 ENGINEER OF DESIGN AND ENVIRONMENT

May 8, 2009
Christine M. Reed
 DIRECTOR OF HIGHWAYS, CHIEF ENGINEER

PRINTED BY THE AUTHORITY
OF THE STATE OF ILLINOIS