

F.A.P. RTE.	SECTION	COUNTY	TOTAL SHEETS	SHEET NO.
*	**	FORD	7	1
ILLINOIS CONTRACT NO. 66941				

\* FAP 693,697 (IL 9), FAP 71 (IL 54)  
 \*\* D3 AGGREGATE SHOULDERS 2010-1

**INDEX OF SHEETS**

1. COVER SHEET
2. GENERAL NOTES
3. SUMMARY OF QUANTITIES
4. TYPICAL SECTIONS
5. AGGREGATE SHOULDER SCHEDULE - FAP 693,697 (IL 9)
6. AGGREGATE SHOULDER SCHEDULE - FAP 71 (IL 54)
7. AGGREGATE SHOULDER DETAILS

**STANDARDS**

- |           |                                                                            |
|-----------|----------------------------------------------------------------------------|
| 701001-02 | OFF-ROAD OPERATIONS 2L, 2W, MORE THAN 4.5 m (15') AWAY                     |
| 701006-03 | OFF-ROAD OPERATIONS 2L, 2W, 4.5 m (15') TO 600 mm (24") FROM PAVEMENT EDGE |
| 701011-02 | OFF-ROAD MOVING OPERATIONS 2L, 2W, DAY ONLY                                |
| 701301-03 | LANE CLOSURE, 2L, 2W, SHORT TIME OPERATIONS                                |
| 701306-02 | LANE CLOSURE, 2L, 2W, SLOW MOVING OPERATIONS DAY ONLY, FOR SPEEDS > 45 MPH |
| 701901-01 | TRAFFIC CONTROL DEVICES                                                    |

**STATE OF ILLINOIS**  
**DEPARTMENT OF TRANSPORTATION**  
**DIVISION OF HIGHWAYS**  
**PROPOSED**  
**HIGHWAY PLANS**  
**FAP ROUTE 693 & 697 (IL 9)**  
**FAP ROUTE 71 (IL 54)**  
**SECTION D3 AGGREGATE SHOULDERS 2010-1**

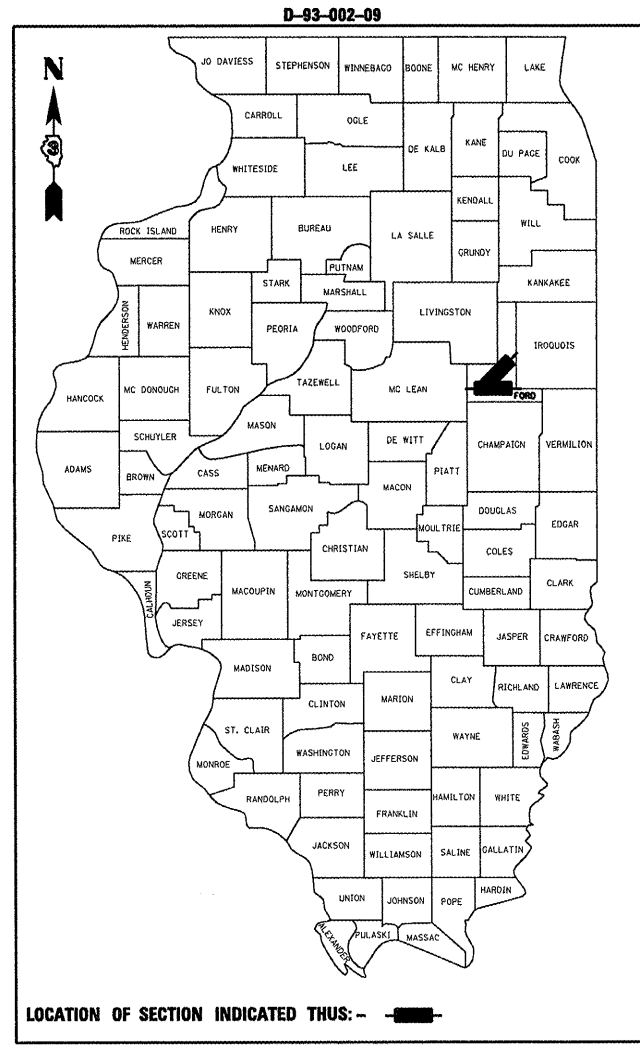

**FUNCTIONAL CLASSIFICATION**  
 RURAL - MINOR ARTERIAL  
 F.A.P. ROUTE 697 (IL 9)  
 2007 ADT = 1750  
 P.V. = 87.4% M.U. = 8.6% S.U. = 4.0%

**FUNCTIONAL CLASSIFICATION**  
 RURAL - MINOR ARTERIAL  
 F.A.P. ROUTE 71 (IL 54)  
 2007 ADT = 1500  
 P.V. = 83.3% M.U. = 10.0% S.U. = 6.7%

**PROJECT END**  
**IL ROUTE 54**  
**1400 N. ROAD AT ROBERTS**

**SHOULDER STONE PLACEMENT**  
**FORD COUNTY**  
**C-93-077-09**

**PROJECT BEGIN**  
**IL ROUTE 54**  
**500 N. ROAD AT GIBSON CITY**

**PROJECT END**  
**IL ROUTE 9**  
**McLEAN COUNTY LINE**

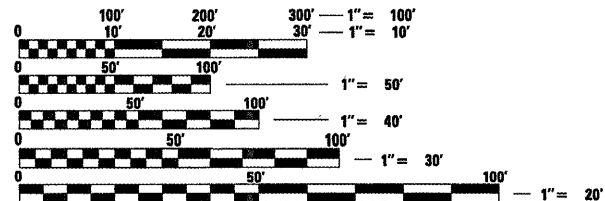
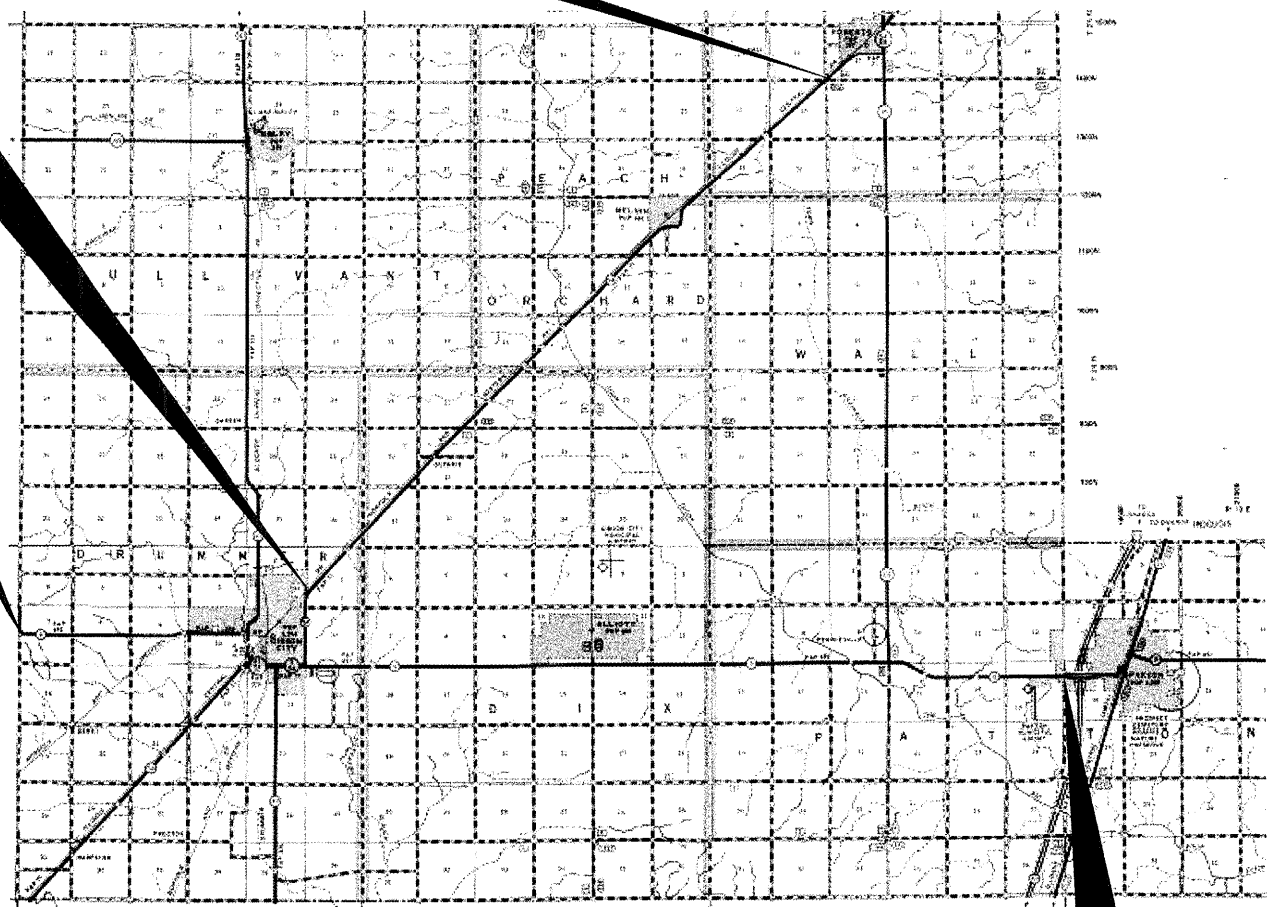

FULL SIZE PLANS HAVE BEEN PREPARED USING STANDARD ENGINEERING SCALES. REDUCED SIZED PLANS WILL NOT CONFORM TO STANDARD SCALES. IN MAKING MEASUREMENTS ON REDUCED PLANS, THE ABOVE SCALES MAY BE USED.

J.U.L.I.E.  
 JOINT UTILITY LOCATION INFORMATION FOR EXCAVATION  
 1-800-892-0123  
 OR 811

**PROJECT ENGINEER: JOE KANNEL**  
**UNIT CHIEF: RON WOODSHANK**  
**TOWNSHIP: VARIOUS**  
**CONTRACT NO. 66941**

GROSS LENGTH IL RTE 9 = 98102 FT. = 18.58 MILE  
 NET LENGTH IL RTE 9 = 58978 FT. = 11.17 MILE  
  
 GROSS LENGTH IL RTE 54 = 67478 FT. = 12.78 MILE  
 NET LENGTH IL RTE 54 = 61934 FT. = 11.73 MILE

**PROJECT BEGIN**  
**IL ROUTE 9**  
**AT 1800 E. ROAD (PAXTON)**

STATE OF ILLINOIS  
 DEPARTMENT OF TRANSPORTATION  
 DIVISION OF HIGHWAYS

SUBMITTED 4/12 2009  
George Rejman  
 DEPUTY DIRECTOR OF HIGHWAYS, REGION ENGINEER  
 May 8, 2009  
Charles G. Jorgensen  
 ENGINEER OF DESIGN AND ENVIRONMENT  
 May 8, 2009  
Christine M. Reed  
 DIRECTOR OF HIGHWAYS, CHIEF ENGINEER

**PRINTED BY THE AUTHORITY**  
**OF THE STATE OF ILLINOIS**

GENERAL NOTES

PLAN DIMENSIONS AND DETAILS RELATIVE TO EXISTING PLANS ARE SUBJECT TO ROUTINE VARIATIONS. THE CONTRACTOR SHALL FIELD VERIFY EXISTING DIMENSIONS AND DETAILS AFFECTING NEW CONSTRUCTION AND MAKE NECESSARY APPROVED ADJUSTMENTS PRIOR TO CONSTRUCTION OR ORDERING OF MATERIALS. SUCH VARIATIONS SHALL NOT BE CAUSE FOR ADDITIONAL COMPENSATION FOR A CHANGE IN THE SCOPE OF THE WORK. HOWEVER, THE CONTRACTOR WILL BE PAID FOR THE QUANTITY FURNISHED BASED UPON THE UNIT BID FOR THE WORK.

THE CONTRACTOR SHALL BE RESPONSIBLE FOR PROTECTING UTILITY PROPERTY FROM CONSTRUCTION OPERATIONS AS OUTLINED IN ARTICLE 107.31 OF THE STANDARD SPECIFICATIONS. THE "JULIE" NUMBER IS 1-800-892-0123. A MINIMUM OF FORTY-EIGHT (48) HOURS ADVANCE NOTICE IS REQUIRED.

ABANDONED UNDERGROUND UTILITIES THAT CONFLICT WITH CONSTRUCTION SHALL BE DISPOSED OF OUTSIDE THE LIMITS OF THE RIGHT OF WAY ACCORDING TO ARTICLE 202.03 OF THE STANDARD SPECIFICATIONS AND AS DIRECTED BY THE ENGINEER. THIS WORK WILL NOT BE PAID FOR SEPARATELY BUT SHALL BE INCLUDED IN THE COST OF EARTH EXCAVATION.

ANY REFERENCE TO A STANDARD IN THESE PLANS SHALL BE INTERPRETED TO MEAN THE EDITION AS INDICATED BY THE SUBNUMBER LISTED ON THE INDEX OF SHEETS OR THE COPY OF THE STANDARD INCLUDED IN THESE PLANS.

THE EXISTING SHOULDERS ARE LOW. IN THE EVENT THAT CONSTRUCTION OPERATIONS RESULT IN A DROP OFF GREATER THAN 3" BETWEEN THE EDGE OF PAVEMENT OR EDGE OF SHOULDER WITHIN 3' OF THE EDGE OF PAVEMENT AND THE EARTH OR AGGREGATE SHOULDERS, THEN THE DROP OFF SHALL BE PROTECTED ACCORDING TO ARTICLE 701.04(B)(1) OF THE STANDARD SPECIFICATIONS. THIS WORK WILL BE CONSIDERED AS INCLUDED IN THE CONTRACT UNIT PRICES FOR TRAFFIC CONTROL.

THE FOLLOWING RATES OF APPLICATION HAVE BEEN USED IN CALCULATING PLAN QUANTITIES:

GRANULAR MATERIALS	2.05	TONS / CU YD
--------------------	------	--------------

DATE: 4-1-09

PREPARED BY: *Rich Powell*  
DISTRICT STUDIES & PLANS ENGINEER

EXAMINED BY: *Hubert K. Sings*  
DISTRICT CONSTRUCTION ENGINEER

*Wayne J. Phillips*  
DISTRICT MATERIALS ENGINEER

*James A. Hucker*  
DISTRICT OPERATIONS ENGINEER

\* FAP 693.697 (IL 9), FAP 71 (IL 54)  
\*\* D3 AGGREGATE SHOULDERS 2010-1

FILE NAME =	USER NAME = woodshankr1	DESIGNED - RON WOODSHANK	REVISED -
ct\pw_work\PW100T\WOODSHANKRL\dms91757	D366941-details.dgn	DRAWN - RON WOODSHANK	REVISED -
PLOT SCALE = 100.0000 / IN.	CHECKED -	REVISIONS	DATE
PLOT DATE = Mar 30, 2009 - 08:58:26 AM	DATE	REVISED	

**STATE OF ILLINOIS  
DEPARTMENT OF TRANSPORTATION**

**GENERAL NOTES**

SCALE: \_\_\_\_\_ SHEET NO. 1 OF 1 SHEETS STA. \_\_\_\_\_ TO STA. \_\_\_\_\_

F.A.P. RTE.	SECTION	COUNTY	TOTAL SHEETS	SHEET NO.
*	**	FORD	7	2
CONTRACT NO. 66941				
ILLINOIS FED. AID PROJECT				

### SUMMARY OF QUANTITIES

CONSTRUCTION CODE TYPE:                      SFTY-2A

CODE NO.	ITEM	UNIT	TOTAL QUANTITY	RURAL IL RTE 9	100% STATE IL RTE 54
48102100	AGGREGATE WEDGE SHOULDER, TYPE B	TON	11207	8529	2678
67100100	MOBILIZATION	L SUM	1	0.5	0.5
70100460	TRAFFIC CONTROL AND PROTECTION, STANDARD 701306	L SUM	1	0.5	0.5
20048665	RAILROAD PROTECTIVE LIABILITY INSURANCE	L SUM	1	0.5	0.5

\* FAP 693,697 (IL 9), FAP 71 (IL 54)  
 \*\* D3 AGGREGATE SHOULDERS 2010-1

FILE NAME =	USER NAME = woodshankr1	DESIGNED - RON WOODSHANK	REVISED - -----
c:\pwork\pwidot\WOODSHANKRL\dms91757	0366941-details.dgn	DRAWN - RON WOODSHANK	REVISED - -----
	PLOT SCALE = 100.0000 "/ IN.	CHECKED - -----	REVISED - -----
	PLOT DATE = Mar 30, 2009 - 08:58:31 AM	DATE - -----	REVISED - -----

**STATE OF ILLINOIS  
DEPARTMENT OF TRANSPORTATION**

## SUMMARY OF QUANTITIES

SCALE: ----- SHEET NO. 1 OF 1 SHEETS STA. ----- TO STA. -----

F.A.P. RTE.	SECTION	COUNTY	TOTAL SHEETS	SHEET NO.
*	**	FORD	7	3
CONTRACT NO. 66941				
ILLINOIS FED. AID PROJECT				

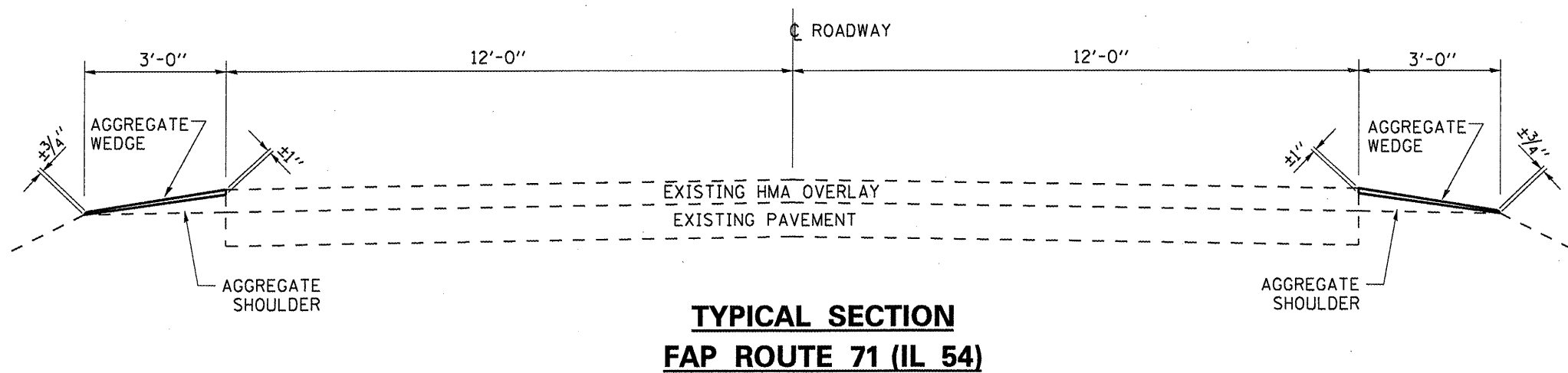
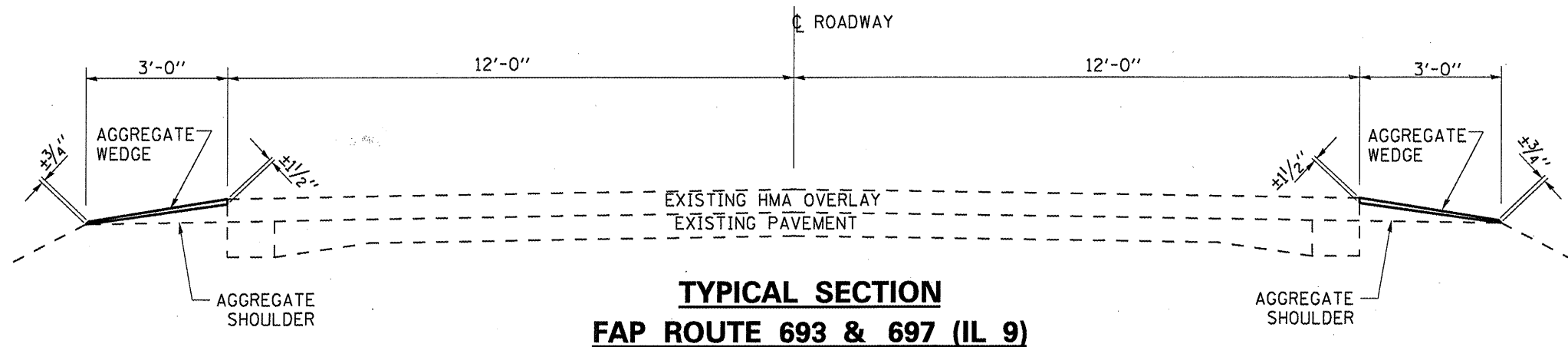

\* FAP 693,697 (IL 9), FAP 71 (IL 54)  
 \*\* D3 AGGREGATE SHOULDERS 2010-1

FILE NAME =	USER NAME = woodshankr1	DESIGNED - RON WOODSHANK	REVISED -
es:\pwork\PIWIDOT\WOODSHANKRL\dms91757	0366941-details.dgn	DRAWN - RON WOODSHANK	REVISED -
	PLOT SCALE = 100.0000' / IN.	CHECKED -	REVISED -
	PLOT DATE = Mar 30, 2009 - 09:58:36 AM	DATE -	REVISED -

**STATE OF ILLINOIS  
DEPARTMENT OF TRANSPORTATION**

## TYPICAL SECTIONS

SCALE: \_\_\_\_\_ SHEET NO. 1 OF 1 SHEETS STA. \_\_\_\_\_ TO STA. \_\_\_\_\_

F.A.P. RTE.	SECTION	COUNTY	TOTAL SHEETS	SHEET NO.
*	**	FORD	7	4
CONTRACT NO. 66941				
ILLINOIS FED. AID PROJECT				

LOCATION		FAP ROUTES 693 & 697 (IL 9)		
LOG MILE	LOG MILE	TON	WESTBOUND LANE	
			REMARKS	
	0.00		BEGIN PROJECT: 1800 E. ROAD	
0.00	TO 0.30	22	INDUSTRIAL PARK DRIVE	
0.30	TO 1.00	68	1700 E. ROAD	
1.00	TO 1.50	54		
1.50	TO 2.00	54	1600 E. ROAD	
2.00	TO 2.30	33		
2.30	TO 3.00	64	IL ROUTE 115	
3.00	TO 3.30	32		
3.30	TO 3.60	33		
3.60	TO 4.10	40	1400 E. ROAD	
4.10	TO 5.00	99	1300 E. ROAD	
5.00	TO 5.50	55		
5.50	TO 6.10	12	1200 E. ROAD	
6.10	TO 7.10	105	1100 E. ROAD	
7.10	TO 7.20	11		
7.20	TO 8.10	129	SIDE ROAD	
8.10	TO 9.10	132	900 E. ROAD	
9.10	TO 10.10	218	800 E. ROAD	
10.10	TO 11.10	255		
11.10	TO 11.80	204		
11.80	TO 12.00	36	600 E. ROAD	
12.00	TO 12.50	178	550 E. ROAD	
12.50	TO 12.60	34	FULTON STREET	
12.60	TO 12.80	77	CHAPEL DRIVE	
12.80	TO 12.90	6	ILLINOIS STREET	
12.90	TO 12.97	29	BEGIN CURB: GIBSON CITY	
12.97	TO 14.70		END CURB: GIBSON CITY	
	14.60		IL ROUTE 47	
14.70	TO 15.30	356		
15.30	TO 15.50	31	300 E. ROAD	
15.50	TO 16.50	597	200 E. ROAD	
16.50	TO 18.30	1245	END PROJECT: McLEAN COUNTY LINE	
TOTAL		4209		

LOCATION		FAP ROUTES 693 & 697 (IL 9)		
LOG MILE	LOG MILE	TON	EASTBOUND LANE	
			REMARKS	
	0.00		BEGIN PROJECT: 1800 E. ROAD	
0.00	TO 0.30	22		
0.30	TO 1.00	75		
1.00	TO 1.50	49		
1.50	TO 2.00	49	1600 E. ROAD	
2.00	TO 2.30	33		
2.30	TO 3.00	65	IL ROUTE 115	
3.00	TO 3.30	30	1480 E. ROAD	
3.30	TO 3.60	32		
3.60	TO 4.10	40		
4.10	TO 5.00	101	1300 E. ROAD	
5.00	TO 5.50	55		
5.50	TO 6.10	12	1200 E. ROAD	
6.10	TO 7.10	109	1100 E. ROAD	
7.10	TO 7.20	11		
7.20	TO 8.10	132	SIDE ROAD	
8.10	TO 9.10	133	900 E. ROAD	
9.10	TO 10.10	220	800 E. ROAD	
10.10	TO 11.10	250		
11.10	TO 11.80	204		
11.80	TO 12.00	33	600 E. ROAD	
12.00	TO 12.50	179		
12.50	TO 12.60	37		
12.60	TO 12.80	81		
12.80	TO 12.90	49		
12.90	TO 12.97	37	BEGIN CURB: GIBSON CITY	
12.97	TO 14.70		END CURB: GIBSON CITY	
	14.60		IL ROUTE 47	
14.70	TO 15.30	325	JORDAN STREET	
15.30	TO 15.50	127	300 E. ROAD	
15.50	TO 16.50	597	200 E. ROAD	
16.50	TO 18.30	1233	END PROJECT: McLEAN COUNTY LINE	
TOTAL		4320		

\* FAP 693,697 (IL 9), FAP 71 (IL 54)  
 \*\* D3 AGGREGATE SHOULDERS 2010-1

LOCATION		FAP ROUTE 71 (IL 54)		
LOG MILE	LOG MILE	TON	SOUTHBOUND LANE	
		REMARKS		
	0.00		BEGIN PROJECT: 500 N. ROAD AT GIBSON CITY	
0.00	TO 0.17	10	SIDE ROAD	
0.17	TO 1.62	153	SIDE ROAD	
1.62	TO 2.67	113	700 N. ROAD	
2.67	TO 3.00	35	725 N. ROAD	
3.00	TO 3.30	31	750 N. ROAD	
3.30	TO 4.05	80	800 N. ROAD	
4.05	TO 4.45	42	820 N. ROAD	
4.45	TO 5.43	105	900 N. ROAD	
5.43	TO 5.88	48	SIDE ROAD	
5.88	TO 6.83	99	1000 N ROAD	
6.83	TO 7.25	45	1030 N. ROAD (ELLIOT)	
7.25	TO 8.25	106	1100 N. ROAD	
8.25	TO 8.71	48	SIDE ROAD	
8.71	TO 8.90	19	CENTER STREET	
8.90	TO 9.02	10	1130 N. ROAD	
9.02	TO 9.10	8	S. HUNT STREET	
9.10	TO 9.30	21	E. MAIN STREET	
9.30	TO 9.80	48	1200 N. ROAD	
9.80	TO 10.20	41	1220 N. ROAD	
10.20	TO 11.30	118	1300 N. ROAD	
11.30	TO 12.80	159	END PROJECT: 1400 N. ROAD AT ROBERTS	
TOTAL		1339		

LOCATION		FAP ROUTE 71 (IL 54)		
LOG MILE	LOG MILE	TON	NORTHBOUND LANE	
		REMARKS		
	0.00		BEGIN PROJECT: 500 N. ROAD AT GIBSON CITY	
0.00	TO 0.17	17	SIDE ROAD	
0.17	TO 1.62	153	SIDE ROAD	
1.62	TO 2.67	112	700 N. ROAD	
2.67	TO 3.00	34	725 N. ROAD	
3.00	TO 3.30	31	750 N. ROAD	
3.30	TO 4.05	80	800 N. ROAD	
4.05	TO 4.45	42	820 N. ROAD	
4.45	TO 5.43	105	900 N. ROAD	
5.43	TO 5.88	48	SIDE ROAD	
5.88	TO 6.83	89	1000 N ROAD	
6.83	TO 7.25	44	1030 N. ROAD (ELLIOT)	
7.25	TO 8.25	106	1100 N. ROAD	
8.25	TO 8.71	49	SIDE ROAD	
8.71	TO 9.02	30	1130 N. ROAD	
9.02	TO 9.80	82	1200 N. ROAD	
9.80	TO 10.20	41	1220 N. ROAD	
10.20	TO 11.52	139	1300 E. ROAD	
11.52	TO 12.80	137	END PROJECT: 1400 N. ROAD AT ROBERTS	
TOTAL		1339		

\* FAP 693,697 (IL 9), FAP 71 (IL 54)  
 \*\* D3 AGGREGATE SHOULDERS 2010-1

FILE NAME =	USER NAME = woodshankr1	DESIGNED - RON WOODSHANK	REVISED - -----
c:\pw_work\FWIDOT\WOODSHANKR\dma91757	D366941-details.dgn	DRAWN - RON WOODSHANK	REVISED - -----
PLOT SCALE = 100.0000' / IN.	CHECKED - ---	REVISOR - -----	REVISED - -----
PLOT DATE = Mar 30, 2009 - 08:58:45 AM	DATE - -----	REVISOR - -----	REVISED - -----

STATE OF ILLINOIS  
 DEPARTMENT OF TRANSPORTATION

**SCHEDULES - FAP 71 (IL 54)**

SCALE: ----- SHEET NO. 1 OF 1 SHEETS STA. ----- TO STA. -----

F.A.P. RTE.	SECTION	COUNTY	TOTAL SHEETS	SHEET NO.
*	**	FORD	7	6
CONTRACT NO. 66941			[ILLINOIS] FED. AID PROJECT	

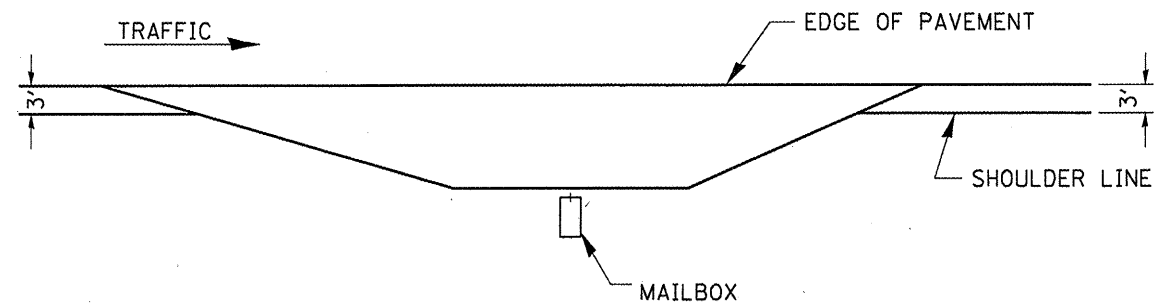

**PLAN AT MAIL BOX TURNOUTS**

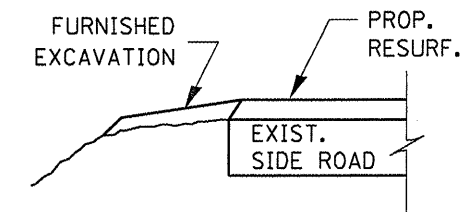

**SECTION B-B**

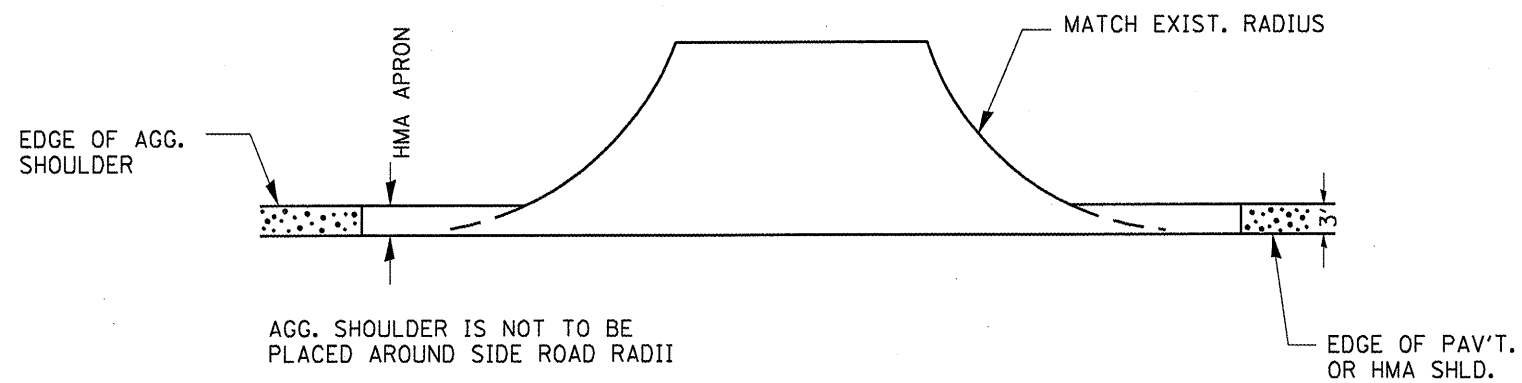

**PLAN AT SIDE ROADS**

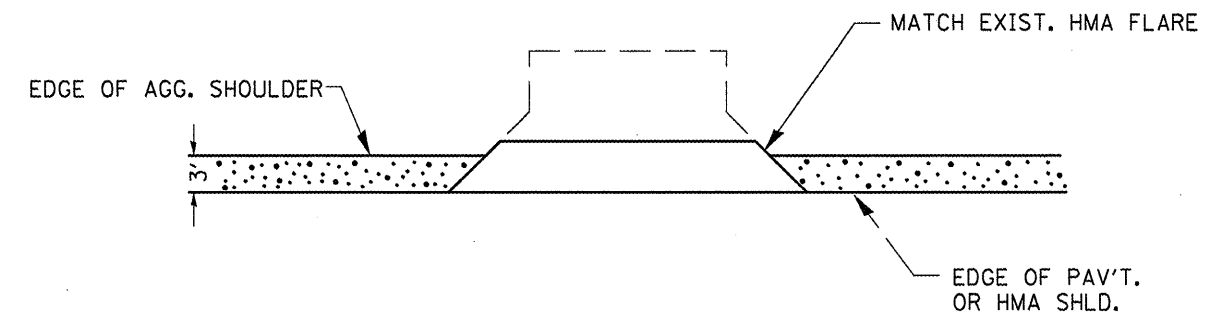

**PLAN AT PRIVATE & COMMERCIAL ENTRANCES**

• FAP 693,697 (IL 9), FAP 71 (IL 54)  
 •• D3 AGGREGATE SHOULDERS 2010-1

FILE NAME =	USER NAME = woodshankr1	DESIGNED - RON WOODSHANK	REVISED -
c:\pwork\PW100T\WOODSHANKR1\dms91757	D366941-details.dgn	DRAWN - RON WOODSHANK	REVISED -
	PLOT SCALE = 100.0000' / IN.	CHECKED -	REVISED -
	PLOT DATE = Mar 30, 2009 - 09:59:50 AM	DATE -	REVISED -

STATE OF ILLINOIS  
 DEPARTMENT OF TRANSPORTATION

**AGGREGATE SHOULDER DETAILS**

SCALE: SHEET NO. 1 OF 1 SHEETS STA. TO STA.

F.A.P. RTE.	SECTION	COUNTY	TOTAL SHEETS	SHEET NO.
•	••	FORD	7	7
CONTRACT NO. 66941			ILLINOIS FED. AID PROJECT	