

INDEX OF SHEETS

1. COVER SHEET
2. GENERAL NOTES
3. SUMMARY OF QUANTITIES
4. TYPICAL SECTIONS
5. SCHEDULES
6. AGGREGATE SHOULDER DETAILS

STANDARDS

- | | |
|-----------|--|
| 701001-02 | OFF-ROAD OPERATIONS 2L, 2W, MORE THAN 4.5 m (15') AWAY |
| 701006-03 | OFF-ROAD OPERATIONS 2L, 2W, 4.5 m (15') TO 600 mm (24") FROM PAVEMENT EDGE |
| 701011-02 | OFF-ROAD MOVING OPERATIONS 2L, 2W, DAY ONLY |
| 701301-03 | LANE CLOSURE, 2L, 2W, SHORT TIME OPERATIONS |
| 701306-02 | LANE CLOSURE, 2L, 2W, SLOW MOVING OPERATIONS DAY ONLY, FOR SPEEDS > 45 MPH |
| 701901-01 | TRAFFIC CONTROL DEVICES |

STATE OF ILLINOIS
DEPARTMENT OF TRANSPORTATION
DIVISION OF HIGHWAYS
PROPOSED
HIGHWAY PLANS
 VARIOUS ROUTE
SECTION D3 AGGREGATE SHOULDERS 2010-2

SHOULDER STONE PLACEMENT
FORD COUNTY

C-93-095-09

PROJECT BEGIN
 KANKAKEE COUNTY LINE (M.P. 0.00)

PROJECT END
 IL ROUTE 9 (M.P. 37.7)

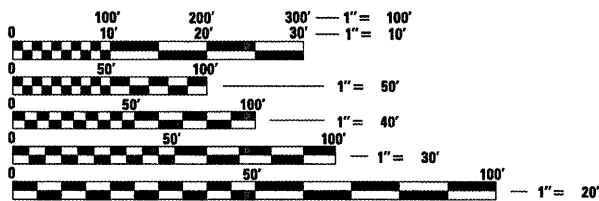
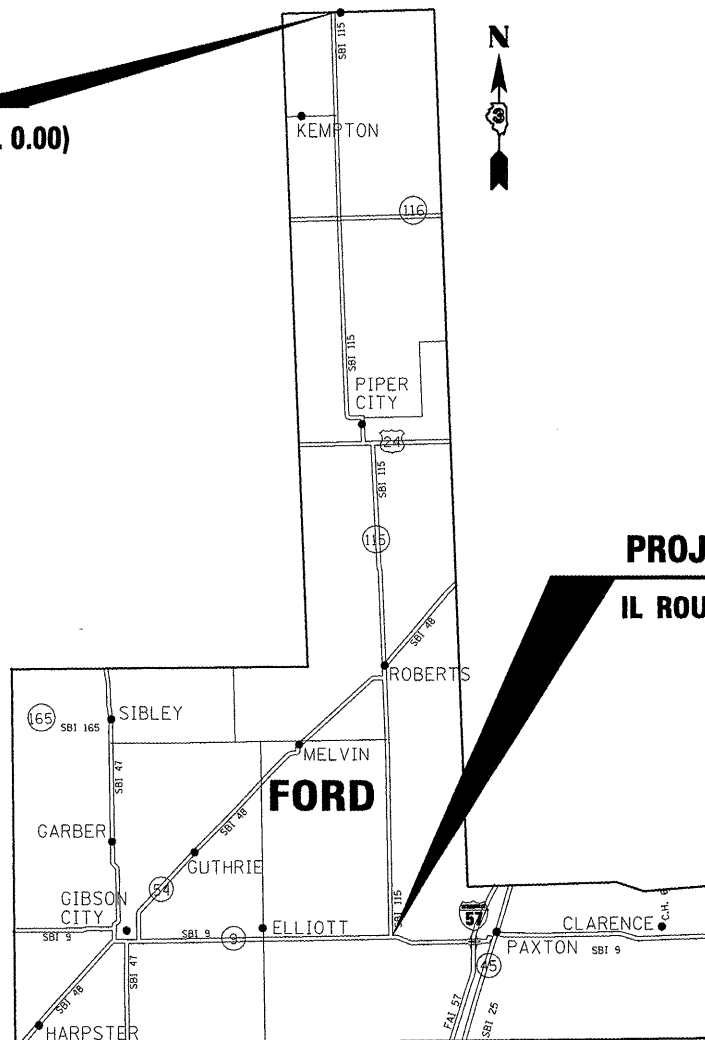

FULL SIZE PLANS HAVE BEEN PREPARED USING STANDARD ENGINEERING SCALES. REDUCED SIZED PLANS WILL NOT CONFORM TO STANDARD SCALES. IN MAKING MEASUREMENTS ON REDUCED PLANS, THE ABOVE SCALES MAY BE USED.

J.U.L.I.E.
 JOINT UTILITY LOCATION INFORMATION FOR EXCAVATION
 1-800-892-0123
 OR 811

PROJECT ENGINEER: JOE KANNEL
UNIT CHIEF: RON WOODSHANK
TOWNSHIP: VARIOUS
CONTRACT NO. 66962

GROSS LENGTH IL RTE 9 = 199,056 FT. = 37.7 MILE
 NET LENGTH IL RTE 9 = 165,083 FT. = 31.3 MILE

RTE.	SECTION	COUNTY	TOTAL SHEETS	SHEET NO.
*	**	FORD	6	1
		ILLINOIS	CONTRACT NO. 66962	

* FAP 796, 798, FAS 340
 ** D3 AGGREGATE SHOULDERS 2010-2

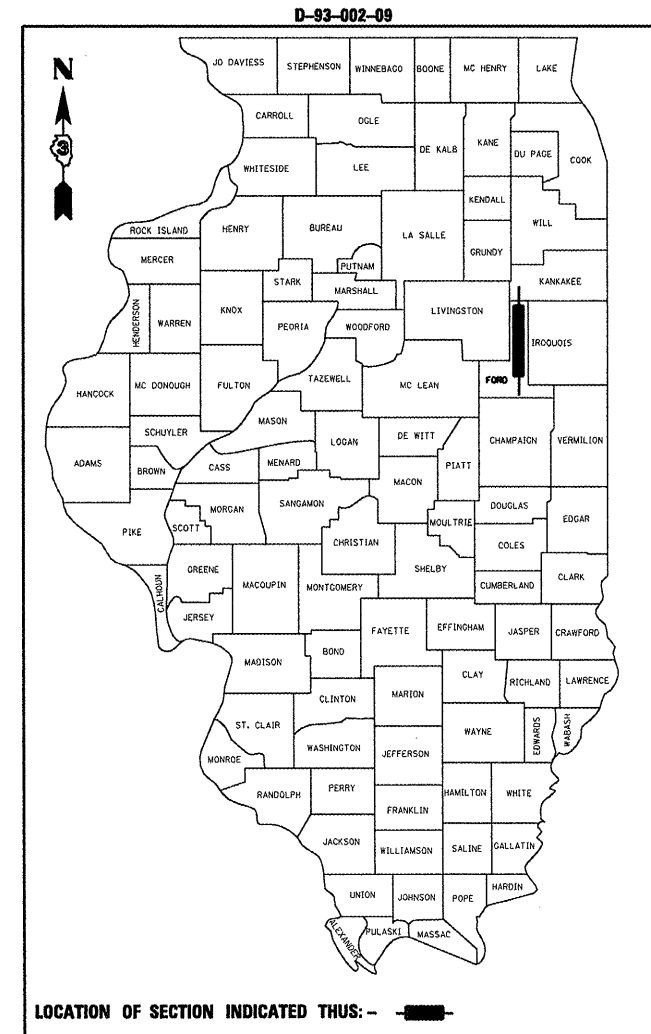

FUNCTIONAL CLASSIFICATION
 RURAL - MINOR ARTERIAL
 F.A.P. RTE 796,798, FAS 340 (IL 115)
 2007 ADT = 900
 P.V = 76.1% M.U. = 13.9% S.U. = 10.0%

STATE OF ILLINOIS
 DEPARTMENT OF TRANSPORTATION
 DIVISION OF HIGHWAYS

SUBMITTED 4/2 20 09
George Ryan
 DEPUTY DIRECTOR OF HIGHWAYS, REGION ENGINEER

May 8, 20 09
Charles J. Ingersoll
 ENGINEER OF DESIGN AND ENVIRONMENT

May 8, 20 09
Christine M. Reed
 DIRECTOR OF HIGHWAYS, CHIEF ENGINEER

PRINTED BY THE AUTHORITY
OF THE STATE OF ILLINOIS

GENERAL NOTES

PLAN DIMENSIONS AND DETAILS RELATIVE TO EXISTING PLANS ARE SUBJECT TO ROUTINE VARIATIONS. THE CONTRACTOR SHALL FIELD VERIFY EXISTING DIMENSIONS AND DETAILS AFFECTING NEW CONSTRUCTION AND MAKE NECESSARY APPROVED ADJUSTMENTS PRIOR TO CONSTRUCTION OR ORDERING OF MATERIALS. SUCH VARIATIONS SHALL NOT BE CAUSE FOR ADDITIONAL COMPENSATION FOR A CHANGE IN THE SCOPE OF THE WORK. HOWEVER, THE CONTRACTOR WILL BE PAID FOR THE QUANTITY FURNISHED BASED UPON THE UNIT BID FOR THE WORK.

THE CONTRACTOR SHALL BE RESPONSIBLE FOR PROTECTING UTILITY PROPERTY FROM CONSTRUCTION OPERATIONS AS OUTLINED IN ARTICLE 107.31 OF THE STANDARD SPECIFICATIONS. THE "JULIE" NUMBER IS 1-800-892-0123. A MINIMUM OF FORTY-EIGHT (48) HOURS ADVANCE NOTICE IS REQUIRED.

ABANDONED UNDERGROUND UTILITIES THAT CONFLICT WITH CONSTRUCTION SHALL BE DISPOSED OF OUTSIDE THE LIMITS OF THE RIGHT OF WAY ACCORDING TO ARTICLE 202.03 OF THE STANDARD SPECIFICATIONS AND AS DIRECTED BY THE ENGINEER. THIS WORK WILL NOT BE PAID FOR SEPARATELY BUT SHALL BE INCLUDED IN THE COST OF EARTH EXCAVATION.

ANY REFERENCE TO A STANDARD IN THESE PLANS SHALL BE INTERPRETED TO MEAN THE EDITION AS INDICATED BY THE SUBNUMBER LISTED ON THE INDEX OF SHEETS OR THE COPY OF THE STANDARD INCLUDED IN THESE PLANS.

THE EXISTING SHOULDERS ARE LOW. IN THE EVENT THAT CONSTRUCTION OPERATIONS RESULT IN A DROP OFF GREATER THAN 3" BETWEEN THE EDGE OF PAVEMENT OR EDGE OF SHOULDER WITHIN 3' OF THE EDGE OF PAVEMENT AND THE EARTH OR AGGREGATE SHOULDERS, THEN THE DROP OFF SHALL BE PROTECTED ACCORDING TO ARTICLE 701.04(B)(1) OF THE STANDARD SPECIFICATIONS. THIS WORK WILL BE CONSIDERED AS INCLUDED IN THE CONTRACT UNIT PRICES FOR TRAFFIC CONTROL.

THE FOLLOWING RATES OF APPLICATION HAVE BEEN USED IN CALCULATING PLAN QUANTITIES:

GRANULAR MATERIALS	2.05	TONS / CU YD
--------------------	------	--------------

DATE: 4.1.09

PREPARED BY: *Rid Paul*
DISTRICT STUDIES & PLANS ENGINEER

EXAMINED BY: *Harbert K. Long*
DISTRICT CONSTRUCTION ENGINEER

Way J. Phillips
DISTRICT MATERIALS ENGINEER

James A. Husker
DISTRICT OPERATIONS ENGINEER

* FAP 796, 798, FAS 340
** D3 AGGREGATE SHOULDERS 2010-2

FILE NAME =	USER NAME = woodshankr1	DESIGNED - RON WOODSHANK	REVISED -
of\pw\work\PW\DDT\WOODSHANKRL\dms91783	0366962-details.dgn	DRAWN - RON WOODSHANK	REVISED -
	PLOT SCALE = 100.0000 / IN.	CHECKED -	REVISED -
	PLOT DATE = Mar 31, 2009 - 02:04:15 PM	DATE -	REVISED -

STATE OF ILLINOIS
DEPARTMENT OF TRANSPORTATION

GENERAL NOTES

SCALE: _____ SHEET NO. 1 OF 1 SHEETS STA. _____ TO STA. _____

RTE.	SECTION	COUNTY	TOTAL SHEETS	SHEET NO.
*	**	FORD	6	2
CONTRACT NO. 66962				

SUMMARY OF QUANTITIES

CONSTRUCTION CODE TYPE:

SFTY-2A

RURAL
100% STATE
TOTAL
QUANTITY

CODE NO.	ITEM	UNIT	TOTAL QUANTITY
48102100	AGGREGATE WEDGE SHOULDER, TYPE B	TON	5615
67100100	MOBILIZATION	L SUM	1
70100460	TRAFFIC CONTROL AND PROTECTION, STANDARD 701306	L SUM	1

* FAP 796, 798, FAS 340
** D3 AGGREGATE SHOULDERS 2010-2

FILE NAME = c:\pw_work\PWIDOT\WOODSHANKRL\dms91783	USER NAME = woodshankr1 D366962-details.dgn	DESIGNED - RON WOODSHANK	REVISED - -----	STATE OF ILLINOIS DEPARTMENT OF TRANSPORTATION	SUMMARY OF QUANTITIES	RTE. _____	SECTION _____	COUNTY _____	TOTAL SHEETS _____	SHEET NO. _____
	PLOT SCALE = 100.0000 ' / IN.	DRAWN - RON WOODSHANK	REVISED - -----					FORD	6	3
	PLOT DATE = Mar 31, 2009 - 02:04:19 PM	CHECKED - -----	REVISED - -----		SCALE: -----	SHEET NO. 1 OF 1 SHEETS	STA. -----	TO STA. -----	CONTRACT NO. 66962	
ILLINOIS										

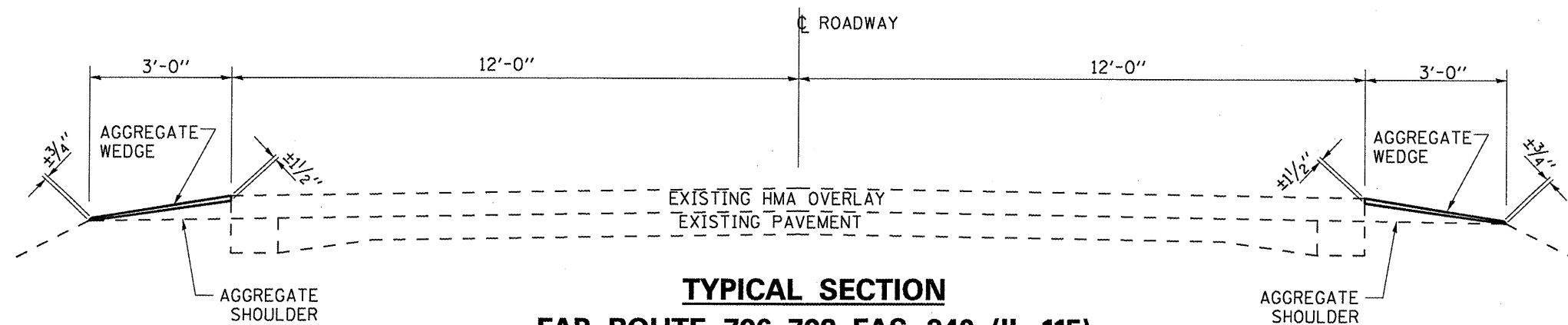

TYPICAL SECTION
FAP ROUTE 796, 798, FAS 340 (IL 115)

* FAP 796, 798, FAS 340
 ** D3 AGGREGATE SHOULDERS 2010-2

FILE NAME =	USER NAME = woodshankr1	DESIGNED - RON WOODSHANK	REVISED -
c:\pwork\pwork\WOODSHANKR1\dms91783	D366762-details.dgn	DRAWN - RON WOODSHANK	REVISED -
	PLOT SCALE = 100.0000 / IN.	CHECKED -	REVISED -
	PLOT DATE = Mar 31, 2009 - 02:04:23 PM	DATE -	REVISED -

STATE OF ILLINOIS
DEPARTMENT OF TRANSPORTATION

TYPICAL SECTION

SCALE: _____ SHEET NO. 1 OF 1 SHEETS STA. _____ TO STA. _____

RTE.	SECTION	COUNTY	TOTAL SHEETS	SHEET NO.
*	**	FORD	6	4
CONTRACT NO. 66962			ILLINOIS	

LOCATION			KANKAKEE CO. LINE TO IL ROUTE 9 NORTHBOUND LANE	
LOG MILE		LOG MILE	TON	REMARKS
	0.00			PROJECT BEGIN: KANKAKEE CO. LINE
0.00	TO	1.00	79	4000 N. ROAD
1.00	TO	2.00	83	3900 N. ROAD
2.00	TO	3.00	83	3800 N. ROAD
3.00	TO	4.00	83	3700 N. ROAD
4.00	TO	5.00	82	3600 N. ROAD
5.00	TO	6.00	82	3500 N. ROAD
6.00	TO	7.00	84	3400 N. ROAD
7.00	TO	8.00	82	IL ROUTE 116
8.00	TO	9.00	73	3200 N. ROAD
9.00	TO	11.00	168	3000 N. ROAD
11.00	TO	12.00	82	2900 N. ROAD
12.00	TO	13.00	71	2800 N. ROAD
13.00	TO	14.00	82	2700 N. ROAD
14.00	TO	15.00	84	2600 N. ROAD
15.00	TO	15.90	73	SIDE ROAD
15.90	TO	15.95	3	SIDE ROAD
15.95	TO	16.20		OMMISSION: PIPER CITY (HMA SHLD/C.C.C. \$ G.)
16.20	TO	17.40	17	IL ROUTE 24
17.40	TO	18.80	117	2300 N. ROAD
18.80	TO	19.80	83	2200 N. ROAD
19.80	TO	20.80	81	2100 N. ROAD
20.80	TO	21.80	81	2000 N. ROAD
21.80	TO	22.80	83	1900 N. ROAD
22.80	TO	23.70	74	1800 N. ROAD
23.70	TO	24.70	81	1700 N. ROAD
24.70	TO	25.70	84	1600 N. ROAD
25.70	TO	26.60		OMMISSION: ROBERTS
26.60	TO	27.70	42	1400 N. ROAD N. ROAD
27.70	TO	28.70	82	1300 N. ROAD
28.70	TO	29.70	83	1200 N. ROAD
29.70	TO	30.70	81	1100 N. ROAD
30.70	TO	31.70	81	1000 N. ROAD
31.70	TO	32.70	82	900 N. ROAD
32.70	TO	33.70	82	800 N. ROAD
33.70	TO	34.70	81	700 N. ROAD
34.70	TO	35.70	84	600 N. ROAD
35.70	TO	36.70	84	500 N. ROAD
36.70	TO	37.70	83	PROJECT END: IL ROUTE 9
TOTAL			2860	

LOCATION			KANKAKEE CO. LINE TO IL ROUTE 9 NORTHBOUND LANE	
LOG MILE		LOG MILE	TON	REMARKS
	0.00			PROJECT BEGIN: KANKAKEE CO. LINE
0.00	TO	0.05	5	SIDE ROAD
0.05	TO	0.10	4	SIDEROAD
0.10	TO	1.00	74	4000 N. ROAD
1.00	TO	2.00	82	3900 N. ROAD
2.00	TO	3.00	84	3800 N. ROAD
3.00	TO	4.00	84	3700 N. ROAD
4.00	TO	5.00	82	3600 N. ROAD
5.00	TO	6.00	82	3500 N. ROAD
6.00	TO	7.00	83	3400 N. ROAD
7.00	TO	8.00	82	IL ROUTE 116
8.00	TO	9.00	72	3200 N. ROAD
9.00	TO	11.00	163	3000 N. ROAD
11.00	TO	12.00	82	2900 N. ROAD
12.00	TO	13.00	72	2800 N. ROAD
13.00	TO	14.00	81	2700 N. ROAD
14.00	TO	15.00	84	2600 N. ROAD
15.00	TO	16.20		OMMISSION: PIPER CITY (HMA SHLD/C.C.C. \$ G.)
16.20	TO	17.40	16	US ROUTE 24
17.40	TO	18.80	84	2300 N. ROAD
18.80	TO	19.80	83	2200 N. ROAD
19.80	TO	20.80	84	2100 N. ROAD
20.80	TO	21.80	82	2000 N. ROAD
21.80	TO	22.80	82	1900 N. ROAD
22.80	TO	23.70	72	1800 N. ROAD
23.70	TO	24.70	84	1700 N. ROAD
24.70	TO	25.70	84	1600 N. ROAD
25.70	TO	26.60		OMMISSION: ROBERTS
26.60	TO	27.70	42	1400 N. ROAD
27.70	TO	28.70	81	1300 N. ROAD
28.70	TO	29.70	83	1200 N. ROAD
29.70	TO	30.70	82	1100 N. ROAD
30.70	TO	31.70	84	1000 N. ROAD
31.70	TO	32.70	84	900 N. ROAD
32.70	TO	33.70	83	800 N. ROAD
33.70	TO	34.70	78	700 N. ROAD
34.70	TO	35.70	84	600 N. ROAD
35.70	TO	36.70	83	500 N. ROAD
36.70	TO	37.70	84	PROJECT END: IL ROUTE 9
TOTAL			2755	

FILE NAME =	USER NAME = woodshankr1	DESIGNED - RON WOODSHANK	REVISED -
ca:\pw_work\PW100T\WOODSHANKRL\dms91783	0366962-details.dgn	DRAWN - RON WOODSHANK	REVISED -
	PLOT SCALE = 100.0000' / IN.	CHECKED -	REVISED -
	PLOT DATE = Mar 31, 2009 - 02:04:27 PM	DATE -	REVISED -

STATE OF ILLINOIS
DEPARTMENT OF TRANSPORTATION

SCHEDULES

SCALE: SHEET NO. 1 OF 1 SHEETS STA. TO STA.

RTE.	SECTION	COUNTY	TOTAL SHEETS	SHEET NO.
*	**	FORD	6	5
			CONTRACT NO. 66962	

*FAP 796, 798, FAS 340
**D3 AGGREGATE SHOULDERS 2010-2

ILLINOIS

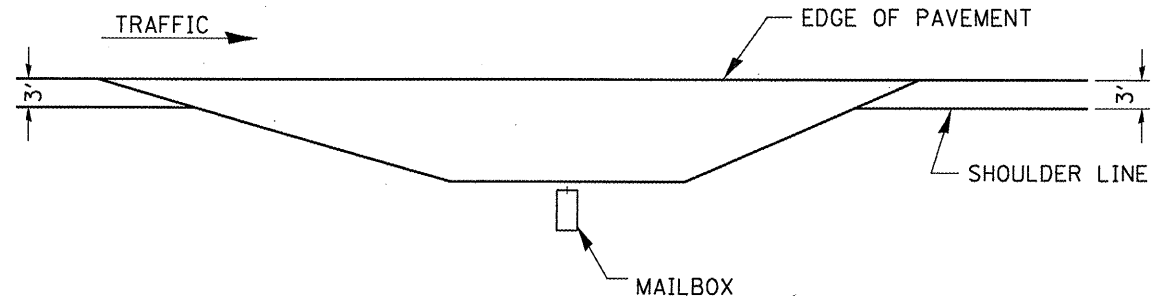

PLAN AT MAIL BOX TURNOUTS

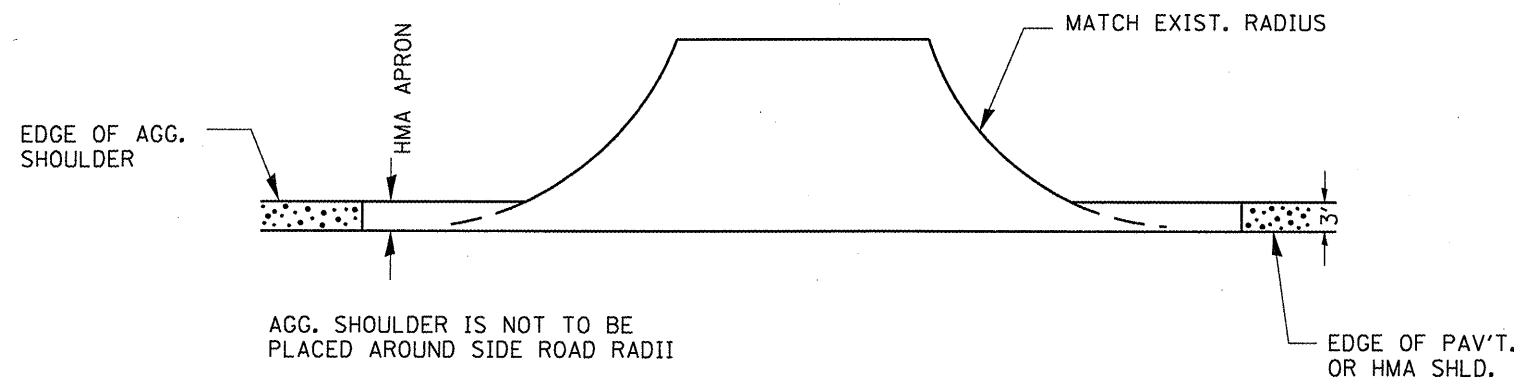
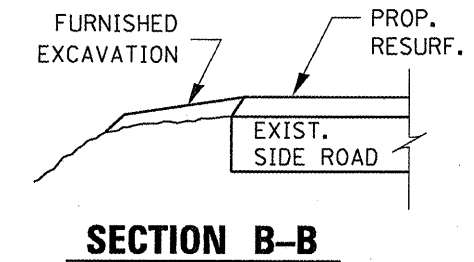

PLAN AT SIDE ROADS

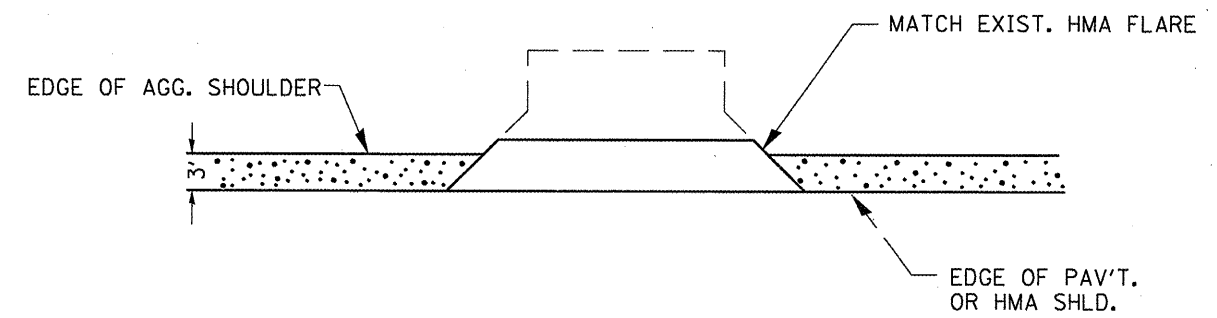

PLAN AT PRIVATE & COMMERCIAL ENTRANCES

• FAP 796, 798, FAS 340
 • D3 AGGREGATE SHOULDERS 2010-2

FILE NAME =	USER NAME = woodshankr1	DESIGNED - RON WOODSHANK	REVISED -
cr\pw_work\PW\DOT\WOODSHANKR1\dms91783	0366962-details.dgn	DRAWN - RON WOODSHANK	REVISED -
PLOT SCALE = 100.0000 / IN.	CHECKED -	REVISOR -	REVISED -
PLOT DATE = Mar 31, 2009 - 02:04:33 PM	DATE -	REVISOR -	REVISED -

STATE OF ILLINOIS
 DEPARTMENT OF TRANSPORTATION

AGGREGATE SHOULDER DETAILS

SCALE: SHEET NO. 1 OF 1 SHEETS STA. TO STA.

RTE.	SECTION	COUNTY	TOTAL SHEETS	SHEET NO.
*	**	FORD	6	6
CONTRACT NO. 66962				
[ILLINOIS]				